

Installation Instructions

Wireless LED Spotlight with Remote

MB370/371

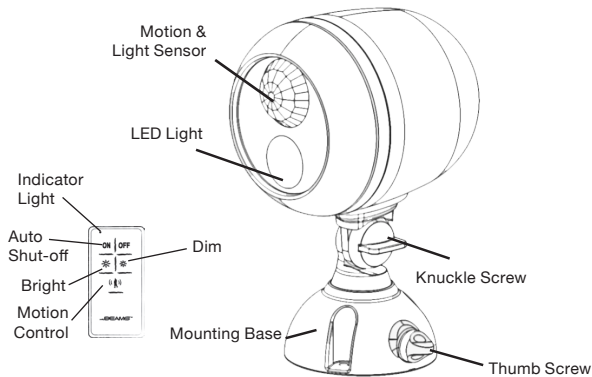

Spotlight features:

Fully Adjustable: Light can be rotated 360° as well as up and down

Light Coverage: up to 400 sq ft

Durable, Weather Resistant: Tight seals and UV resistant material allow the light to work in all weather conditions

Remote Control: Control from up to 70 ft away

What you need to install:

- 1 Small Screwdriver
- 3 D-Cell Alkaline Batteries

What is included per light:

- 1 Remote Controlled Spotlight
- Mounting Base
- 3 Screws & 3 Anchors
- 1 Remote Control with Mounting Bracket + 2 screws
- (1) 3V Coin Battery

Set up

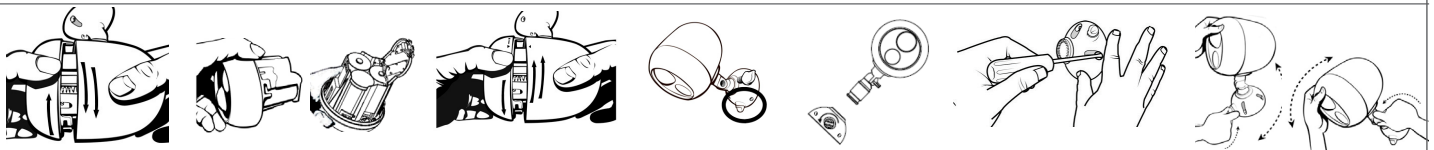

1. Remove front cover of Spotlight by rotating counter-clockwise as shown above. Pull face out from cup to reveal battery holder.

2. Push down on battery door tab to release. Insert 3 D-Cell batteries into Spotlight. Attach battery door by matching the tabs to the rectangular holes and then push down on front until door clicks into place.

3. Match arrows then turn clockwise. Make sure unit is securely closed with arrow pointing at the lock symbol to ensure weather proof seal is tight.

4. Determine location for mounting Spotlight. NOTE: For best performance, spotlight should be positioned so motion sensor is on top and light is on bottom.
5. Remove mounting base by turning thumb screw counter-clockwise.

6. Pull mounting base off stem.
7. Drive three screws into the three holes located on mounting base.
8. Insert spotlight stem back into mounting base pointed in desired direction and tighten thumb screw in base.

9. Loosen larger thumb screw that connects Spotlight head to mounting base and adjust Spotlight head to proper direction as shown above. Tighten thumb screw.

Remote Set-up

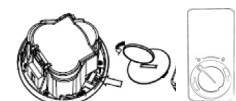

1. Open the Remote Control with a small coin and insert one flat 3V battery (included) as shown on the inside of the Remote Control. Smooth side of battery should be facing up.

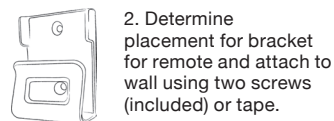

2. Determine placement for bracket for remote and attach to wall using two screws (included) or tape.

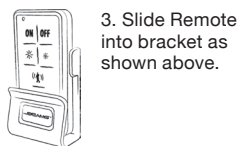

3. Slide Remote into bracket as shown above.

Syncing your light

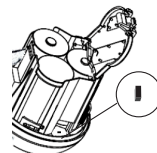

1. The remote is paired to work only with the Spotlight it is packaged with. To sync additional spotlights to a single remote, press the exposed black button on the spotlight next to the battery compartment for 3 seconds while pressing the ON button on the remote.

Customize Remote

Activation: Spotlight can be turned on or off with the remote control. Activating the remote will override the light sensor, and light can be activated at any time. Default auto shut-off mode is set for 30 seconds.

2 Auto Shut-off Options: First, activate light with remote. Next, hold the ON button down until light blinks. When it blinks 1x, auto shut-off is set to 1 hour. When it blinks 2x it is set for 4 hours.

3 Brightness Modes: First, activate the light with the remote control. Next, press the bright or dim button to adjust brightness. Brightness options are 60, 90, and 140 lumens.

Motion Sensor Activation: Spotlight will activate when motion is sensed from up to 30 ft away. Motion sensor only activates in darkness to conserve energy.

Disable Motion: Activate light with remote. Click the motion sensor button down until light blinks. When it blinks 2x the motion sensor has been disabled. When it blinks 4x, the motion sensor has been enabled. Light will remember your last motion setting.

Using the Remote

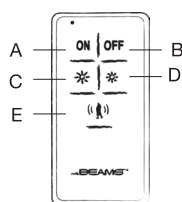

- A Turns on Remote/ Adjust Auto Shut-off
- B Turns off Remote
- C Increase Brightness
- D Decrease Brightness
- E Turn Motion Sensor On/Off

Tips:

- Use only new alkaline D-Cell batteries with 1.5V rating.
- Do not mix old and new batteries. If batteries are not new, it may cause light to malfunction.
- Install batteries with polarity in correct position.

Battery Caution:

- 1) Do not mix old and new batteries
- 2) Do not mix Alkaline, Standard (Carbon-Zinc) or Rechargeable (Nickel Cadmium or Nickel Metal Hydride) batteries
- 3) Do not dispose of batteries in fire
- 4) Batteries should be recycled or disposed of as per state and local guidelines

Patent # 8,203,445



* Visit our website to view installation video.

* 1 year limited warranty. Visit site for details.

32333 Aurora Rd. Suite 100 Solon, OH 44139
877.298.9082

MR BEAMS[®]
Surprisingly Bright Light Anywhere
www.mrbeams.com