

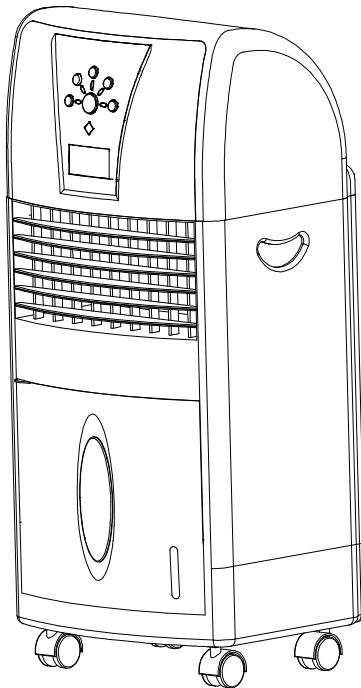

## Instruction Manual

### ***Evaporative Swamp Cooler***



It is important that you read these instructions thoroughly before using your new air cooler and we strongly recommend that you keep them in a safe place for future reference.

***Model No. SF-613***

---

# CONTENTS

|  |       |
|--|-------|
| TABLE OF CONTENTS .....                          | 1     |
| A. PRODUCT INTRODUCTION .....                    | 2     |
| B. TECHNICAL PARAMETER .....                     | 2     |
| C. CONTROL PANEL, LCD & CONSTRUCTION DIAGRAM --- | 3     |
| D. SELECTION OF FUNCTIONS .....                  | 4 ~ 5 |
| E. CARE AND MAINTENANCE .....                    | 5     |
| F. CAUTIONS .....                                | 6     |
| G. PACKING LIST .....                            | 8     |
| DEFECTIVE NOTICE .....                           | 8     |
| WARRANTY .....                                   | 9     |

---

## **A. PRODUCT INTRODUCTION**

SF-613 Air cooler is our latest design with microcomputer control system. It has device for storing water and ice cubes. It can lower surrounding temperature, freshen the air with equipped anion, humidify the air through the principle of water evaporation and melting ice. LCD panel makes it luxurious and easy to use. Also equipped with double-layered, filtration mesh water curtain to remove odor and dust. This unit will provide you a comfortable and healthy environment.

### **BRIEF INTRODUCTION OF FEATURES**

1. High-grade computer-control system with LCD panels.
2. Remote control.
3. Functions include: cool fan, humidifier, air filtration, and ionizer.
4. Energy-saving and effective, input power of cooler is 60W.
5. 0.5 to 7.5-hours timer control.
6. 3 fan speeds: High – Medium – Low.
7. Water tank for cooler air output.
8. Activated carbon removes odor.
9. Filter to remove harmful tiny substances, such as dust and pollen.

## **B. TECHNICAL PARAMETER**

| Main technical parameter |                         |
|--------------------------|-------------------------|
| Rating voltage frequency | 120V / 60Hz             |
| Input power              | 60W                     |
| Water consumption        | 0.5-0.6L/h              |
| Max air volume           | ≥20m <sup>3</sup> /min  |
| Fan Speeds               | 7.4 m/s                 |
| N. W.                    | 19.9 lbs                |
| Dimension (L x W x H)    | 14.5 x 11.5 x 31.75 in. |

## C. CONTROL PANEL, LCD DISPLAY AND CONSTRUCTION DIAGRAM

### 1. Control panel and functions (Same with remote controller)

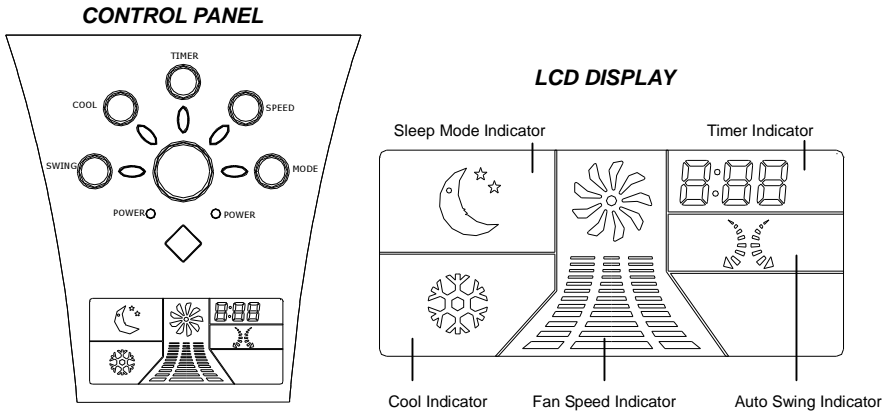

### 2. Construction diagram.

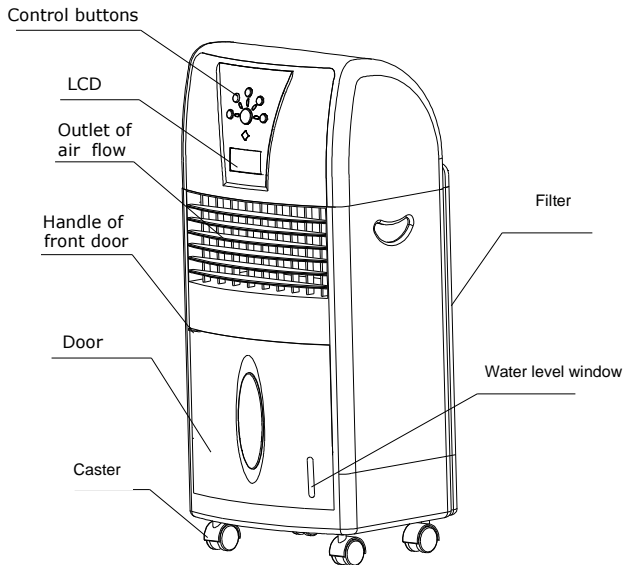

---

## **D. SELECTION OF FUNCTIONS**

1. ON/OFF: Turns unit ON or OFF
  - Press once to turn ON. Following indicator lights will illuminate: POWER, IONIZER, and SPEED. Unit operates in default High fan speed. LCD panel will display rotating fan at High speed.
  - Press again to turn OFF.
  - IONIZER turns on automatically when unit is powered on.
2. FLOW: Horizontal swing of vertical louvers.
  - Press once to engage auto swing of louvers. FLOW indicator light will illuminate and LCD panel will display auto swing indicator.
  - Press again for fixed air direction.
  - To directing vertical airflow, adjust the horizontal louvers manually.
3. Speed: Selects fan speed.
  - Press to select desired fan speed: High – Medium – Low, in turn. LCD panel will display the corresponding air speed.
4. Sleep: Unit operates according to preset computer program, alternating between different fan speeds.
  - Press to engage in Sleep Mode. SLEEP indicator will illuminate and LCD panel displays the sleep (moon) indicator.
  - To return to regular fan mode, press either SLEEP or SPEED button.
5. Cool: For cool air / humidify function.
  - Press once to start the evaporative cooling function. COOL indicator light will illuminate and LCD panel displays the cool (snowflake) indicator.
  - Press again to stop function and operate in regular fan mode.
  - Make sure water is added before turning on this function. Unit cycles the water to blow cool, humidified air.
  - Add ice to the water tank for added cooling.
6. Timer: Sets timer-off in increment of 0.5 hours.
  - Timer can be set between 0.5 to 7.5 hours.
  - TIMER indicator will illuminate and LCD panel will display the set time.
  - To remove timer and operate unit continuously, press button repeatedly until indicator light and display goes off.
7. Oxygen Bar with Negative ion.
  - Fan releases negative ions into the air.
  - Operates automatically when unit is turned on.

**NOTE:** Water must be added to the water tank before using the COOL function.

- Open the front door by the pulling gently on the handle.
- Add water to the tank. Do not overfill.
- For added cooling, add ice to the tank. (Fig. 1)
- Power supply should be disconnected before filling to prevent electrical parts from damage.

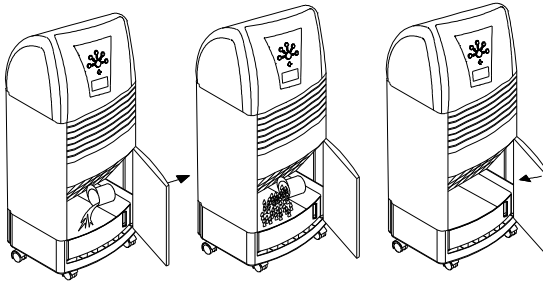
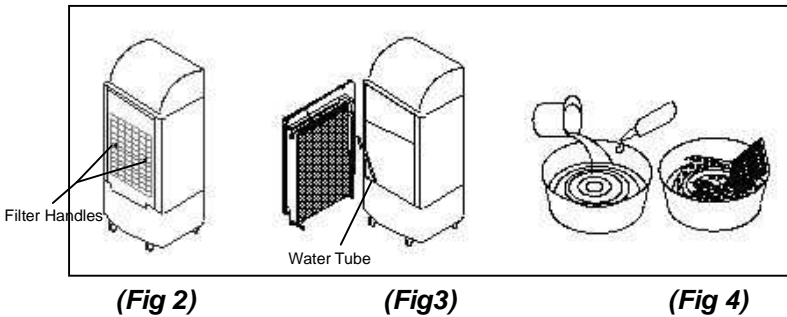

Fig 1

## E. CARE AND MAINTENANCE

*Always power OFF and unplug the unit before cleaning and maintenance.*

- Clean the housing with a damp cloth. Never spray water directly onto the housing or control panel/LCD or use harsh chemicals.
- After long time operation, the Filter and Water Curtain becomes clogged with dust and dirt, which will greatly affect the unit's performance. Sometimes mold and mildew may also occur, due to lack of water changes. It is recommended to clean the filter and water curtain once every two weeks.



---

### Cleaning the Dust Filter

1. Disconnect the power supply.
2. Push down on the two handles of the filter and pull outwards. (Fig 2)
3. Clean under lukewarm water and mild detergent.
4. Make sure filter is completely dry before operating unit.

### Cleaning the Water Curtain

1. Disconnect the power supply.
2. Remove the 3 screws located on the back frame: one in each top corner and one at bottom center. Do not remove back panel yet.
3. Panel is connected to the unit by a water tube, gently remove end of tube that is connected to the water pump. (Fig. 3) Remove back panel.
4. Remove water curtain by first removing the bottom rod – push in gently. Then remove from top rod by separating the Velcro attachment.
5. Wash water curtain in a mild detergent and warm water solution, then rinse in clean water. (Fig. 4)
6. Replace water curtain; make sure tube is firmly connected to the pump.

### Storage

If you plan not to use the unit for a long period of time, drain the water tank and wipe clean. Clean the filter and water curtain. Operate the unit in normal fan mode for approximately 30~60 minutes on a sunny day. This will dry the interior and prevent mold from growing. It is recommended to pack the unit in its original box and store in a dry, cool place

## **F. CAUTIONS**

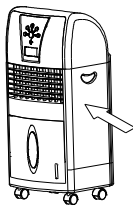

**(Fig. 5)**

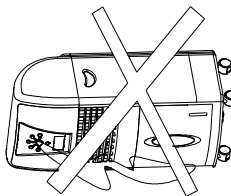

**(Fig. 6)**

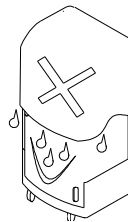

**(Fig. 7)**

1. Use normal supply of 120V / 60Hz. Plug into dedicated socket with minimum rating current of 3A.

2. After filling with water, do not tilt unit and avoid moving unit – which may cause water to overflow the sides of the tank and leak. If unit needs to be moved a little, push on the side gently. (Fig. 5)
3. Never turn the unit on its sides. (Fig. 6)
4. Do not place any heavy objects on top of the Air Cooler. The air outlet must not be obstructed. (Fig. 7)

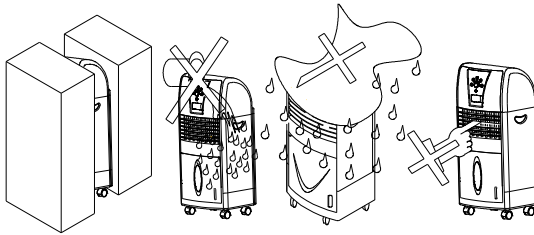

**Fig. 8**

**Fig. 9**

**Fig. 10**

**Fig. 11**

5. Keep a minimum space of 6 inches around the unit. (Fig. 8)
6. Suitable ambient temperature range is 68~104°F. The body of this Air Cooler should not be placed in area with extremely high or low temperature. When ambient temperature is high, change water frequently to prevent mildew and mold growth. (Fig. 9)
7. Never wet the unit or spray water onto the control panel or LCD. (Fig. 10)
8. Do not use any corrosive cleaner or solvent. (Fig. 11)
9. If using unit as a humidifier during cold weathers (below 32°F), be sure to empty and dry up the water tank after use to prevent water freezing. After emptying water from the drain, use a towel to suck up remaining water.
10. Empty the water tank before moving the Air Cooler.
11. Unplug power source when not in use.
12. Do not use the COOL function if unit is used in a damp and closed space.
13. Do not place fingers or insert foreign objects into the louver during operation.
14. Do not operate unit with a damage power cord or plug. Contact Sunpentown, do not attempt to repair on your own.
15. Basic precautions should be taken when operating unit near young children.
16. When operating in COOL mode, pay attention to water level and add water when water level is less than 1/3 full. Do not operate COOL mode on an empty tank, as this may cause water pump to malfunction.



**G. PACKING LIST**

| No. | NAME                | QUANTITY |
|-----|---------------------|----------|
| 1   | Air Cooler          | 1        |
| 2   | Remote Controller   | 1        |
| 3   | Instructions Manual | 1        |

***DEFECTIVE NOTICE***

If this product is defective or not working properly  
Please ***DO NOT*** return to your retail store

Please contact us directly with any Service or Technical Assistance

Contact us toll free at:

1-800-330-0388



## ***Your Guarantee***

If this product is found to be faulty as a result of faulty materials or workmanship within one year from date of purchase, it will be repaired free of charge.

This guarantee is subject to the following terms:

- Sunpentown must be notified of the fault.
- Proof of purchase must be presented to Sunpentown's nominated representative.
- The warranty will be void if the product is modified, misused or repaired by an unauthorized person.
- The warranty after repair will not be extended beyond the original one-year period.
- All replacement parts will be new or reconditioned.
- Parts, which are replaced, become the property of Sunpentown.
- The warranty applies for the use of the product in the USA only.

What is NOT COVERED:

- Warranty does not include freight charges.
- Incidental or consequential damage caused by possible defects with this product.
- Damage to product caused by improper power supply voltage, accident, fire, floods or acts of nature.
- Failure of product resulting from unauthorized modifications to the product.
- Improper installation or failure to perform the necessary maintenance.

This GUARANTEE is in addition to your Statutory Rights