

HARDWARE LIST

E		Metal Base W/Casters (1 pc)	
F		Hydraulic Rod Assembly (1 pc)	
G		4MM Allen Wrench	1 PC
H		Ø1/4" x 2-1/4"	2 PCS
I		Ø1/4" x 10MM	10 PCS
J		Ø1/4" x 17MM	4 PCS
K		Ø1/4" x 12MM	6 PCS
L		Ø1/4" x 12MM	4 PCS
M		12MM Wrench	1 PC
N		Barrel nut	2 PCS
O		Ø12.5MM Wood Plug	10 PCS
P		FA8 x 1-1/4"	4 PCS
Q		FA3 x 5/8"	5 PCS
R		14MM	1 PC
T		White Glue	1 PC
U		Ø1/4" x 2-1/2"	4 PCS

Be sure to check all packing material carefully for small parts, which may have come loose inside the carton during shipment. Separate, count and check all parts against the Components and Hardware List. **Failure to use the correct length bolts in the proper locations may result in an unsafe product and could also cause damage to the parts being assembled.**

PART LIST

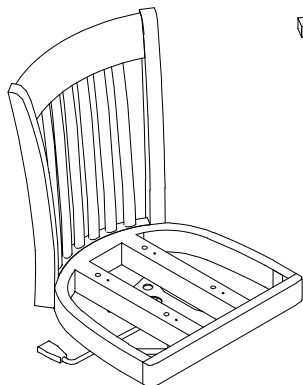

A Seat Frame and Back Frame (1 pc)

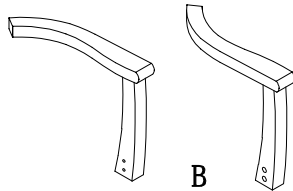

B Arm Rest (right & left) (2 pcs)

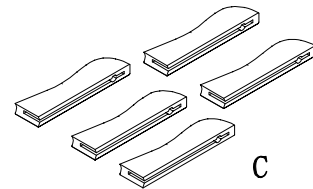

C Wood Cap (5 pcs.)

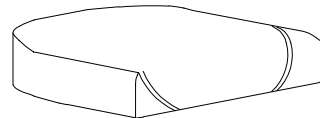

D Seat Cushion (1 pc)

Step 1: Place a Lock Washer (I) and 12mm Flat Washer (K) onto a 2 1/4" Long Bolt (H). Insert the bolt through a hole in the Back Frame, partially extended into the back end of the Arm. Insert a Barrel Nut (N) into the hole underneath the back end of the Arm. Place a screwdriver in the slot in the end of the barrel nut and rotate so that the bolt can be screwed into the barrel nut. Use the Allen Wrench (G) to tighten finger tight only, until after next step.

Step 2: Place a Lock Washer (I) and 12mm Flat washer (K) onto a 2 1/2" Long Bolt (U). Insert the bolt through a hole in the Arm, through the corresponding hole in the Seat Frame. Place a 17mm Flat Washer (J), Lock Washer (I) and Hex Nut (L) onto the bolt. Using the Allen Wrench (G) and Small Wrench (M) tighten all bolts connecting the Arms to the Seat & Back Frames. Repeat Steps 1 & 2 for other side of chair. Apply a small amount of White Glue (T) to a Wood Button (O) and press into the bolt holes.

Step 3: Turn the Seat Cushion (D) upside down and place it onto the corner of a table with the front edge facing inward. Carefully turn the chair assembly upside down and center it on the bottom side of Seat Cushion. Attach the Seat Cushion using the four 1 1/4" long Wood Screws (P) and your Phillips screwdriver.

Step 4: Attach the Wood Caps (C) on top of each leg of the Metal Base. Turn the chair base upside down and place it on a soft surface. Using a Phillips screwdriver install the 5/8" Wood Screws (Q) through the Metal Bracket (S) into pre-drilled holes of the Wood Caps (See the Diagram).

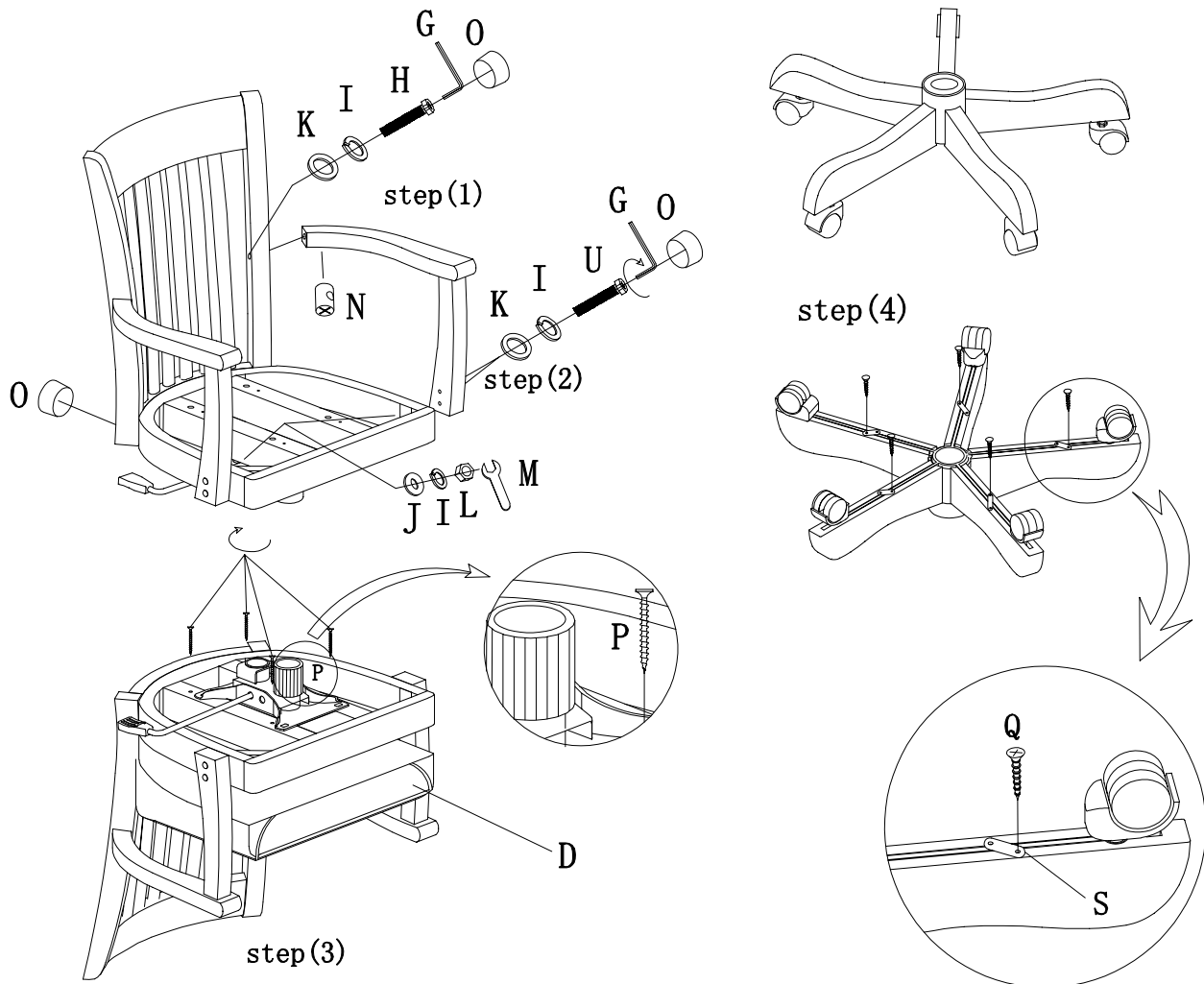

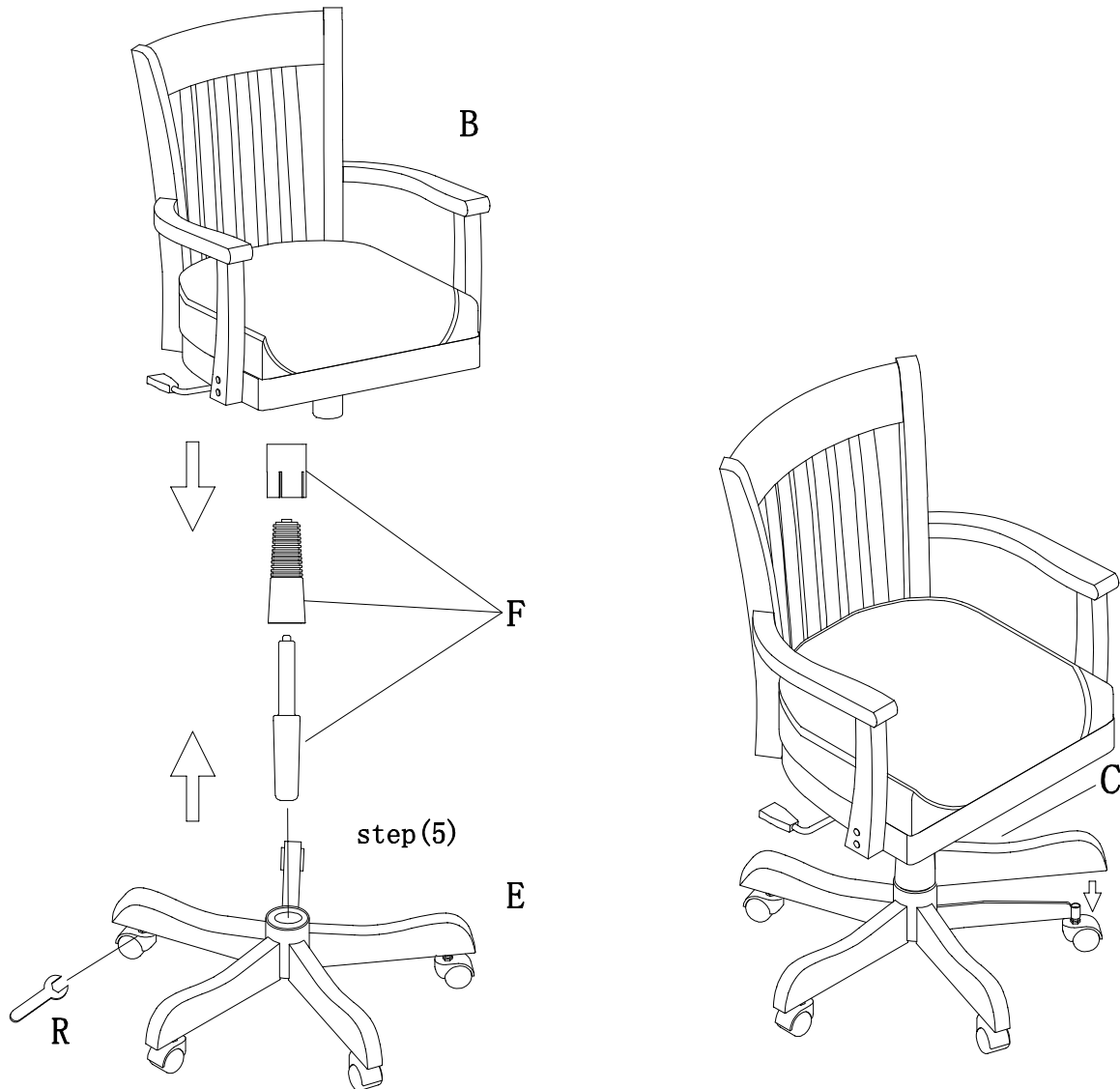

step 5: Insert the Hydraulic Rod (F) into the center hole in top of the Metal Leg Base (E). Place the other two black protective parts over the Hydraulic Rod in the order shown. Position the chair frame on the top end of the Hydraulic Rod and press down on the Chair Seat.

Note: The lift lever is in a locked position for shipping the chair. To unlock, pull the lever straight out and it can then be activated to raise or lower the chair.

How to care for your new purchase:

The touch of a soft cloth is all that is necessary for normal maintenance. Never use harsh chemicals or abrasive cleaning materials. The application of a good furniture polish periodically to all wood surfaces is suggested.

Your chair is equipped with casters for convenient mobility, however, to prevent possible damage to some types of flooring, such as hardwood or vinyl flooring, always use a floor protector underneath the chair.