

saxby
lighting



Vigor Flush

S5511

S5512

S5512EM

S5513

Thank you for purchasing this light fitting.
Please read the instructions carefully before use to ensure safe and satisfactory operation of this product.
Please retain these instructions for future reference.

Warning

This is a Class I product and must be earthed.

Please read these instructions carefully before commencing any work.
This unit must be fitted by a competent and qualified electrician.
Install in accordance with IEE Wiring regulations and current Building Regulations.
To prevent electrocution switch off at mains supply before installing or maintaining this fitting. Ensure other persons cannot restore the electrical supply without your knowledge. If you are in any doubt, please consult a qualified electrician.
This light fitting should be connected to a circuit with a 30mA RCD fitted.
If replacing an existing fitting, make a careful note of the connections.
Always use the correct type and wattage bulb. Never exceed the wattage stated.
When changing a bulb, always switch off at the mains and allow the old bulb to cool down before handling.
Dispose of used bulbs carefully and responsibly.
Waste electrical products should not be disposed of with household waste. Please recycle where facilities exist.
Check with your local authority or retailer for recycling advice.
This product is rated at IP44.
This product is not suitable for dimming.
This product is not suitable for location in or near a marine environment.
These products should not be fitted to PIR circuits or short duration timed switches. Should you wish to connect this unit to a timed system please consult the manufacturer before installation.
The entire unit gets hot whilst on for a period of time.

Specification

Voltage: 240V 50Hz a.c.
Lamp: 16W 2D 4Pin GR10q (S5511) 28W 2D 4Pin GR10q (S5512) 38W 2D 4Pin GR10q (S5513).
IP rating: 44

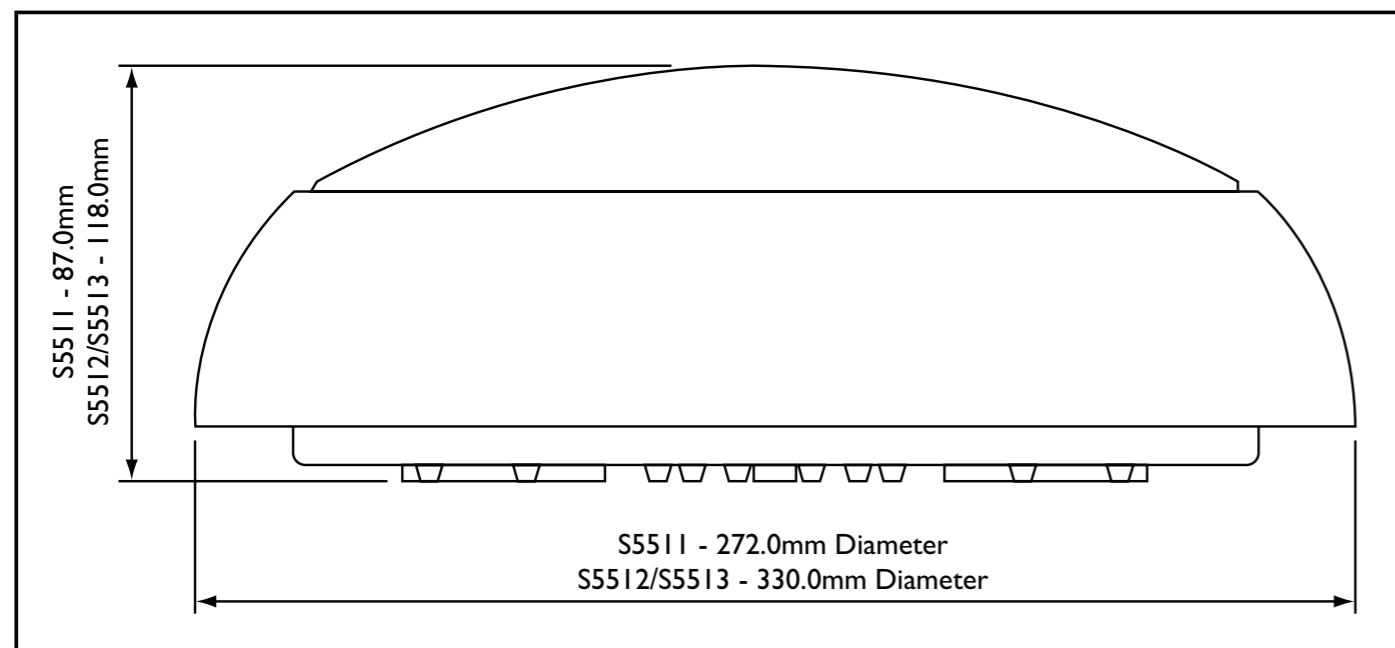

Layout

- Avoid locating any cables in positions that would cause a hazard. Position cables and outdoor rated junction boxes (not supplied) away from areas where they may be at risk from being cut, trapped or damaged.
- We recommend that you use H05RN-F specification cable (not supplied) which is an outdoor grade, rubber sheathed cable. The mains supply cable must have a minimum cross sectional area of 1.0mm²
- Cables must be protected using suitable conduit or plastic trunking.

Installation

Existing fittings must be completely removed before installation of a new product. Before removing the existing fitting, **carefully note the position of each set of wires.**

1. Remove the cover by twisting 45 degrees anti clockwise, and set aside. Carefully remove the lamp and set aside as well. Remove the gear tray and set aside.
2. Hold the product in place and mark the position of the holes.
3. Ensure the wall is capable of holding the weight of the product, or if fitting to a ceiling, ensure there is a joist at the point of fixing to support the weight of the product. Take care to avoid damaging any concealed wiring and pipes. The correct fixings should be used for brick, cavity walls or plasterboard.
4. Fix into position. Ensure that the screws are sealed to maintain the IP rating of the product.

Wiring

Having correctly identified the wiring from your existing light fitting, pull the wire through the hole and connect to the connection block inside the product in the following way:

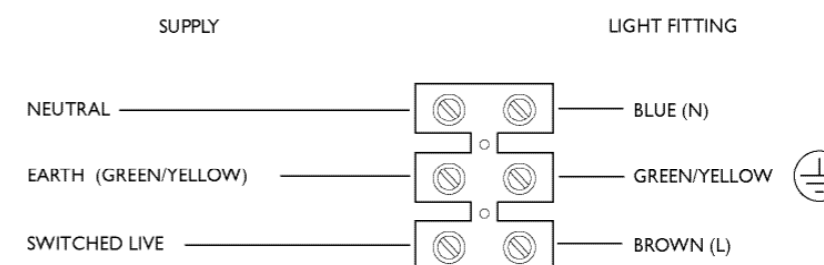

Check That

You have correctly identified the wires.
The connections are tight.
No loose strands have been left out of the connection block.

Commissioning

5. Refit the lamp in position.
6. Refit the shade into position.
7. Replace fuse or circuit breaker and switch on. Your light is now ready for use.

Fitting / Replacing Bulbs

For your safety, always switch off the light at the mains when cleaning, changing or removing the shade.
To remove: twist the shade anti-clockwise to remove.
When changing a bulb, always switch off at the mains and allow the bulb to cool before handling. Used bulbs should not be disposed of with household waste. Please recycle where facilities exist.
Always use the correct type and wattage bulb. Using the incorrect wattage bulb will damage the lamp and ballast.

S5511	:	16W 2D 4 Pin GR10q
S5512	:	28W 2D 4 Pin GR10q
S5512EM	:	28W 2D 4 Pin GR10q
S5513	:	38W 2D 4 Pin GR10q

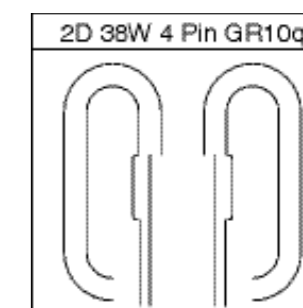
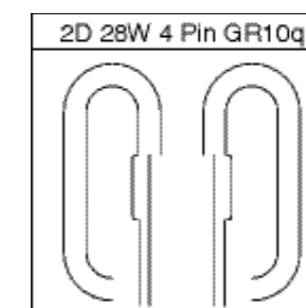
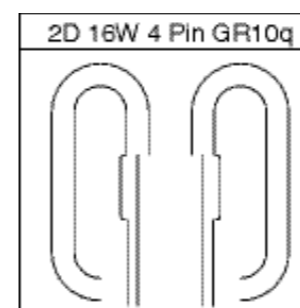

Alternative Trims

The products are supplied with a white trim. This can be interchanged for a chrome or satin silver finish trim.

S5511 - S5511CHTRIM or S5511SSTRIM

S5512 - S5512CHTRIM or S5512SSTRIM

S5512EM - S5512CHTRIM or S5512SSTRIM

S5513 - S5512CHTRIM or S5512SSTRIM

To fit, locate the three tabs as shown in figure 1. Using a screwdriver, as shown in figure 2, twist gently and pop the tab out. The other two tabs should release easily, allowing the bezel to be removed.

To refit the bezel, place the shade in the centre and carefully pop in the tabs to resecure the shade.

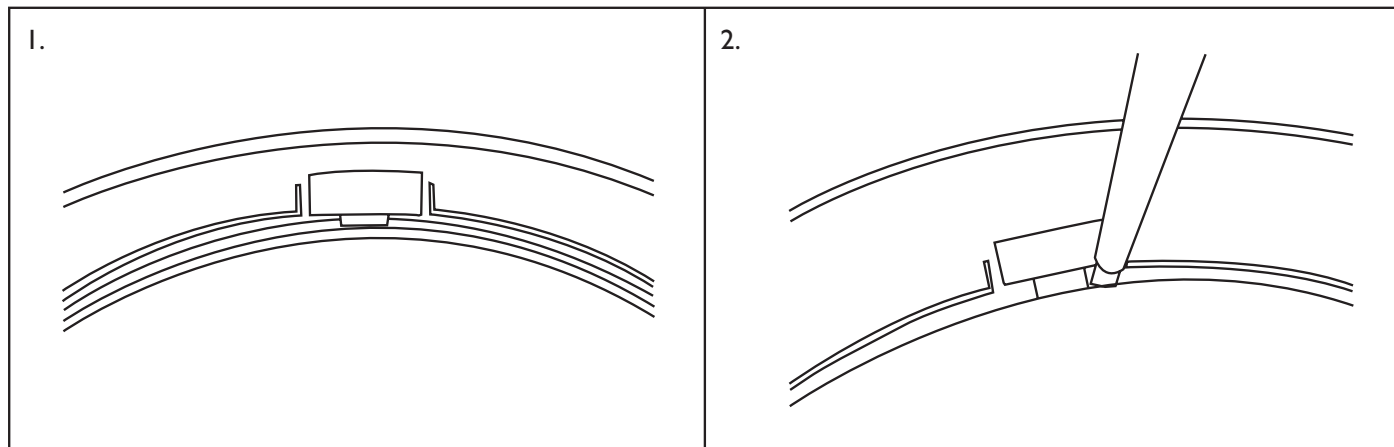

Care and Cleaning

We recommend cleaning with a soft dry cloth.

Do not use solvents or abrasive cleaners as these could damage the finish.

Do not clean the units with a pressure washer.

Recycling Advice



Waste electrical products should not be disposed of with household waste. Please recycle where facilities exist. Check with your Local Authority or retailer for recycling advice.

Safety Information

Live Voltages may be present in this unit even when turned off or when completely disconnected.

For your safety, always switch off the supply before changing lightbulbs, or cleaning.

This system contains non-replaceable parts and cannot be serviced. If damage occurs the part should be scrapped.

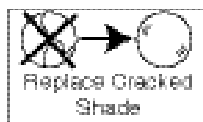

The shade must be replaced immediately should the shade become cracked or damaged. This fitting must not be used without the shade in place.



Saxby Lighting Ltd. BH23 3PE