

Check that...

- You have correctly identified the wires.
- The connections are tight.
- No loose strands have been left out of the transformer connection block.

Commissioning

- Link each fitting together using the plug connectors as shown in Fig 3.
- Ensure that the cables are secured in place using clips (not supplied) and are not positioned where they could create a hazard.
- Connector the transformer to the mains supply. Replace fuse and switch on.

Fitting/replacing bulbs

- When changing a bulb, always switch off at the mains and allow the bulb to cool before handling. Dispose of used bulbs carefully.
- Use a soft cloth to handle bulbs, avoid directly touching the bulbs as this will shorten their life. Do not exceed the wattage stated or use a different shape bulb from that indicated on the fitting.
- Using a small screwdriver, lever off the shade to access the bulb.
- Remove and replace bulb, and refit the shade in position.

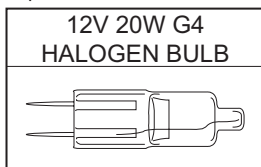

- Always switch off or disconnect from the mains when cleaning the product.
- We recommend cleaning with a soft dry cloth. Never use scourers, abrasives or chemical cleaners.
- Do not allow moisture to come into contact with electric parts.

Recycling advice

 Waste electrical products should not be disposed of with household waste. Please recycle where facilities exist. Check with your Local Authority or retailer for recycling advice.

Safety information

For your safety, always switch off the supply before changing lightbulbs, cleaning or removing shades.

Instruction leaflet

Firn Undercabinet

42850, 42851, 42852



saxby
lighting

Thank you for purchasing this light fitting. Please read the instructions carefully before use to ensure safe and satisfactory operation of this product. Please retain these instructions for future reference.

Warning



This product is Double Insulated and does not require connection to an Earth circuit.

Please read these instructions carefully before commencing any work.

This unit must be fitted by a competent and qualified electrician.

Install in accordance with IEE Wiring regulations and current Building Regulations.

To prevent electrocution switch off at mains supply before installing or maintaining this fitting. Ensure other persons cannot restore the electrical supply without your knowledge.

This light fitting should be connected to a fused circuit.

This system contains non-replaceable parts and cannot be serviced. If damage occurs the part should be scrapped.

This product cannot be dimmed.

This product is suitable for indoor use only, on normal flammable surfaces. It is designed for use under kitchen cupboards, bookshelves, cabinets etc. It is not suitable for use in bathrooms.

Ensure cables are routed to avoid accidental damage or hazard.

Waste electrical products should not be disposed of with household waste. Please recycle where facilities exist. Check with your local authority or retailer for recycling advice.

Specification

Voltage: 240V ~ 50Hz
Lamp: 3 x 20W G4 Halogen
IP rating: 20

Layout

- Plan the desired layout of these fittings carefully, ensuring the cables will reach the distances between the transformer to each unit.
- This product is designed for use under kitchen cupboards, bookshelves, cabinets etc. Suitable for indoor use only. Not suitable for bathrooms.
- Do not attach to surfaces which are damp, freshly painted or otherwise electrically conductive (e.g. metallic surfaces).
- The chosen location should allow for the product to be securely mounted and safely connected to the mains supply (240V wall socket).
- Ensure that there is adequate ventilation for the transformer.
- Avoid locating any cables in positions that would cause a hazard. Position cables and connector block away from areas where they may be at risk from being cut, trapped or damaged.
- Cables that are to be in walls must be protected using suitable conduit or plastic trunking.

Installation

Existing fittings must be completely removed before installation of a new product. Before removing the existing fitting, **carefully note the position of each set of wires.**

- Position the transformer next to the mains outlet that the system will connect to. Do not connect at this stage.
- After deciding the layout of the light fittings, ensure that the cables are long enough to connect to the desired positions.
- These fittings can be surface mounted using the supplied bezels or they can be recessed without the bezels.

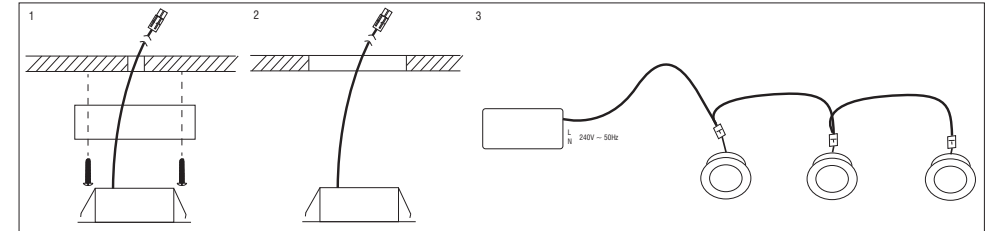

Surface Mounted (see Fig 1).

- Drill a 14mm diameter hole and pass the connector & wire through.
- Fix the surface mounted fitting to the cabinet using the screws provided.
- Push the fitting home so it is secured using the clips provided.

Recessed Fitting (see Fig 2).

- Cut a 58mm hole in the mounting surface.
- Feed the wire through the holes, and push the fitting home so it is secured using the clips provided.

Wiring

This unit is double insulated and must not be earthed.

- Remove the cover from the terminal block. The Brown wire must be connected to the terminal marked L. The Blue wire must be connected to the terminal marked N. Use a 3 Amp Fuse approved to BS1362.
- The appliance can also be fitted to a rewirable 3 pin plug fitted with a 3 amp fuse. Should the fuse require replacement, it must be replaced with a fuse rated at 3 amp and approved to BS1362.
- If the mains plug is unsuitable for the socket outlet or is removed for any other reason, then the cut off plug should be disposed of safely to prevent the hazard of electric shock.
- There is a danger of electric shock if the cut off plug is inserted into any 13 amp socket outlet.

- The wires in the mains lead on this appliance are coloured in accordance with the following code:
Blue – Neutral
Brown – Live
- Use a 3 Amp Fuse approved to BS1362.

