

Fitting/replacing bulbs

- When changing a bulb, always switch off at the mains and allow the bulb to cool before handling.
 - Used bulbs should not be disposed of with household waste. Please recycle where facilities exist.
 - Always use the correct type and wattage bulb. Using the incorrect wattage bulb will damage the bulb and ballast.
 - Select the correct lamp:
13908 3 x 14W T5 Fluorescent
13909 3 x 28W T5 Fluorescent
 - Slide the clips back, unhinge the reflector and set aside. See Figure 4.
9. Fit the lamp by aligning the pins in the slots and pushing gently in and rotating 90 degrees. See Figure 5.

- Refit the reflector into place and slide the clips back in position. See Figure 6.

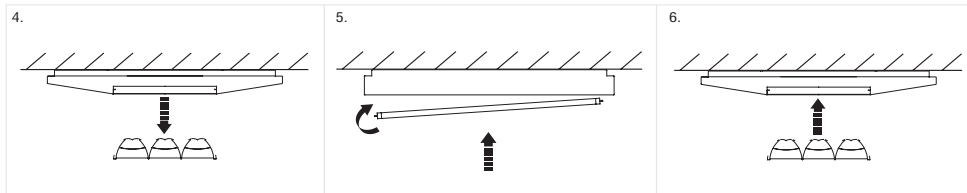
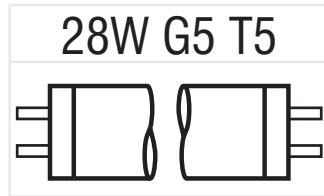
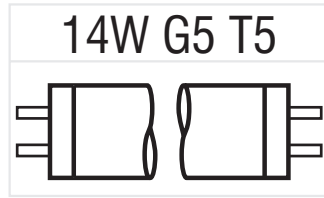

We recommend cleaning with a soft dry cloth. Do not use solvents or abrasive cleaners as these could damage the finish.

Shade – Use a damp cloth. Do not use abrasive materials as these will damage the finish.

Recycling advice



Waste electrical products should not be disposed of with household waste. Please recycle where facilities exist. Check with your Local Authority or retailer for recycling advice.

Safety information

Live Voltages may be present in this unit even when turned of or when completely disconnected. For your safety, always switch off the supply before changing lightbulbs, or cleaning.

Instruction leaflet

Paraport

13908, 13909

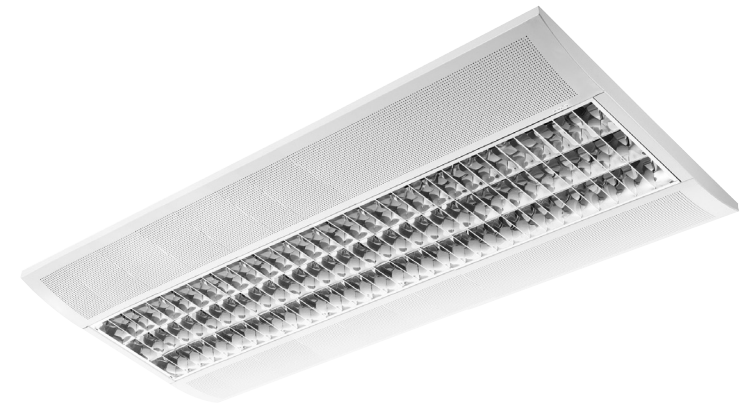

saxby
lighting

Thank you for purchasing this light fitting. Please read the instructions carefully before use to ensure safe and satisfactory operation of this product. Please retain these instructions for future reference.

Warning

This light fitting is Class 1 and must be connected to an Earth circuit.

Please read these instructions carefully before commencing any work.

This unit must be fitted by a competent and qualified electrician.

Install in accordance with IEE Wiring regulations and current Building Regulations.

To prevent electrocution switch off at mains supply before installing or maintaining this fitting. Ensure other persons cannot restore the electrical supply without your knowledge.

This light fitting should be connected to a fused circuit.

If replacing an existing fitting, make a careful note of the connections.

Always use the correct type and wattage bulb. Using the incorrect wattage bulb will damage the bulb and ballast.

When changing a bulb, always switch off at the mains and allow the old bulb to cool down before handling.

Dispose of used bulbs carefully and responsibly.

This product is not suitable for dimming.

This product should not be fitted to PIR circuits or short duration timed switches.

Waste electrical products should not be disposed of with household waste. Please recycle where facilities exist. Check with your local authority or retailer for recycling advice.

Specification

Voltage: 240V 50Hz a.c.
Lamp: 13908 3 x 14W T5 Fluorescent
13909 3 x 28W T5 Fluorescent
IP rating: 20

Layout

- Plan the desired layout of this fitting carefully, ensuring the cables will reach the distance between the junction box and the light fitting.
- Avoid locating any cables in positions that would cause a hazard. Position cables and junction boxes (not supplied) away from areas where they may be at risk from being cut, trapped or damaged.
- The mains supply cable must have a minimum cross

sectional area of 1.0mm².

- This product can be used with a suspension kit available separately.

Installation

Existing fittings must be completely removed before installation of a new product. Before removing the existing fitting, **carefully note the position of each set of wires.**

- Remove the reflector from the product by sliding the clips back and unhinging. See Figure 1.
- With the help of an assistant, lift the product into place and mark the position of the fixing holes.
- This must be securely attached to a main joist or other structure to support the weight. Ensure

the ceiling is capable of holding the weight of the product. Take care to avoid damaging any concealed wiring and pipes. The correct fixings should be used for brick, cavity walls or plasterboard.

- Using an assistant to hold the product in place lift into position and fix into position. See Figure 2.
- Pull the cable through the grommet and wire as detailed below.

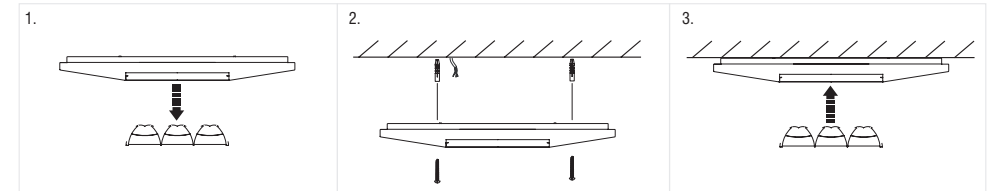

Wiring

Having correctly identified the wiring from your existing light fitting, pull the wire through the hole and connect to

the connection block inside the product in the following way:

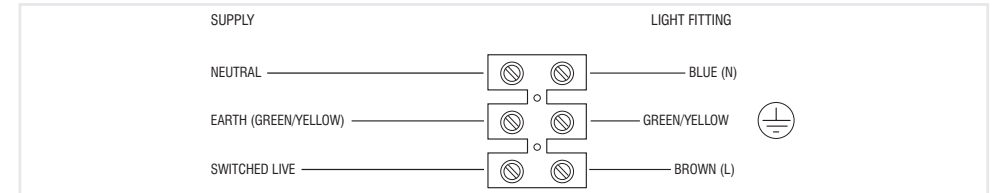

Check that...

- You have correctly identified the wires
- The connections are tight
- No loose strands have been left out of the connection block.

Commissioning

- Refit the reflector into place and slide the clips back into position. See Figure 3.
- Replace fuse or circuit breaker and switch on. Your light is now ready for use.