

## Fitting/replacing bulbs

- The LED's in this product are non replaceable

- We recommend cleaning with a soft dry cloth. Do not use solvents or abrasive cleaners as these could damage the finish.
- Glass parts – Wipe with a damp cloth. Do not use abrasive materials as these will damage the finish.

## Recycling advice



Waste electrical products should not be disposed of with household waste. Please recycle where facilities exist. Check with your Local Authority or retailer for recycling advice.

## Safety information

For your safety, always switch off the supply before changing lightbulbs, or cleaning.

## Instruction leaflet

# Orbita COB Recessed

46398, 46399



CE

saxby  
lighting

Iss.1 26102012

Thank you for purchasing this light fitting. Please read the instructions carefully before use to ensure safe and satisfactory operation of this product. Please retain these instructions for future reference.

## Warning

**This light fitting is Class 3 and requires an LED Driver to work.**

Please read these instructions carefully before commencing any work.

This unit must be fitted by a competent and qualified electrician.

Install in accordance with IEE Wiring regulations and current Building Regulations.

This system operates at Safety Extra Low Voltage, via an LED driver. Never connect the light fittings directly to the mains without using an LED driver.

To prevent electrocution switch off at mains supply before installing or maintaining this fitting. Ensure other persons cannot restore the electrical supply without your knowledge.

This light fitting must be connected to a fused circuit.

If replacing an existing fitting, make a careful note of the connections.

This fitting must always be fitted to a plasterboard ceiling. This must not be fitted to a plaster and lathe ceiling

This system contains non-replaceable parts and cannot be serviced. If damage occurs the part should be scrapped.

This product is suitable for dimming using the correct LED driver and a suitable dimmer switch.

Waste electrical products should not be disposed of with household waste. Please recycle where facilities exist. Check with your local authority or retailer for recycling advice.

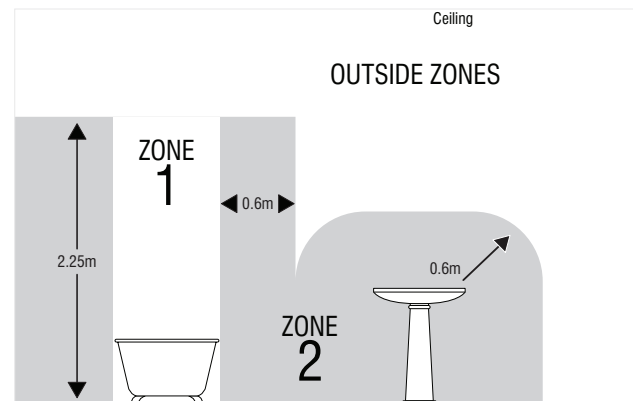

When used with the 42914 bezel, this product is suitable for use in Zone 1 and Zone 2. Other Bezels are outside Zones **ONLY** in a bathroom. See diagram.

If this unit is being fitted in a room containing a bath or shower, a 30mA RCD must be used - in accordance with IEE regulations.

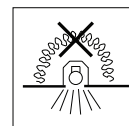

Ensure free movement of air around the fitting by removing any roof void insulation from at least 150mm around the hole. Under no circumstances must these fittings be covered with insulating matting or similar material.

## Specification

Supply: LED Driver 350mA Constant Current  
 Lamp: 46398 - 1 x 14W COB LED 3000K  
 46399 - 1 x 14W COB LED 4000K  
 IP rating: 20

## Layout

- Plan the desired layout of these fittings carefully, ensuring the cables will reach the distances between the transformer and each light fitting.
- Ensure that there is adequate ventilation for the LED driver.
- Avoid locating any cables in positions that would cause a hazard. Position cables and junction boxes (not supplied) away from areas where they may be at risk from being cut, trapped or damaged
- The mains supply cable must have a minimum cross sectional area of 1.0mm<sup>2</sup>
- The distance between units must be 0.5m minimum.
- The unit must be located 0.2m away from a joist.
- This product must be mounted out of arms reach.
- This product has no special protection against the ingress of moisture unless the IP rated heads (42914 & 45543) are used.

## Ceiling Preparation

Existing fittings must be completely removed before installation of a new product. Before removing the existing fitting, **carefully note the position of each set of wires.**

- This product has been designed to be used with the four alternative bezels available. It cannot be used with other recessed heads.
- Check that the installation holes do not foul any pipes, mains cables or joists beneath the surface. Cut the diameter of the hole as given below:
- 42912 – 70mm diameter
- 42913 – 70mm diameter

- 42914 – 70mm diameter
- 43252 – 90mm diameter
- 45543 – 70mm diameter
- We recommended cutting the hole slightly smaller than the size specified, and then file the hole until the bezel fits snugly.
- Ensure that the void depth is a minimum of 150mm.
- Under no circumstances must these fittings be covered with insulating matting or similar material. See Fig. 1.** Ensure free movement of air by removing void insulation from at least 150mm from around the hole. See Fig. 2

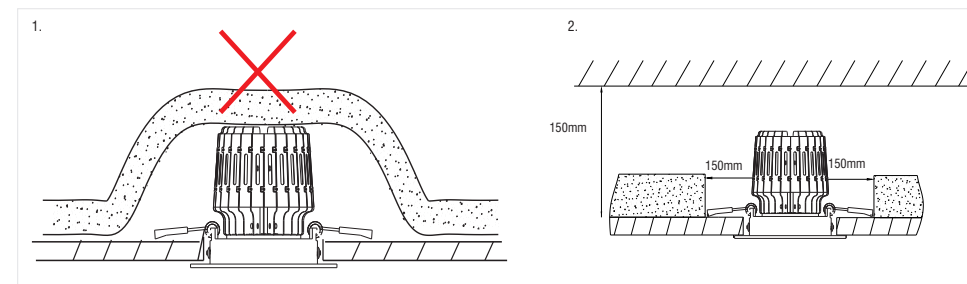

- Unscrew the protective ring from the front of the bezel. See Fig 3.

- Screw the chosen bezel onto the front of the Orbita LED unit. See Figures 4 & 5. Take care not to cross the thread.

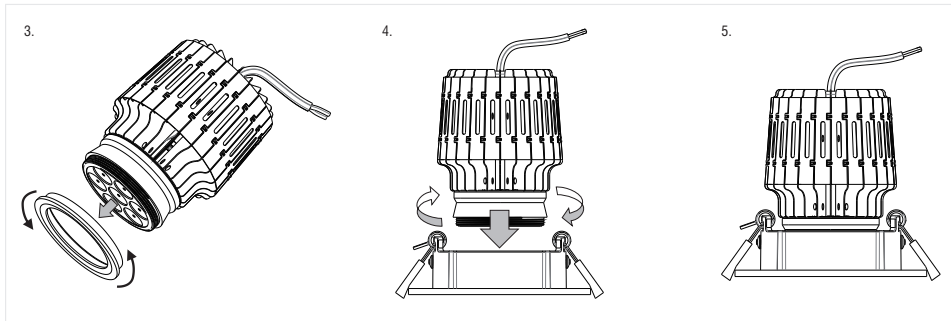

## Mains Wiring

This unit has been designed to work with the following power supplies:

46896 – Orbita COB LED Driver

46897 – Orbita COB LED Dimmable Driver

The dimmable driver is compatible with most dimmers. However, we would recommend that you test the product and driver with the dimmer prior to installation.

The LED Drivers are double insulated and must not be

earthed. If there are any incoming earth cables, they must be joined together and well insulated with good quality insulation tape. This is to ensure earth continuity throughout your property.

Remove the cover from the mains terminals and having correctly identified the wiring from your existing light fitting, pull the mains wiring through the hole and connect to the connection block inside the LED driver in the following way:

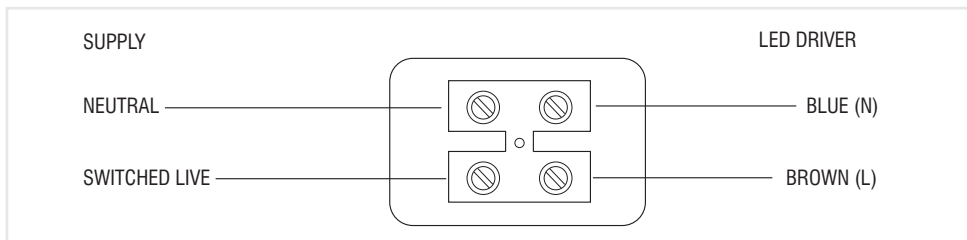

## Check that...

- You have correctly identified the wires.
- The connections are tight.
- No loose strands have been left out of the connection block.
- That the cover over the mains terminals has been replaced.

## Low Voltage Wiring

**This Orbita LED product is Class 3 and must only be used inconjunction with a recommended driver. It must not be connected directly to the mains supply.**

Ensure that you have the polarity correct. If the product is incorrectly connected then it will not light and may be damaged when turned on.

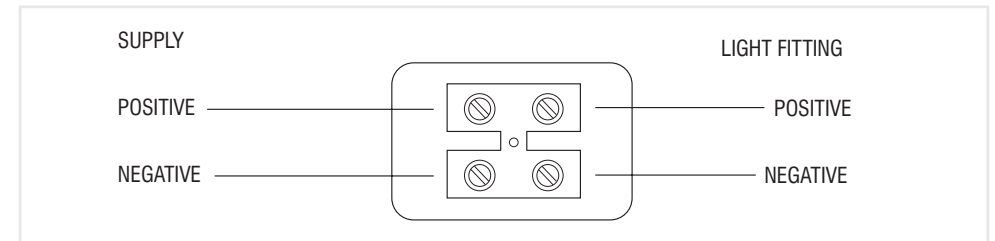

## Check that...

- You have correctly identified the wires.
- The connections are tight.
- No loose strands have been left out of the connection block.

## Commissioning

- The ceiling surface must be flat and smooth to ensure a good fit.
- Push the spring clips upwards and fit into the ceiling hole. See Fig. 6.
- Push the unit up until firmly in position, ensuring that no cables are trapped. See Fig. 7.
- Ensure that the LED driver is sitting away from the unit and has good ventilation.
- Ensure that the product is sitting properly in the hole.
- Replace fuse or circuit breaker and switch on. Your light is now ready for use.

