

## ASSEMBLY INSTRUCTIONS: 24" D SEMI-RECESSED WORKSTATIONS (F6SR)

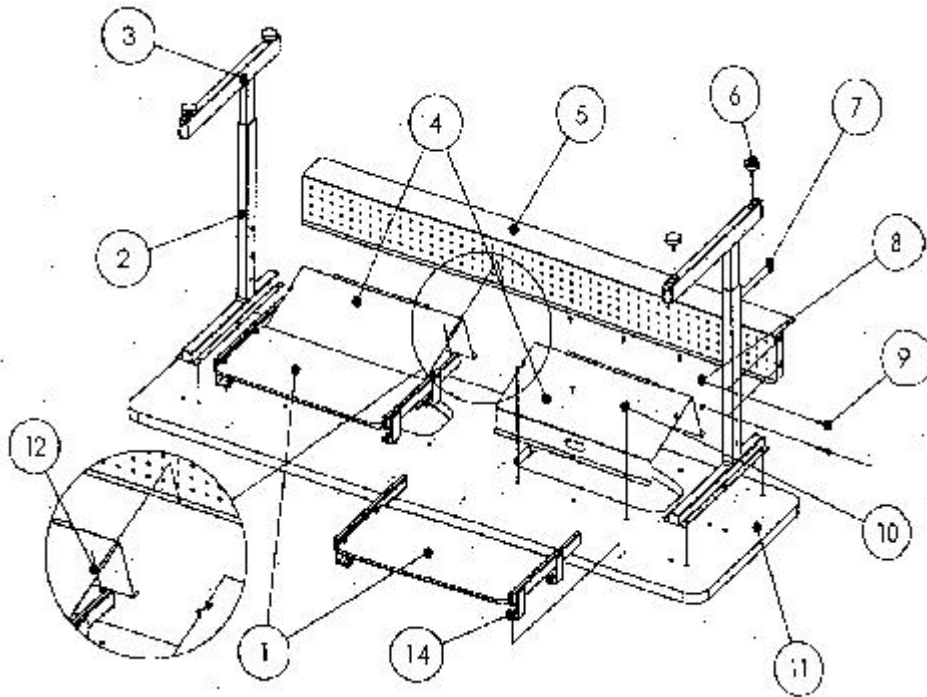

HARDWARE		
QUANTITY	PART NUMBER	DESCRIPTION
4	1010530	FLOOR GLIDE
2	1010535	RUBBER GROMMET
4	1010541	3/8-16 X 1/2" SET SCREW
4	1010545	10/32 LOCKNUT
1	1010549	3/16 HEX KEY
4	1010550	1/4-20 LOCKNUT
28	1010555	10/32 X 1/2" MACHINE SCREW
4	1010566	1/4-20 X 1 3/4" MACHINE SCREW

OTHER TOOLS REQUIRED: CORDLESS HAND DRILL WITH TORQUE CONTROL, PHILLIPS DRIVE BIT, PHILLIPS SCREW DRIVER, AND 7/16" WRENCH.

### INSTRUCTIONS

1. Preassemble keyboard trays per their separate instructions and hardware.
2. Lay top face down on a clean, scratch free surface.
3. Install keyboard trays using hardware provided with the keyboard tray and the cordless screw gun. Set the torque control to the lowest setting to fully drive the screws into the top without over tightening. Over tightening will cause the screw to strip, damaging the top.
4. Fully extend the keyboard tray and place the FPSR tub over the corresponding hole patterns. Tighten the FPSR tub to the top using the 10/32 X 1/2" machine screws.

5. Insert two floor glides into each leg foot in the designated locations.
6. Install two 3/8-16 X 1/2" set screw into leg upper into two extruded holes located on the back side of the leg upper. Insert leg lower into leg upper and tighten to the desired leg height using 3/8-16 X 1/2" set screw. Use the 3/16 hex key to tighten the set screws.
7. Place the assembled legs over the corresponding holes and tighten using six #10 X 1/2" machine screws per leg.
8. Attach the chase to the legs using two 1/4-20 X 1 3/4" machine screws and secure them with 1/4-20 locknuts using a 7/16 wrench. Attach the chase to the FPSR tub using two #10 X 1/2" machine screws and 10/32 locknuts per tub and tighten securely.
9. Turn the fully assembled table over and adjust the floor glides until the table is completely level.

NOTE: When moving this table, do not push, pull, or drag the table. With help, pick the table up to move.