

OWNER'S MANUAL



Grillin' Pro Model # 3001

LP Gas Grill



A propane gas cylinder is required for operation. This gas grill is not intended for commercial use.

SAVE THESE INSTRUCTIONS FOR FUTURE REFERENCE. IF YOU ARE ASSEMBLING THIS UNIT FOR SOMEONE ELSE, GIVE THIS MANUAL TO HIM OR HER TO SAVE FOR FUTURE REFERENCE. FOR CUSTOMER SERVICE, CALL 912-638-4724

WARNING:

Improper installation, adjustment, alteration, service or maintenance could cause injury or property damage. Read the installation, operation and maintenance instructions thoroughly before assembling or servicing this equipment.

Keep your receipt with this manual for Warranty.



WARNING

For Outdoor Use Only
(outside any enclosure)

DANGER:

DO NOT use gas grill for indoor cooking or heating. TOXIC fumes can accumulate and cause asphyxiation. Do not use in or on boats or recreational vehicles.

PROP 65 WARNING:

Chemicals known to the state of California to cause cancer, birth defects or other reproductive harm are created by the combustion of propane.





If you smell gas:

1. Shut off gas to the appliance.
2. Extinguish any open flame.
3. Open Lid.
4. If odor continues, keep away from the appliance and immediately call your gas supplier or your fire department.



Do not store or use gasoline or other flammable liquids or vapors in the vicinity of this or any other appliance.

An LP cylinder not connected for use shall not be stored in the vicinity of this or any other appliance.

For Your Safety

Stop! Call us first! Do Not return product to store. This grill has been made to high quality standards. If you have any questions not addressed in this manual or if you need parts please call our customer service department at 1-912-638-4724 (USA), Monday-Friday 8:30am-5pm (EST).

Have your grills serial number (located on the back of the grill body or on the leg) when calling.

Table of Contents

Important Safety Information	page 4 - 5
Illustrated Parts List	page 6 - 7
Tools, Assembly Tips and Hardware List	page 8
Assembly Instructions	page 9 - 17

Operating Grill

Connecting Gas Cylinder.....	page 18
Cleaning and Care.....	page 19-20
Checking for Leaks.....	page 21
Lighting Grill.....	page 22-24
Trouble Shooting.....	page 25-26
Grill Preparation.....	page 27
Recipes.....	page 28 - 29
Accessories.....	page 30 - 31

WARNING

FOR YOUR SAFETY

1. DO NOT store or use gasoline or any other flammable vapors and liquids within 25 feet (8m) of this or any other appliance.
2. When cooking with oil/grease, do not allow the oil/grease to exceed 350 °F (177 °C). Do not store or use extra cooking oil in the vicinity of this or any other appliance.
3. An LP Cylinder not connected for use should be stored a minimum of 10 feet (3m) away from this or any other appliance. Never fill the cylinder beyond 80 percent full. If the above information not followed exactly, a fire causing death or serious injury may occur.
4. If you smell gas:
 - Shut Off gas to the grill.
 - Extinguish any open flame.
 - Open Lid

For Your Safety

Stop! Call us first! Do Not return product to store. This grill has been made to high quality standards. If you have any questions not addressed in this manual or if you need parts please call our customer service department at 1-912-638-4724 (USA), Monday-Friday 9am-5pm (EST).

NOTE: The use and installation of this product must conform to local codes. In absence of local codes, use the National Fuel Gas Code, ANSI Z223.1/NFPA54.

IMPORTANT NOTICE: read all instructions prior to assembly and use.

Read and understand all warnings and precautions prior to operating your grill.

CAUTION

1. This grill is for use with propane gas only (propane gas cylinder not included).
2. Never attempt to attach this grill to the self-contained propane system of a camper trailer, motor home or house.
3. Never use charcoal or lighter fluid with the gas grill.
4. Do not use gasoline, kerosene or alcohol for lighting. The LP-gas supply cylinder must be constructed and marked in accordance with the specifications for propane gas cylinders of the U.S. Department of Transportation (DOT) CFR 49. This grill is not intended to be used in or installed on recreation vehicles and/or boats.
5. Do not attempt to move the grill while it is lit.
6. Do not use the grill unless it is completely assembled and all parts are securely fastened and tightened.
7. Keep all combustible items and surfaces at least 36 inches (91.4cm) away from grill at all times.
8. DO NOT use this grill or any gas product near unprotected combustible constructions.
9. Do not use in an explosive atmosphere. Keep grill area clear and free from combustible materials, gasoline and other flammable vapors and liquids.

10. Do not touch metal parts of grill until it has completely cooled (about 45 minutes) to avoid burns, unless you are wearing protective gear (BBQ mittens, pot holders, etc.)
11. Do not alter this grill in any manner
12. Clean and inspect the hose before each use. If there is evidence of abrasion, wear, cuts, or leaks, the hose must be replaced prior to operating the appliance. The replacement hose assembly will be that which is specified by the manufacturer.
13. Move gas hoses as far away as possible from hot surfaces and dripping hot grease.
14. Never keep a filled container in a hot car or car trunk. Heat will cause the gas pressure to increase, which may open the relief valve and allow gas to escape.
15. Keep the grill's valve compartment, burners and circulating air passages clean. Inspect the grill before each use.

WARNING

1. This grill is for outside use only, and should not be used in a building, garage or any other enclosed area.
2. The use of alcohol, prescription or non-prescription drugs may impair the operator's ability to properly assemble or safely operate the grill.
3. Always open grill lid slowly and carefully as heat and steam trapped within the grill can burn you severely.
4. Always place your grill on a hard, level surface far away from combustibles. An asphalt or blacktop surface may not be acceptable for this purpose.
5. Do not leave a lit grill unattended. Keep children and pets away from the grill at all times.
6. Do not place this grill on any type of tabletop surface.
7. Do not use the grill in high winds.
8. Disconnect the propane tank (LP tank) by first turning off valve on top of propane tank, turn off burner valves, then disconnect regulator from valve on propane tank by turning plastic connector counter clockwise. Unscrew wing-bolt in bottom shelf to release the tank for removal.

DANGER

Liquid propane (LP) gas is flammable and hazardous if handled improperly. Know its characteristics before using any propane product.

1. Propane Characteristics; Flammable, explosive under pressure, heavier than air and settles in pools and low areas
2. In its natural state, propane has no odor. For your safety, an odorant has been added.
3. Contact with propane can cause freeze burns to skin.
4. This grill is shipped from the factory for propane gas use only.
5. Never use a propane cylinder with a damaged body, valve, collar or footing.
6. Dented or rusted propane cylinders may be hazardous and should be checked by your propane gas supplier.

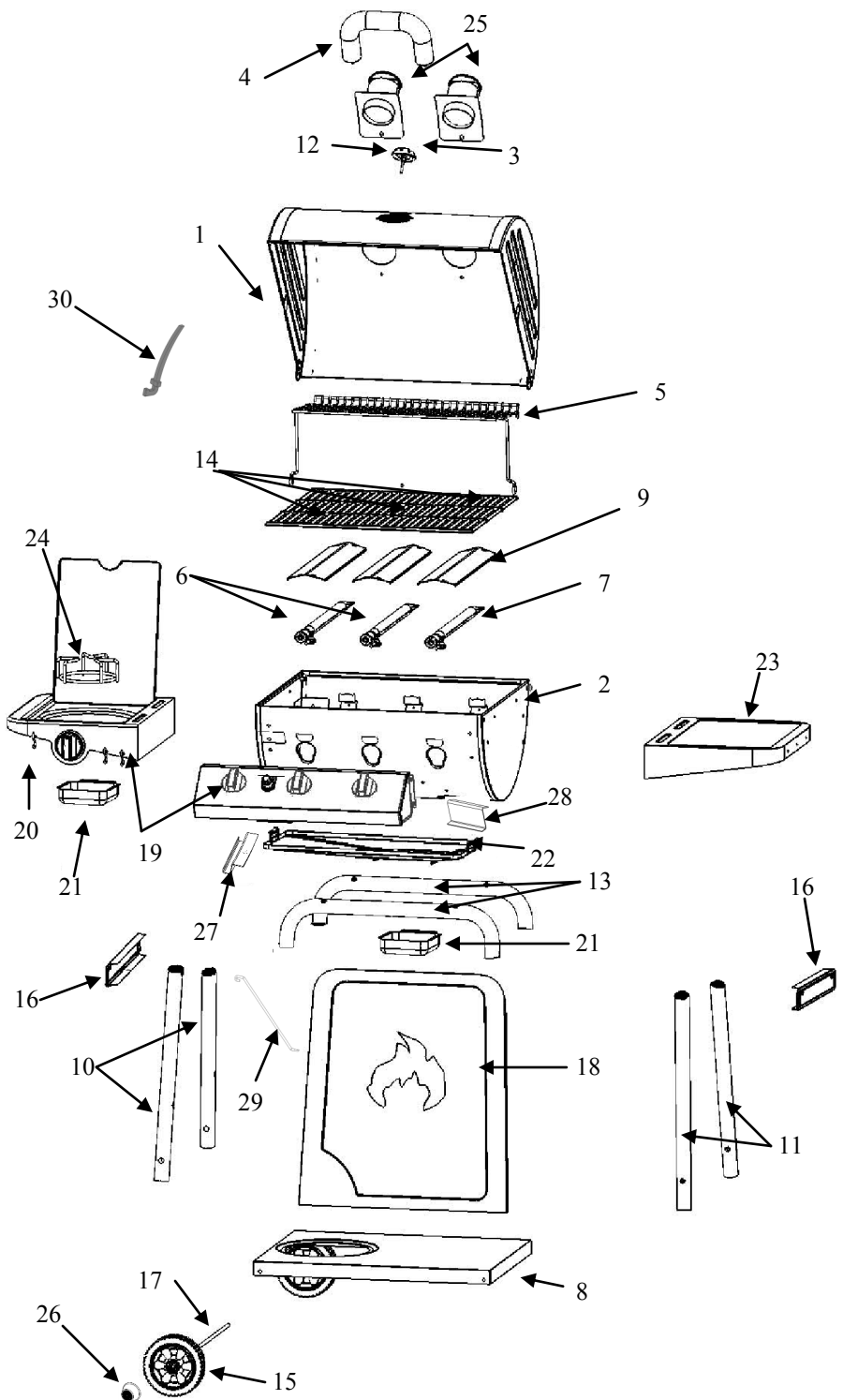

LINE ITEM	QTY	PART NAME	PART NUMBER
1	1	HOOD	30-0009
2	1	GRILL BODY	30-0010
3	1	THERMOMETER	55-0008
4	1	HOOD HANDLE	55-0009
5	1	WARMING RACK	20-0001
6	2	BURNER (short wire)	80-0005
7	1	BURNER (long wire)	80-0006
8	1	BASE	20-0029
9	3	FLARE-UP SHIELD	10-0001
10	2	SHORT LEG	10-0022
11	2	LONG LEG	10-0023
12	1	BEZEL	10-0016
13	2	LEG CROSS BAR	10-0024
14	3	COOKING GRATE	10-0006
15	2	WHEEL	55-0003
16	2	LEG BRACE	10-0025
17	1	AXLE	10-0026
18	1	FRONT PANEL	10-0027
19	1	SIDE BURNER/ CONTROL PANEL	80-0013
20	3	UTENSIL HOOK	50-0002
21	1	GREASE TRAY	10-0028
22	1	CATCH PAN, REMOVABLE	20-1025
23	1	SIDE SHELF	20-0033
24	1	POT STAND	20-0005
25	2	STACK	20-0034
26	2	HUB CAP	55-0007
27	1	STOPPER BRACKET	10-0360
28	2	SLIDER BRACKET	10-0359
29	1	TANK BLOCK BAR	10-0283
30	1	GRATE LIFTER	10-0045

Assembly: Requires 2 people. Get another person to help.

Tools Needed: Pliers, Phillips Head Screwdriver and a 7/16" Nut Driver.

NOTE: Do Not tighten any bolts unless instructed to do so. Tightening too soon may prohibit parts from fitting together. All Hex Nuts should be on the inside of the grill unless stated otherwise. Unpack all contents in a well cleared and padded area.

STOP! Do Not Return to Store. If you are missing parts or need assistance please email us at info@chargriller.com or call 912-638-4724. Do not attempt assembly if you are missing parts.

Hardware:

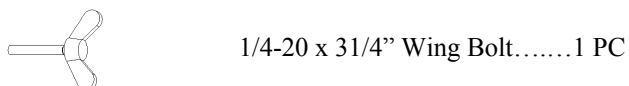
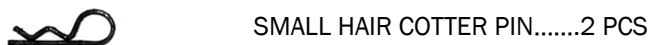
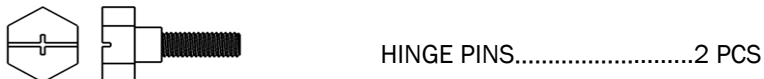
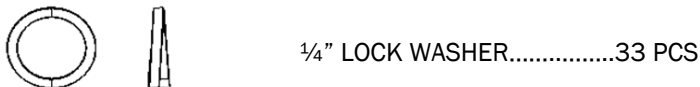
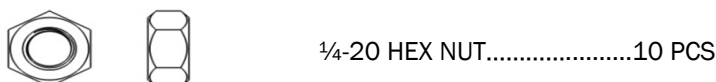
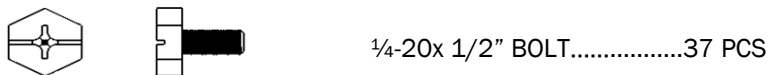
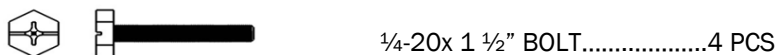

Assembly Instructions

Step 1

Attach the LONG LEGS and SHORT LEGS to the base, opposite the tank well/hole with two (2) lock washers $\frac{1}{2}$ " Bolts as shown below.

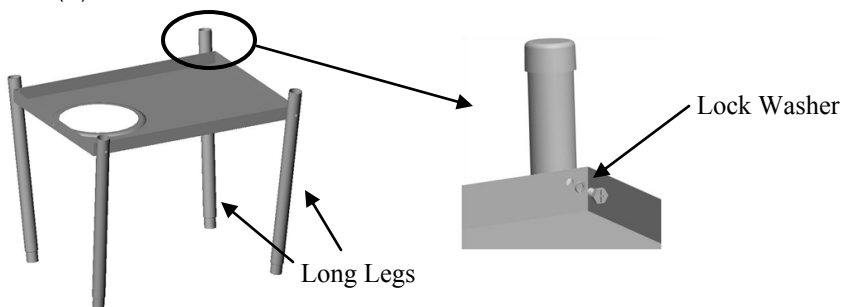

Step 2

Insert the LEGS into the LEG CROSS BARS as shown below.

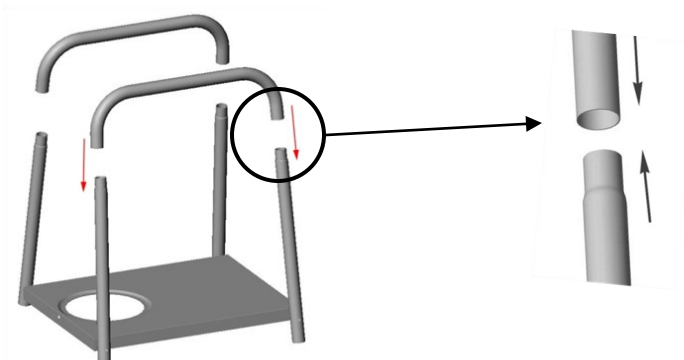

Step 3

Insert the AXLE through the SHORT LEGS and through the BASE. Install one WASHER, COTTER PIN and HUB CAP onto the AXLE then slide the AXLE through WHEELS and legs as shown. Finish by attaching 2nd WASHER, COTTER PIN and HUB CAP.

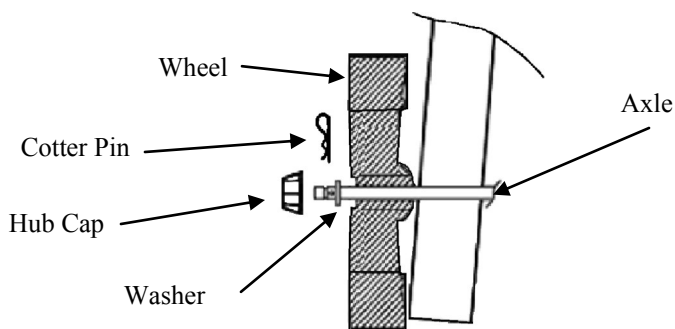

Step 4

Install the two (2) LEG BRACES to the LEGS using eight (8) LOCK WASHERS and eight (8) 1/2" BOLTS as shown. Remember to NOT tighten the bolts until the grill is completely assembled.

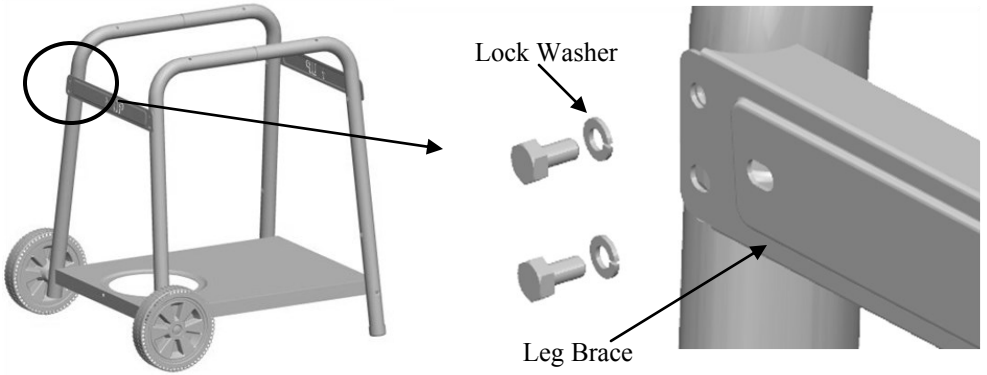

Step 5

Attach the FRONT PANEL to the inside of the front LEGS using four (4) LOCK WASHERS and 1/2" BOLTS as shown below. Then install the CYLINDER BLOCK BAR as shown using (1) 1/2" long BOLT, LOCK WASHER and FLAT WASHER as shown in step 6 also...

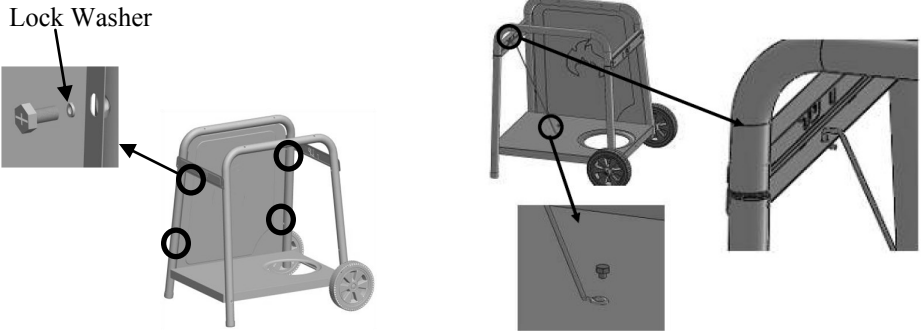

Step 6

Attach the GRILL BODY to the LEGS using four (4) LOCK WASHERS, four (4) 1/2" BOLTS and four (4) FLAT WASHERS. Make sure to insert the bolt first through the lock washer then the flat washer then through the grill body. You may need to loosen other bolts and move the GRILL BODY slightly to get the holes in the GRILL BODY to line up with the holes in the LEGS.

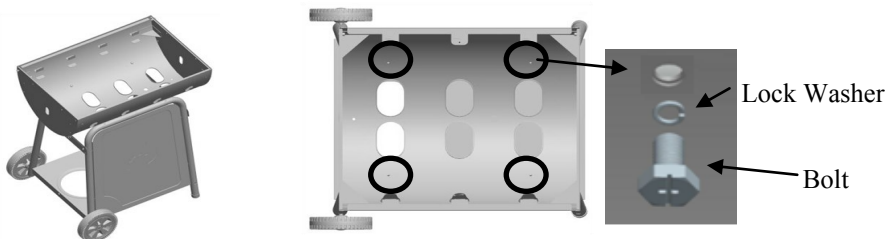

Step 7

Attach (2) SLIDER BRACKETS and (1) STOPPER BRACKET to Bottom of GRILL BODY as shown on Figure 2 and Figure 3 using (6) #10-24 x 0.40" bolts. NOTE: Oriented Brackets as shown in Figure 1. Install CATCH PAN by placing CATCH PAN support brackets on top of SLIDER BRACKETS underneath GRILL BODY, see Figure 4, and then slide it forward until you can hang the CATCH PAN side bracket onto the STOPPER BRACKET. From the rear of the grill, slide the GREASE TRAY into the guides/ rails under the CATCH PAN.

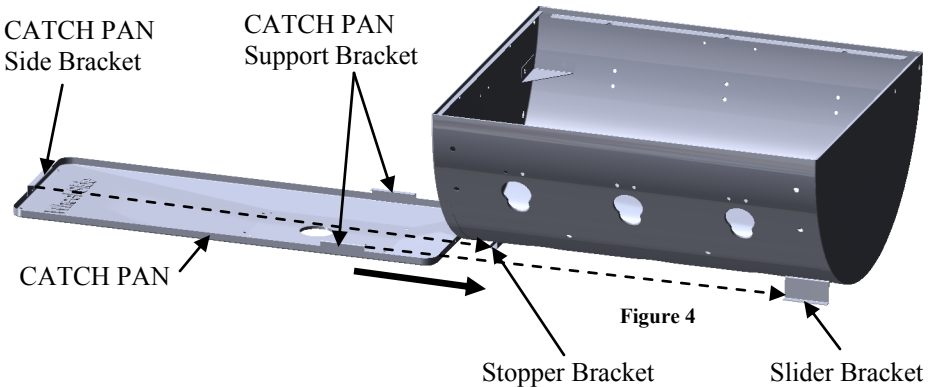
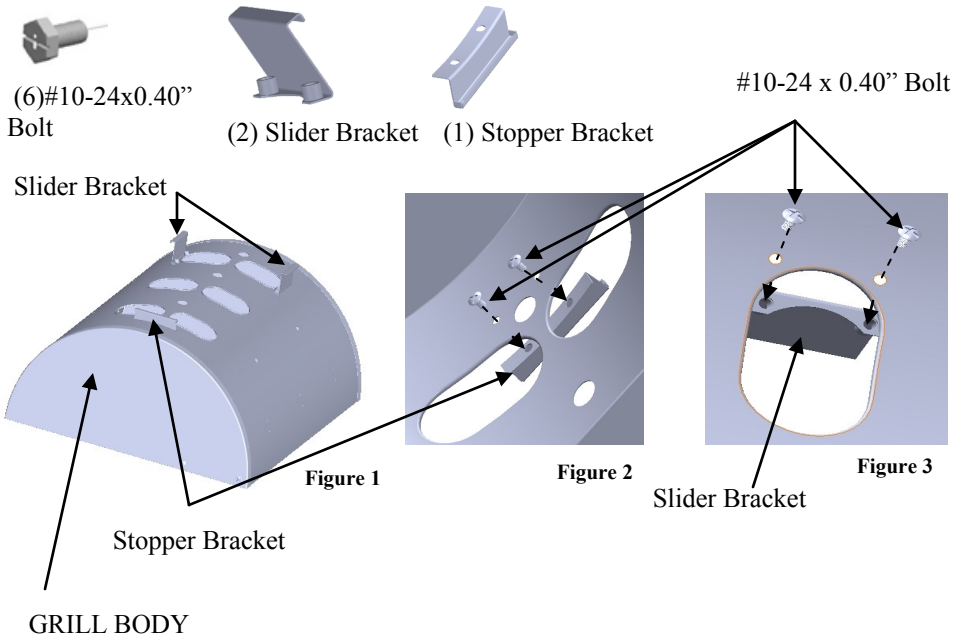

Step 8

Install the SIDE BURNER and the CONTROL PANEL into the firebox. Attach with eight (8) 1/2" BOLTS and eight (8) LOCK WASHERS from inside the GAS GRILL BODY. The BOLTS will first go through the GRILL BODY and then screw into the SIDE BURNER and CONTROL PANEL. See Figures below. Then remove and re-install bolt in LEG BRACE to hold HOSE GUIDE in place as shown.

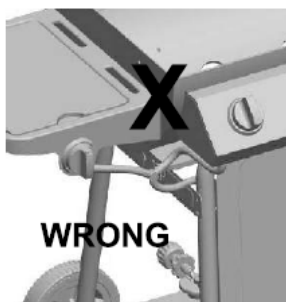
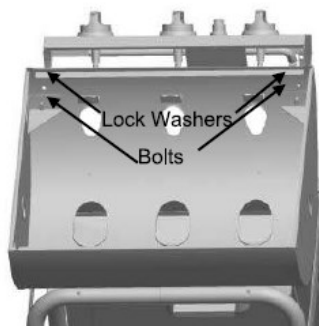
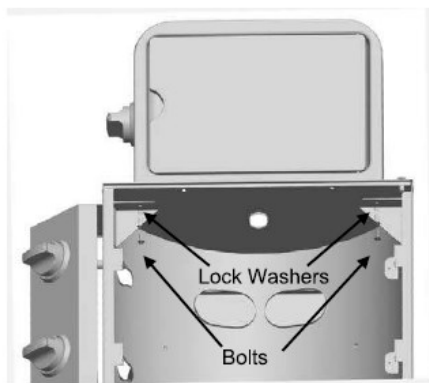

WRONG HOSE LOCATION

Note: the hose should be on the outside of the leg brace.

Step 9

Attach the SIDE SHELF with four (4) 1/2" BOLTS and Lock washers as shown below.

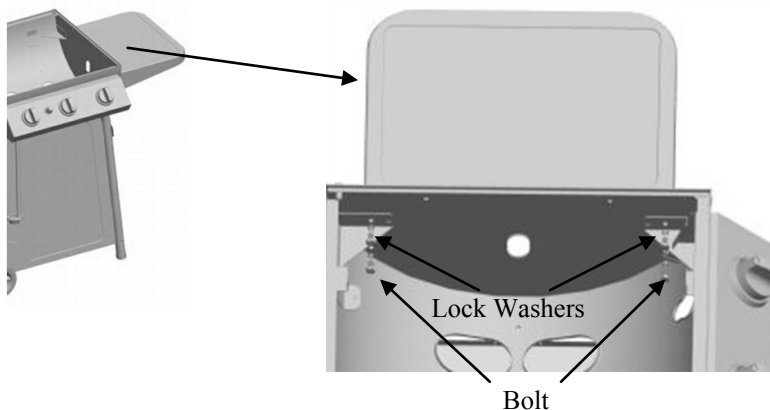

Step 10

Install the BURNERS into the GAS GRILL BODY by first inserting the open end of the BURNERS through the holes directly behind the CONTROL PANEL and then onto the VALVE tip. Make sure the valve tip is completely inside the hole on the end of the BURNER. The BURNER with the long wire is installed on the right side of the GAS GRILL BODY. Secure the other end of the BURNER to the GAS GRILL BODY with the SCREW provided. Again, make sure the VALVE tip is completely inside the hole on

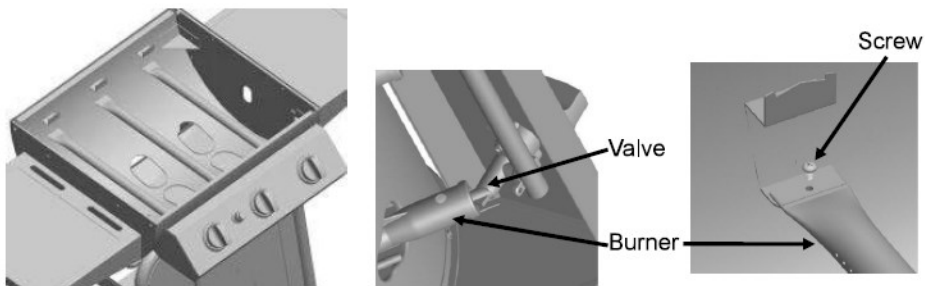

Step 11

Insert the IGNITER WIRES, which are attached to the underside of each BURNER, through the small hole in the GRILL BODY that the BURNER goes through then attach the wire to the back side of the ELECTRONIC IGNITER, which is attached to the

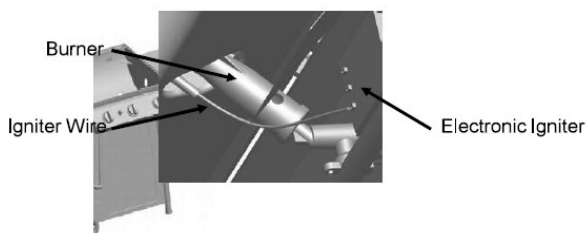

Step 12

Attach the HOOD HANDLE to the HOOD with two (2) LOCK WASHERS and two (2) WING NUTS as shown above. Attach THERMOMETER through BEZEL as shown.

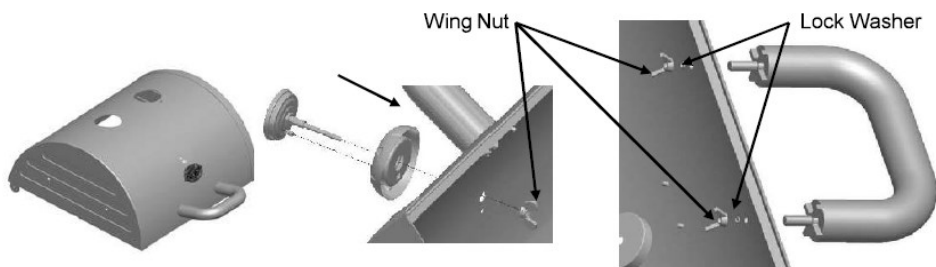

Step 13

Install the two (2) GAS CHIMNEYS to the GAS GRILL HOOD and the CHARCOAL CHIMNEY to the CHARCOAL GRILL HOOD. Insert the CHIMNEYS through each hole from inside the HOOD and secure with two (2) HEX NUTS and two (2) 1/2" BOLTS for each CHIMNEY, see below.

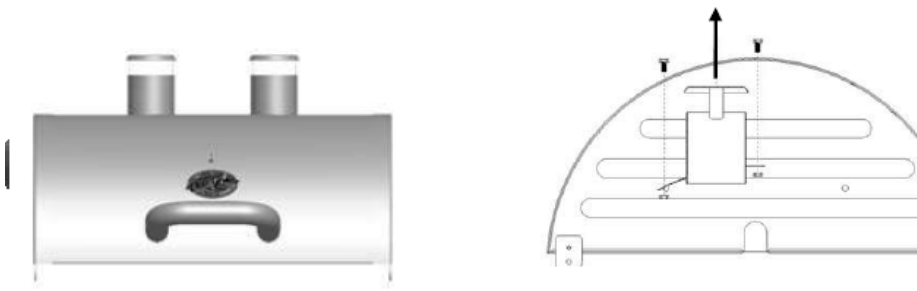

Step 14

Attach the HOOD to the GRILL BODY using the HINGE PINS as shown. First place the HOOD onto the GRILL BODY then screw the HINGE PINS into place and then insert COTTER PINS through the holes in the HINGE PINS on the inside of the GRILL BODY.

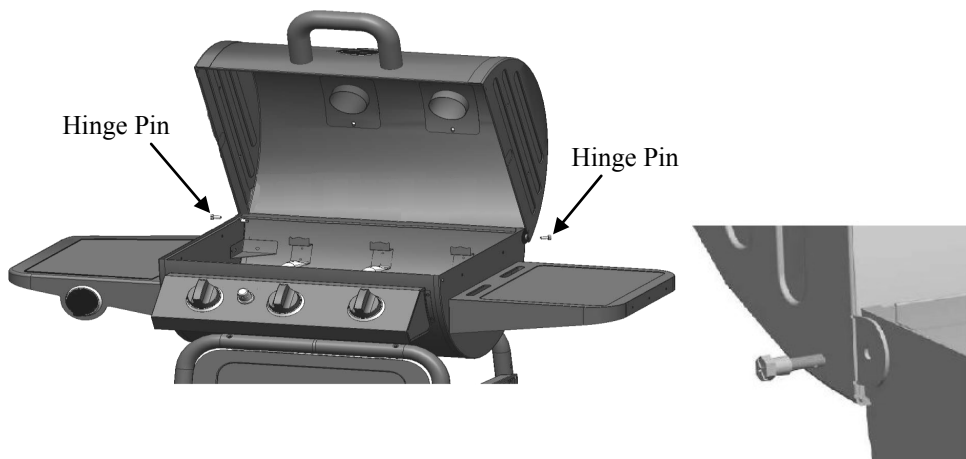

Step 15

Before attaching WARMING RACK you must attach the warming rack BOLTS to the GRILL HOOD and BODY. Insert the 1½" BOLTS through the holes in the sides of the HOOD from the outside and tighten the HEX NUTS on the inside of the HOOD. Insert the 1½" BOLTS through the holes in the sides of the GRILL BODY from the outside and tighten the HEX NUTS on the inside of the GRILL BODY. Now, you can attach the warming rack to these bolts as shown above and secure with HEX NUTS only finger tight.

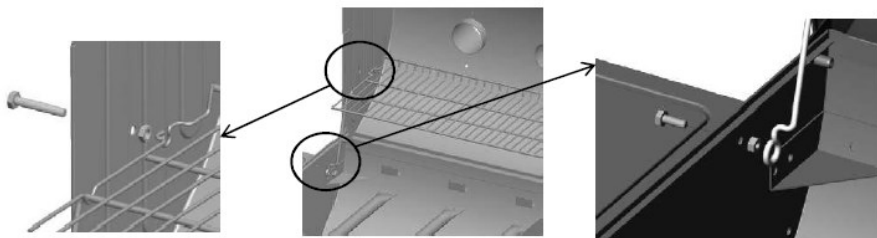

Step 16

Set the POT STAND in place over the SIDE BURNER. Next install the FLARE-UP SHIELD over the BURNER TUBES. Then set the COOKING GRATES in place and insert UTENSIL HOOKS into the SIDE SHELF.

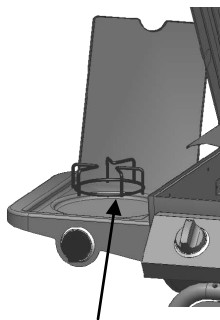

POTS STAND

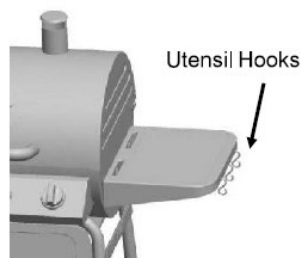
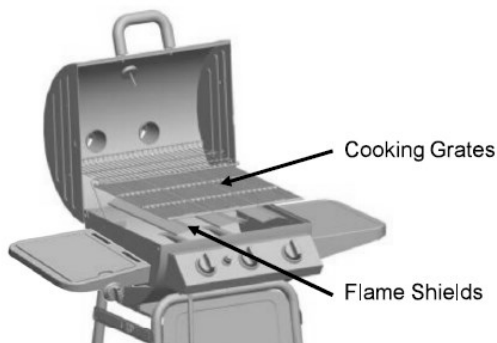

Step 17

1. Place a standard 20 lb. LP gas cylinder (not included) into the cart assembly and connect the cylinder with the gas hose/regulator as shown. (See "Operating Grill" on page for further instructions).
2. Turn the Screw on the left side of the base panel clockwise to secure the standard 20 lb. LP gas cylinder.



NOTE: Hoses must go under and to the outside of the leg brace.

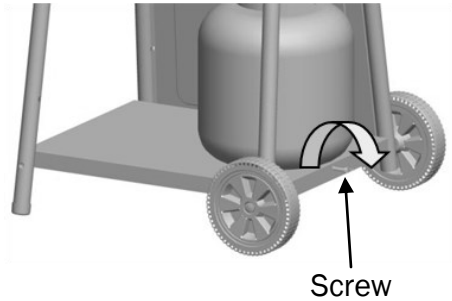

Step 18

Install Igniter battery by turning the Igniter push button cap counter-clockwise until the igniter button detaches, then install a AA battery making sure the positive(+) end is toward the push button. Then re-attach the igniter button by turning it clockwise.

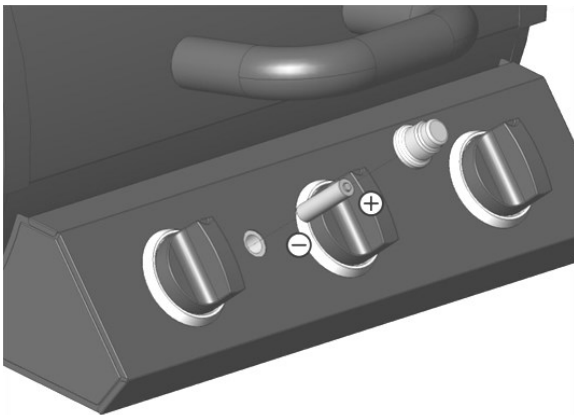

Step 19

Tighten all NUTS and BOLTS.

Fully Assembled



Caution: Use only the regulator provided!

If a replacement is necessary, please call our customer service department, 912-638-4724. Do NOT use replacement parts that are not intended for this grill.

Hint: The paper label that is affixed to the hood is more easily removed when the hood is warm. Any remaining glue residue can be cleaned off with a spray lubricant like WD-40. Do NOT use any other type of solvent or cleaner because this will damage the finish/paint/coating on the grill.

Connecting Gas Cylinder:

The propane gas supply cylinder to be used must be constructed and marked in accordance with the Specifications for propane gas Cylinders of the U.S. Department of Transportation (DOT), or the National Standard of Canada, CAN/CSA B339, Cylinders, Spheres and Tubes for Transportation of Dangerous Goods; and Commission, as applicable. Only cylinders with a listed overfill prevention device (OPD) and marked “propane” may be used. Cylinders with an OPD will have valve handles with three “lobes” (prongs). Only use 20-pound cylinders equipped with a Type 1 cylinder connection device for outdoor cooking appliances. The cylinder must include a collar to protect the cylinder valve. The gas cylinder should not be dropped or handled roughly! If the appliance is not in use, the gas cylinder must be disconnected. Storage of an appliance indoors is permissible ONLY if the cylinder is disconnected and removed from the appliance. Cylinders must be stored outdoors out of the reach of children and must not be stored in a building, garage or any other enclosed area. Your cylinder must never be stored where temperatures can reach over 125 F. Before connection, be sure that there is no debris caught in the head of the gas cylinder, head of the regulator valve or in the head of the burner and burner ports. Connect regulator valve and hand-tighten firmly. Disconnect the propane cylinder from the regulator valve when the grill is not in use. **DO NOT** obstruct the flow of combustion air and ventilation air to the grill. The propane cylinder must be arranged for vapor withdrawal and equipped with a listed overfilling prevention device. For proper vapor withdrawal, the cylinder should be used in the proper upright position (refer to illustration under step 22 of page 17).

DANGER:

Never store a spare propane cylinder near this grill.

A fire causing death or serious injury may occur if the above is not followed exactly.



Cleaning and Care

Caution:

All cleaning and maintenance should be done when grill is cool and with the gas supply turned off at the propane cylinder.

DO NOT clean any grill part in a self cleaning oven. The extreme heat will damage the finish.

Cleaning

Burning-off the grill after every use (approx. 15 minutes) will keep excessive food residue from building up. Clean grease tray and cup after EVERY use.

Recommended cleaning materials:

- Mild dishwashing liquid detergent
- Hot water
- Nylon cleaning pad
- Brass wire brush (brush lightly)

DO NOT use cleaners that contain acid, mineral spirits or xylene.

Outside surfaces –

Use a mild dishwashing detergent and hot water solution to clean, then rinse with water.

If the inside surface of the grill lid has the appearance of peeling paint, baked on grease buildup has turned to carbon and is flaking off. Clean thoroughly with strong solution of detergent and hot water.

Rinse with water and allow to completely dry.

Interior of grill bottom – Remove residue using brush, scraper and/or cleaning pad, then wash with dishwashing detergent and hot water solution. Rinse with water and let thoroughly dry.

Cooking Grids – The porcelain grates have a glass-like composition that should be handled with care not to chip. Use mild dishwashing detergent or baking soda and hot water solution. Non abrasive scouring powder can be used on stubborn stains, then rinse with water.

Heat Shield – Clean residue with wire brush and wash with soapy water. Then rinse with water.

Cleaning the Burner Assembly

- Remove grease collector.
- Remove cooking grates and heat shield.
- Remove burner by unscrewing nut from beneath burner “foot” using a screwdriver and pliers.
- Lift burner up and away from gas valve orifice.
- Clean inlet (venturi) of burner with small bottle brush or compressed air.
- Remove all food residue and dirt on outside of burner surface.
- Clean any clogged ports with a stiff wire (such as an opened paper clip)
- Inspect burner for any damage (cracks or holes). If damage is found, replace with new burner. Reinstall burner; check to insure that gas valve orifices are correctly positioned inside burner inlet (venturi). Also check position of spark electrode.

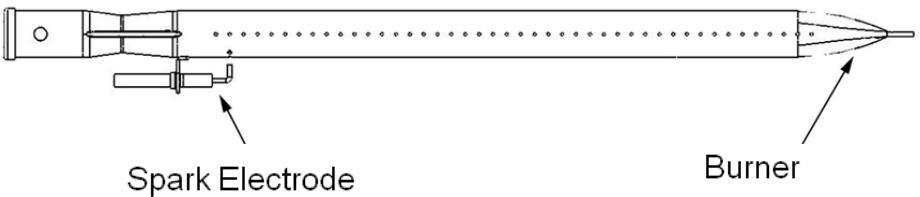



Stand in front of the grill to operate the controls.

Note: Before starting the grill, check for leaks. Make sure the regulator valve is securely fastened to the burner and the cylinder.

To prevent fire or explosion hazard when testing for a leak:

1. Always perform the “leak test” as described below before lighting the grill or each time the cylinder is connected for use.
2. Do not smoke or allow other sources of ignition in the area while conducting a leak test.
3. Conduct leak test outdoors in a well-ventilated area.
4. Do not use matches, lighters or a flame to check for leaks.
5. Do not use grill until any and all leaks are corrected. If you are unable to stop a leak, disconnect the propane supply. Call a gas appliance serviceman or your local propane gas supplier.

To Perform a Leak Test:

Make a 2-3 oz (0-90ml.) of leak solution by mixing one part liquid dishwashing soap with three parts water in a spray bottle.

Note: Make sure control knobs are off.

Spray solution on the tank valve to regulator connection, the “Y” joint in the hose, the connection to the manifold behind the main control panel, and the connection to the side burner valve.

Inspect the solution at the connection looking for bubbles. If NO bubbles appear, the connection is secure. If bubbles appear, you have a leak. Check the regulator connection as follows: Disconnect regulator from the tank and reconnect, making sure the connection is secure. Retest with solution. If you continue to see bubbles, replace the cylinder.

Lighting Your Grill

Danger: Failure to open hood while igniting the grill or not waiting 5 minutes to allow the gas to clear if the grill does not light, may result in an explosive flare-up which can cause serious bodily injury or death.

Before cooking on this grill for the first time, operate the grill for about 15 minutes with the lid closed and the gas turned on “high”. This will “heat clean” the internal parts and dissipate odor from the manufacturing processes and painted finish.

Main Burners:

1. Always open the lid before lighting the grill.

Attempting to light the burner with the lid closed may cause an explosion!

2. Make sure there are no obstructions of airflow to the gas unit. Spiders and insects can nest within and clog the burner/venturi tube at the orifice. A clogged burner tube can lead to a fire beneath the appliance.
3. Make sure all burner knobs are in the OFF position.
4. Open the valve on the LP gas cylinder.
5. Ignite only the burners you desire to use, using the same method for each: Push in desired burner knob fully and rotate slowly about $\frac{1}{4}$ turn counter-clockwise to “HIGH”. **If the burner does not light immediately**, return the knob to **OFF**, wait **Five minutes** for the gas to clear and repeat the procedure. After the burner ignites, repeat the same procedure with any other burner desired. Adjust knob (s) to desired cooking setting.

After lighting, observe the burner flame, make sure all burner ports are lit.

If burner flame goes out during operation, immediately turn the gas “off” at the control panel and at the gas cylinder and open hood/lid to let the gas clear for about 5 minutes before re-lighting. **Clean your grill after each use**, DO NOT use abrasive or flammable cleaners, as it will damage the parts of this product and may start a fire.



Side Burner

1. Open lid during lighting. Lid must be open when burner is on.
2. Burner valves must be in the “off” position.
3. Open cylinder valve.
4. Push in side burner valve knob fully and rotate slowly about $\frac{1}{4}$ turn counter-clockwise until a click is heard. **If the burner does not light**, immediately turn the valve knob to OFF. **Wait 5 minutes** for the gas to clear and repeat the procedure.

After burner ignites, adjust valve knob to desired cooking setting.

Shutting Off Burners:

1. Always turn the valve knob(s) clockwise to the HI position, then push in and turn to OFF. Never force the knob without depressing it as this can damage the valve.
2. Promptly turn the gas supply OFF at the propane cylinder.
3. Close the lid of the grill.

Observe Flame Height When Lit:

Flame should be a Blue / Yellow color.

To visually check that the burner is operating, look at the burner flame through the flame viewing hole. The flame should be approximately $\frac{1}{2}$ - $\frac{3}{4}$ inch long with the high setting.

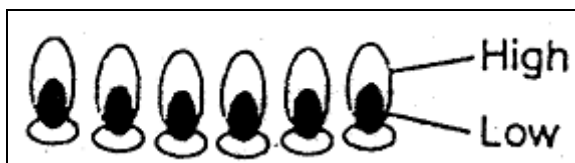

Lighting Burner With a Match:

1. Place a match in the end of the match holder that is installed on the side of Grill Housing. Once lit, immediately place the flame through the cooking grates as shown near the burner ports.
2. Press in knob and rotate counter-clockwise to the High setting and burner should light immediately.
3. Adjust burners to desired cooking settings

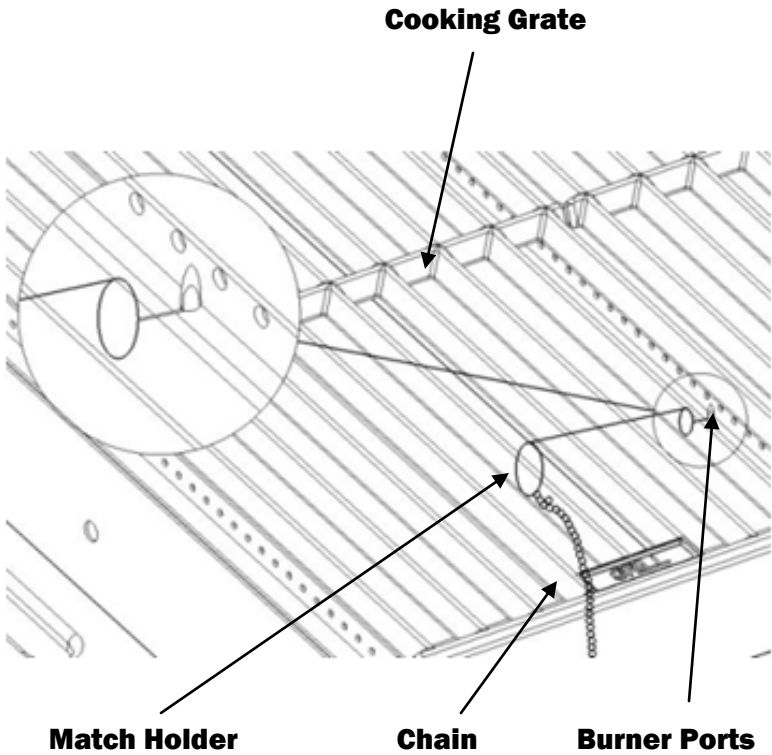

Gas Grill Trouble Shooting

Problem	Possible Cause	Prevention/Cure
Burner will not light using knobs	Wires/or electrode covered with cooking residue.	Clean wire and/or electrode, with rubbing alcohol
	Electrode and burners are wet.	Wipe dry with cloth
	Electrode cracked or broken -sparks at crack	Replace electrode
Burner will not light with match.	Wire loose or disconnected	Reconnect wire or replace electrode/wire assembly.
	No gas flow.	Check if propane tank is empty. If propane tank is not empty. Refer to "Sudden drop in gas flow or reduced flame height". If empty, replace or refill.
	Coupling nut and regulator not connected.	Turn the coupling nut about one-half full connected to three quarters additional turn until solid stop. Tighten by hand only -do not use tools.
	Obstruction of gas Flow.	Clear burner tubes. Check for bent or kinked hose.
	Disengagement of burner to valve.	Re-engage burner and valve.
Sudden drop in gas flow or reduced flame height.	Insect nests in venturi (burner insert).	Clean venturi.
	Burner ports clogged or blocked.	Clean burner ports.
Sudden drop in gas flow or reduced flame height.	Out of gas	Change Propane Tank
	Excess flow safety device may have been activated.	Turn off knobs, wait 30 seconds and light grill. If flames are still too low. Reset the excessive flow safety device by turning off knobs and propane tank valve. Disconnect regulator. Turn burner control knobs off. Reconnect regulator and leak check connections. Turn propane tank valve on slowly, wait 30 seconds and then light the grill.
Irregular flame pattern, flame does not run the full length of burner.	Burner ports are clogged or blocked.	Clean Burner ports

Gas Grill Troubleshooting, continued

Problem	Possible Cause	Prevention/Cure
Flame is yellow or orange.	New burner may have residual Manufacturing oils.	Burn Grill for 15 minutes with the lid closed.
	Insect nests in venturi.	Clean venturi.
	Food residue, grease or seasoning salt on burner.	Clean burner.
	Poor alignment of valve to burner venturi.	Assure burner venturi is properly engaged with valve.
Flame blows out	High or gusting winds	Turn front of grill to face wind or increase flame height. (We recommend not using grill during high winds)
	Low gas pressure	Change Propane Tank
	Excess flow valve tripped	Refer to "Sudden drop in gas flow or reduced flame height"
Flare-Up	Grease buildup	Clean Grill
	Excessive fat in meat	Trim fat before grilling
	Excessive cooking Temperature	Adjust (lower) temperature accordingly
Persistent grease fire	Grease trapped by food buildup around burner system.	Turn knobs to OFF. Turn gas off.
Flashback (fire in burner tube(s))	Burner and/or burner tubes dirty.	Clean burner and/or burner tubes.
Inside of lid appears to be peeling - like paint peeling	Baked on grease buildup has turned to carbon and is flaking off.	Clean inside of lid thoroughly. The lid is not painted on the inside

GRILL PREPARATION & OPERATING INSTRUCTIONS

PLEASE NOTE: NO RETURNS ON USED GRILLS

Read all safety warnings and instructions carefully before assembling and operating your grill.

1. Note: The interior of the grills are not painted, they are coated with vegetable oil. **DO NOT** remove this coating. Cure grills prior to cooking to protect the interior and exterior finishes and prevent adding unnatural flavors to your food. (A) Lightly coat **ALL INTERIOR SURFACES** (including **INSIDE OF BARREL, AND COOKING GRATES**) with additional vegetable oil (spray vegetable oil is easiest but **KEEP AWAY FROM HOT COALS, FIRE OR FLAME**). Light burners and set on Medium-Low heat. (D) Gas Grills: Close lid and maintain heat at approximately 250 °F (120 °C) for two hours. You can lightly coat the exterior the GRILL body (while warm) with vegetable oil and wipe off excess with a rag. This will extend the life of the finish, much like waxing a car. Your GRILL will then be ready for use. Note: Oil will drip from the GRILL for several uses, but will slow over time.

NEVER EXCEED 450 °F (230 °C) BECAUSE THIS WILL DAMAGE THE FINISH AND CONTRIBUTE TO RUST. PAINT IS NOT WARRANTED AND WILL REQUIRE TOUCH-UP. THIS UNIT IS NOT WARRANTED AGAINST RUST.

2. This grill is made of steel and cast iron, which **WILL RUST, ESPECIALLY IF NOT PROPERLY CARED FOR.**

3. You may fill unwanted holes with Nuts & Bolts (Not Provided).

NOTE: Smoke will escape from areas other than the smokestacks. This will not affect your cooking .

GRILLING RECIPES

DIRECT METHOD

STEAK (& ALL MEATS): Cook food directly above coals/heat. Generally speaking, to grill meats, raise fire grate to high position (hot) and sear for one minute on each side with the lid open to seal in flavor and juices. Then lower fire grate to medium position with lid closed and cook to desire doneness.

Control heat with dual dampers and adjustable fire grate.

BETTER BARBECUE: Place grilled meat back in the marinade for several minutes before serving – it will become tastier and juicier. CAUTION: Boil extra marinade first to kill bacteria remaining from the raw meat.

Tip: Cooking with a MEAT THERMOMETER ensures food is fully cooked. Insert into thickest part not touching bone & allow five minutes to register. Internal temperatures for BIRDS should be 170F to 180F and meat should be 140F for rare, 160F medium and 170F for well done.

MARINATED FLANK STEAK: Mix marinade ingredients in nonmetal dish. Let steak stand in marinade for no less than 4 hours in refrigerator. Brown each side for 5 minutes, but center should remain rare. Cut steak diagonally across the grain into thin slices before serving. Grill with fire grate in high (hot) position with lid open or closed.

MARINADE: 1/2 cup vegetable or olive oil, 1/3 cup soy sauce, 1/4 cup red wine vinegar, 2 tbs. Lemon juice, 1 tsp. Dry mustard, 1 minced clove garlic, 1 small minced onion, 1/4 tsp pepper.

QUAIL OR DOVES: Cover birds in Italian dressing (Good Seasons or Kraft Zesty), marinate overnight, pour off dressing and cover with Texas Pete Hot Sauce for 6 hours. Wrap birds in thick bacon secured by a toothpick. *Place on grill – keep turning until bacon is black. Grill for 20 minutes. Sear with lid open and fire grate in high (hot) position for 1 min each side before lowering grate and closing lid. *OR SMOKE by placing birds in center of GRID with fire in both ends of FIRE BOX.

KABOBS: Alternating on skewers any combination of meat, onions, tomatoes, green peppers, mushrooms, zucchini, circular slice of corn-on-the-cob, or pineapple. Meat could consist of chunks of shrimp, scallops, lobster, chicken, sausage, pork, beef, etc. Marinate the meat in refrigerator for several hours. Grill each side approximately 7 minutes turning occasionally while basting with marinade. Leave a small amount of room between pieces in order to cook faster. Grill with lid up and the fire grate in the lowest position. See marinade recipe on last page.

KABOB MARINADE: Mix 1 cup soy sauce, 1/2 cup brown sugar, 1/2 cup vinegar, 1/2 cup pineapple juice, 2 teaspoons salt, 1/2 teaspoon garlic powder and bring to a boil. Marinate beef in mixture a minimum of 4 hours.

HOT DOGS: Grill with lid up and fire grate in high (hot) position for approximately 6 minutes, turn every few minutes.

HAMBURGERS: Mix in chopped onions, green peppers, salt, sear 3/4 inch patties on each side with fire grate in high position for a few minutes. Lower fire grate to medium position and grill with lid down to avoid flare-ups. Cook each side 3 to 7 minutes according to desired doneness. Cook ground meat to 150 internally or until juice runs clear (free of blood) for prevention of E-coli.

Burgers can be basted with marinade when turning and/or other ingredients can be mixed in with the ground beef such as chili sauce or powder; or you may marinate by allowing to stand in marinade for 1 or 2 hours at room temperature before cooking; or let stand in covered dish in refrigerator up to 24 hours. Bring to room temperature before cooking.

See meat marinade on page 9.

SHRIMP (Peeled) & Crayfish: Place on skewers, coat with melted butter and garlic salt. Grill 4 minutes on each side or until pink. Cocktail sauce optional.

BAKED POTATOES: Rub with butter and wrap in foil and cook on grill with lid down for 50 minutes. Turn after 25 minutes (no need to turn if smoked). Squeeze to check for doneness.

SWEET CORN IN HUSKS: Trim excess silk from end and soak in cold salted water 1 hour before grilling. Grill 25 minutes – turning several times.

Grillin' Pro 3001

ACCESSORIES ORDER FORM



TO ORDER

Visit:

www.chargriller.com
or

CALL: 912-638-4724
or

FAX: 912-638-2580
or MAIL:

P.O. Box 30864
Sea Island, GA
31561



Visit our online store at:
www.chargriller.com
for more Char-Griller®
Professional Accessories™

Professional Accessories™ Branded with Char-Griller® Logo

ALL TOOLS: STAINLESS STEEL & HARDWOOD HANDLES

• Cover

- Custom Fit, Weather Resistant
- Protects grill finish
- Cover Accommodates Side Shelf or Side Fire Box
- Grill cover #3055 fits with Side Fire Box or Side Shelves.....\$24.99



• Side Fire Box item #2-2424

- For Charcoal grilling
- Attaches to grill in minutes.....\$59.99



• Rotisserie—Heavy Duty

- Excellent for effortless grilling
- Universal Fit for Any Grill.....\$35.99



• Apron

- Machine Washable
- Two Front Pockets
- Adjustable Straps.....\$14.99



• Tank Cover

- Weather Resistant Nylon
- Fits standard 20lb LP tank
- Velcro Close
- Elastic at Top and Bottom
- Cover Only Tank Not Included.....\$9.99



(continued on next page)

ACCESSORIES ORDER FORM

Grillin' Pro 3001



TO ORDER

Visit our online store at:

www.chargriller.com

or

CALL: 912-638-4724

or

FAX: 912-638-2580

or MAIL:

P.O. Box 30864

Sea Island, GA

31561



• **Raw Cast Iron Grate**

- Even Heat, Great For Searing
- Non Stick, Non Warp..... \$8.99

Name _____ Telephone _____

Street Address _____

City / State / Zip _____

Email _____

Please bill my credit card:

Check or Money Order (Sorry—No C.O.D.s)
Check orders will be held 2 weeks before shipment

EXPIRATION DATE

VISIT OUR WEB SITE FOR SHIPPING COST
www.CharGriller.com
Model 3001 Grillin' Pro

Prices & policies subject to change
15% Restocking Fee on all returns
No Returns on Used Product.
Please Call For updated Pricing
and Product Availability.

Georgia Customers add a 7% sales tax.
Washington state Customers add a 10% sales tax

Qty.	Product	Price	Qty.	Product	Price
	Tank Cover	\$9.99		Rotisserie	\$35.99
	Adjustable Fit Apron	\$14.99		Side Fire Box #2-2424	\$59.99
	Cover For Grill	\$24.99		Raw Cast Iron Grate	\$8.99
				Shipping Charge	
ORDER NOW!				Total	

Page intentionally left blank for notes



**P.O. Box 30864
Sea Island, GA
31561
912-638-4724
www.CharGriller.com**

Warranty Information – Gas Grill

Char-Griller® will repair or replace any defective part of its grillers/smokers for a period of up to one year from the date of purchase. Char-Griller® will also repair or replace the body (lid and bottom half) of its grillers/smokers if the metal is rusted through or burned through for a period up to five years. Char-Griller will repair or replace any defective part of its side fire boxes for a period up to one year from the date of purchase. Char-Griller® gas grill burners have a five year warranty from the date of purchase.

Proof of purchase, proof of purchase date and prepaid return of the item in question may be required. Misuse, abuse, or commercial use nullifies all warranties. Paint/finish is not warranted. Products are not warranted against rust.

The warranty is for replacement of defective parts only. Manufacture will not be responsible for damage resulting from accident, alteration, misuse, abuse, hostile environments, improper installation, installation not in accordance with local codes of service of unit.

This limited warranty does not cover any scratches, dents, corrosion or discoloring by heat, abrasive and chemical cleaners nor any components used in the installation of the appliance.

Save your receipt for all warranty claims.

