

# HOLTKÖTTER INTERNATIONAL, INC.

155 Hardman Avenue South, South St. Paul, MN 55075

fax: (888) 552-8661 • phone: (800) 899-5444

www.holtkoetter.com

e-mail: customerservice@holtkoetter.com

Congratulations, you have just purchased one of the finest reading lamps available on the market today. This lamp has a telescoping shade that allows the user to focus the halogen light where they want it and a full-range dimmer to control the light output. The reflector houses a secondary aluminum reflector covered with a frosted glass shield that evens and focuses the light output of the encased 20 Watt Halogen bulb.

Replacement Bulb Order Code: 9250\*020-HSTAR-G4

## Care Instructions

Use only a soft, dry cloth to clean. If necessary, a slightly damp, soft cloth can be used to spot clean. Do not use common household cleaners on lamps or fixtures, as the lacquer on the outside of the brass may be damaged as a result.

Enjoy your new Holtkötter lamp.



6265/1

## General Installation Instructions

**IT IS FIRMLY RECOMMENDED THAT A LICENSED ELECTRICIAN INSTALL THIS FIXTURE.**

1. Remove the universal crossbar strap from the back of the sconce.
2. Mount the universal crossbar strap to the outlet box before making the wire connections.
3. Connect the wires from the sconce with the wires in the outlet box according to generally accepted electrical standards.
4. Mount the backplate of the sconce to the crossbar strap and secure with finished screws.

## ASSEMBLY INSTRUCTIONS FOR

# Bedside Reading Lighting Wall Sconce No. 6265/1

## Glass Shield and Bulb Replacement Instructions

1. In order to replace the bulb, special care must be taken to remove the shade. The lamp must be turned off and unplugged for at least 15 minute prior to removing the shade.
2. Turn the shade clockwise until it stops. Using the allen wrench provided, loosen the set-screw located on the inner part of the vent. Do not remove this set-screw.
3. Take the shade assembly off the lamp.

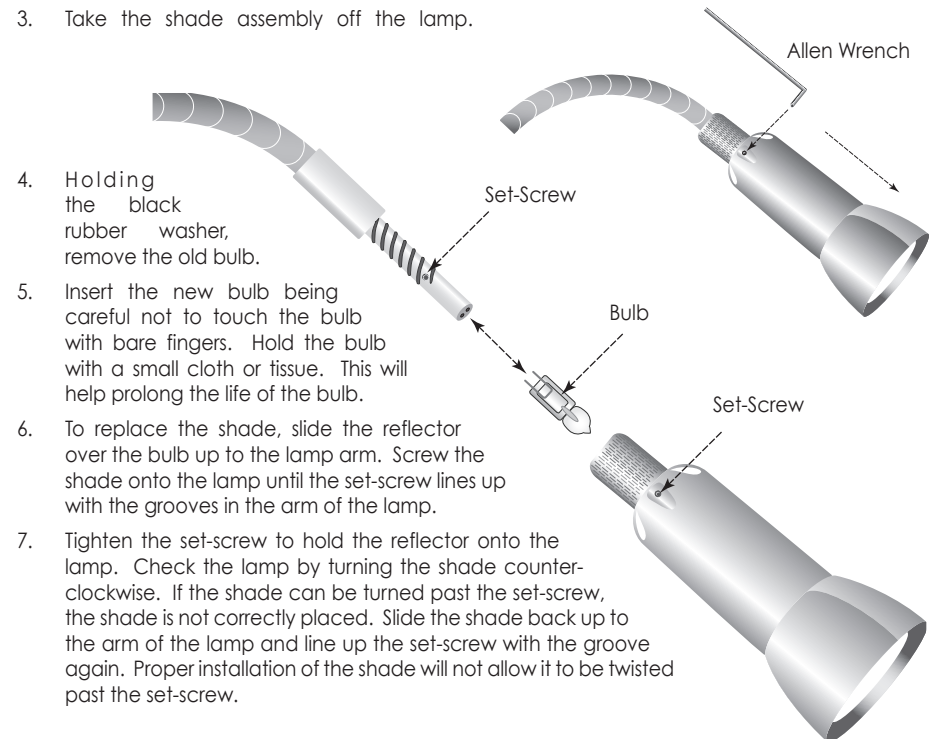

4. Holding the black rubber washer, remove the old bulb.
5. Insert the new bulb being careful not to touch the bulb with bare fingers. Hold the bulb with a small cloth or tissue. This will help prolong the life of the bulb.
6. To replace the shade, slide the reflector over the bulb up to the lamp arm. Screw the shade onto the lamp until the set-screw lines up with the grooves in the arm of the lamp.
7. Tighten the set-screw to hold the reflector onto the lamp. Check the lamp by turning the shade counter-clockwise. If the shade can be turned past the set-screw, the shade is not correctly placed. Slide the shade back up to the arm of the lamp and line up the set-screw with the groove again. Proper installation of the shade will not allow it to be twisted past the set-screw.

---

# HOLTKÖTTER INTERNATIONAL, INC.

---

www.holtkoetter.com  
e-mail: customerservice@holtkoetter.com

---

**Special note on focusing:** When focusing the light, be sure to grasp the **front** of the shade -- not the back of the shade near the heat vents. The back of the lamp shade will get hot when used for prolonged periods of time.

**To intensify the light/narrow the beam:**

Turn the shade clockwise to move the shade toward the surface being lit, casting a narrower beam of light.

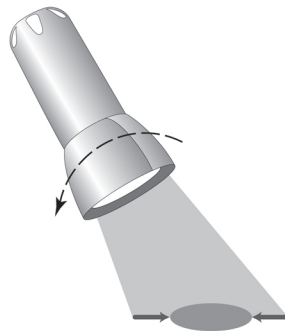

**To diffuse the light/broaden the beam:**

Turn the shade counter-clockwise to move the shade away from the surface being lit, casting a broader beam of light.

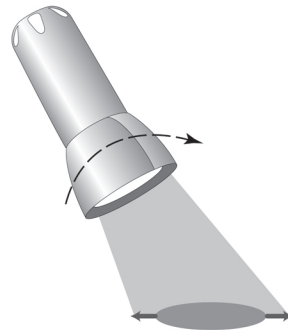

---

## ASSEMBLY INSTRUCTIONS FOR Bedside Reading Lighting Wall Sconce No. 6265/1

---

### CAUTION, IMPORTANT SAFETY INSTRUCTIONS

This portable luminaire has a polarized plug (one blade is wider than the other) as a feature to reduce the risk of electrical shock. This plug will fit a polarized outlet only one way. If the plug does not fit fully into the outlet, reverse the plug. If it still does not fit, contact a qualified electrician. Never use with an extension cord unless plug can be fully inserted. Do not alter the plug.

### INSTRUCTIONS PERTAINING TO A RISK OF FIRE, ELECTRIC SHOCK, EXPOSURE TO EXCESSIVE UV RADIATION OR INJURY TO PERSONS

### WARNING - To reduce the risk of FIRE, ELECTRIC SHOCK, EXPOSURE TO EXCESSIVE UV RADIATION OR INJURY TO PERSONS:

1. Turn off power/unplug and allow to cool before replacing bulb.
2. Bulb gets HOT quickly. Contact only switch/plug when turning on.
3. Do not touch hot lens, guard or enclosure.
4. Do not remain in light if skin feels warm.
5. Do not look directly at lighted lamp.
6. Keep lamp away from materials that burn.
7. Use only with a 20 Watt, low-voltage Halostar G4 or smaller bulb.
8. Do not touch the bulb at any time. Use a soft cloth. Oil from skin may damage bulb.
9. Do not operate the portable luminaire with a missing or damaged guard, lamp containment barrier or UV filter.

### SAVE THESE INSTRUCTIONS