

ASSEMBLY GUIDE

TOOL CART WITH THREE TRAYS (TC301A)

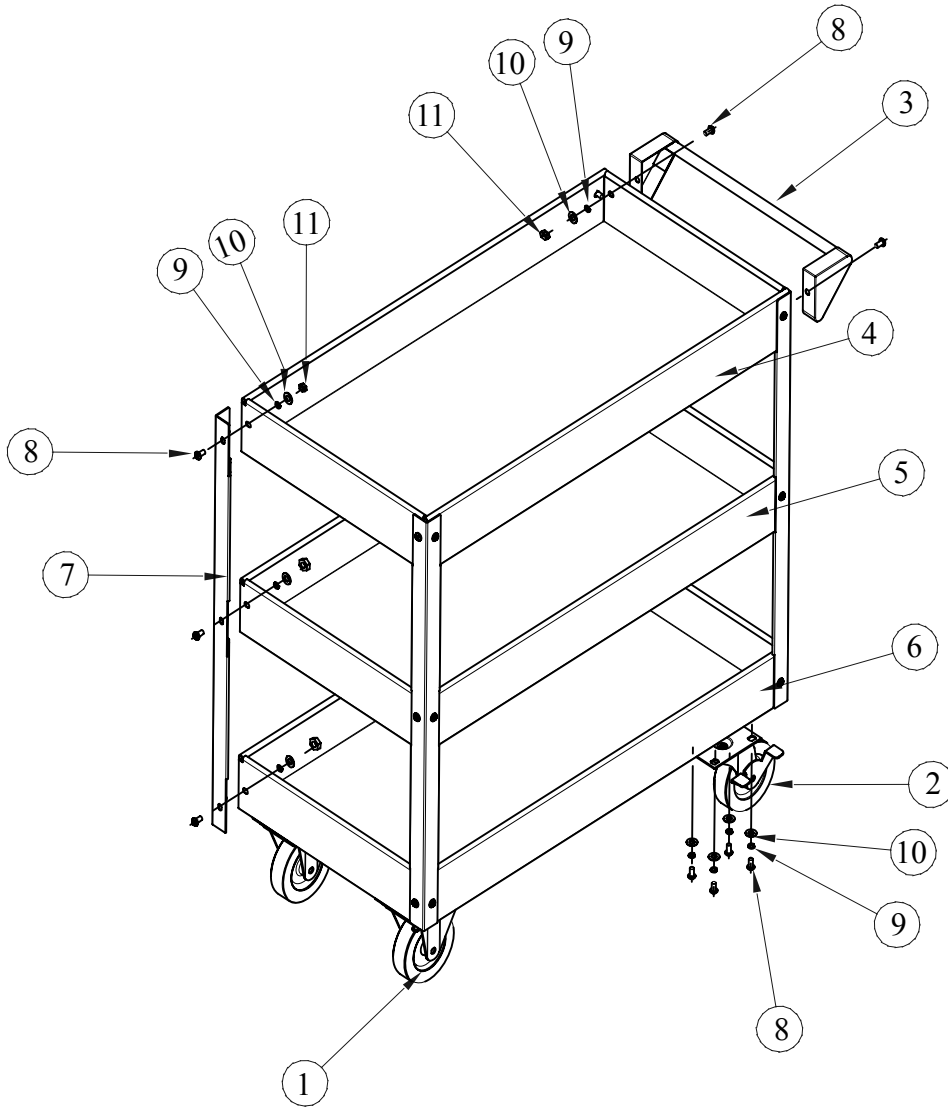

THE MAXIMUM LOAD CAPACITY FOR EACH TRAY SHOULD BE NO MORE THAN 100LBS
 THE MAXIMUM LOAD CAPACITY FOR THE PRODUCT SHOULD BE NO MORE THAN 275LBS

No.	Title	Quantity	No.	Title	Quantity
1	Fixed Caster	2	7	Column	4
2	Swivel Caster(with brake)	2	8	Bolt M6 x 14	40
3	Side Handle	1	9	Washer With Spring M6	40
4	Top Tray	1	10	Washer M6	40
5	Middle Tray	1	11	Nut M6	24
6	Bottom Tray	1			

Step 1

- Attach the casters to the bottom tray(#6) with sixteen M6x14 bolts(#8), washers M6(#10) and washer with springs M6(#9).
- Mount both swivel casters with brakes(#2) onto the same side.
- Wrench tighten.

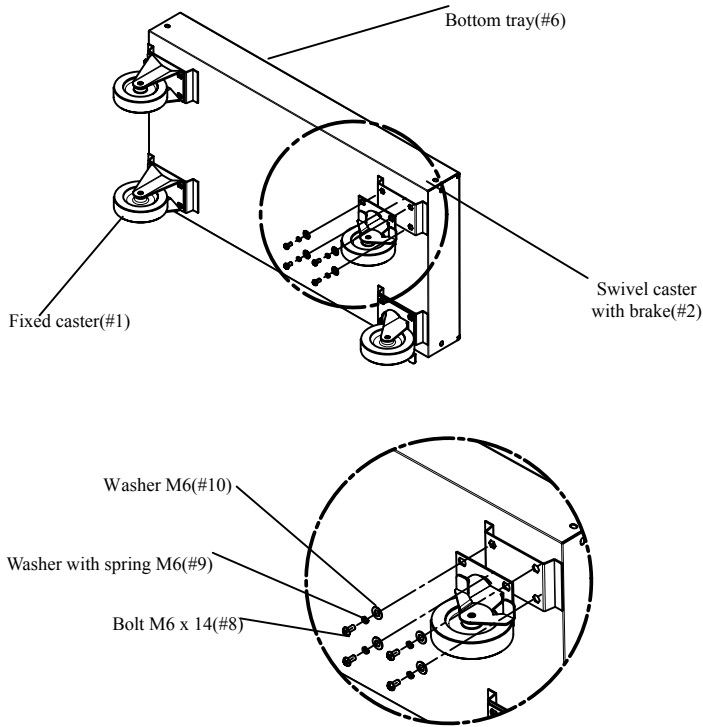

Step 2

- Align all four columns(#7), in either direction, based upon the below diagram.
- Attach the columns(#7) to the bottom tray(#6) as shown in the below diagram with eight M6x14 bolts(#8), washer with springs M6(#9), washers M6(#10) and nuts M6(#11).

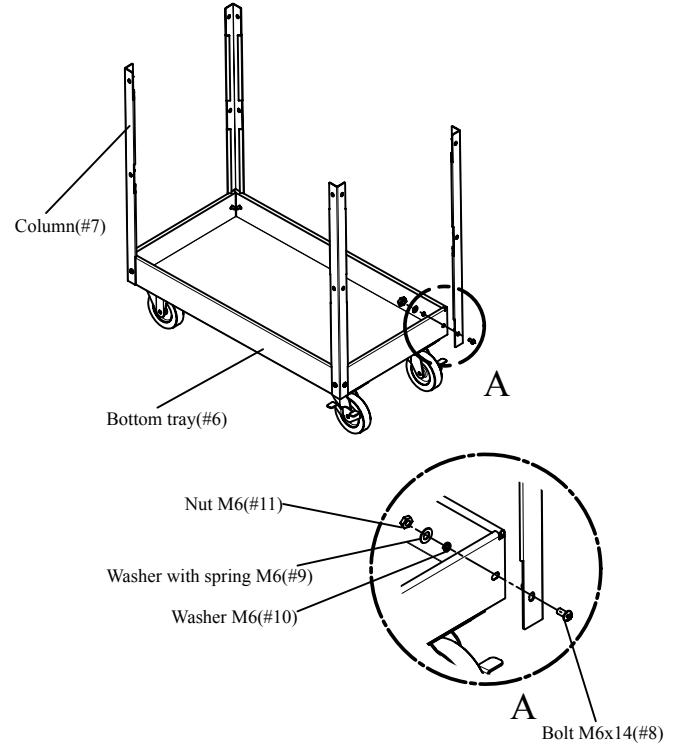

Step 3

- Attach the middle tray(#5) to the four column(#7) with eight bolts M6x14(#8), washer with springs M6(#9), washer M6(#10) and nuts M6(#11). Repeat the above step to attach the top tray.
- Please do not attach bolts in the two holes noted in the below diagram. These two holes will be used to attach the side handle(#3) in a later step.

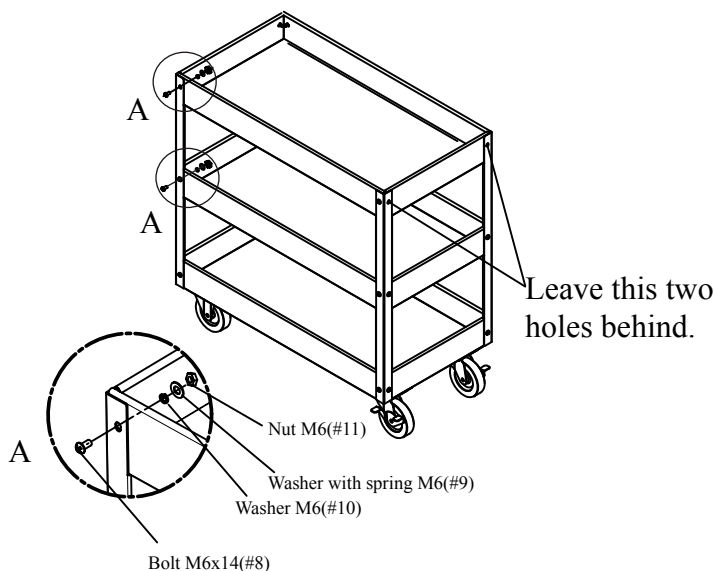

Step 4

- Attach the side handle(#3) with two bolts M6x14 (#8), washer with springs M6(#9), washers M6(#10) and nuts M6(#11).

