

NEWAGE STEEL WELDED WALL CABINET INSTALL INSTRUCTIONS

NEWAGE
PRODUCTS INC.



KIT CONTAINS

- Full Width Adjustable Steel Shelves (2)
- Aluminum Door Trim (2)
- 2.5" x 1/4" Cabinet Mounting Lag Bolts (4)
- Large Zinc Plated Mounting Washers (4)
- 5/8" x 1/4" Zinc Plated Hex Bolt (4)
- 1/4" - 20 Hex Lock Nuts (4)

TOOLS REQUIRED

- 7/16" wrench
- 7/16" socket driver wrench
- 12" Magnetic Level
- Cordless Power Drill with 7/16" socket attachment
- Stud Finder
- Pencil
- Hammer Drill with Masonry Bit (*optional*)
- Tape Measure

WARNING: EXCESSIVE WEIGHT HAZARD

Use two or more people to move, assemble or install cabinet or locker. Failure to do so can result in back or other injury

UNPACKING THE WALL CABINET:

- Begin by placing the cabinet on a sound level surface.
- Remove all cardboard and foam packaging material.
- Remove clear plastic bag.
- Dispose / recycle all packaging materials.
- Remove and verify all the contents in the box. See "Parts and Hardware Supplied List"

PRODUCT SPECS

SIZE: 28"H x 28"W x 14"D

WEIGHT CAPACITY: Shelves: 30lbs
Bottom: 100lbs



ASSEMBLY INSTRUCTIONS:

INSTALLING ALUMINUM DOOR TRIM:

1. Crimp the trim before sliding into place. Slide aluminum trim onto the inner lip of each cabinet door's grooved handle.

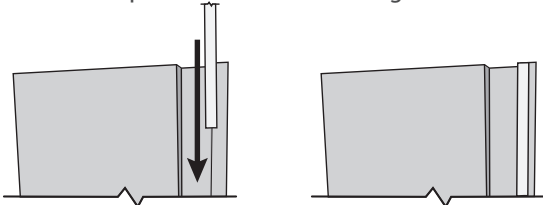

WALL CABINET WALL MOUNTING INTO DRYWALL / STUDDED WALL:

1. Using a stud finder locate the studs in the wall where the wall cabinet is to be placed.
2. Once studs are located, using a pencil and a level mark a vertical line to indicate stud location.



3. Place the wall cabinet into position tight against the supporting wall.
4. Open the doors and locate the perforated mounting strip on the top and bottom of the backside of the cabinet.

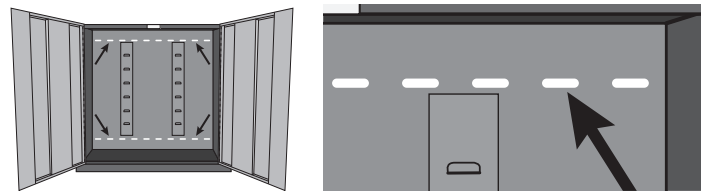

5. Align the previously marked stud lines with a perforated hole by shifting the cabinet slightly.
6. Place a small magnetic level on top of the wall cabinet and adjust the orientation of the cabinet to bring it to a level position.

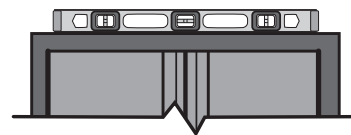

7. Once leveled, using the supplied mounting hardware fasten a 2.5" x 1/4" cabinet mounting lag bolt with a large fender washer through the cabinet and into the stud. This can be done by

NEWAGE STEEL WELDED WALL CABINET INSTALL INSTRUCTIONS

NEWAGE
PRODUCTS INC.

hand with a 7/16" socket wrench or a cordless power drill with a 7/16" socket attachment. Do not over tighten bolts! Once the fender is sitting tightly flush with the backside of the cabinet stop.

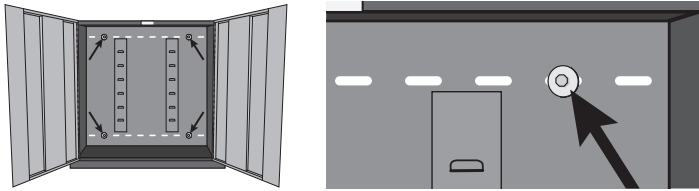

8. Repeat Step 7 three additional times with the remaining mounting hardware.

WALL CABINET WALL MOUNTING INTO CONCRETE BLOCK / MASONRY WALL:

NOTE: Masonry Hardware NOT Included

Required Hardware:

2 1/4" x 1/4" Tapcon Concrete Anchor (4) or #10 x 2" Screw with 3/16" masonry plug (4)

1. Place the wall cabinet into position tight against the supporting wall.
2. Open the doors and locate the perforated mounting strip on the top and bottom of the backside of the cabinet.
3. Place a small magnetic level on top of the wall cabinet and adjust the orientation of the cabinet to bring it to a level position.
4. Using a hammer drill, drill 4 pilot holes through the perforated strip in the backside of the cabinet and through the wall.
5. Using either the 2 1/4" x 1/4" Tapcon Concrete Anchor or #10 x 2" Screw with 3/16" masonry plug method and the supplied fender washers fasten the cabinet directly to the wall. This application requires a cordless power drill for ease of installation.
6. Repeat Step 3 - 5 three additional times with the remaining mounting hardware.

FASTENING CABINETS TOGETHER:

NOTE: For ease of installation and to achieve a professionally installed look it is always better to fasten cabinets together using the supplied 5/8" x 1/4" zinc plated hex bolts and 1/4" - 20 hex lock nuts. Two people are required for this aspect of the installation.

1. Locate cabinet fastening holes on the sides of each cabinet. Two holes are on the top and bottom of the sides of each cabinet.

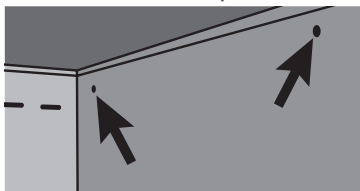

2. With your initial cabinet already securely mounted to the wall or level in place, put a 5/8" x 1/4" zinc plated hex bolt through the hole and into the same hole of the next cabinet you wish to install. Finish off the bolt by hand tightening on a 1/4" - 20 hex lock nut.

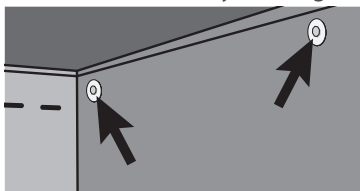

3. Repeat this step for the remaining holes.
4. Using a small magnetic level, level the second cabinet.
5. Once level using a 7/16" wrench and a 7/16" socket wrench tighten the nuts. Ensure both cabinet faces are flush prior to tightening of nuts.
6. Now you can mount the second cabinet directly into the wall.

INSTALLING SHELVES:

NOTE: Plan your shelf heights and install shelves starting from the bottom. The shelves are supported by the metal tabs on the back and side walls of the cabinet.

1. Determine the placement of the shelves.
2. Tilt the shelf so that one end is higher than the other as show in the diagram.

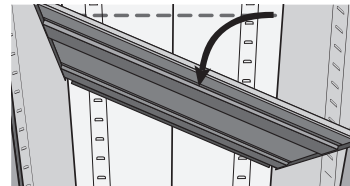

3. Insert the shelf into the cabinet so that the higher end is directly above the desired slots and push the shelf down into place behind the side slots.
4. Raise the lower end so it is directly above the desired slots and push the shelf down.

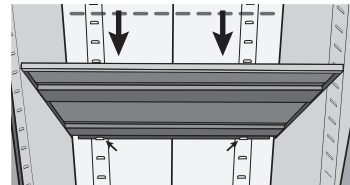

NOTE: Make sure all shelf tabs are completely in place, see below diagram.

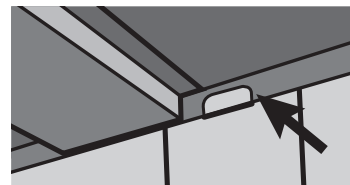

5. Repeat steps 2 - 4 for the remaining shelves.

THANK YOU for purchasing a NewAge Product. Please give us a call, or visit us online if you have any other questions or comments.

NEWAGE
PRODUCTS INC.
THE ORGANIZED GARAGE

201 Chrislea Road, Vaughan, ON, Canada
1-877-306-8930
www.NEWAGEPRODUCTS.com

NEWAGE PRODUCTS INC. WELDED-STEEL CABINETS WARRANTY 10 YEAR LIMITED MANUFACTURER WARRANTY



For ten years from the date of purchase, when this product is installed, operated and maintained according to the instructions attached to or furnished with the product, NewAge Products Inc. will replace the defective product or parts if the part fails as a result of defective materials or workmanship.

NEWAGE PRODUCTS INC. WILL NOT PAY FOR:

1. Service calls to correct the installation of any NewAge products or to instruct you how to use or install them.
 2. Damage resulting from improper handling or shipping of products, or products damaged by accident, misuse, abuse, fire, flood, improper installation, acts of God, neglect, corrosion, modification or mishandling.
 3. Products damaged by improperly loading beyond the specified maximum weight capacity outlined in the instructions provided with the product.
 4. Repairs or replacement when your product is used in other than normal, single-family household use, such as a commercial environment, or handled in any way inconsistent with the installation instructions included with the product.
 5. Cosmetic damage, including scratches, dings, dents or cracks in paint that do not affect the structural or functional capability of the product.
 6. Surfaces damaged due to chemical interaction resulting in corrosion of paint or metal.
 7. Replacement parts for NewAge products outside Canada and the United States.
 8. Replacement keys or locking mechanisms.
 9. Loss of product contents due to theft, fire, flood, accident or acts of God.
 10. Shipping or freight fees to deliver replacement products or to return defective products.
 11. Any labor costs during the limited warranty period.
-
-

DISCLAIMER OF IMPLIED WARRANTIES; LIMITATION OF REMEDIES

IMPLIED WARRANTIES, INCLUDING TO THE EXTENT APPLICABLE WARRANTIES OF MERCHANTABILITY OR FITNESS FOR A PARTICULAR PURPOSE, ARE EXCLUDED TO THE EXTENT LEGALLY PERMISSIBLE. ANY IMPLIED WARRANTIES THAT MAY BE IMPOSED BY LAW ARE LIMITED TO ONE YEAR, OR THE SHORTEST PERIOD ALLOWED BY LAW. SOME STATES AND PROVINCES DO NOT ALLOW LIMITATIONS OR EXCLUSIONS ON HOW LONG AN IMPLIED WARRANTY OF MERCHANTABILITY OR FITNESS LASTS, SO THE ABOVE LIMITATIONS OR EXCLUSIONS MAY NOT APPLY TO YOU. THIS WARRANTY GIVES YOU SPECIFIC LEGAL RIGHTS, AND YOU MAY ALSO HAVE OTHER RIGHTS WHICH VARY FROM STATE TO STATE OR PROVINCE TO PROVINCE