

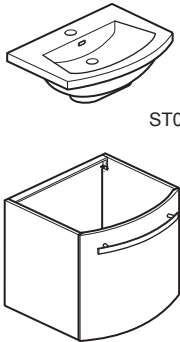

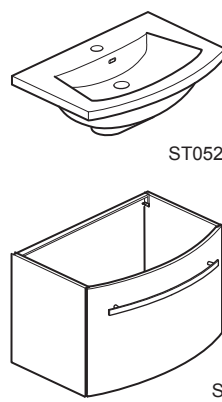

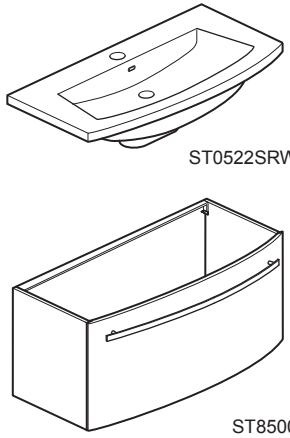

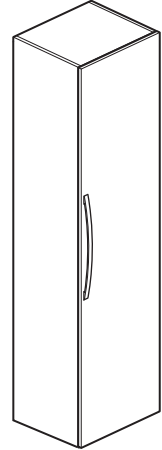











440 Door Vanity Unit & Basin Including 1 pre-fitted glass shelf	590 Drawer Vanity Unit & Basin	850 Drawer Vanity Unit & Basin	Storage Unit Including 4 pre-fitted glass shelves
 <p>ST0520SRW</p> <p>ST4400</p>	 <p>ST0521SRW</p> <p>ST5900</p>	 <p>ST0522SRW</p> <p>ST8500</p>	 <p>ST3016</p>
 4.8X38mmx6  4x25mmx2  x2  x1	 4.8X38mmx6  4x25mmx2  x2  x1	 4.8X38mmx6  4x25mmx2  x2  x1	 4.8X38mmx6  4x25mmx2  4.8x50mmx2  x2  x1

Tools & equipment needed: Drill, 5mm Suitable drill bit, Phillips screwdriver, Spirit level, Ruler/tape measure, Pencil, Silicone sealant (clear).

! IMPORTANT - Advice and safety - Please read before installation

Please read these instructions carefully before starting installation and keep in a safe place for future reference.

Check the contents of the pack carefully before installation. Bauhaus will not be held responsible for any de-fit / re-fit costs where faulty product has been fitted.

If any fault is found with materials or workmanship, it must be reported immediately to the manufacturer. Remedial action will be taken, based on information received, on condition that:

1. Full details are supplied to the manufacturer; 2. The product has not been modified or tampered with; 3. The manufacturer is informed of any damage/shortages prior to installation.

We do not accept responsibility for any problems that may occur through incorrect installation.

! Advice & Safety

This product should be only be installed by a suitably qualified Plumber/installer. Should the installation be completed by a non-qualified person any product guarantee maybe considered invalid. For a claim made under our warranty written certification of your installers qualifications can be required.

It is advised that all doors and drawers are removed prior to fitting to avoid unnecessary damage occurring.

Ensure the room is well heated and ventilated.

It is recommended that walls are fully tiled before furniture and accessory installation. This ensures that the product is installed flat to the tile face and allows product to be easily removed if required in the future.

These instructions have been prepared for your guidance, you must exercise due care at all times.

Please note that some units are heavy. Always take care when lifting, and follow health and safety guidelines. It is recommended that 2 people carry out the installation of larger basin/vanity units.

Handle glass with care. Although the glass supplied is toughened safety glass (to BS6206), impacts can damage both the glass and the furniture.

Warning! Please check for any hidden pipes or electrical cables before drilling holes in the floor or walls.

When using power tools always follow the manufacturer's user instructions.

Care & Cleaning

NEVER use products containing bleach, cleaners of a gritty or abrasive nature or so called "glass and mirror" cleaning products. Use a well wrung chamois leather or micro fibre cloth for furniture carcasses.

Resin wash basins should only be cleaned with a mild detergent or warm soapy water; in hard water areas a good quality lime-scale remover can be applied.

Clean mirrors only with a micro fibre cloth.

If any maintenance is required then it must be carried out by a qualified Plumber.

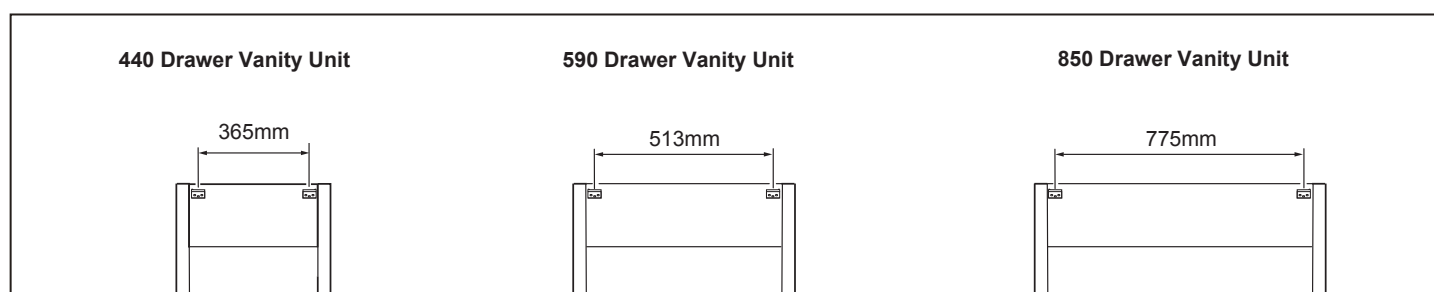

Vanity Unit & Basin Installation - 590 Drawer Vanity Unit is shown as a typical example

Step 1

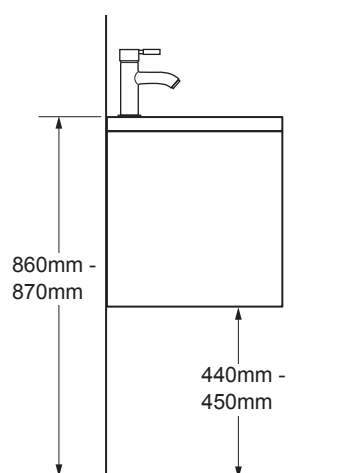

Plan unit position

Decide on the position and height of the unit. The recommended basin height is between 860mm and 870mm.

Mark the fixing positions onto the wall.

Drill Ø 5mm holes, insert the wall plugs and fix using 6 of the large screws.

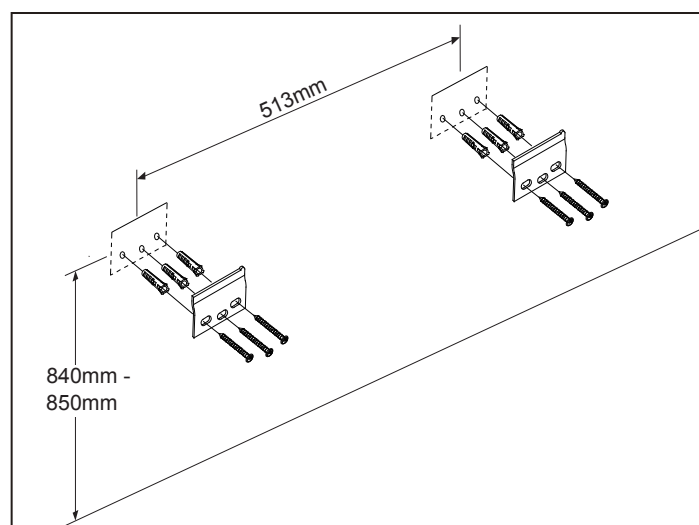

Step 2

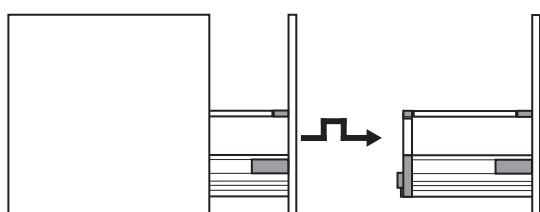

Remove the drawer before installation. Pull out fully, lift the front, pull out again, lower and fully remove.

Door Unit - 440 Door Vanity Unit only

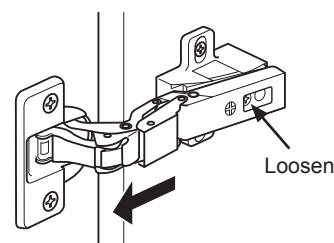

Remove the door before installation. Loosen the screw (shown) on both hinges, pull the door back and lift the hinges off the hinge plates. Remove the glass shelf.

Step 3

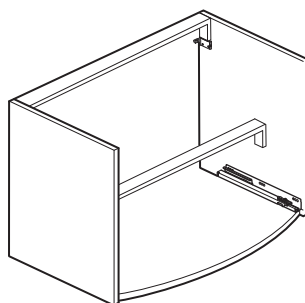

Place the unit centrally onto the lower bracket. Ensure it is level and mark all 4 fixing positions onto the wall.

Remove the unit, drill Ø 6mm holes and insert the wall plugs.

Step 4

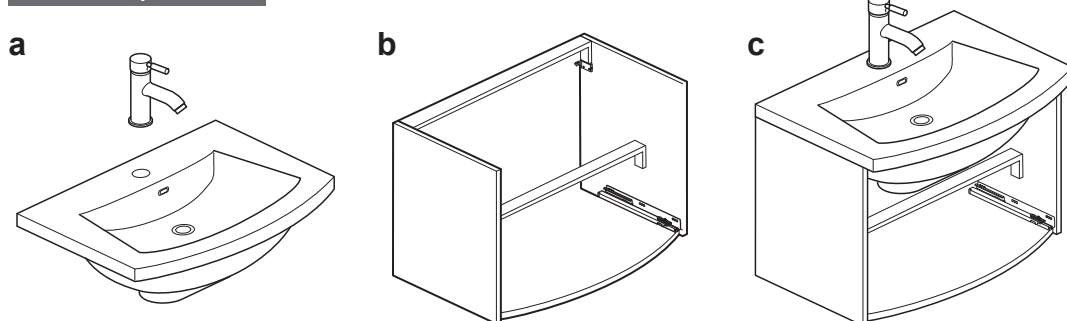

a: Attach the tap to basin and carefully bed in the waste using silicone **only**.

b: Carefully apply silicone to the top edges of the unit.

c: Carefully position the basin down onto the unit, ensure is centrally positioned and flush at the back.

Connect the tap and waste.

Step 5

Door Unit - 440 Door Vanity Unit only

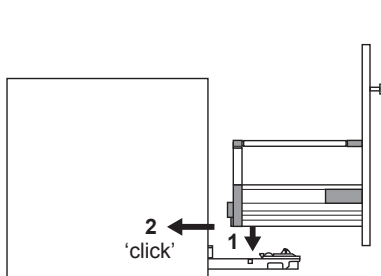

Re-fit drawer: Pull out both runners.
1: Place the drawer onto the runners.
2: Push in until the drawer 'clicks' into position.

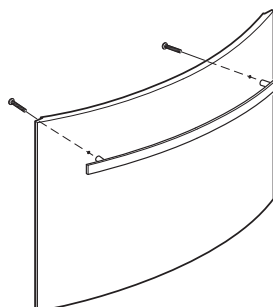

Attach door handle: Attach the handle to the door front. **Note:** Only attach the handle now if **not** changing the opening side (see below).

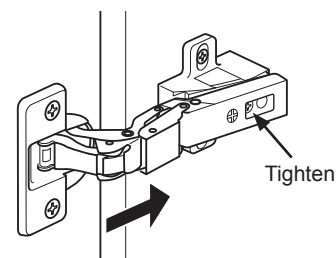

Re-fit door: Reposition both hinges over the screws on the hinge plates. Pull the door forward and tighten the screws. Re-fit the glass shelf.

Changing door opening side

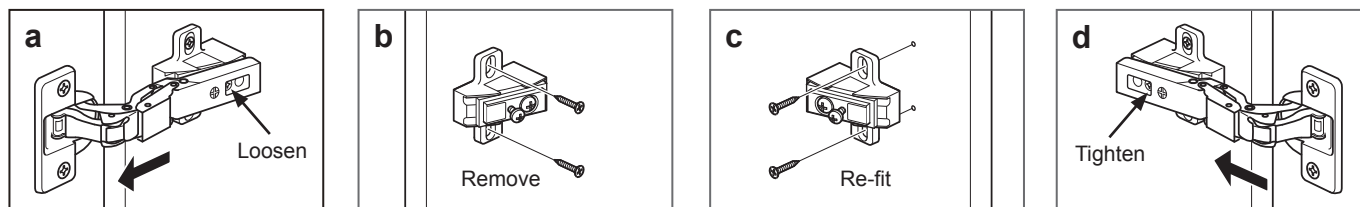

a: Loosen the screw (shown) on both hinges, pull door back and lift the hinges off the hinge plates. **b:** Remove the hinge plates (and soft close mechanism).

c: Re-fit the hinge plates (and soft close mechanism) onto the opposite side. **d:** Rotate the door. Reposition both hinges over the screws on the back plates. Pull door forward and tighten the screws. Attach the handle to the top set of holes on the door.

Hinge adjustment

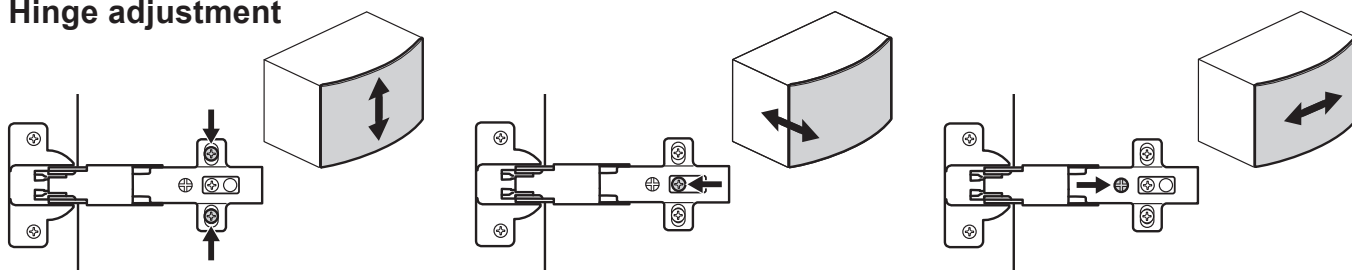

To move door up or down: Loosen screws shown and move door up or down to suit. Re-tighten.

To move door in or out: Loosen screw shown and move door in or out to suit. Re-tighten.

To move door left or right: Loosen screw shown and move door left or right to suit. Re-tighten.

Storage Unit installation

Step 1

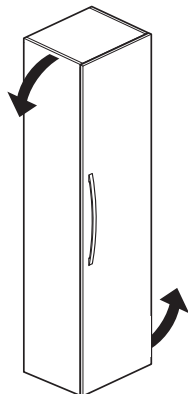

Plan unit position

We suggest positioning the tower unit so it is level with any other unit that has been installed.

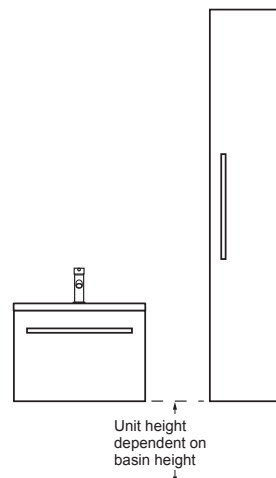

Decide on the opening side of the door, rotate the whole unit to change the opening side.

Drill Ø 5mm holes, insert the wall plugs and fix using the 6 large screws.

Step 2

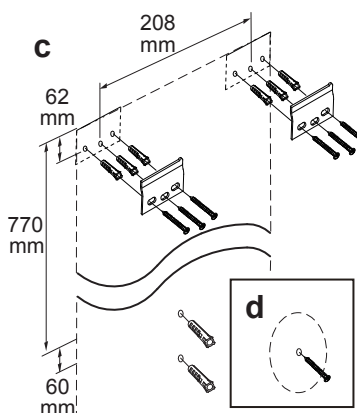
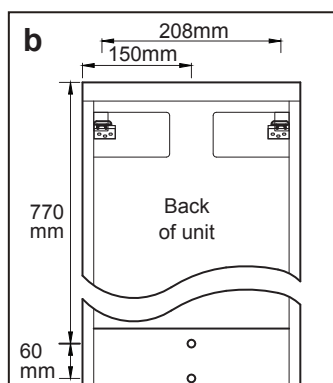
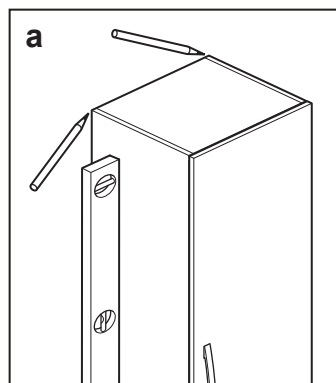

a: Ensure it is vertical and mark top corner positions onto the wall.

b & c: Remove the unit, mark the fixing hole positions onto the wall. Drill Ø 5mm holes, insert the wall plugs and the wall brackets.

d: Positions onto the wall, insert screws.

Step 3

From inside the unit, use a screwdriver to adjust the hanging position.

a: To lift or lower the unit adjust the screw shown.

b: To move the unit closer or further from the wall adjust the screw shown. **Note:** The unit may need to be removed and the 'hanging hooks' adjusted.

When correctly aligned, fix up through the lower bracket into the unit using the small screws.

Note: If door requires adjustment, follow the hinge adjustment section on page 3.

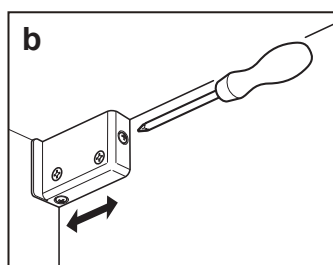
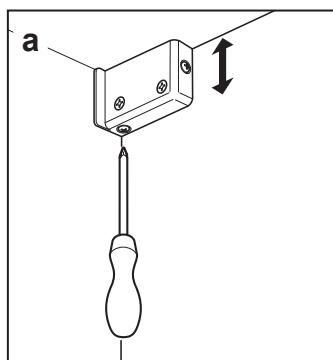

bauhaus

For any further information please contact Bauhaus on: **0845 873 8840**

Or visit our web-site at:
www.bauhaus-bathrooms.co.uk

The manufacturer reserves the right to make technical modifications without prior notice.