

KYOTO INDOOR

Inspired by Japanese architecture with a futuristic style.
Ideal for children to develop their imagination.

FEATURES:

The Kyoto Indoor will be the star of the children`s playroom. With multiple openings, it will be a safe place to play.
Hard, easy to assembly and with all rounded edges.

TECHNICAL SPECIFICATIONS:

Materials:

The indoor childrens playhouses are made up of four outside walls and a horizontal roof. The main material is black MDF wooden boards (Medium Density Fiberboard) coated with melamine on white and lacquered on white RAL9010, 19mm thick.
The hardware is made of highly resistant steel.

Openings:

there are a total of 6 openings; one of them is to enter, and another located on the corner.

Assembly:

Assembly is very simple. In 15' will be ready to play.

Total weight:

65 kg (146 lbs)

Dimensions (W x D x H):

1,20x1,20x1,20m (3'-11"x3'-11"x3'-11")

Recommended age:

- From 3 to 7 years old.

OPTIONAL EXTRAS:

- Roof. We can also provide a full roof on white wood.

RELATED PRODUCTS:

Corner option 3 Walls

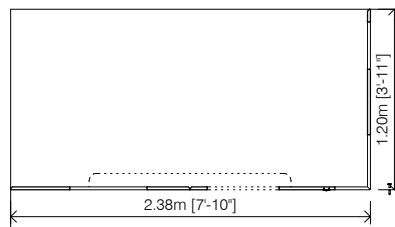

Corner option 2 Walls

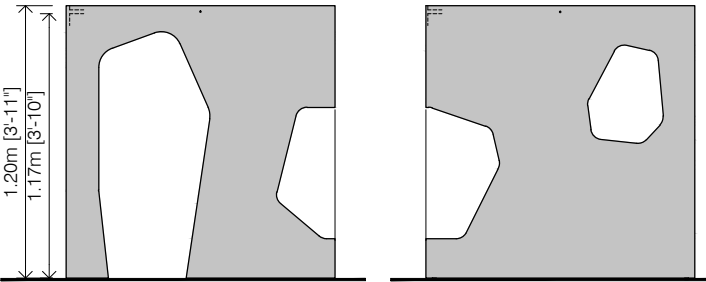
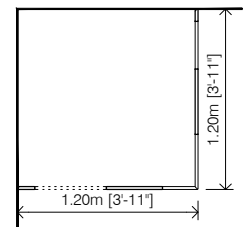

front

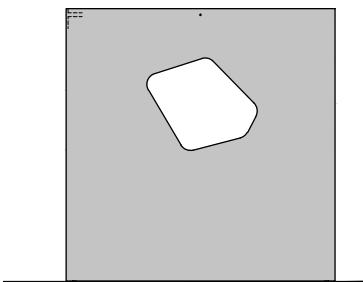

back

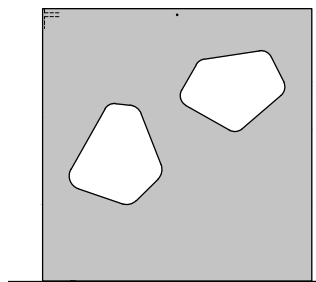

left

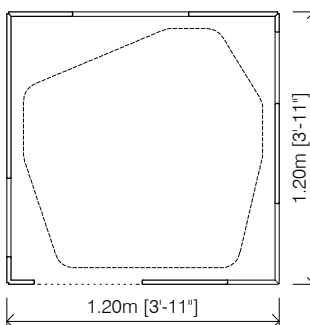

High Security Standards
Best quality
Nordic Pedagogy