

# HOBIKKEN MINI

This wooden playhouse is inspired by Nordic architecture, with predominately warm colours and red and dark tones.

## FEATURES:

- The small model of the Hobikken product line, it is very light and easy to assemble.
- Made completely with Birch marine plywood, with a natural finish and lasur treatment.

## TECHNICAL SPECIFICATIONS:

### Materials:

- The main material of this playhouse is Birch plywood. It is a material that is highly resistant since it made of a dense wood and glued with phenolic resins ideal for wet environments, with a water-borne woodstain finish for water and UV protection.
- Bevelled corners and weather-proof windows.

### Flooring:

The indoor flooring is also made of Birch plywood with phenolic glue. The top layer of the floor is finished with a non-slip material, similar to those used on slides and other children's playground equipment.

### Roof:

The **roof** has thermal insulation and precast waterproof EPDM rubber material with a water drain pipe incorporated from warehouse, to guarantee total water tight closure.

### Doors and windows:

- Has one door with design handles and finger protection in the hinge area, one operable windows, and 2 stationary windows. All made with methacrylate for safety. The door that opens outward for security reasons.

### Total weight:

- 320 lb (145Kg)

### Recommended age:

- From 3 to 8 years old.

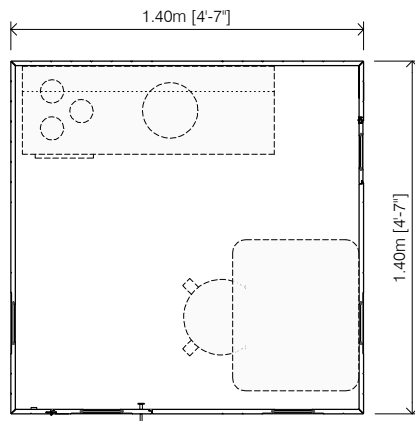
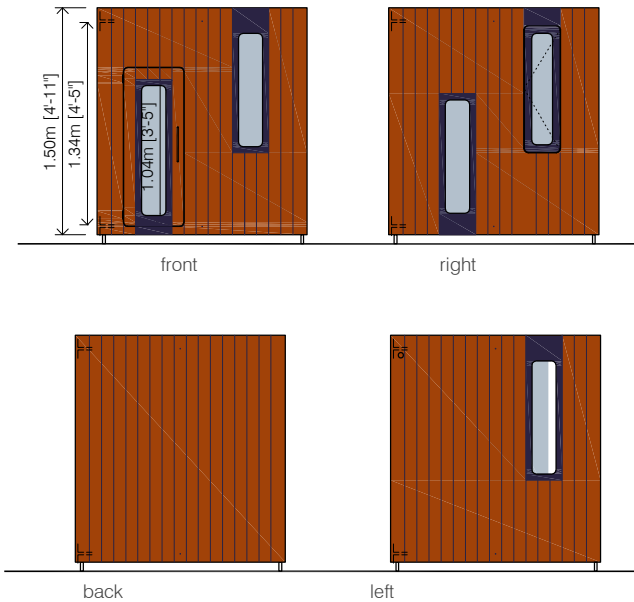

## OPTIONAL EXTRAS:



- **Lighting.** The playhouses can be equipped with various interior lighting systems with low voltage lighting made of white warm LED downlight. In this case it works with 2 3W Recessed lights with optics to choose from, at 12V. The switch is next to the door. Electrical box under flooring, can be registered from the inside .



- **Soft natural carpet flooring.** A very high-end carpet from the InterfaceFLOOR, and designed for public concurrence. Provided with 50x50cm tufted plain level loop tiles , are very easy to install and clean. Grey colour with some white and black, model Heuga 727, ref.7901



- **Lock set.** For safety, the door can only be closed from the outside.



- **Guides for curtain.** Supply rails as including parts for corners and curved sliding parts to support the curtain, which is not included.



- **Artificial Grass over roof.** To improve the finish of the exterior roof, it's possible to cover the roof with artificial grass, or white marble gravel.



High Security Standards  
Best quality  
Nordic Pedagogy