



OWNER'S MANUAL



PROFESSIONAL 41" STAINLESS STEEL ELEVEN DRAWER TOOL CHEST

Model # HLRT24111

SAFETY PRECAUTIONS

In using your TRINITY Tool Chest, please observe the following safety precautions:

CAUTION



Lock wheels when leaving tool chest in a stationary position



Lock all drawers and lid before moving the tool chest!



Do not open all drawers at once - tool chest may tip over!



Do not step on open drawers!



Do not let children play near chest!

PARTS LIST

Your TRINITY Professional 41" Stainless Steel Eleven Drawer Tool Chest should include the following parts. Before assembling, unpack the carton and lay out all of the parts described below. If you are missing any parts, need assistance with assembly or have questions, please contact TRINITY Customer Service at 800.985.5506 or at customerservice@TRINITYii.com. Parts can also be requested online at our customer center at www.TRINITYii.com.

TOP CHEST

A



SIDE HANDLE SCREWS (12)

B



SIDE HANDLES (2)

C

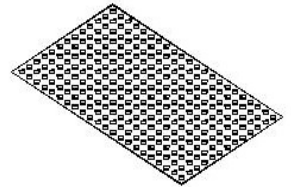

LINERS (7)

D



KEYS (2)



PARTS LIST

BOTTOM CHEST

E



SIDE HANDLE SCREWS (12)

F

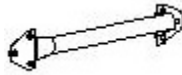

SIDE HANDLES (2)

G



SWIVEL CASTER W/O LOCK (2)

H



SWIVEL CASTER W/LOCK (2)

I



REAR BRACES (2)

J



REAR BRACE SCREWS (8)

K



SWIVEL CASTER SCREWS (16)

L



KEYS (2)

M

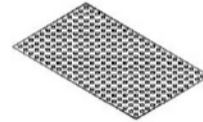

LINERS (6)

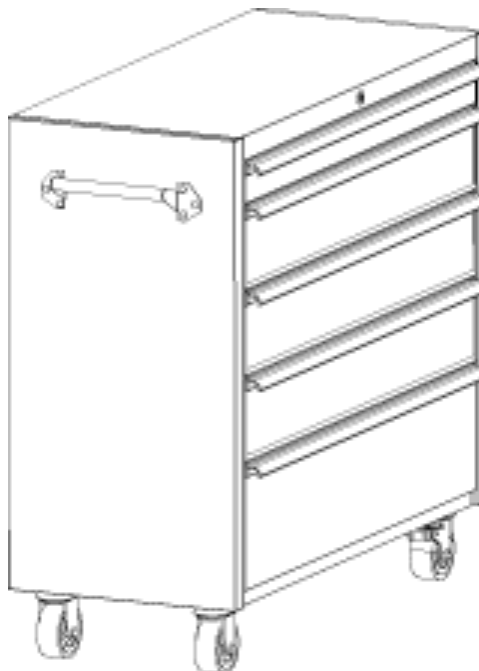

ASSEMBLY INSTRUCTIONS

STEP 1: INSTALLING SIDE HANDLES

Be sure to assemble the **SIDE HANDLES (B,F)** on both the Top and Bottom Chests to make it easier to move your Tool Chest

Position the **SIDE HANDLES (B,F)** over the precut holes and attach them using the (mid-sized) **SIDE HANDLE SCREWS (A,E)**. Tighten securely.

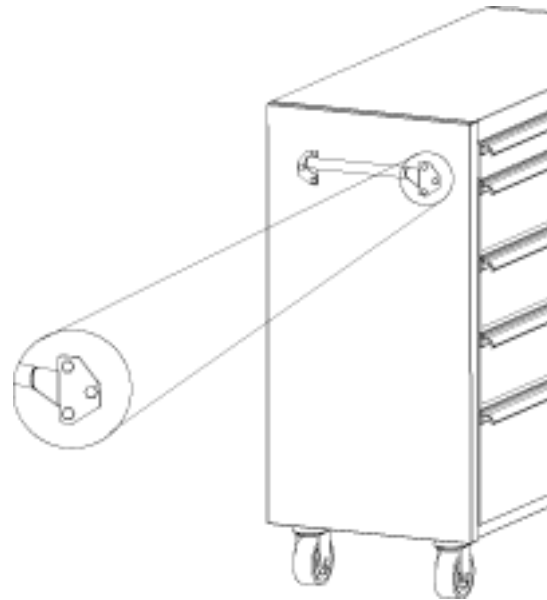

STEP 2: INSTALLING SWIVEL CASTERS

Carefully lay the Bottom Chest on its back. Position the two **SWIVEL CASTERS W/O LOCKS (G)** on the right side. Position the two **SWIVEL CASTERS W/LOCKS (H)** on the left side. Insert the (large-sized) **SWIVEL CASTER SCREWS (K)** through the **SWIVEL CASTERS (G,H)**, and then into the bottom of the Chest. Tighten securely.

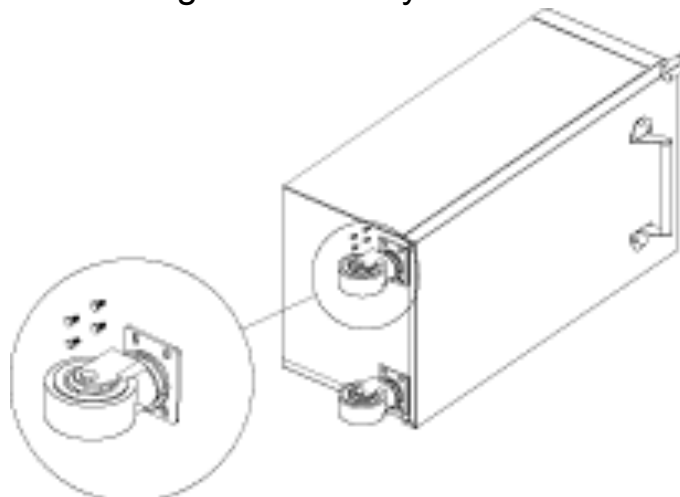

ASSEMBLY INSTRUCTIONS

STEP 3: INSTALLING REAR BRACES

Be sure to assemble the **REAR BRACES (I)** to secure the Top Chest to the Bottom Chest.

Position the **REAR BRACES (I)** over the precut holes at the back edge where the two Chests adjoin, and attach the **REAR BRACES (I)** using the (small-sized) **REAR BRACE SCREWS (J)**. Tighten securely.

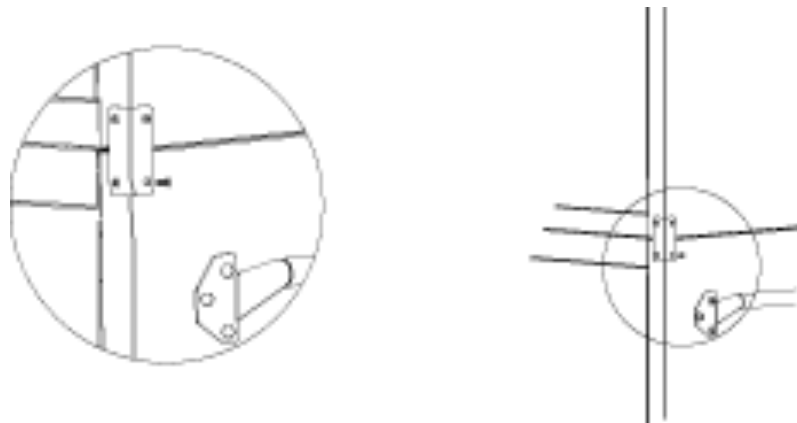

STEP 4: INSTALLING DRAWER LINERS

Simply Place the **LINERS (C, M)** inside the top compartment and inside of each drawer

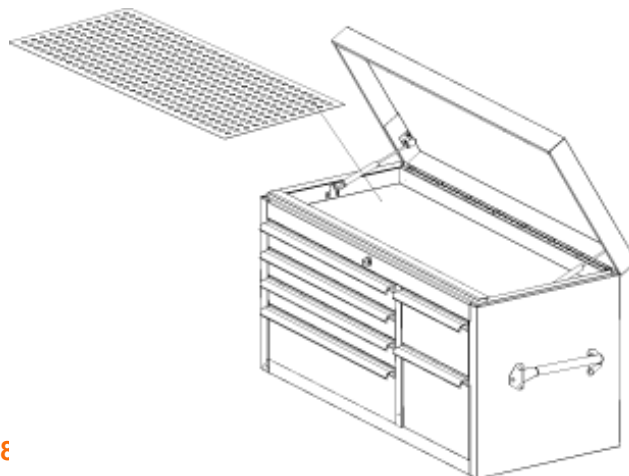

USAGE INSTRUCTIONS

DRAWER REMOVAL

Pull the drawer out so that it is almost fully extended. Push the back release lever DOWN on the RIGHT-hand side. Pull the black release lever UP on the LEFT-hand side. While holding the levers as instructed, pull the drawer forward until released from the slides attached to the Tool Chest (“Tool Chest Slides”). **Note:** The slides attached to the drawer (“Drawer Slides”) are an integral part of the drawer and must be removed along with the drawer itself.

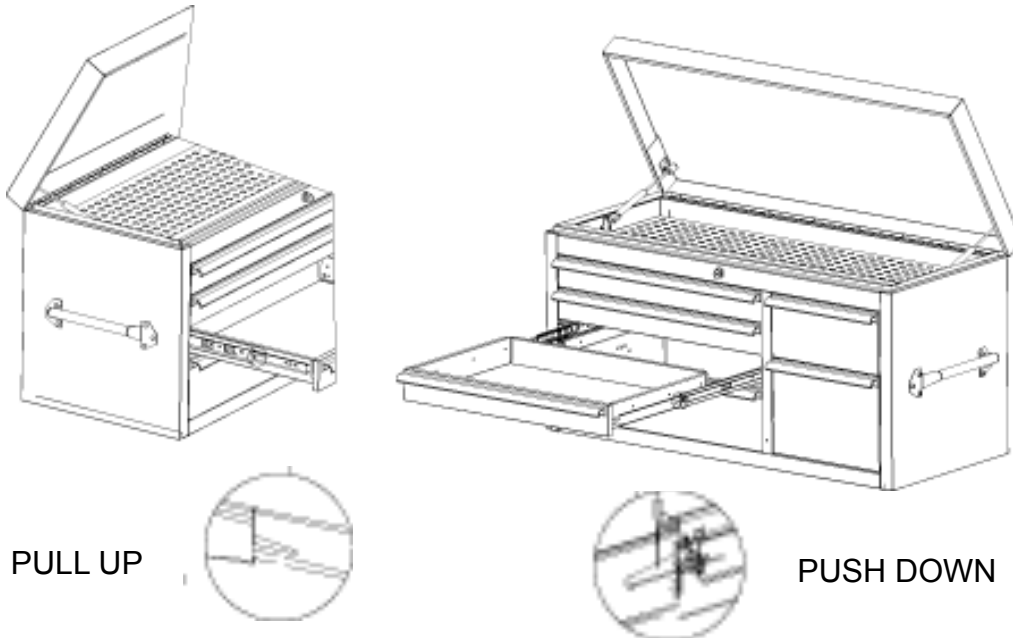

DRAWER REPLACEMENT

Extend the Tool Chest Slides for the drawer to be replaced. Insert the brackets on each side of the Drawer Slides into the corresponding slots on the Tool Chest Slides, making sure they are properly positioned. Once the brackets are inserted into the slots, completely close the drawer to set all slides in their proper positions.

SERVICE PARTS LIST

TRINITY Customer Service provides the following replacement parts:

- 1) HLRT-SH: Side Handle
- 2) HLRT-GL: Gas Lift
- 3) HLRT-LINER: Drawer Liner
- 4) HLRT-SLTC: Tool Chest Slide
- 5) HLRT-SLDR: Drawer Slide
- 6) HLRT-MDRS: Medium Drawer (w/ Front Face Panel)
- 7) HLRT-LDRAH: Medium Aluminum Drawer Handle
- 8) HLRT-LCDRS3: Large Complete Set
- 9) HLRT-KEY: Keys
- 10) HLRT-LOCK: Lock
- 11) HLRT-SCDRS6: Short Complete Drawer 6" Set
 - HLRT-SCDRS3: Short Complete Drawer 3" Set
- 12) HLRT-SCDRS3: Short Complete Drawer 3" Set

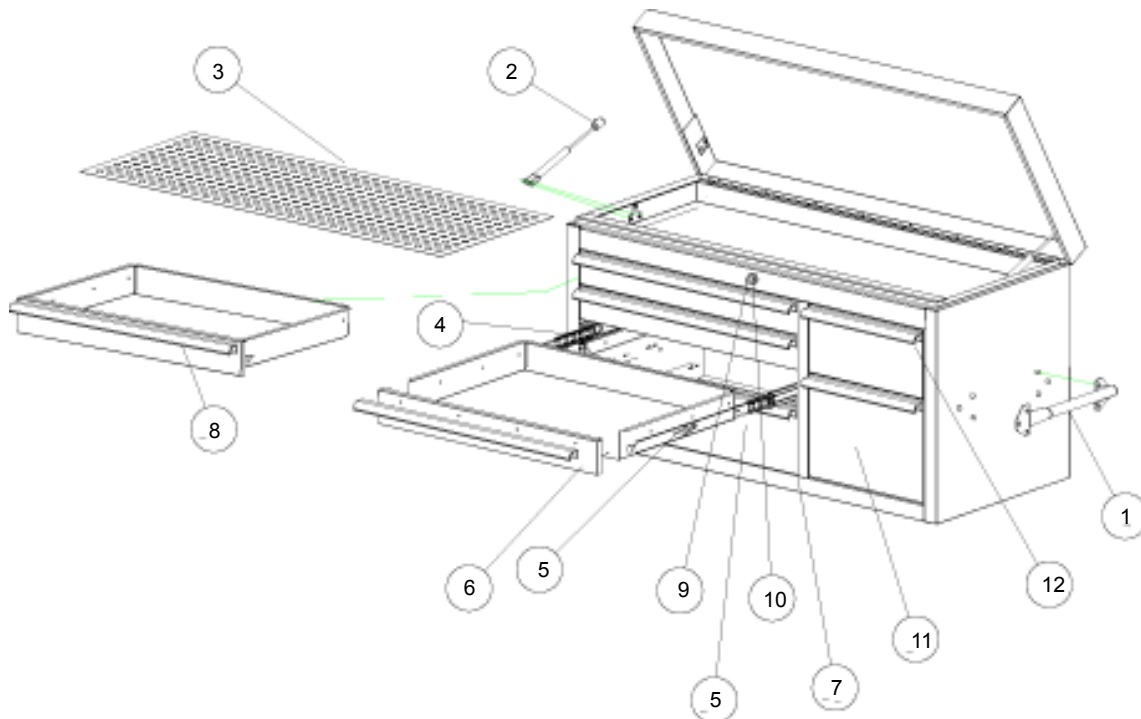

NOTE: Replacement keys may be ordered using the code shown on the face of the lock. The Top and Bottom Chests may have different key codes.

SERVICE PARTS LIST

TRINITY Customer Service provides the following replacement parts:

- | | |
|--|---|
| 1) HLRT-SH: Side Handle | 10) HLRT-LCDRS6: Large Complete Set 6" Deep |
| 2) HLRT-BRACE: Rear Brace | 11) HLRT-LCDRS3: Large Complete Set 3" Deep |
| 3) HLRT-LOCK: Lock | 12) HLRT-LINER: Drawer Liner |
| 4) HLRT-KEY: Keys | 13) HLRT-LCDRS9: Large Complete Set 9" Deep |
| 5) HLRT-SLTC: Tool Chest Slide | 14) HLRT-SCWOL: Swivel Caster w/o Lock |
| 6) HLRT-SLDR: Drawer Slide | 15) HLRT-SCWL: Swivel Caster w/Lock |
| 7) HLRT-LDR: Large Drawer (w/o Front Face Panel) | |
| 8) HLRT-LDR: Large Drawer (w/Front Face Panel) | |
| 9) HLRT-LDRAH: Large Aluminum Drawer Handle | |

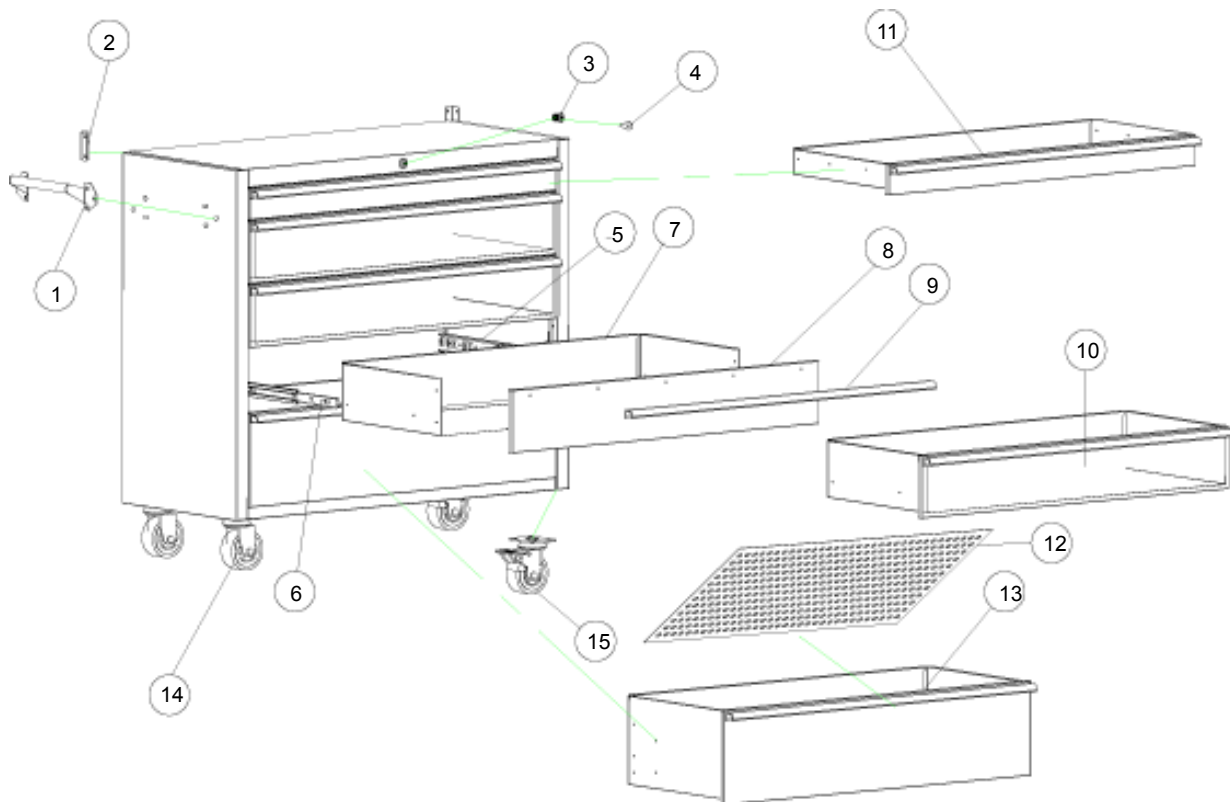

LIMITED WARRANTY

TRINITY PROFESSIONAL 41" STAINLESS STEEL ELEVEN DRAWER TOOL CHEST Model # HLRT24111

TRINITY warrants to the original consumer purchaser ("Purchaser") of the TRINITY Professional 41" Stainless Steel Eleven Drawer Tool Chest ("Product") that each Product shall be free from defects in workmanship and materials for a period of 1 year from the date of original purchase. TRINITY's obligation under this warranty shall be limited to repair or replacement of, or adequate compensation for, the Product, at the option of TRINITY, during the warranty period. TRINITY's liability shall not extend beyond repair or replacement, or the cost equivalent thereto.

This warranty excludes normal wear and tear of the Product and its parts or components, and damage arising from any of the following: negligent use or misuse of the Product, use contrary to this Owner's Manual, or alteration by any one other than TRINITY. This warranty exclusion includes purchasing open-box and returned items. The warranty period of 1 year shall not be extended or renewed by the repair or replacement of, or compensation for, the Product.

If your Product is defective or otherwise requires service or parts, please first call TRINITY Customer Service toll-free at 800.985.5506, between 8:00 a.m. to 5:00 p.m., PST, or send an e-mail to customerservice@TRINITYii.com. You can also request assistance online at our customer center at www.TRINITYii.com. TRINITY commits to using its very best efforts to honor this warranty, and repair, replace or compensate you for your Product through your original place of purchase. Please tell us which model you purchased, the date of purchase, and the problem with your Product. A copy of your original purchase receipt and a completed copy of your product registration must accompany your service request.

LIMITATION OF REMEDIES AND LIABILITY

TRINITY shall not be liable for any incidental or consequential damages for breach of any express or implied warranty on its Product. Except to the extent prohibited by applicable law, any implied warranty or merchantability or fitness for a particular purpose on this Product shall be limited to the duration of the above warranty. Neither TRINITY nor anyone else who has been involved in the creation, production, or delivery of the Product shall be liable for damages of any type, including but not limited to any lost profits, lost savings, loss of anticipated benefits, or other incidental or consequential damages which may arise out of the purchase, use, or inability to use the Product, whether arising out of contract, negligence, strict tort, or under any warranty, or otherwise, even if you have been advised of the possibility of such damage or any other claim by any other party. TRINITY's liability for any breach of warranty shall be limited to repair or replacement of the defective part or parts as described above. Some states do not allow the exclusion or limitation of incidental or consequential damages, so the above limitation or exclusion may not apply to you. The above warranty gives you specific legal rights, and you may have other rights which vary from state to state.



PRODUCT REGISTRATION

Thank you for purchasing a TRINITY Professional 41" Stainless Steel Eleven Drawer Tool Chest. In order to register your product to receive streamlined customer service, please fill out the following Product Registration Form and (1) fax the form to FAX 310.347.4134 (2) complete the Product Registration Form online at www.TRINITYii.com (3) or scan and email the form to customerservice@TRINITYii.com. Include a copy of your original receipt with your submission.

First Name: _____ Last Name: _____

Address: _____

City: _____ State: _____ Zip Code: _____

Email Address: _____ Phone: _____

Product Model #: _____ Purchase Date: ____/____/____

Location of Purchase: _____

Please rate the importance of each feature (1=least important; 10=most important)

Quality ____ Price ____ Size/Capacity ____ Appearance ____ Other ____

What other brands did you seriously consider before making this purchase?

- Craftsman Snap On Waterloo
 Matco Other Did not consider other brands

How did you hear about our product?

- Magazine Ad Catalog Salesperson Word of Mouth
 Internet Store Display Other

Marital Status: Single Married

Household Income: Below \$50,000 \$50,000-\$150,000 \$150,000+

Education: High School College Graduate School

Primary Residence: Own Rent

Comments/Suggestions:

CONTACT US

**QUESTIONS? NEED PARTS?
WE ARE HERE TO HELP!**

**To receive your replacement part, please fax or email
your receipt and product registration along with your
name, address and a brief description of your problem to:**

TRINITY Customer Service

TEL: 800.985.5506

FAX: 310.347.4134

EMAIL: customerservice@TRINITYii.com

**Monday through Friday
8:00 AM – 5:00 PM (PST)**

www.TRINITYii.com