

88 5123 89C

Bar Stool Set with Decorative Stainless Steel Accents

(Set includes two Bar stools and one High Table)

Thank you for purchasing our quality products. Please carefully check the quantity of the parts and hardware. Please also read this assembly instructions until you understand clearly how to put the parts together, then start assembling step by step.



Casual Attire For Today's Home

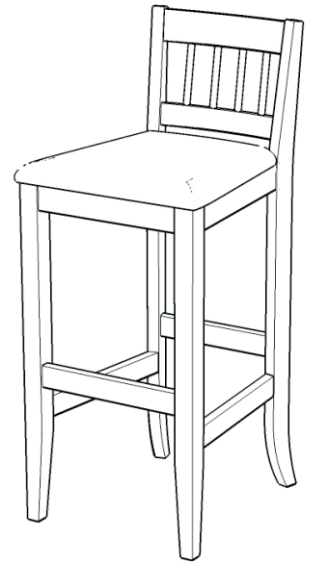

PART LIST

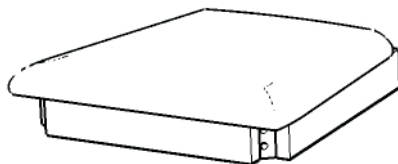

A.
Seat
1 pc.

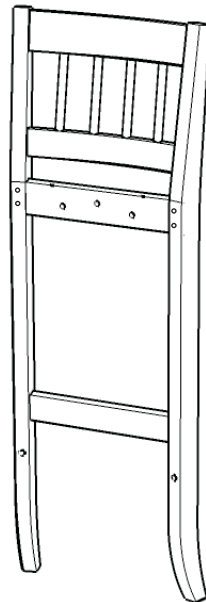

B.
Back Frame
1 pc.



C.
Leg
1 pc.



D.
Leg
1 pc.

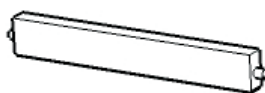

E.
Front Stretcher
1 pc.



F.
Side Stretcher
1 pc.

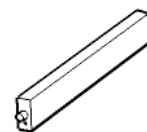

G.
Side Stretcher
1 pc.

HARDWARE LIST



Hex Wrench
1 pc.



Head Cap Bolt (short)
3 pcs. (+1 extra)



Wood Screw
6 pcs. (+1 extra)



Spring Washer
11 pcs. (+1 extra)



Small Hex Wrench
1 pc.



Head Cap Bolt (middle)
4 pcs. (+1 extra)



Head Cap Bolt (long)
4 pcs. (+1 extra)

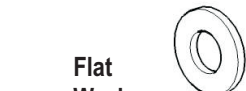

Flat Washer
11 pcs. (+1 extra)

Tools Required For Assembly : **Phillips** screwdriver

Home Styles Consumer Assistance Line 888-680-7460 and 877-831-0319
servicedesk@homestyles-furniture.com

Assembly Instructions

IMPORTANT

* Do not tighten up all the screws until each part is properly assembled.

* You should keep Hex Wrench in the safe place as you may need to tighten up the Head Cap Bolts in the future.

STEP 1

Attach the Leg (C) to Seat (A) with Head Cap Bolts (middle), Spring Washers and Flat Washers. Attach the Front Stretcher (E) to the Leg (C). Attach the Leg (D) to the Assembled Unit with Head Cap Bolts (middle), Spring Washers and Flat Washers, then tighten Head Cap Bolts half way. Insert the Wood Screws from the Front Stretcher (E) to the Legs (C) and (D) as shown, tighten them up.

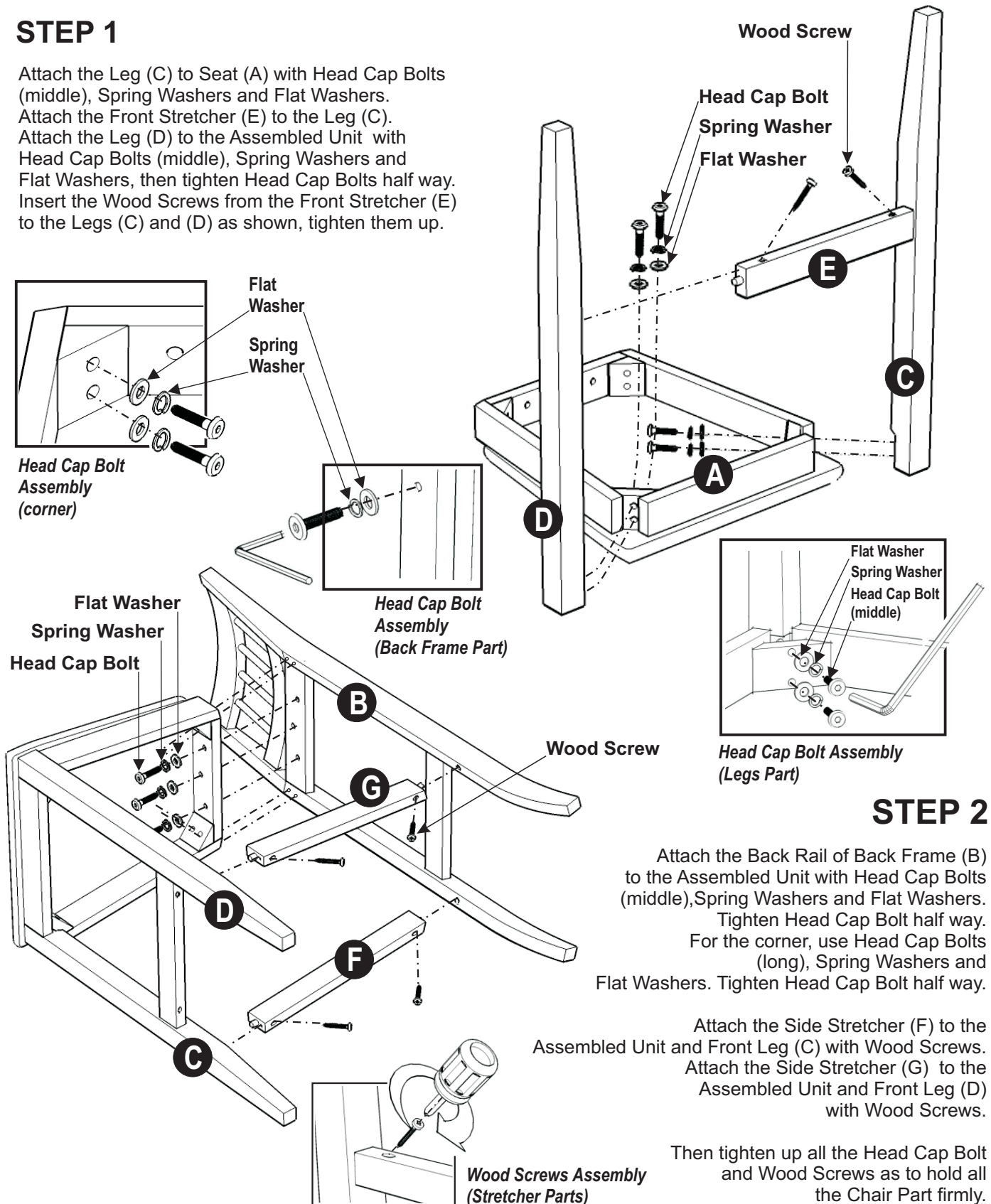

STEP 2

Attach the Back Rail of Back Frame (B) to the Assembled Unit with Head Cap Bolts (middle), Spring Washers and Flat Washers.

Tighten Head Cap Bolt half way. For the corner, use Head Cap Bolts (long), Spring Washers and Flat Washers. Tighten Head Cap Bolt half way.

Attach the Side Stretcher (F) to the Assembled Unit and Front Leg (C) with Wood Screws. Attach the Side Stretcher (G) to the Assembled Unit and Front Leg (D) with Wood Screws.

Then tighten up all the Head Cap Bolt and Wood Screws as to hold all the Chair Part firmly.