

Assembly Notes

MODULICIOUS 5

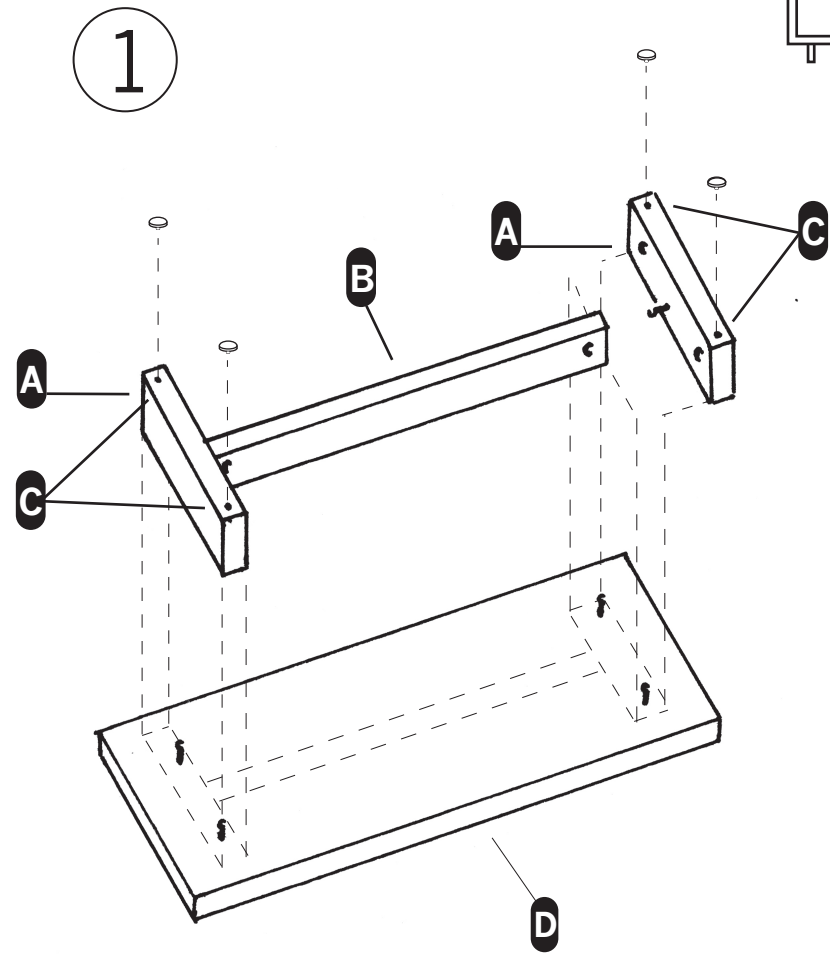

2

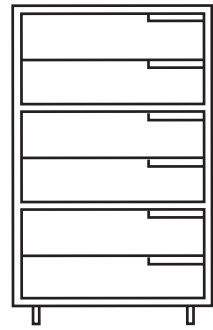
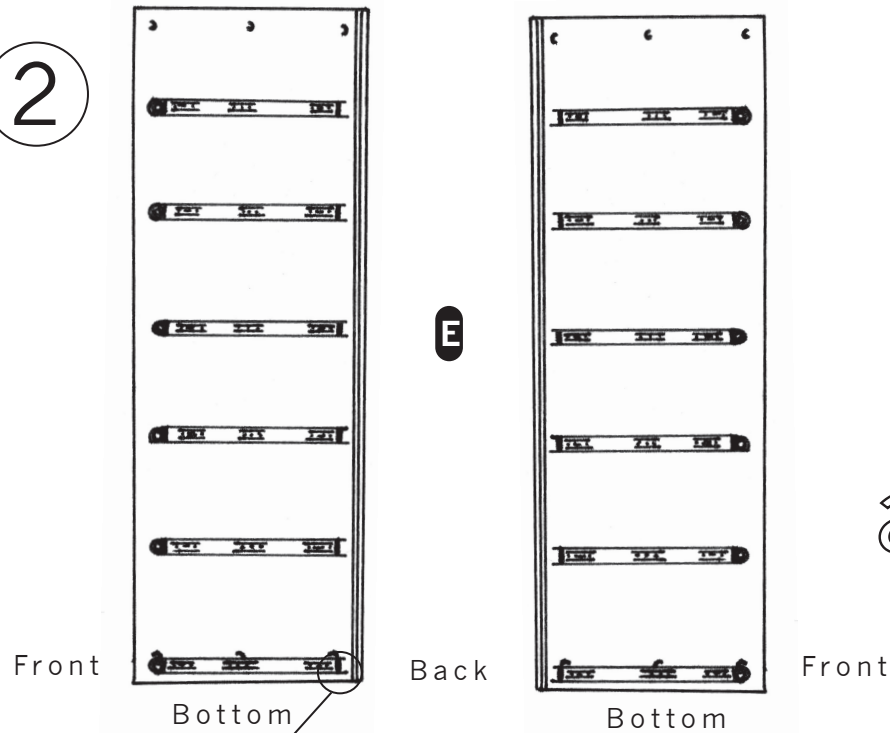

a drink

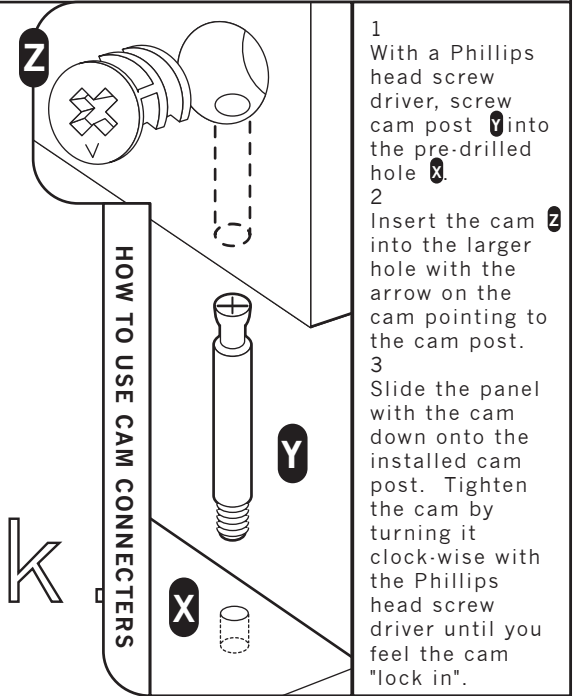

- 1 With a Phillips head screw driver, screw cam post **X** into the pre-drilled hole **Z**.
- 2 Insert the cam **Z** into the larger hole with the arrow on the cam pointing to the cam post.
- 3 Slide the panel with the cam down onto the installed cam post. Tighten the cam by turning it clock-wise with the Phillips head screw driver until you feel the cam "lock in".

First,
make...

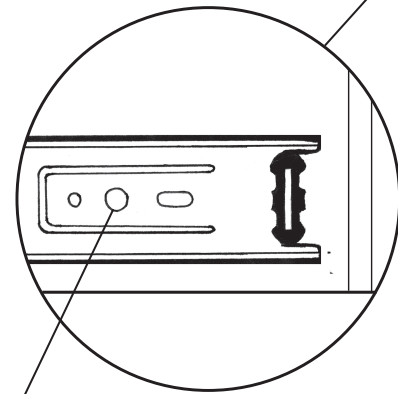

Your first screw goes here

3

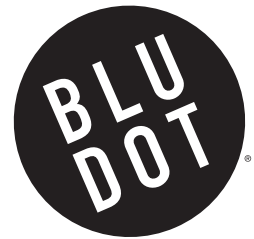
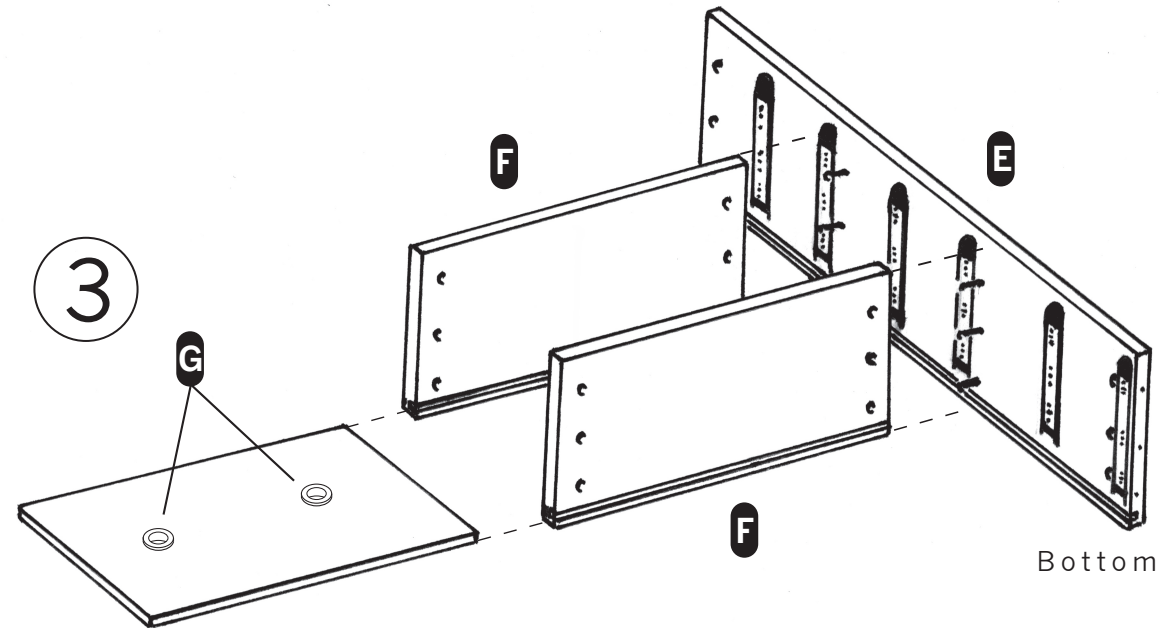

Assemble on carpet or protective mat.
Before beginning, familiarize yourself with using cam connectors. (see insert right corner)

- 1 See sketch 1. Screw the cam post into the small hole on the side of each foot **A**. Place the two cams in the stretcher **B** so that the arrow points towards the end of the stretcher and turn the cams to the right until snug. Now, you know how cams work (a valuable skill). Locate the bottom panel **D**. This panel has holes drilled on both faces (the top panel has holes on only one side). Find the side with the groove. Place this side face down. Now with the other side facing up, screw cam posts into all four holes. Place cams into the four holes on the feet **A**.
- 2 Attach feet/stretcher assembly to bottom panel by turning cams until snug. See sketch 1. Push foot tacks into holes on bottom side of the feet **C**.
- 3 Turn this whole assembly over so it faces right side up, install six more cam posts and set aside.

- 4 Locate the 2 side panels **E** (the sides have grooves on the back edge). Lay them with the grooves facing up (Sketch 2). Screw all drawer slides onto panel as shown (the rounded side of the glide goes towards the front). Then screw cam posts into the 6 holes in the middle of each side panel. Locate the shelves **F** (these have grooves on both sides). **IMPORTANT:** With the panels oriented as in Sketch 3, fasten one shelf to one side panel **ONLY** and tighten cams. Repeat for second shelf. Insert a white back panel into the grooves at the back of the shelves.
- 5 Install the black grommets **G** into the holes in the back panels by squeezing them into place.

HARDWARE INVENTORY



30 cams

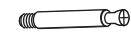

30 cam posts



4 foot tacks



6 black grommets



24 slide screws

WOOD COLOR OVER TIME: Air and daylight will naturally change the color of the wood. For most woods, this change is gradual and very slight. During the first several months, while the patina is developing, items placed on the wood should be rotated to different locations to prevent uneven coloration. Over time an even patina will develop.

BLU DOT DESIGN AND MANUFACTURING, INC. copyright 200.
www.bludot.com / t. 612.782.1844 / f. 612.782.1845

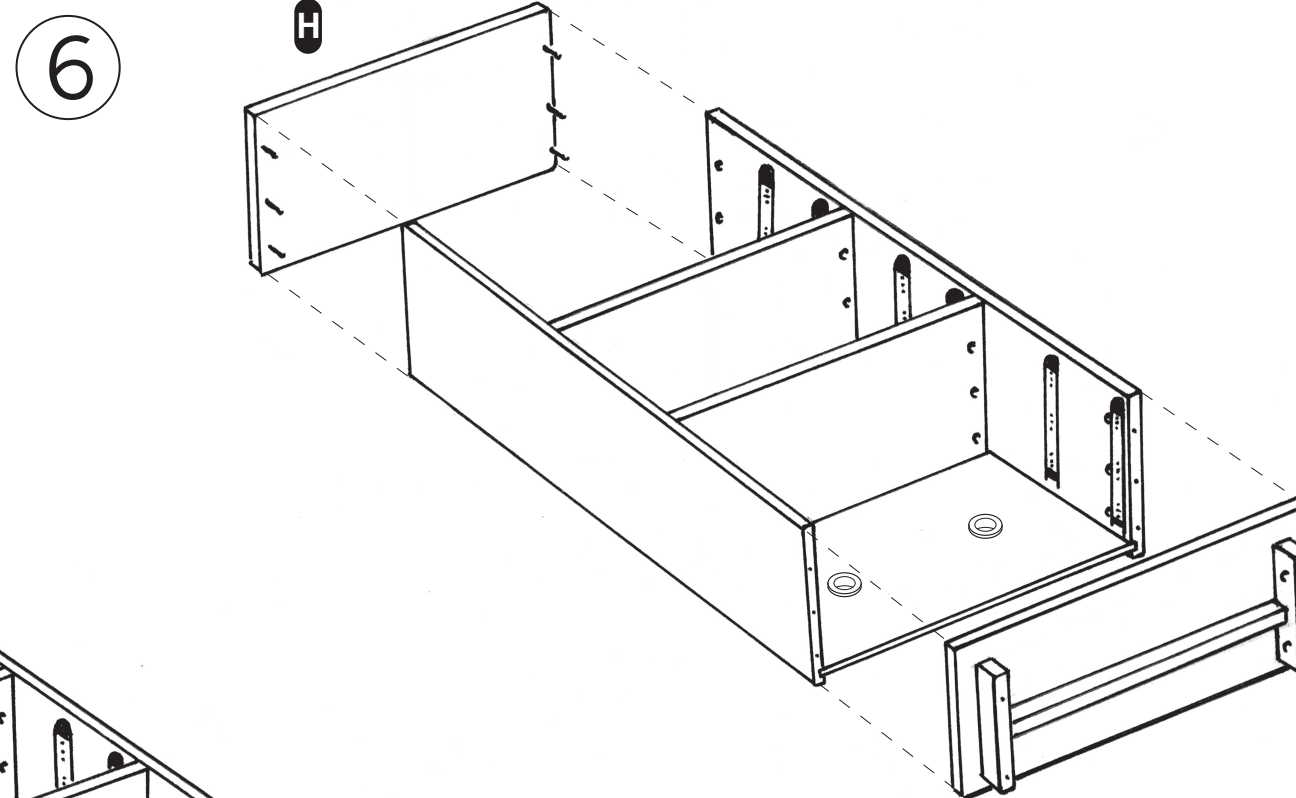
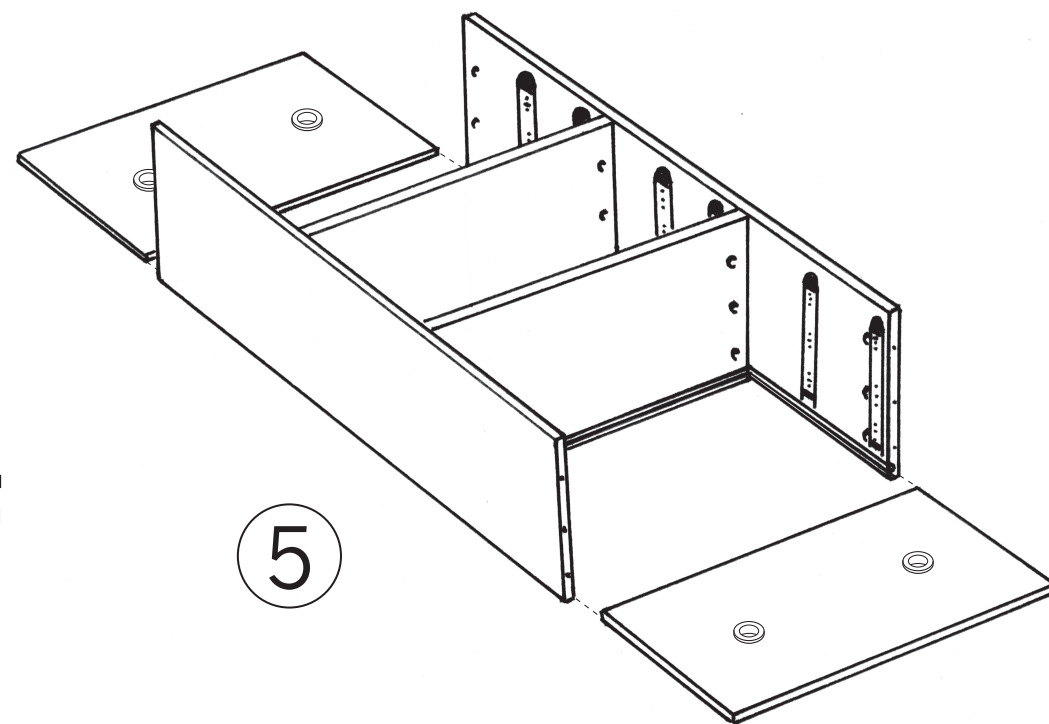
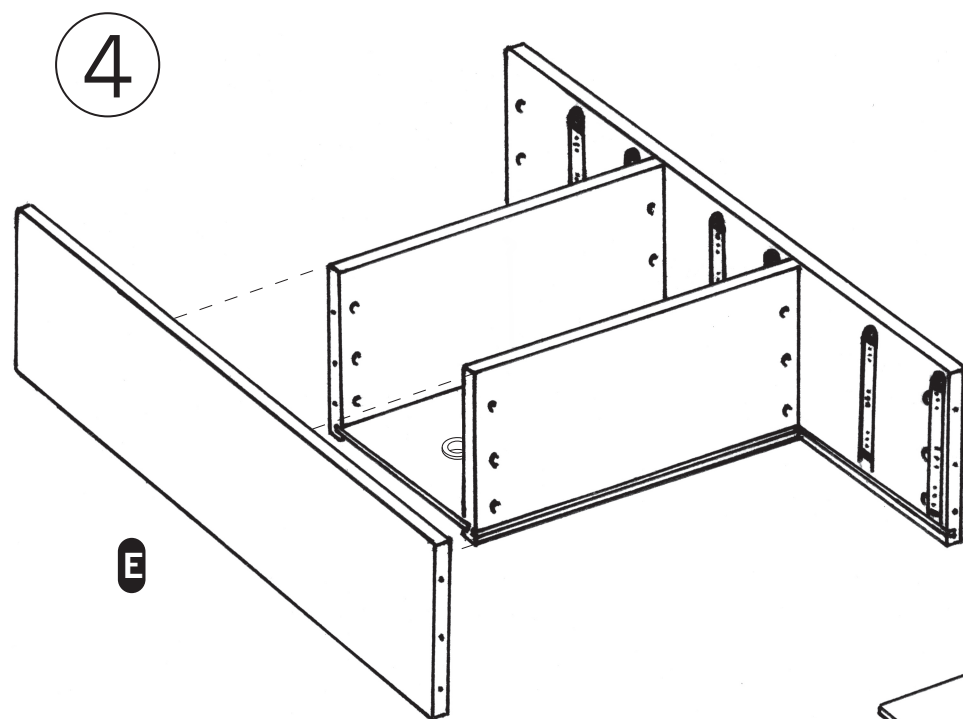
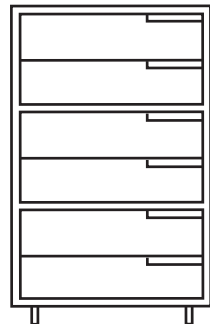

Tired of

screwing?

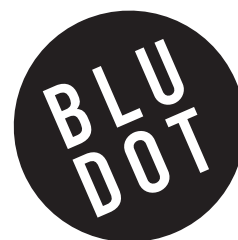

Assemble on carpet or protective mat.
Before beginning, familiarize yourself with using cam connectors. (see insert right corner)

- 5 | Attach the other side panel **E** to the shelves and tighten all cams (Sketch 4). You should now have an "H" shaped assembly.
IT IS IMPORTANT TO NOT MOVE THE "H" SHAPED ASSEMBLY UNTIL THE BACK PANELS, TOP AND BOTTOM ARE INSTALLED.
- 6 | Take the remaining two back panels and insert them between the side panels (Sketch 5). Attach the base unit to the side panels (NOTE: the cams on the shelves should be facing the base). Make sure the groove on the bottom panel lines up with the grooves on the side panels. See Sketch 6.
- 7 | Tighten all cams.

- 8 | Install 6 cam posts into the top panel **H**. Attach top panel and tighten cams (Sketch 6).
- 9 | Grab a friend to help tip the unit upright. To install each drawer, pull the ball bearing cartridges on the cabinet slides to the front. Align drawer mounted slides with the cabinet slides and slide it in. Repeat for all drawers. Make another drink.

WOOD COLOR OVER TIME: Air and daylight will naturally change the color of the wood. For most woods, this change is gradual and very slight. During the first several months, while the patina is developing, items placed on the wood should be rotated to different locations to prevent uneven coloration. Over time an even patina will develop.

BLU DOT DESIGN AND MANUFACTURING, INC. copyright 2005.
www.bludot.com / t. 612.782.1844 / f. 612.782.1845