

# Arim Large

**700WSARML\_-LED** 1.0



**GENERAL PRODUCT INFORMATION:**

Mount to either a 4" square electrical box with round plaster ring or an octagonal electrical box.



Suitable for damp locations.

**CAUTION - RISK OF FIRE**  
This product must be installed in accordance with the applicable installation code by a person familiar with the construction and operation of the product and the hazards involved.  
Use minimum 90°C supply conductors.

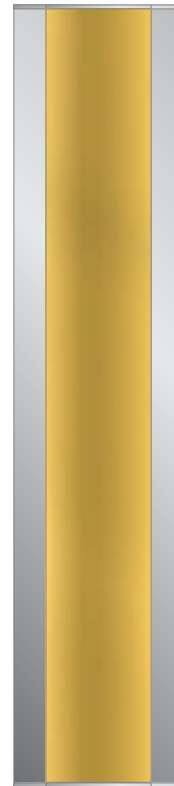

## Install the Fixture

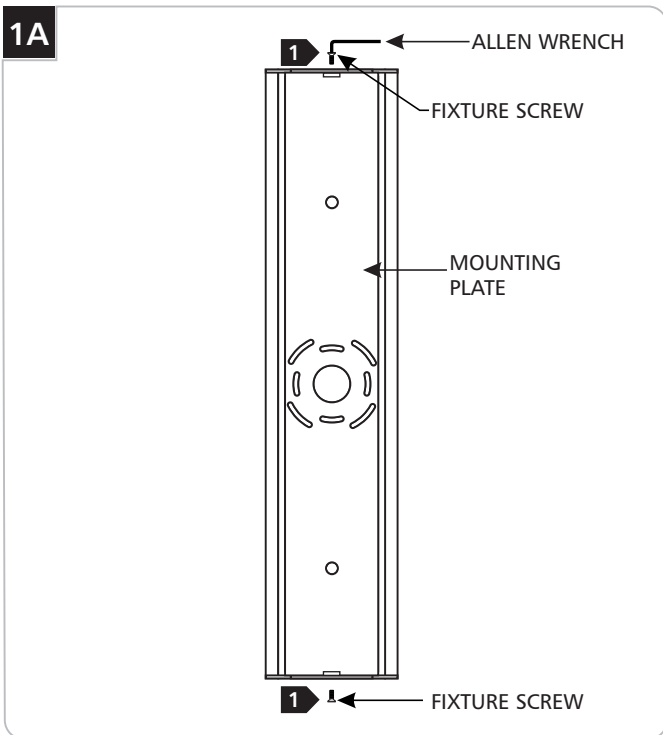

- 1** Using the provided Allen wrench, unscrew and remove the two fixture screws located at the top and bottom of the fixture
- 2** Remove the mounting plate from the back of the fixture.

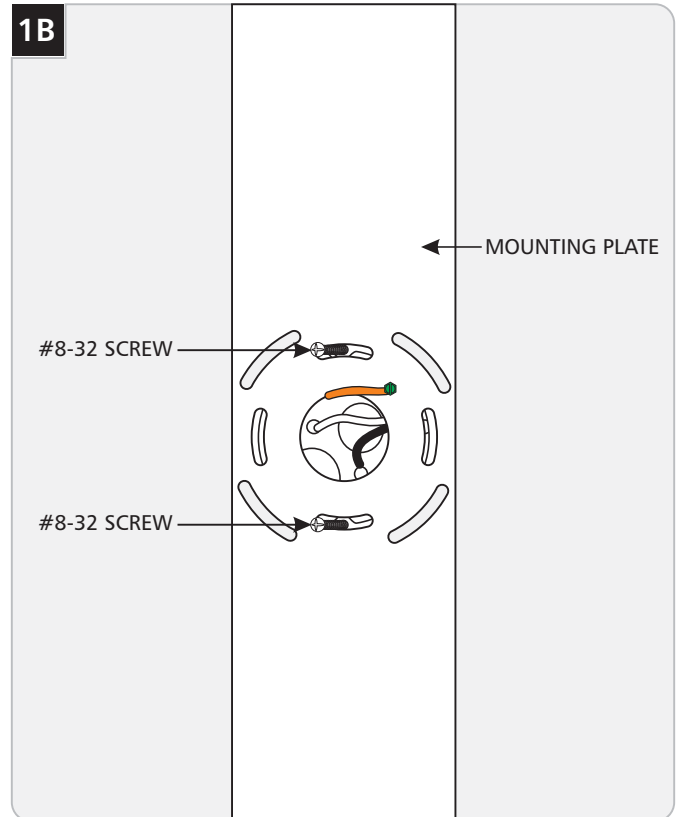

- 3** Attach the mounting plate to the electrical box using the two #8-32 screws provided.

**1C**

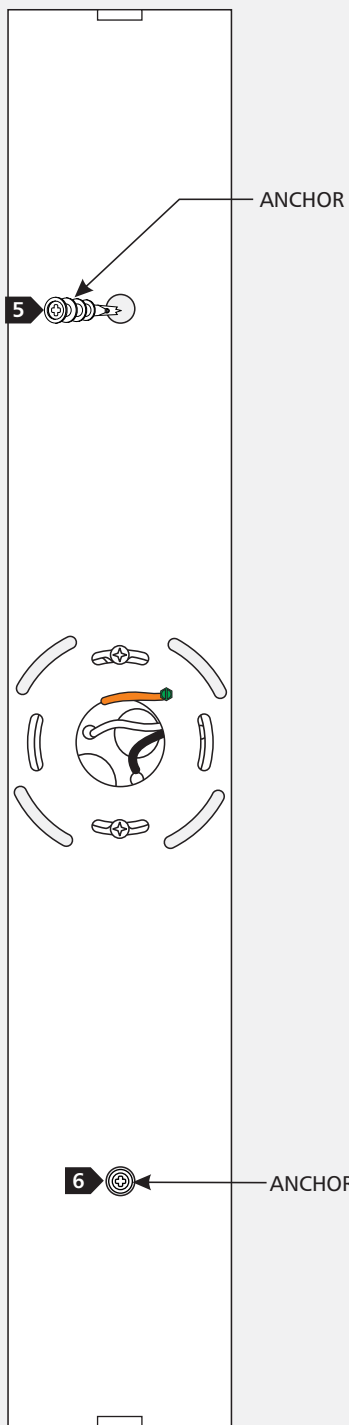

- 4** Verify that the mounting plate is level before continuing.
- 5** Line up an anchor tip with the center of a mounting plate hole, and push the anchor into the wall up to the threads.
- 6** Screw the anchors in the rest of the way with a Phillips-head screwdriver.
- 7** Repeat steps 5-6 for the other anchor.

**1D**

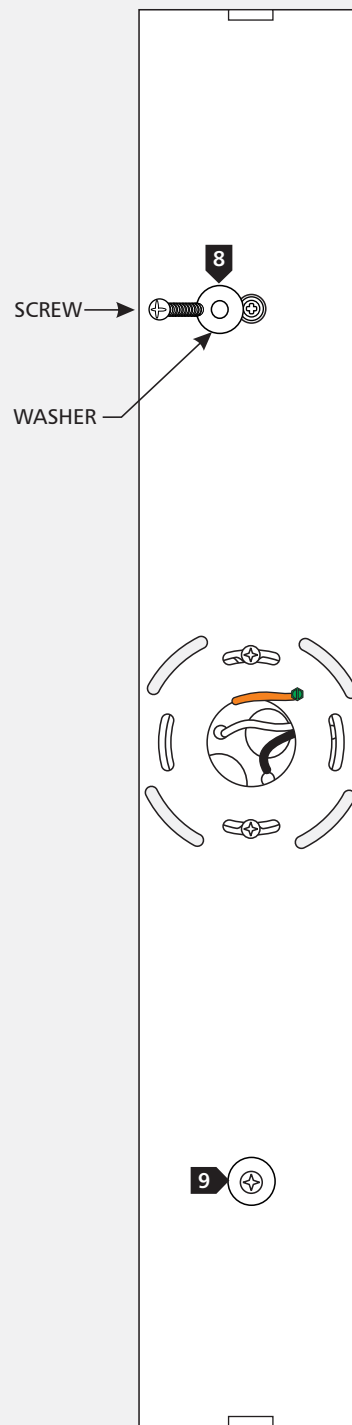

- 8** Slide a #8 screw through a washer and screw it into an anchor.
- 9** Repeat for the other anchor to secure the mounting plate to the wall.

**1E**

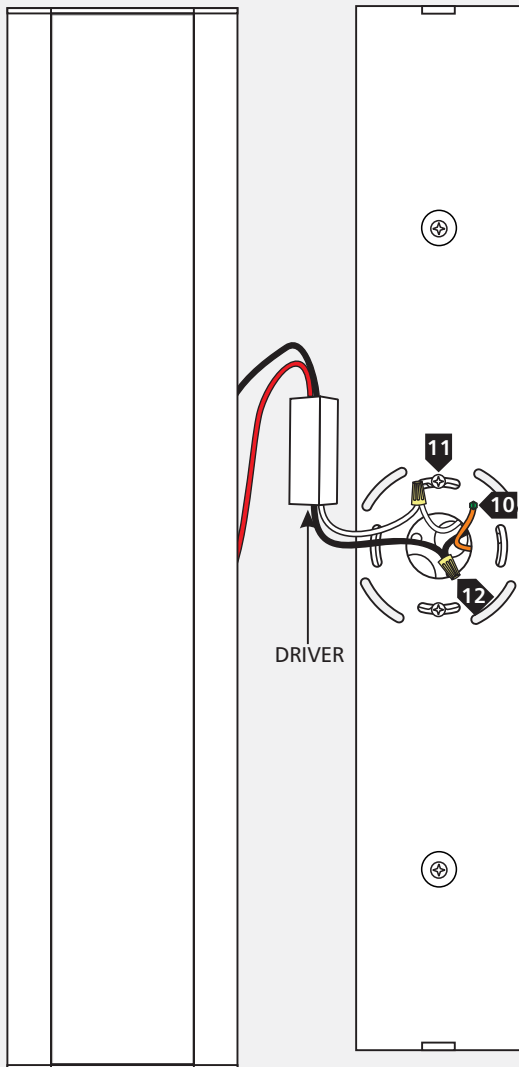

- 10** Connect the mounting plate wire to a suitable ground in accordance with local electrical codes.
- 11** Connect the white driver wire to the neutral power line.
- 12** Connect the black driver wire to the hot power line.

**1F**

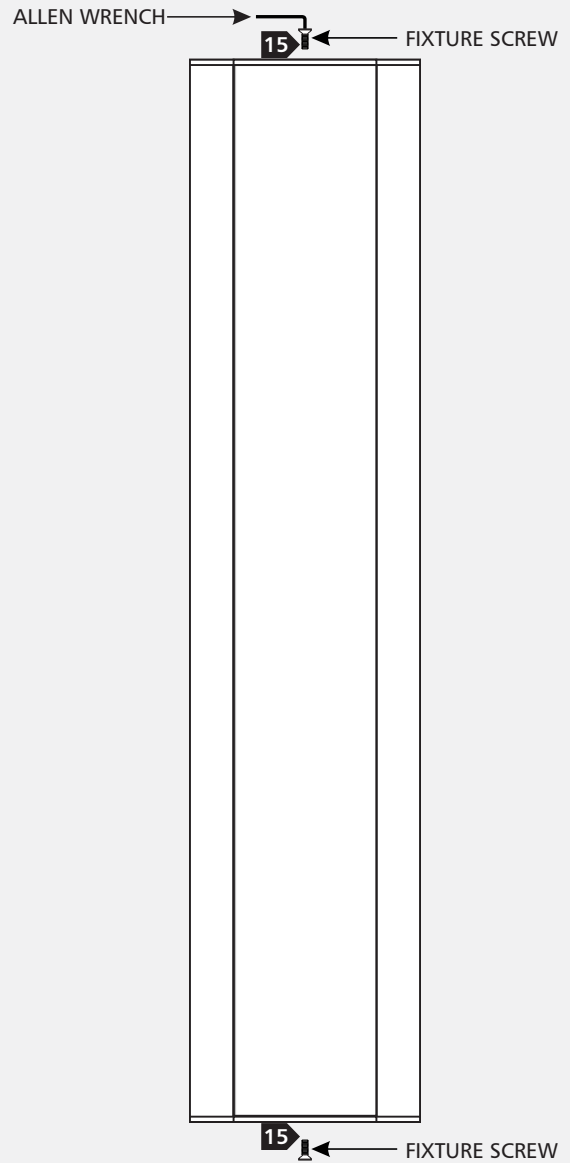

- 13** Properly place the driver, all wires, and wire nut connections into the electrical box.
- 14** Place the fixture onto the mounting and align the fixture screw holes.
- 15** Reinstall and tighten the fixture screws using the provided Allen wrench.

**SAVE THESE INSTRUCTIONS!**



**TECH LIGHTING®**

7400 Linder Ave, Skokie, IL 60077  
847.410.4400

**[www.techlighting.com](http://www.techlighting.com)**

© 2014 Tech Lighting, L.L.C. All rights reserved. The "Tech Lighting" graphic is a registered trademark of Tech Lighting, L.L.C. Tech Lighting reserves the right to change specifications for product improvements without notification.

A Generation Brands Company