

CP1 Clamp-On Light

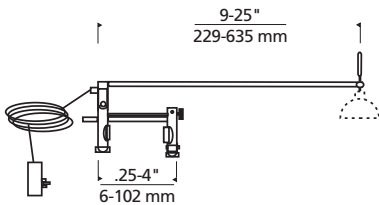

Shown approx. 10% actual size.
(with Mesh Backlight Shield Accessory)



de_cp1_clampon_spec.pdf

DESCRIPTION

Light weight and versatile, CP1 features a universal clamp that provides a secure grip on any surface shape-from 1/2" pipe to 4" wall. Arms telescope from 9" to 25", and angle up and down 180°; the lamp rotates 330° and the CP1 holds steady however it's positioned. It automatically shuts itself off then turns on again when short is corrected.

FINISH

Chrome arms; black or white clamp.

INSTALLATION

10 foot cord and plug with 50 watt or 75 watt 12 volt transformer (included). No tools necessary to install or to replace lamp.

LAMP

CP1 with 50 watt transformer: low-voltage Halogen MR16 lamp up to 50 watts (not included).

CP1 with 75 watt transformer: low-voltage Halogen MR16 lamp up to 75 watts (not included).

See accessory for maximum wattage usage.

ACCESSORY

Wild Thing, Sun Louver, Flight Paper, MR16 Snout, Round Glass Shield, Cone Glass Shield, Lil Egypt, Lil Wok, Barndoors, Snap Barndoors, Backlight Shield, Louver Lens Holder, Snap Louver Holder, Eggcrate Louver, Glass Lens (sold separately).

WEIGHT

1.55 lb./0.70 kg. ±

ORDERING INFORMATION

700CP1	WATTAGE	CLAMP
	- 50 WATT	BK BLACK
	7 75 WATT	WH WHITE



7400 Linder Avenue T 847.410.4400
Skokie, Illinois 60077 F 847.410.4500

www.techlighting.com

700CP1 _____

FIXTURE TYPE: _____

JOB NAME: _____

