

Specifications - Cast Iron

CAST IRON - TRADITIONAL

ITEM #	OVERALL LENGTH	OVERALL WIDTH	OVERALL HEIGHT	FAUCET HOLES CENTER TO CENTER	BOTTOM OF TUB TO FLOOR	OVERFLOW HEIGHT TO BOTTOM OF TUB	SEAT AREA	WATER VOLUME GALLON	UNCRATED / CRATED WEIGHT - LBS
P0700	60.5"	30.5"	24"	3 3/8"	5.3"	12.5"	37" x 17"	36	352 / 485
P0731	48.5"	30.5"	22"	3 3/8"	4.7"	12.5"	27" x 15"	23	220 / 383
P0761	54.5"	30.5"	24"	3 3/8"	5.3"	12.5"	30" x 17"	31	319 / 449
P0764	66.5"	30.5"	24"	3 3/8"	5.3"	12.5"	43" x 17"	43	374 / 531
P0880	60.5"	30.5"	24"	N/A	5.3"	15.5"	37" x 17"	41	352 / 485
P0885	60.5"	30.5"	24"	7"	5.3"	15.5"	37" x 17"	41	352 / 485
P1028	60.5"	30"	24"	3 3/8"	N/A	13"	37" x 17"	36	460 / 593
P1029	60.5"	30"	24"	N/A	N/A	13"	37" x 17"	41	460 / 593
P1030	60.5"	30"	24"	7"	N/A	13"	37" x 17"	41	460 / 593

CAST IRON - SLIPPER

ITEM #	OVERALL LENGTH	OVERALL WIDTH	OVERALL HEIGHT	FAUCET HOLES CENTER TO CENTER	BOTTOM OF TUB TO FLOOR	OVERFLOW HEIGHT TO BOTTOM OF TUB	SEAT AREA	WATER VOLUME GALLON	UNCRATED / CRATED WEIGHT - LBS
P0704	66.5"	30"	29" / 23"	7"	6.3"	14.5"	41" x 17"	48	394 / 540
P0705	66.5"	30"	29" / 23"	N/A	6.3"	14.5"	41" x 17"	48	394 / 540
P0760	61"	31"	32.3" / 25"	7"	5.3"	15.5"	38" x 15"	39	374 / 515
P0762	61"	31"	32.3" / 25"	N/A	5.3"	15.5"	38" x 15"	39	374 / 515

CAST IRON - DOUBLE ENDED SLIPPER

ITEM #	OVERALL LENGTH	OVERALL WIDTH	OVERALL HEIGHT	FAUCET HOLES CENTER TO CENTER	BOTTOM OF TUB TO FLOOR	OVERFLOW HEIGHT TO BOTTOM OF TUB	SEAT AREA	WATER VOLUME GALLON	UNCRATED / CRATED WEIGHT - LBS
P0767	72"	31.5"	29.5" / 21.5"	7"	5.3"	13.7"	34" x 15"	68	418 / 624
P0770	72"	31.5"	29.5" / 21.5"	N/A	5.3"	13.7"	34" x 15"	68	462 / 624
P0784	72"	31.5"	29.5" / 21.5"	7"	5.3"	13.7"	34" x 15"	68	418 / 624
P0785	72"	31.5"	29.5" / 21.5"	N/A	5.3"	13.7"	34" x 15"	68	462 / 624
P0883	72"	31.5"	30" / 21.5"	7"	7.5"	12.5"	34" x 15"	68	506 / 640
P0884	72"	31.5"	30" / 21.5"	N/A	7.5"	12.5"	34" x 15"	68	506 / 640

Specifications - Cast Iron

CAST IRON - TRADITIONAL

ITEM #	OVERALL LENGTH	OVERALL WIDTH	OVERALL HEIGHT	FAUCET HOLES CENTER TO CENTER	BOTTOM OF TUB TO FLOOR	OVERFLOW HEIGHT TO BOTTOM OF TUB	SEAT AREA	WATER VOLUME GALLON	UNCRATED / CRATED WEIGHT - LBS
P0700	60.5"	30.5"	24"	3 3/8"	5.3"	12.5"	37" x 17"	36	352 / 485
P0731	48.5"	30.5"	22"	3 3/8"	4.7"	12.5"	27" x 15"	23	220 / 383
P0761	54.5"	30.5"	24"	3 3/8"	5.3"	12.5"	30" x 17"	31	319 / 449
P0764	66.5"	30.5"	24"	3 3/8"	5.3"	12.5"	43" x 17"	43	374 / 531
P0880	60.5"	30.5"	24"	N/A	5.3"	15.5"	37" x 17"	41	352 / 485
P0885	60.5"	30.5"	24"	7"	5.3"	15.5"	37" x 17"	41	352 / 485
P1028	60.5"	30"	24"	3 3/8"	N/A	13"	37" x 17"	36	460 / 593
P1029	60.5"	30"	24"	N/A	N/A	13"	37" x 17"	41	460 / 593
P1030	60.5"	30"	24"	7"	N/A	13"	37" x 17"	41	460 / 593

CAST IRON - SLIPPER

ITEM #	OVERALL LENGTH	OVERALL WIDTH	OVERALL HEIGHT	FAUCET HOLES CENTER TO CENTER	BOTTOM OF TUB TO FLOOR	OVERFLOW HEIGHT TO BOTTOM OF TUB	SEAT AREA	WATER VOLUME GALLON	UNCRATED / CRATED WEIGHT - LBS
P0704	66.5"	30"	29" / 23"	7"	6.3"	14.5"	41" x 17"	48	394 / 540
P0705	66.5"	30"	29" / 23"	N/A	6.3"	14.5"	41" x 17"	48	394 / 540
P0760	61"	31"	32.3" / 25"	7"	5.3"	15.5"	38" x 15"	39	374 / 515
P0762	61"	31"	32.3" / 25"	N/A	5.3"	15.5"	38" x 15"	39	374 / 515

CAST IRON - DOUBLE ENDED SLIPPER

ITEM #	OVERALL LENGTH	OVERALL WIDTH	OVERALL HEIGHT	FAUCET HOLES CENTER TO CENTER	BOTTOM OF TUB TO FLOOR	OVERFLOW HEIGHT TO BOTTOM OF TUB	SEAT AREA	WATER VOLUME GALLON	UNCRATED / CRATED WEIGHT - LBS
P0767	72"	31.5"	29.5" / 21.5"	7"	5.3"	13.7"	34" x 15"	68	418 / 624
P0770	72"	31.5"	29.5" / 21.5"	N/A	5.3"	13.7"	34" x 15"	68	462 / 624
P0784	72"	31.5"	29.5" / 21.5"	7"	5.3"	13.7"	34" x 15"	68	418 / 624
P0785	72"	31.5"	29.5" / 21.5"	N/A	5.3"	13.7"	34" x 15"	68	462 / 624
P0883	72"	31.5"	30" / 21.5"	7"	7.5"	12.5"	34" x 15"	68	506 / 640
P0884	72"	31.5"	30" / 21.5"	N/A	7.5"	12.5"	34" x 15"	68	506 / 640

ACRYLIC - SOAKER

ITEM #	OVERALL LENGTH	OVERALL WIDTH	OVERALL HEIGHT	FAUCET HOLES CENTER TO CENTER	BOTTOM OF TUB TO FLOOR	OVERFLOW HEIGHT TO BOTTOM OF TUB	SEAT AREA	WATER VOLUME GALLON	UNCRATED / CRATED WEIGHT - LBS
P0879	70"	34"	28.5"	N/A	3.5"	13 1/4"	43" x 17"	62	139/253
P0945	70"	34"	25"	N/A	N/A	13 1/4"	43" x 17"	62	139/253
P1034	67"	32 3/4"	24"	N/A	N/A	14 1/2" INT	45" x 19"	55	115/220
P1035	71"	31 1/2"	22"	N/A	N/A	13 3/4" INT	47" x 17"	63	144/250
P1036	65"	30 3/4"	20 1/2" / 26 1/4"*	N/A	N/A	11 1/2" INT	37" x 19"	31	90/200
P1057	75"	38"	20 3/4" / 26"	N/A	N/A	12 1/2"	41" x 23"	46	94/246
P1070	75"	34"	26 1/2"	N/A	5 3/4"	13 1/4"	45" X 18 1/2"	52	282/396

* LOW SIDE / HIGH SIDE

ACRYLIC - DUAL

ITEM #	OVERALL LENGTH	OVERALL WIDTH	OVERALL HEIGHT	FAUCET HOLES CENTER TO CENTER	BOTTOM OF TUB TO FLOOR	OVERFLOW HEIGHT TO BOTTOM OF TUB	SEAT AREA	WATER VOLUME GALLON	UNCRATED / CRATED WEIGHT - LBS
P0772	75"	34.5"	24"	7"	6"	14 3/4"	53" x 19"	50	134/239
P0773	75"	34.5"	24"	N/A	6"	14 3/4"	53" x 19"	50	134/239
P0775	60"	34.5"	24"	7"	6"	14 3/4"	39" x 19"	38	110/202
P0776	60"	34.5"	24"	N/A	6"	14 3/4"	39" x 19"	38	110/202
P0948	66"	31"	24"	7"	5.25"	14 3/4"	43" x 15"	48	119/216
P0949	66"	31"	24"	N/A	5.25"	14 3/4"	43" x 15"	48	119/216

ACRYLIC - SLIPPER

ITEM #	OVERALL LENGTH	OVERALL WIDTH	OVERALL HEIGHT	FAUCET HOLES CENTER TO CENTER	BOTTOM OF TUB TO FLOOR	OVERFLOW HEIGHT TO BOTTOM OF TUB	SEAT AREA	WATER VOLUME GALLON	UNCRATED / CRATED WEIGHT - LBS
P0951	67"	30"	23.25" / 28.75"	7"	5.25"	14 1/2"	45" x 18"	41	104/205
P0952	67"	30"	23.25" / 28.75"	N/A	5.25"	14 1/2"	45" x 18"	41	104/205
P0956	60"	32"	25" / 33.5"*	7"	5.5"	15 3/4"	38" x 16"	42	121/226
P0957	60"	32"	23 3/4" / 33.5"*	N/A	5.5"	15 3/4"	38" x 16"	42	121/226
P0964	60"	32"	23 3/4" / 33.5"*	7"	5.5"	15 3/4"	38" x 16"	42	121/226
P0965	60"	32"	23 3/4" / 33.5"*	N/A	5.5"	15 3/4"	38" x 16"	42	121/226

* LOW SIDE / HIGH SIDE

ACRYLIC - DOUBLE ENDED SLIPPER

ITEM #	OVERALL LENGTH	OVERALL WIDTH	OVERALL HEIGHT	FAUCET HOLES CENTER TO CENTER	BOTTOM OF TUB TO FLOOR	OVERFLOW HEIGHT TO BOTTOM OF TUB	SEAT AREA	WATER VOLUME GALLON	UNCRATED / CRATED WEIGHT - LBS
P0993	72"	31.5"	29.5" / 21.5"	7"	5.3"	13.7"	34" x 15"	68	226/388
P0994	72"	31.5"	29.5" / 21.5"	N/A	5.3"	13.7"	34" x 15"	68	226/388
P0995	72"	31.5"	29.5" / 21.5"	7"	5.3"	13.7"	34" x 15"	68	218/380
P0996	72"	31.5"	29.5" / 21.5"	N/A	5.3"	13.7"	34" x 15"	68	218/380
P0997	72"	31.5"	30" / 21.5"	7"	7.5"	12.5"	34" x 15"	68	216/378
P0998	72"	31.5"	30" / 21.5"	N/A	7.5"	12.5"	34" x 15"	68	216/378

ACRYLIC - CORNER TUB

ITEM #	OVERALL LENGTH	OVERALL WIDTH	OVERALL HEIGHT	FAUCET HOLES CENTER TO CENTER	BOTTOM OF TUB TO FLOOR	OVERFLOW HEIGHT TO BOTTOM OF TUB	SEAT AREA	WATER VOLUME GALLON	UNCRATED / CRATED WEIGHT - LBS
P1058	69 1/2"	34 1/4"	25 3/8'	N/A	N/A	15 3/4"	49" x 19"	46	270/384
P1059	69 1/2"	34 1/4"	25 3/8'	N/A	N/A	15 3/4"	49" x 19"	46	270/384

OVER THE RIM FAUCET/SUPPLY SETS

<u>ITEM #</u>	<u>SPOUT EXTENSION</u>	<u>CENTER TO CENTER</u>	<u>SUPPLY ONLY HEIGHT</u>	<u>TOTAL HEIGHT</u>	<u>SPOUT DROP</u>
P0972	10 1/2"	3 3/8"	24"	34"	N/A
P0972-28	10 1/2"	3 3/8"	28"	38"	N/A
P0973	10 1/2"	7"	24"	33"	4 1/2"
P0973-28	10 1/2"	7"	28"	37"	4 1/2"
P0974	11"	7"	24"	35"	4 1/2"
P0974-28	11"	7"	28"	39"	4 1/2"
P0975	10 1/2"	7"	24"	33"	4 1/2"
P0975-28	10 1/2"	7"	28"	37"	4 1/2"
P1000	11"	7"	24"	33"	5"
P1000-28	11"	7"	28"	37"	5"
P1019-28	13"	7"	28"	94"	N/A
P1020-28	10 1/2"	3 3/8"	28"	94"	N/A
P1023	13"	7"	24"	35"	1 1/2"
P1023-28	13"	7"	28"	39"	1 1/2"
P1024	12"	7"	24"	34"	N/A
P1024-28	12"	7"	28"	38"	N/A
P1025	10 1/2"	7"	24"	33"	4 1/2"
P1025-28	10 1/2"	7"	28"	37"	4 1/2"
P1025-30	10 1/2"	7"	30"	39"	4 1/2"
P1032	14"	7"	24"	35"	N/A
P1032-28	14"	7"	28"	39"	N/A
P1056	13"	3 3/8"	24"	33"	N/A
P1056-28	13"	3 3/8"	28"	37"	N/A
P1069	14"	7"	24"	38"	N/A
P1069-28	14"	7"	28"	42"	N/A
P1081	11"	7"	24"	33"	5"
P1081-28	11"	7"	28"	37"	5"
P1082	11 1/2"	7"	24"	33"	5 1/2"
P1082-28	11 1/2"	7"	28"	37"	5 1/2"
P1083	11 1/2"	7"	24"	33"	5 1/2"
P1083-28	11 1/2"	7"	28"	37"	5 1/2"

ANTIQUE REPRODUCTIONS

Minimum hole size for installation is 1", maximum counter thickness 1 1/4"

<u>ITEM #</u>	(A) <u>SPOUT EXTENSION</u>	(B) <u>HEIGHT</u>	(C) <u>BASE DIAMETER</u>
P0012	4"	4 1/2"	1 7/8"
P0013	5 3/4"	6"	2 1/4"
P0058	5"	4"	2 3/8"
P0549-8	5"	5 1/2"	2 7/8"
P0549-12	5"	5 1/2"	2 7/8"
P0550-8	5"	8 1/2"	2 7/8"
P0550-12	5"	8 1/2"	2 7/8"
P0557-8	5"	8 1/2"	2 7/8"
P0557-12	5"	8 1/2"	2 7/8"
P0558-8	5"	8 1/2"	2 7/8"
P0558-12	5"	8 1/2"	2 7/8"
P0565-8	5"	5"	2 7/8"
P0565-12	5"	5"	2 7/8"
P0587	4"	4 1/2"	1 7/8"
P0598	4"	4 1/2"	1 7/8"
P0629	5"	8 1/2"	2 1/8"
P0630	5"	5 1/2"	2 1/8"
P0819	8"	8"	2 1/8"
P0822	8"	8"	2 1/8"
P1005	7 1/2"	11 1/2"	2 7/8"
P1006	5" / 3***	11 1/4"	2 1/4"
P1007	5"	12"	2 7/8"
P1007-10	5"	12"	2 7/8"

**AS PICTURED - 5" from center ball forward to spout and 3" from inlet as pictured to spout.

LEG TUB FAUCETS

ITEM #	SPOUT LENGTH / HEIGHT	CENTERS	WALL TO SPOUT EXT.
P0006	3 1/2"	3 3/8"	3 1/4"
P0126	9 3/4"	3 3/8"	5 3/8"
P0146*	4 1/2"	3 3/8" - 12"	7"
P0149-1	9 3/4"	3 3/8"	8"
P0400/P0402	9 3/4"	3 3/8"	8"
P0708	9 3/4"	3 3/8"	8"
P0793	9 3/4"	3 3/8"	8"
P0804	9 3/4"	3 3/8" - 9"	8"
P0889	5"	3 3/8" - 12"	7 1/2"
P1003	5"	3 3/8" - 12"	8"
P1004	7 1/2"	3 3/8"	11"
P1014	4 1/2"	3 3/8" - 12"	7"
P1017	8"	3 3/8" - 12"	10 1/2"
P1018	8"	3 3/8" - 12"	10 1/2"
P1026	9 3/4"	3 3/8"	8"
P1053	8"	3 3/8"	11"
P1067	10 1/2"	3 3/8"-12"	9"

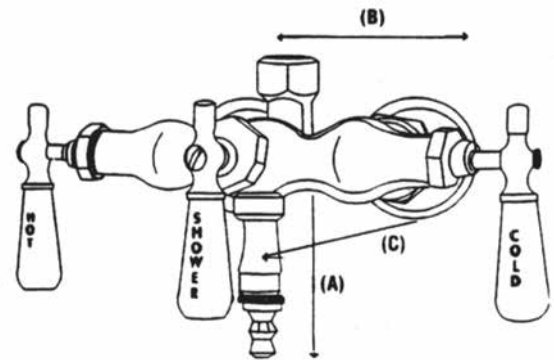

*minimum cc is 4 1/2" when mounting on a "bathroom wall" AND/OR any faucet that has P0166 swing arms added for wall mount installation.

DECK MOUNT FAUCETS

Maximum deck thickness is 1 1/8"

ITEM #	SPOUT EXTENSION	TOTAL HEIGHT	CLEARANCE	BASE DIA.	CENTER TO CENTER
P0341	7"	10"	2" BELOW DECK	2 1/8"	7"
P0462	7"	14"	2"	2 1/8"	7"
P0625	9"	ADJ.	ADJ.	2 1/8"	3 3/8" - 9"
P0626	8"	ADJ.	ADJ.	2 1/8"	3 3/8" - 12"
P0627	8"	ADJ.	ADJ.	2 1/8"	3 3/8" - 12"
P0684	9"	ADJ.	ADJ.	2 1/8"	3 3/8" - 9"
P0712	5"	ADJ.	ADJ.	2 1/8"	3 3/8" - 9"
P0795 / P0796	9"	15"	6"	2 1/8"	3" - 11"
P0802	7"	8"	2 1/2"	2 1/8"	7"
P0803	5"	11"	6"	2 1/8"	3" - 11"
P0891	5 1/2"	15"	1 3/4"	2 1/8"	7"
P0969	7 1/2"	16"	3"	2 1/8"	7"
P1002	8"	13 1/2"	4 1/4"	2 1/8"	7"
P1009	7"	14"	2"	2 1/8"	7"
P1013	7"	14"	2"	2 1/8"	7"
P1015	8"	13"	10"	2 1/8"	7"
P1054	12"	variable	N/A	2 1/8"	variable
P1068	8"	17"	N/A	2 1/8"	7"
P1073	8 1/2"	15"	4 3/4"	2 1/8"	7"
P1074	8 1/4"	14"	1/2"	2 1/8"	3" - 11"
P1075	8 1/4"	8"	1/2"	2 1/8"	7"
P1076	6"	13 1/2"	2 3/4"	2 1/8"	7"
P1077	7"	8"	2 1/2"	2 1/8"	7"

TUB SPOUTS

ADAPT TO 3/4" IPS (except P0843 & P1044) MINIMUM OF 1 1/2" OF THREADS OUT OF WALL FOR INSTALLATION.

ITEM #	LENGTH	BASE DIAMETER
P0057	5 1/2"	2 3/4"
P0079	5 3/4"	3"
P0080	5 3/4"	2 7/8"
P0843C**	6 1/2"	2 3/8"
P1044**	10 1/2"	2 3/8"

**Connection is 1/2" IPS

WALL MOUNT SHOWERS AND FAUCETS

ITEM #	Extension from wall to Spout or Head	Body C to C	Total height from Inlet	Bottom of Head or spout to Inlet
P0117	5 1/2"	8"	69"	N/A
P0655	11 1/2"	3 3/8"	9 3/4"	N/A
P0678	19"	3 3/8"	44"	36"
P0713	19"	3 3/8"	44"	36"
P0790**	10"	7"	7"	N/A
P0894	10 1/2"	7"	15"	N/A
P0901	19"	7"	45"	37"
P0902	19"	7"	48"	40"
P0903	Spout 8 1/2" / Head 19"	7"	45"	40"
P0905	12"	7"	10"	N/A
P0907	10"	7"	69"	58"
P0944**	10"	7"	7"	N/A
P0916	11"	N/A	N/A	N/A
P0946**	Spout 8 1/2" / Head 19"	7"	48"	40"
P0963**	Spout 8 1/2" / Head 19"	7"	64.5"	56.5"
P0970	13"	7"	11"	N/A
P1001	10"	7"	8 1/4"	N/A
P1016	Spout 11 1/2" / Head 15"	7"	10 1/2"	7"
P1021	11 1/2"	3 3/8"	65"	57 1/2"
P1022	12"	7"	42"	35"
P1027	10"	7"	7"	N/A
P1037	11 1/2"	3 3/8"	9 3/4"	N/A
P1049	Spout 8 1/2" / Head 15"	7"	64.5"	56.5"
P1055	11"	3 3/8"	8"	N/A
P1078**	10"	7"	3"	N/A
P1079***	11 1/2"	7"	7"	N/A
P1080*	12 1/2"	7"	10"	N/A

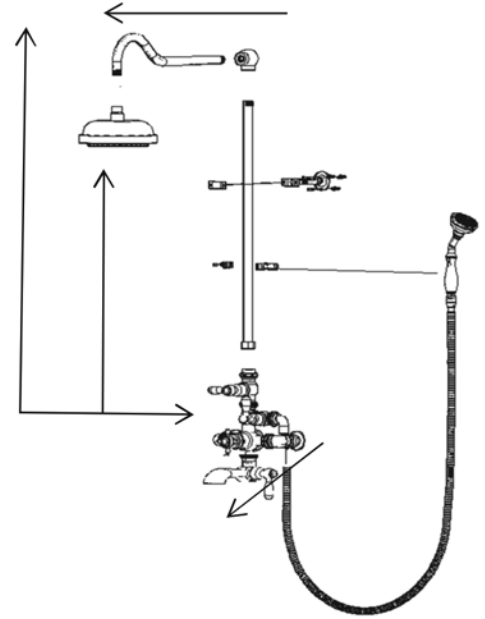

*SPOUT DROP IS 1/2"

**SPOUT DROP IS 4 1/2"

***SPOUT DROP IS 5 1/2"

WALL MOUNT THERMO UNIT SPOUT DROP IS 4 1/2"

KITCHEN FAUCETS

8" CENTER TO CENTER ON ALL KITCHEN FAUCETS.

MAXIMUM COUNTER THICKNESS 1 1/8"

FLOW RATES

Approximate GPM, tested at 60 PSI

Faucet	1/4 Turn Valve Flow Rate
P0006	7
P0012	2.2
P0013	2.2
P0058	2.2
P0126	10.1
P0146	8.1
P0149	8.8
P0400	7
P0550	2.2
P0819 / P0822	11
Exposed Thermostatic	6.5
Concealed Thermostatic	6.1
Ceramic Tub & Shower Valves	5.7
Lavatory Valves	1.5
All Shower Heads & P0869	2
Kitchen Faucets	1.8

ITEM #	SPOUT EXTENSION	HEIGHT	BASE DIAMETER
P0825	15 1/2"	6"	2 1/8"
P0826	12 1/2"	9 1/2"	2 1/8"
P0827	15 1/2"	5 1/2"	2 1/8"
P0828	16 1/4"	3"	2 1/8"
P0829	10"	3"	2 1/8"
P0830	20 1/4"	11"	2 1/8"
P0831	12 1/2"	6"	2 1/8"
P0832	6 1/2"	6"	2 1/8"
P0833	18"	12"	2 1/8"
P0834	15 5/8"	5"	2 1/8"
P0835	12 5/8"	7"	2 1/8"
P0836	12 5/8"	7"	2 1/8"
P0886	10"	3"	2 1/8"
P0887	6 1/2"	6"	2 1/8"
P1010	10"	4 1/2"	2 1/8"
P1011	12 1/2"	9 1/2"	2 1/8"
P1045/P1047	8"	2 1/2"	2 1/8"
P1046/P1048	8"	4 3/4"	2 1/8"
P1063	13 1/2"	8"	2 1/8"
P1064	10"	11"	2 1/8"
P1065	8 3/4"	15"	2 1/2" Spout
P1066	9 1/2"	10"	2 1/2" Spout

WIDESPREAD LAVATORY FAUCETS

Minimum hole size for installation is 1 1/4". Maximum counter thickness is 1 1/2

MISSISSIPPI SERIES	SPOUT EXTENSION	SPOUT HEIGHT	SPOUT BASE	ESC DIAMETER	ESCUTCHEON HEIGHT	HANDLE LENGTH
P0152	5 1/2"	3 1/2"	2 1/2"	2 7/8"	1 7/8"	3 1/4"
P0805	5 1/2"	3 1/2"	2 1/2"	2 7/8"	1 7/8"	2 1/16"
P0981	5 1/2"	3 1/2"	2 1/2"	2 7/8"	1 7/8"	3"
RIO GRANDE SERIES	SPOUT EXTENSION	SPOUT HEIGHT	SPOUT BASE	ESC DIAMETER	ESCUTCHEON HEIGHT	HANDLE LENGTH
P0588	7 1/2"	6 1/2"	2 1/4"	2 1/2"	1 3/4"	3"
P0888	7 1/2"	6 1/2"	2 1/4"	2 1/2"	1 3/4"	3 1/8"
P1033	7 1/2"	6 1/2"	2 1/4"	2 1/2"	1 3/4"	3 1/4"
SACRAMENTO SERIES	SPOUT EXTENSION	SPOUT HEIGHT	SPOUT BASE	ESC DIAMETER	ESCUTCHEON HEIGHT	HANDLE LENGTH
P0104**	5"	4 7/8"	2" / 2 1/2"	2 1/4"	1 1/2"	4"
P0140**	5"	4 7/8"	2" / 2 1/2"	2 1/4"	1 1/2"	3 1/4"
P0188**	5"	4 7/8"	2" / 2 1/2"	2 7/8"	1 3/4"	3 1/4"
P0188X**	5"	4 7/8"	2" / 2 1/2"	2 7/8"	1 3/4"	3 1/4"
P0820**	5"	4 7/8"	2" / 2 1/2"	2 7/8"	1 3/4"	3 1/4"
ST. LAWRENCE SERIES	SPOUT EXTENSION	SPOUT HEIGHT	SPOUT BASE	ESC DIAMETER	ESCUTCHEON HEIGHT	HANDLE LENGTH
P0345	4 1/2"	4 1/2"	2 3/4"	2 3/4"	2"	3 1/4"
P0346	4 1/2"	4 1/2"	2 3/4"	2 3/4"	2"	2 7/8"
P0347	4 1/2"	4 1/2"	2 3/4"	2 3/4"	2"	2 1/2"
P1008	4"	12"	2 3/8"	2 3/4"	2"	4"
THAMES SERIES	SPOUT EXTENSION	SPOUT HEIGHT	SPOUT BASE	ESC DIAMETER	ESCUTCHEON HEIGHT	HANDLE LENGTH
P0376	5 1/2"	4"	2 3/4"	2 1/2"	1 3/4"	3 1/4"
P0377	5 1/2"	4"	2 3/4"	2 1/2"	1 3/4"	3 1/2"
P0378	5 1/2"	4"	2 3/4"	2 1/2"	1 3/4"	3 1/8"
P0821	5 1/2"	4"	2 3/4"	2 1/2"	1 3/4"	3"

**Includes 7/8" spout ring

HANDLES

3/8" ID, 16 splines

ESCUTCHEONS

ITEM #	(D) DIAMETER	(E) HEIGHT
P0099	2 7/8"	1 7/8"
P0383	3 3/8"	2"
P0384	2 7/8"	1 3/4"
P0386	2 1/4"	1 1/2"
P0387	2 1/4"	1 1/2"
P0388	2 7/8"	1 3/4"
P0391	2 1/2"	1 3/4"
P0458	2 3/4"	2"
P0478	2 3/4"	2"
P0481	2 1/2"	1 3/4"
PP0259	2 1/4"	1 1/4"

ITEM #	(F) STEM TO END
P0202	3 1/8"
P0204	4"
P0206	2 3/4"
P0207	3 1/2"
P0208	3 1/2"
P0212	2 1/2"
P0214	3 1/2"
P0215	3 1/2"
P0217	3 1/4"
P0219	3 1/4"
P0220	2 1/4"
P0475	3"
P0476	2 1/2"
P0551	2"
P0552	2"
P0622	4"
P0725	3 3/16"
P0782	2 1/16"
P0815	3"
P0980	3"
P0999	3 1/2"