

WALL MOUNT SHOWERS AND FAUCETS

ITEM #	Extension from wall to Spout or Head	Body C to C	Total height from Inlet	Bottom of Head or spout to Inlet
P0117	5 1/2"	8"	69"	N/A
P0655	11 1/2"	3 3/8"	9 3/4"	N/A
P0678	19"	3 3/8"	44"	36"
P0713	19"	3 3/8"	44"	36"
P0790**	10"	7"	7"	N/A
P0894	10 1/2"	7"	15"	N/A
P0901	19"	7"	45"	37"
P0902	19"	7"	48"	40"
P0903	Spout 8 1/2" / Head 19"	7"	45"	40"
P0905	12"	7"	10"	N/A
P0907	10"	7"	69"	58"
P0944**	10"	7"	7"	N/A
P0916	11"	N/A	N/A	N/A
P0946**	Spout 8 1/2" / Head 19"	7"	48"	40"
P0963**	Spout 8 1/2" / Head 19"	7"	64.5"	56.5"
P0970	13"	7"	11"	N/A
P1001	10"	7"	8 1/4"	N/A
P1016	Spout 11 1/2" / Head 15"	7"	10 1/2"	7"
P1021	11 1/2"	3 3/8"	65"	57 1/2"
P1022	12"	7"	42"	35"
P1027	10"	7"	7"	N/A
P1037	11 1/2"	3 3/8"	9 3/4"	N/A
P1049	Spout 8 1/2" / Head 15"	7"	64.5"	56.5"
P1055	11"	3 3/8"	8"	N/A
P1078**	10"	7"	3"	N/A
P1079***	11 1/2"	7"	7"	N/A
P1080*	12 1/2"	7"	10"	N/A

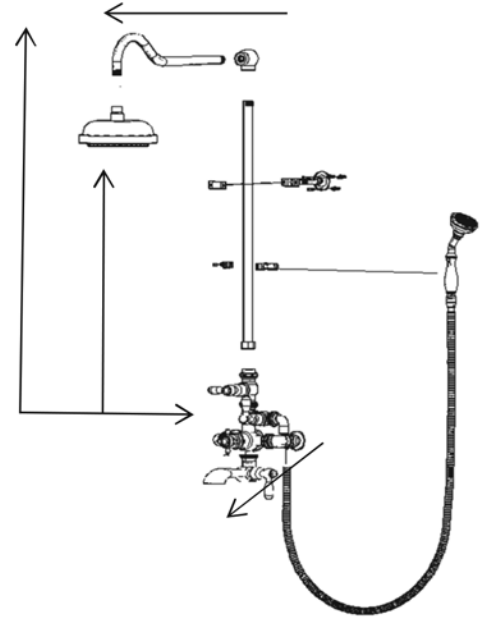

*SPOUT DROP IS 1/2"

**SPOUT DROP IS 4 1/2"

***SPOUT DROP IS 5 1/2"

WALL MOUNT THERMO UNIT SPOUT DROP IS 4 1/2"

KITCHEN FAUCETS

8" CENTER TO CENTER ON ALL KITCHEN FAUCETS.

MAXIMUM COUNTER THICKNESS 1 1/8"

FLOW RATES

Approximate GPM, tested at 60 PSI

Faucet	1/4 Turn Valve Flow Rate
P0006	7
P0012	2.2
P0013	2.2
P0058	2.2
P0126	10.1
P0146	8.1
P0149	8.8
P0400	7
P0550	2.2
P0819 / P0822	11
Exposed Thermostatic	6.5
Concealed Thermostatic	6.1
Ceramic Tub & Shower Valves	5.7
Lavatory Valves	1.5
All Shower Heads & P0869	2
Kitchen Faucets	1.8

ITEM #	SPOUT EXTENSION	HEIGHT	BASE DIAMETER
P0825	15 1/2"	6"	2 1/8"
P0826	12 1/2"	9 1/2"	2 1/8"
P0827	15 1/2"	5 1/2"	2 1/8"
P0828	16 1/4"	3"	2 1/8"
P0829	10"	3"	2 1/8"
P0830	20 1/4"	11"	2 1/8"
P0831	12 1/2"	6"	2 1/8"
P0832	6 1/2"	6"	2 1/8"
P0833	18"	12"	2 1/8"
P0834	15 5/8"	5"	2 1/8"
P0835	12 5/8"	7"	2 1/8"
P0836	12 5/8"	7"	2 1/8"
P0886	10"	3"	2 1/8"
P0887	6 1/2"	6"	2 1/8"
P1010	10"	4 1/2"	2 1/8"
P1011	12 1/2"	9 1/2"	2 1/8"
P1045/P1047	8"	2 1/2"	2 1/8"
P1046/P1048	8"	4 3/4"	2 1/8"
P1063	13 1/2"	8"	2 1/8"
P1064	10"	11"	2 1/8"
P1065	8 3/4"	15"	2 1/2" Spout
P1066	9 1/2"	10"	2 1/2" Spout