

ASSEMBLY INSTRUCTION

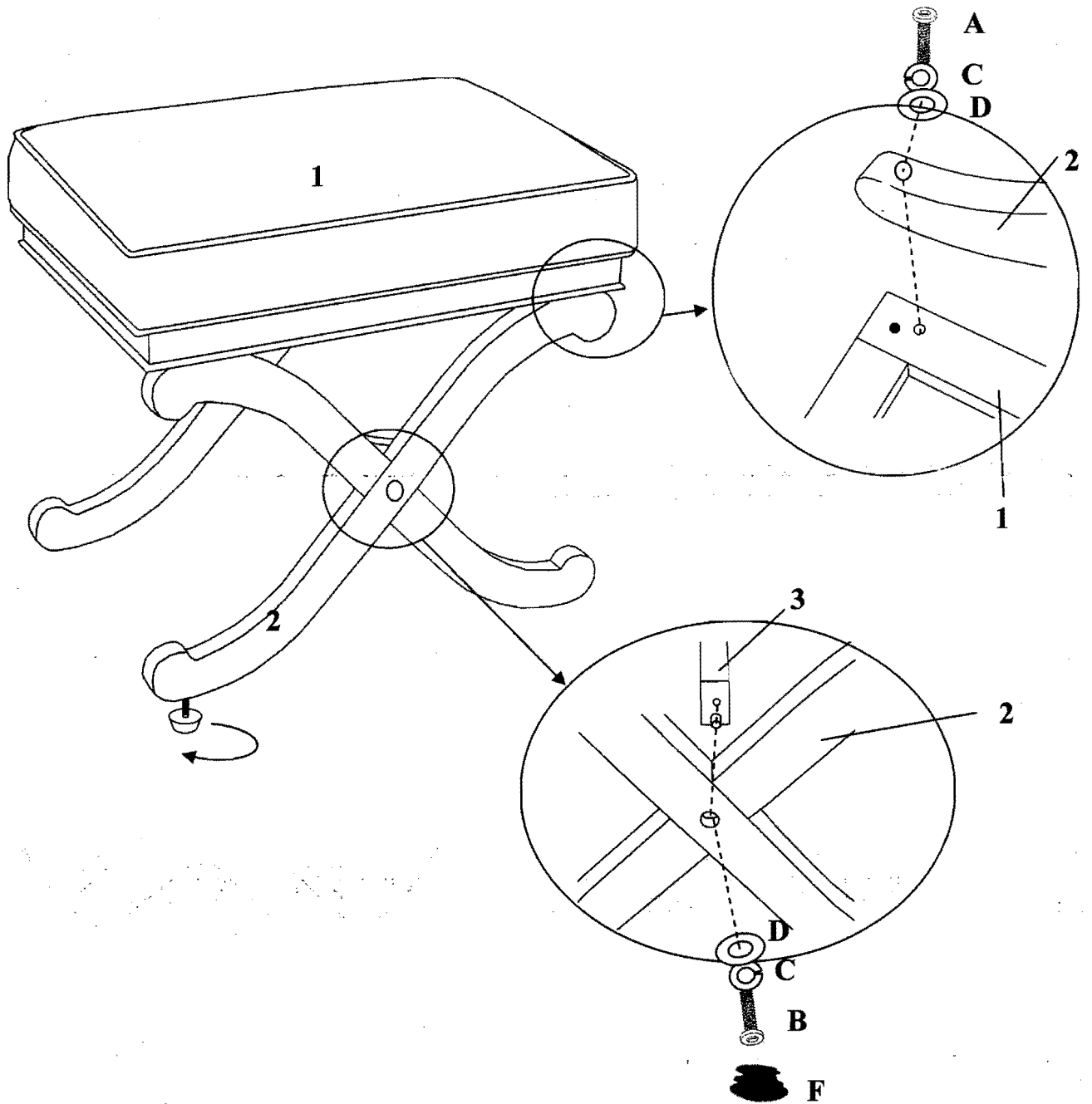

PARTS IDENTIFICATION

1		1PC	2		2PCS
3		1PC			1PC

HARDWARE IDENTIFICATION

A	 $\phi 1/4" \times 55\text{mm}$	4PCS	B	 $\phi 1/4" \times 35\text{mm}$	2PCS
C	 $\phi 6\text{mm}$	6PCS	D	 $\phi 15\text{mm}$	6PCS
E	 4mm	1PC	F		2PCS

ATTENTION:
WHEN YOU ASSEMBLE, PLEASE DO NOT TIGHTEN EACH SCREW UNTIL ALL SCREWS ARE LINED UP WITH THE FRAME.