

CAUTION:
(2) OR MORE PERSONS
RECOMMENDED FOR
ASSEMBLY!

**CAREFULLY READ AND
UNDERSTAND ALL
INSTRUCTIONS BEFORE
PROCEEDING**

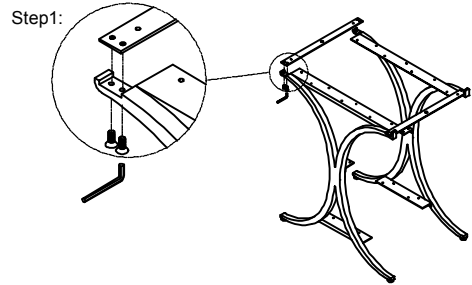

NOTE: if a power
screwdriver is used,
a "low torque" setting
is recommended

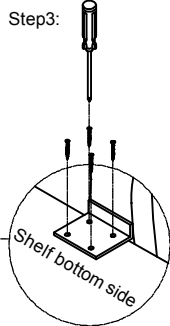
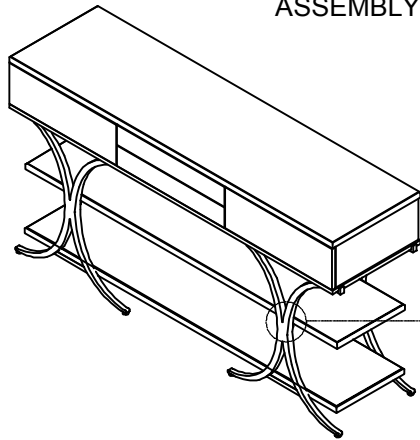
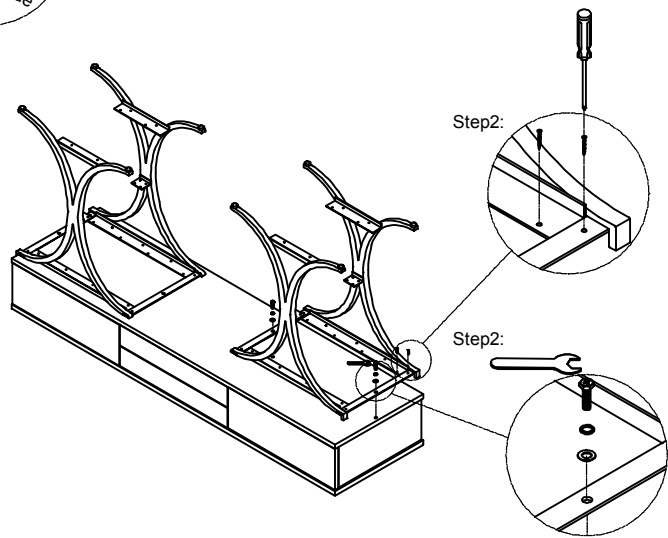

1. ATTACHING THE METAL BAR TO "X"

Fit the METAL BAR into the cutout on the TOP of the "X", using HEX BOLT. Allen wrench will be used.

2. ATTCHING "X" TO TOP CASE

Upside down the top case, using HEXAGON BOLT, FLAT WASHER AND SPRING WASHER to position the case with "X" base. Tighten the bolt with Hex wrench
Secure the BASE ASSEMBLY to the TOP CASE with screws as shown, using a phillip screwdriver.

3. ATTACHING THE SHELF

Secure SHELF to the "X" BASE ASSEMBLY with screws as shown. A phillip Screw Driver will be used.

4. UPRIGHT THE SIDEBOARD

	PART DESCRIPTION		QTY
	Bolt	M6*15mm	16
	Allen Wrench	4mm	1
	Hexagon Bolt	5/16**19	4
	Spring Wahser	5/16"	4
	Flat washer	5/16"	4
	Hex Wrench	12mm	1
	Screw	#8*19	68

NOTE: Your furniture may have different design features than those shown in the drawings