

Assembly Instructions ■

Uniframe® Convertible Bench

October 2013

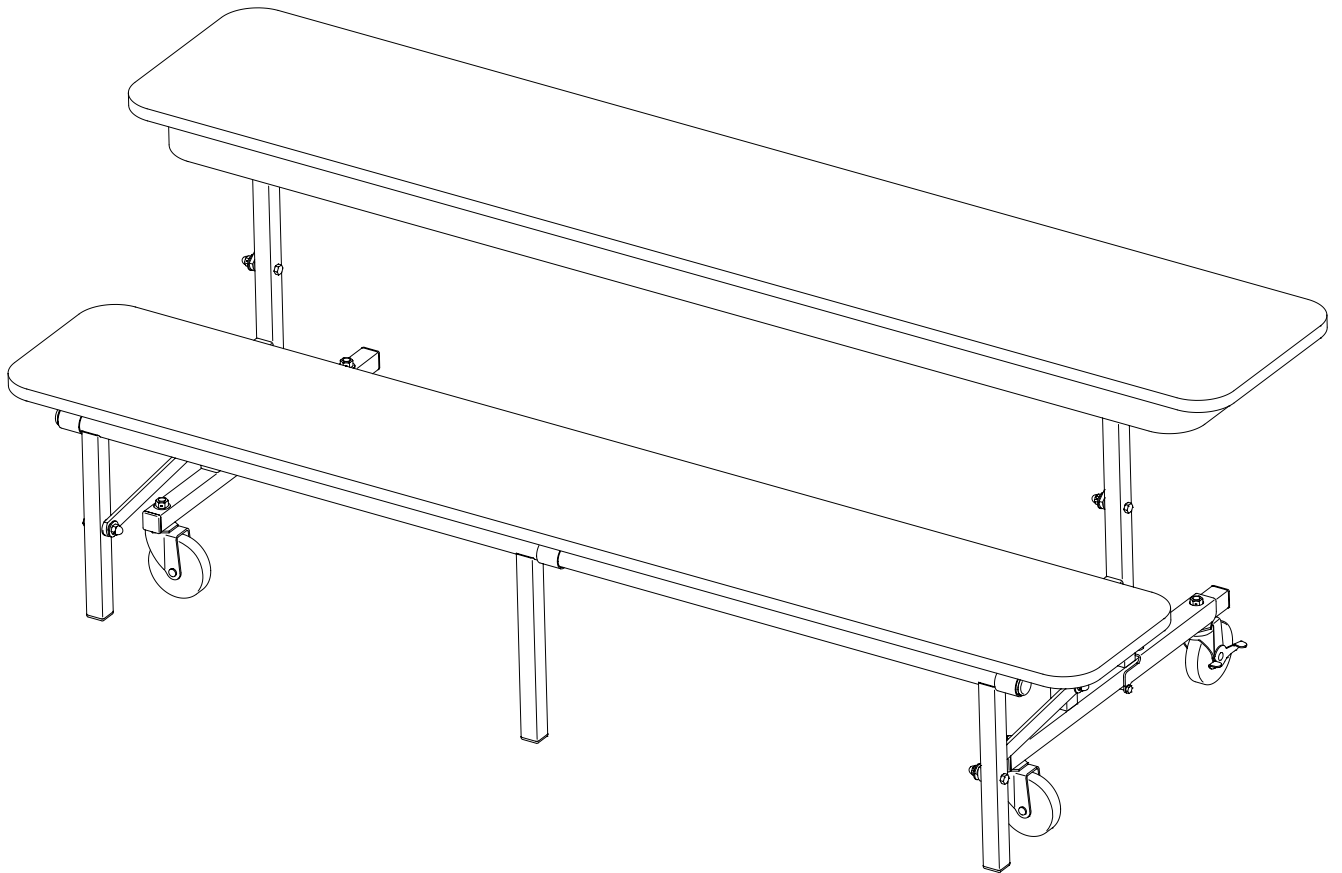

Tools Required: 4mm Hex wrench, $\frac{3}{8}$ " ratchet wrench, $\frac{7}{16}$ " & $\frac{9}{16}$ " sockets, adjustable wrench.

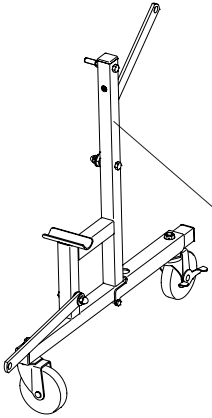

Label on leg
 L=Left- & R=Right-hand
 Leg Assemblies

Support Leg Assembly
 Right-hand
 Qty. 1

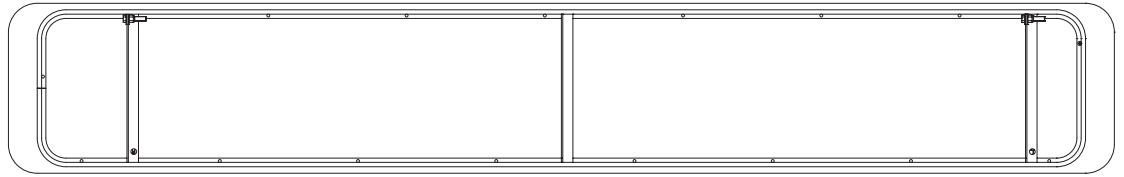

Top Assembly
 Qty. 1

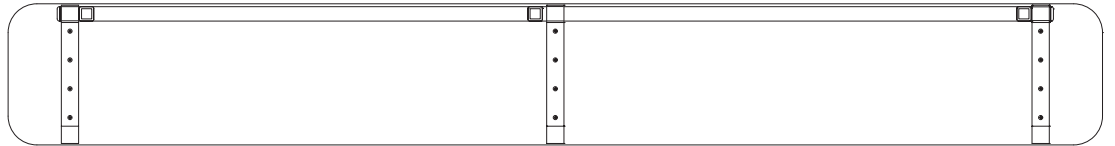

Bench Assembly
 Qty. 1

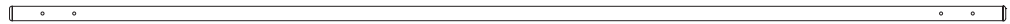

Main Horizontal Tube
 Qty. 1

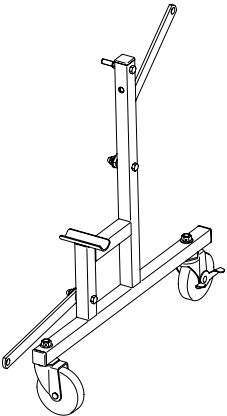

Support Leg Assembly
 Left-hand
 Qty. 1

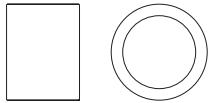

Item #1
 Steel Spacer, .50" OD x .38" ID
 Qty. 6

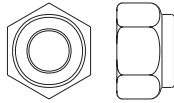

Item #2
 Nut, $\frac{1}{4}$ -20 Nylon Lock
 Qty. 4

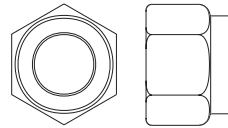

Item #3
 Nut, $\frac{3}{8}$ -16 Nylon Lock
 Qty. 4

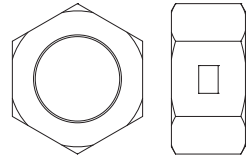

Item #4
 Nut, $\frac{7}{16}$ -14 Center Lock
 Qty. 4

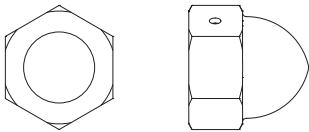

Item #5
 Nut, $\frac{3}{8}$ -16 UNC Acorn
 Qty. 2

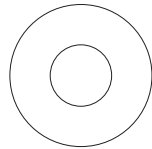

Item #6
 Flat Washer, $\frac{1}{4}$ " SAE
 Qty. 4

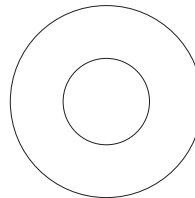

Item #7
 Flat Washer, $\frac{3}{8}$ " SAE
 Qty. 12

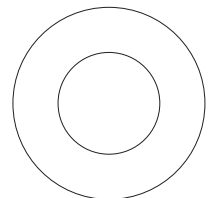

Item #8
 Flat Washer, $\frac{1}{2}$ " Nylon
 Qty. 4

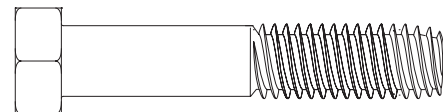
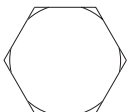

Item #9
 Hex Bolt, $\frac{3}{8}$ -16 x 2" HHCS
 Qty. 2

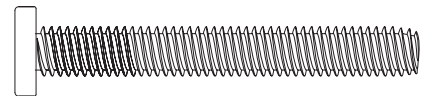

Item #10
 Socket Cap Screw, $\frac{1}{4}$ -20 Button Head
 Qty. 4

Uniframe® Convertible Bench
 Assembly Instructions

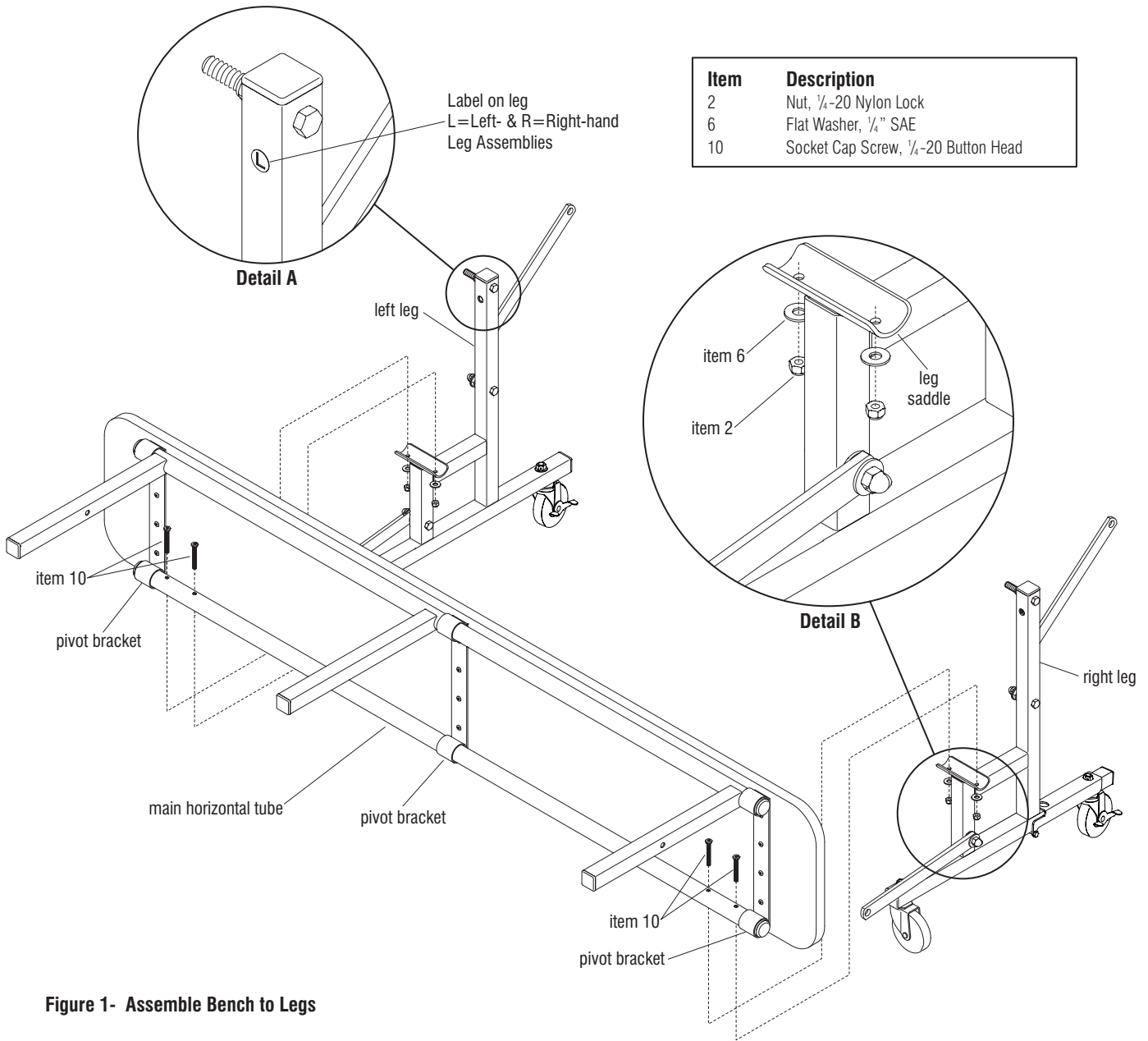

Figure 1- Assemble Bench to Legs

1. Identify right- & left-hand support leg assemblies by labels on upper support member (Figure 1 & Detail A).
2. Insert main horizontal tube through the pivot brackets in each bench assembly (Figure 1).
3. Insert four 1/4-20 x 2" screws (item 10) into main horizontal tube (Figure 1).
4. Place bench assembly with main tube onto leg saddles.
5. Align item 9 screws with holes and attach bench assembly with 1/4" flat washers (item 6) and 1/4-20 nylon lock nuts (item 2) (Figure 2 & Detail B).

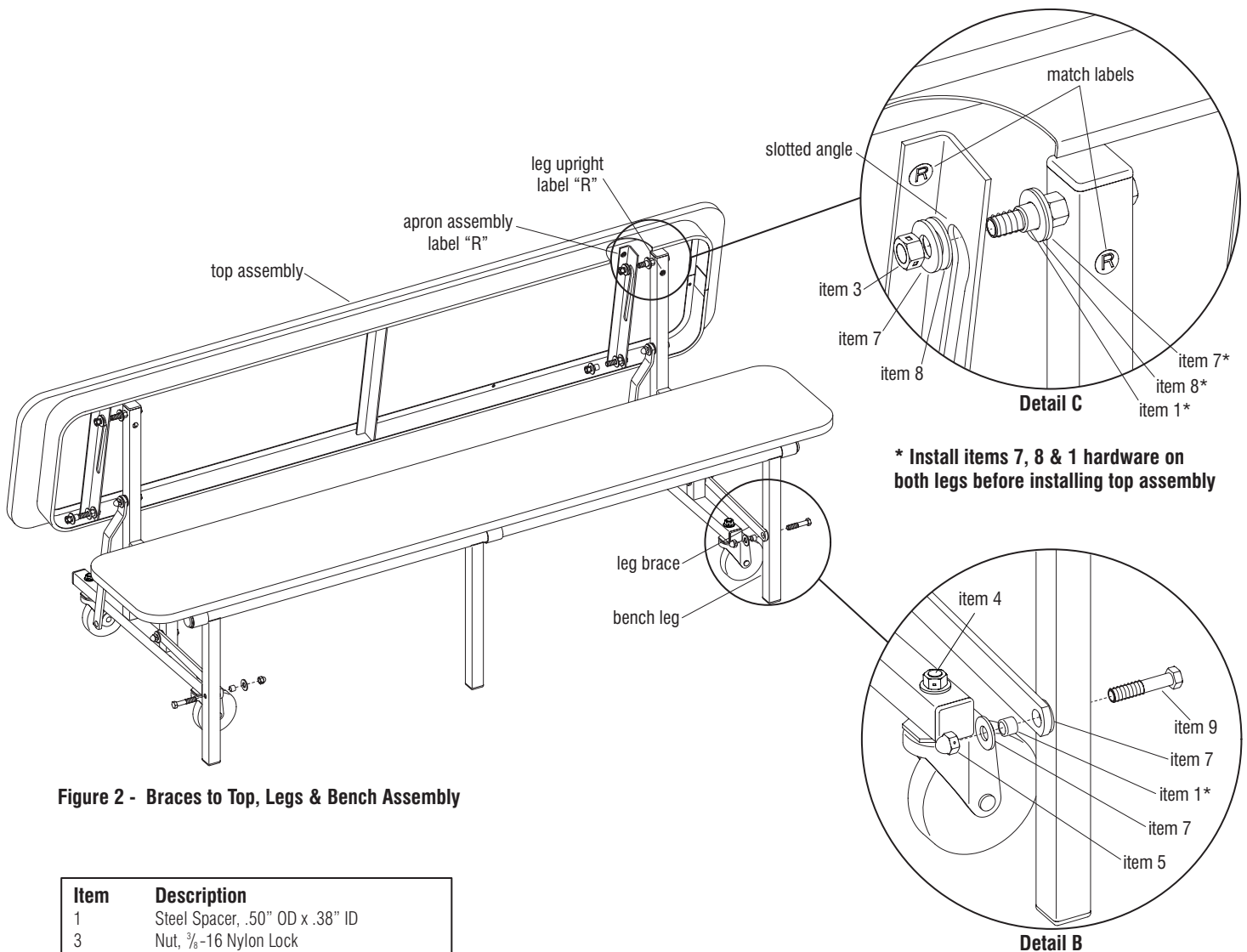

Figure 2 - Braces to Top, Legs & Bench Assembly

Item	Description
1	Steel Spacer, .50" OD x .38" ID
3	Nut, 3/8-16 Nylon Lock
4	Nut, 7/16-14 Center Lock
5	Nut, 3/8-16 UNC Acorn
7	Flat Washer, 3/8" SAE
8	Flat Washer, 1/2" Nylon
9	Hex Bolt, 3/8-16 x 2" HHCS

Bench Legs to Bench Brace
*Steel spacers allow the fasteners to tighten without restricting movement at pivot points

1. Install leg braces to bench legs using hardware installed in sequence shown (Figure 2 & Detail B).
2. At top of leg uprights, install 3/8" flat washer (item 7), 1/2" nylon washer (item 8) and 3/8" steel spacer (item 1) onto leg bolts in sequence shown (Detail C).
3. Locate "L" and "R" labels on apron assembly under top.
4. Install top assembly through slotted angle over the spacers on bolts (Detail C).
5. Install 1/2" nylon washer (item 8), 3/8" flat washer (item 7) and 3/8-16 nylon lock nut (item 3) onto bolts and tighten (Detail C).

■ Uniframe® Convertible Bench
 Assembly Instructions

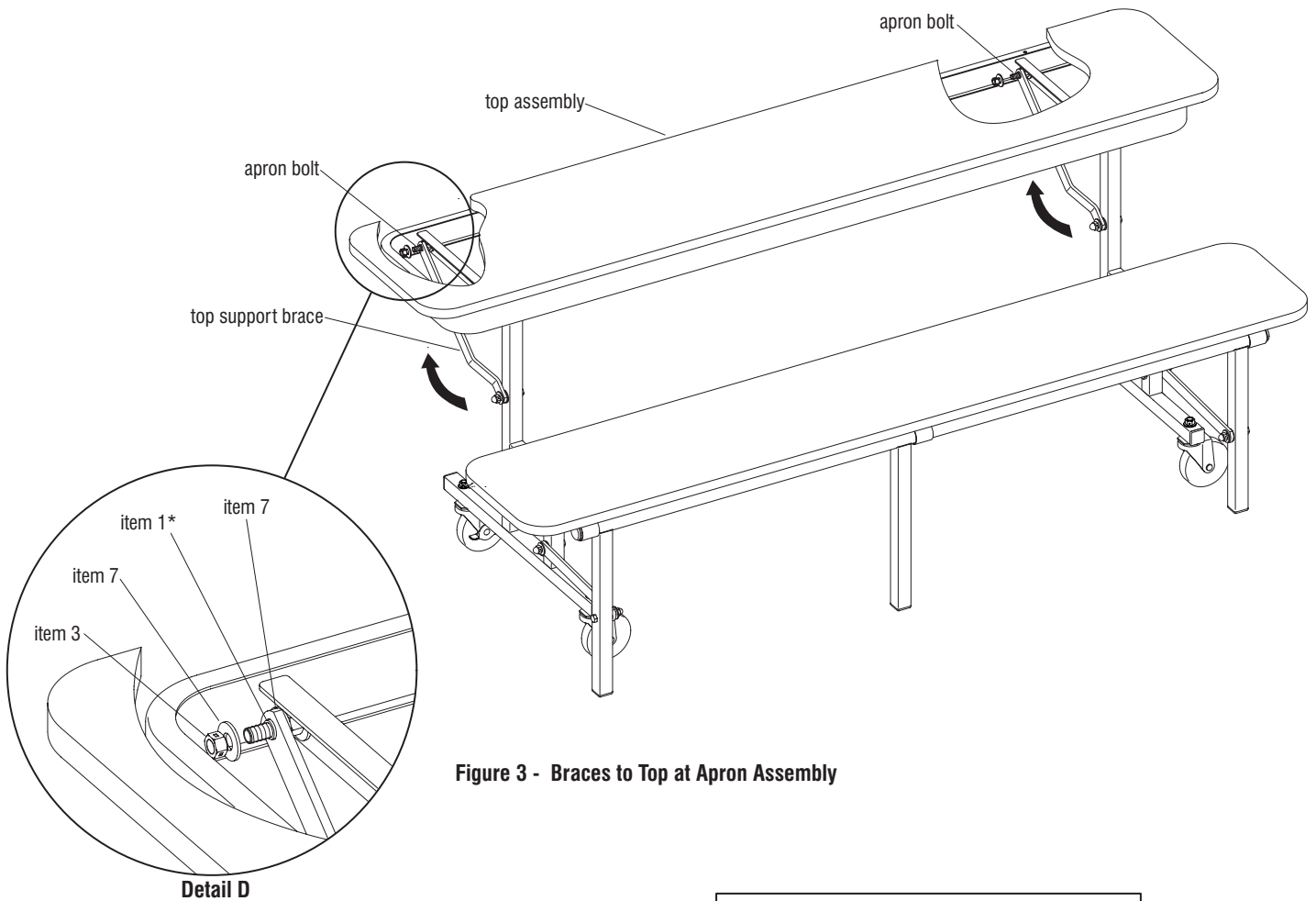

Figure 3 - Braces to Top at Apron Assembly

Top Leg Brace to Apron
 *Steel spacers allow the fasteners to tighten without restricting movement at pivot points

Item	Description
1	Steel Spacer, .50" OD x .38" ID
3	Nut, 3/8"-16 Nylon Lock
7	Flat Washer, 3/8" SAE

1. Attach 3/8" flat washer (item 7) and steel spacer (item 1) onto both apron bolts in sequence shown (Figure 3 & Detail D).
2. Rotate top assembly up (Figure 3).
3. Rotate both top support brackets up and locate them onto the apron bolts. Spacers go into the brace hole (Figure 3 & Detail D).

4. Install 3/8" flat washer (item 7) and 3/8"-16 nylon lock nut (item 3) onto apron bolts and tighten (Detail D).

Note: Steel spacers allow the fasteners to tighten without restricting movement at pivot points.

KI
1330 Bellevue Street
P.O. Box 8100
Green Bay, Wisconsin 54308-8100
1-800-424-2432
www.ki.com

KI is a registered trademark
of Krueger International, Inc.

© 2013 Krueger International, Inc.
All Rights Reserved
Code KI-61586R9/KI/GT/I013

Part # 13.7709

