

# Lighting 101

Follow these simple tips for sizing and hanging your lighting fixtures:

1

## OUTDOOR LANTERNS

**When Hanging 1 Lantern:** Your lantern should measure about  $\frac{1}{3}$  the height of your door.

**When Hanging 2 Lanterns:** Your lanterns should measure about  $\frac{1}{4}$  the height of your door.

As a general rule of thumb, your lanterns should appear to be about half the size of your door from the street. In all cases, the center of the bulb should rest approximately 66" above the threshold of the door.

2

## SIZING A FIXTURE FOR YOUR FOYER OR ENTRY

When determining whether to hang a flush, semi-flush, or multi-tiered chandelier in your foyer, be advised that the bottom of the fixture should be at least 7' from the floor. For two-story foyers, if there is a window above the door, center the chandelier so it can be seen from outside.

3

If your foyer is extra large, you may want to add sconces. Sconces should be installed about 60" from the floor and about 6'-8" apart.

4 & 5

## IN THE BATH

**Above The Vanity:** When installing fixtures directly over the vanity, in most cases the fixture should be a minimum of 24" wide and the center of the fixture should be mounted about 75"-80" above the floor.

**Flanking The Vanity:** Mounting sconces on either side of your vanity allows light to be evenly distributed across your face. The fixtures should be mounted at eye level and approximately 36"-40" apart.

As seen in:



6 & 7

## BEDROOM LIGHTING

**Overhead Lighting:** A central overhead lighting fixture will allow for the room's general illumination.

**Task & Ambient Lighting:** In addition to giving you the lighting you need to read, mounting sconces on either side of your headboard will keep tables clear while helping to bounce light off walls generating a softer mood and a more spacious feeling.

8

## CHANDELIERS

To size a chandelier for your dining room, or to be the focal point of your space, measure the length and width of your room and add those figures together. The sum, converted to inches will equal the correct sized chandelier.

**Example**

$14' + 20' = 34'$

Converted to inches = 34"

Correct Size Chandelier = 34" Diameter

In most cases, the bottom of your chandelier should sit approximately 30"-32" above the tabletop.

9

## PENDANTS

A small grouping of pendants over an island can add great task lighting to the kitchen while infusing a nice design element. As a rule of thumb, the bottoms of the fixtures should sit approximately 30" from the countertop.

10

## CONSIDER SAFETY

Illuminate and protect against unwanted guests with additional lighting in dark areas of your property.

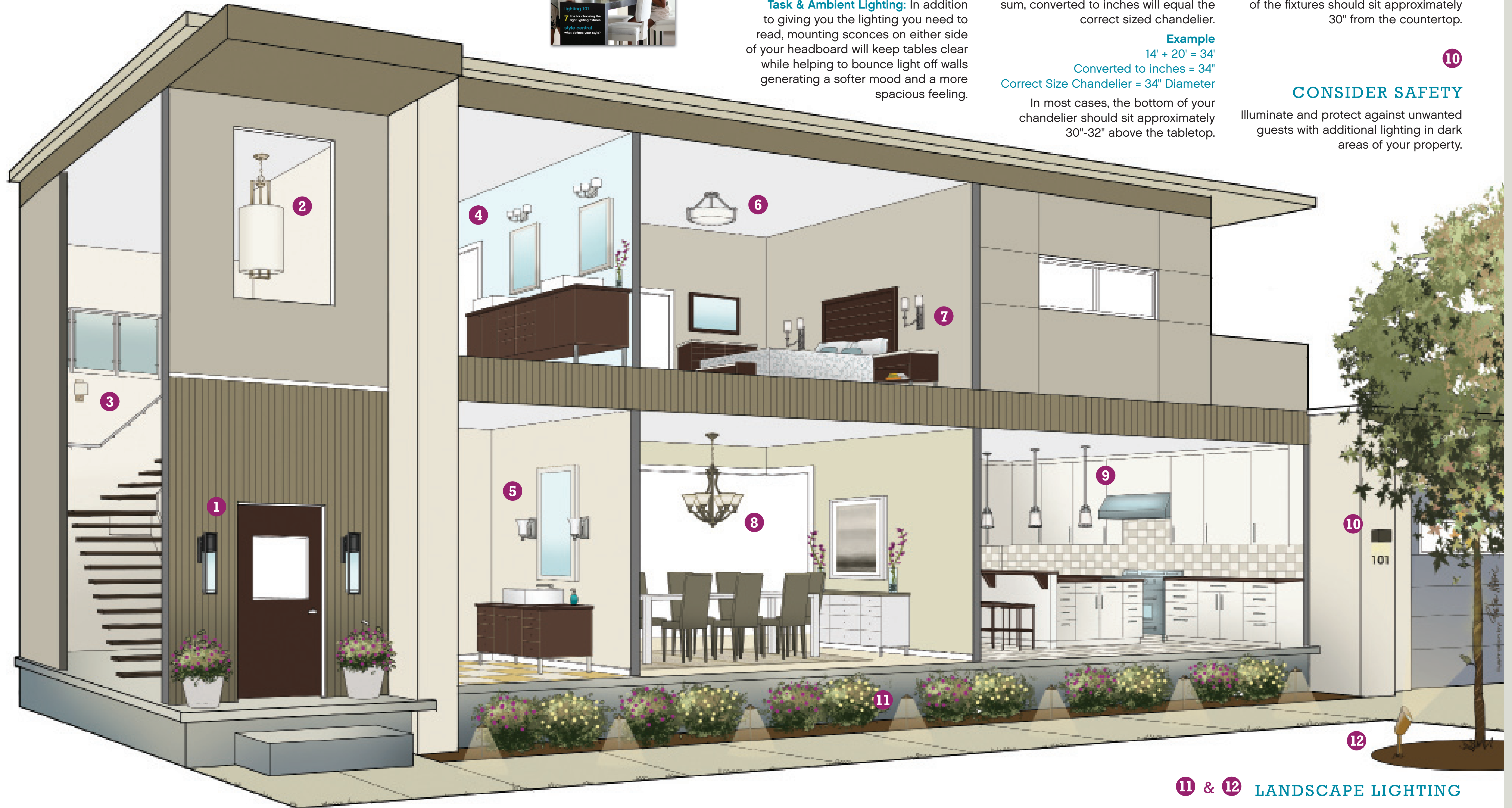

11 & 12 LANDSCAPE LIGHTING

**Path & Area Lighting:** Path lighting should be installed to enhance landscaping and to safely illuminate pathways. A space of about 6' between each light is a general guideline to follow.

**Uplighting:** Illuminating trees or other elements from below will create soft focal points in the landscaping after the sun goes down. Use a flashlight to test where you'd like the light to hit and then mount fixtures accordingly. Be sure to mount fixtures out of the grass for ease of mowing and other landscaping tasks.

This article and other helpful tips can be found in Hinkley's latest issue of Lighting Made Simple. Ask for details.

