

Family: Martina | Item No. 4452 GR

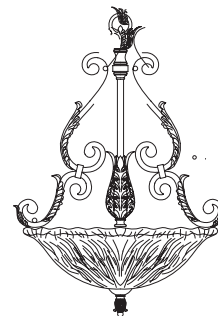

Drawing 1 - Fixture Assembly

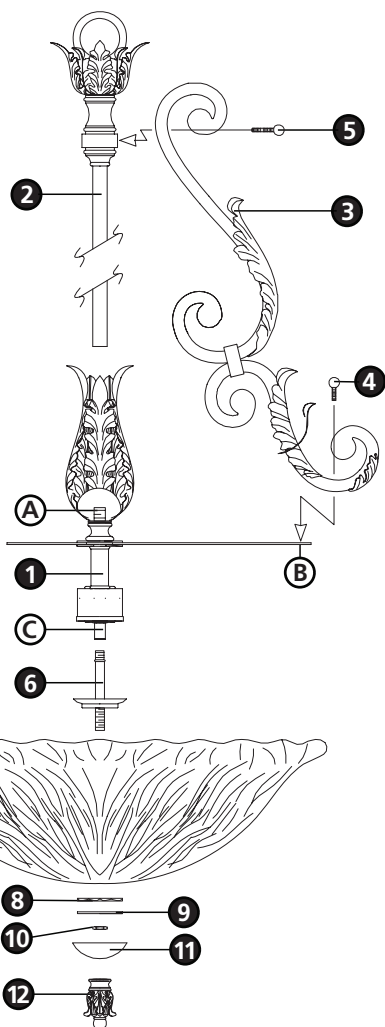

▼ start here

1

1. Find a clear area in which you can work.
2. Unpack fixture and glass from carton.
3. Carefully review instructions prior to assembly.

***** The construction of this fixture will be accomplished by first assembling the main body of the fixture, making all necessary electrical connections, hanging the fixture from the ceiling, and then installing the glass.**

SAFETY WARNING: READ WIRING AND GROUNDING INSTRUCTIONS (I.S. 18) AND ANY ADDITIONAL DIRECTIONS. TURN POWER SUPPLY OFF DURING INSTALLATION. IF NEW WIRING IS REQUIRED, CONSULT A QUALIFIED ELECTRICIAN OR LOCAL AUTHORITIES FOR CODE REQUIREMENTS.

2

1. To assemble fixture, slip center column (2) along wire and thread onto stem (A) located in the center of the cluster assembly (1).
2. Attach bottom of upright (3) to the crossbar (B) using the ball knob studs (4).
3. Attach top of upright (3) to the center column (2) using the ball knob studs (5).
NOTE: It may be necessary to loosen the top loop on the fixture to install the uprights and align them properly with the holes. After all uprights are installed, the loop can be re-tightened.
4. Repeat steps 2-3 for remaining 2 uprights.
5. Thread center stem (6) into coupler (C) and tighten.
6. Please refer to the hanging instruction sheet (I.S. 19) to hang fixture. Then refer back to this sheet to continue installation of this fixture.

3

1. Prior to installing glass, fixture should be lamped accordingly.
2. Slip glass (7) onto center stem (6) and hold in position.
3. Slip rubber washer (8) onto center stem (6) and hold in position.
4. Slip flat washer (9) onto center stem (6) and hold in position.
5. Thread hex nut (10) onto center stem (6) and tighten to secure glass.
5. Slip cap (11) onto center stem (6) and hold in position.
6. Thread decorative knob (12) onto end of center stem (6) and tighten.

Note: Maximum wattage for 4452 fixture is 60 watts per bulb.

2.7.08