

Family: Dunhill | Item No. 4595 RY

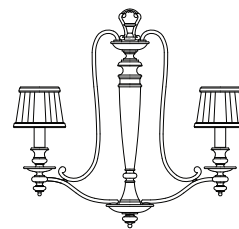

**Drawing 1 - Assembly**

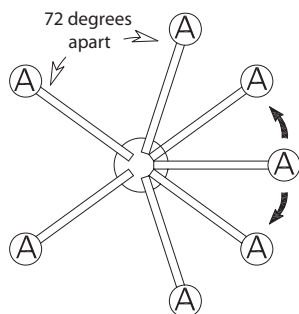

## ▼ start here

**1**

1. Find a clear area in which you can work.
2. Unpack fixture and glass from carton.
3. Carefully review instructions prior to assembly.

**\*\*\* The construction of this fixture will be accomplished by first assembling the main body of the fixture, making all necessary electrical connections, hanging the fixture from the ceiling, and then installing the fixture shade.**

**Drawing 2 - Glass Installation**

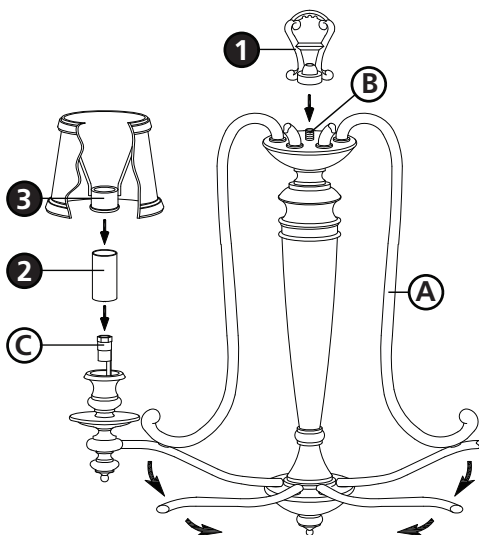

**2**

**SAFETY WARNING: READ WIRING AND GROUNDING INSTRUCTIONS (I.S. 18) AND ANY ADDITIONAL DIRECTIONS. TURN POWER SUPPLY OFF DURING INSTALLATION. IF NEW WIRING IS REQUIRED, CONSULT A QUALIFIED ELECTRICIAN OR LOCAL AUTHORITIES FOR CODE REQUIREMENTS.**

**3**

1. To assemble main body, spread arms (A) located on the main body assembly (1), until they are equally spaced 72 degrees apart - see **Drawing 1**.
2. Slip loop (1) along wire and thread onto threaded tube (B).
3. Please refer to the hanging instruction sheet (I.S. 19) provided to hang fixture. Then refer back to this sheet to install shade.

**4**

1. To install shade, slip candle sleeve (2) over socket (C) - see **Drawing 2**.
2. Slip candle cap with shade (3) over top of candle sleeve (2).
3. Fixture can now be lamped accordingly.

4.9.10