

Assembly Instructions For

WB1482 (E) 10/09

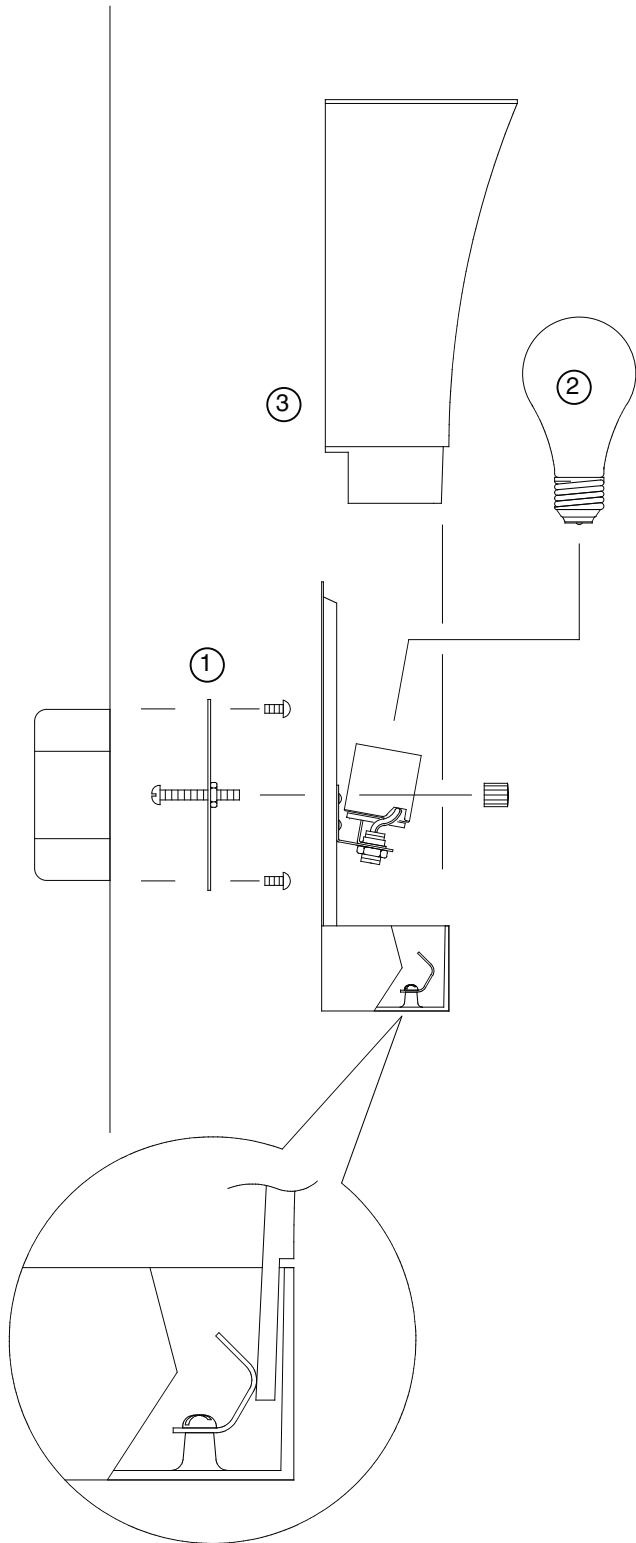

IMPORTANT
TURN OFF THE POWER AT THE MAIN FUSE OR
CIRCUIT BREAKER BOX
BEFORE STARTING INSTALLATION

Carefully unpack and identify all parts before assembly. Bulb not included.

1. Follow enclosed supplement installation instructions for electrical and fixture installation onto house outlet box. If you do not have an outlet box at desired location to attach the fixture then hire a qualified electrician to create one.
2. Install light bulb (not included). See re-lamping label located near socket area for type and maximum allowed wattage.
3. Install shade by sliding inside of fitter until it checks in.

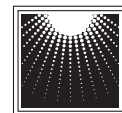

MURRAY
FEISS

GENERATION
BRANDS™ 