

ASSEMBLY INSTRUCTIONS FOR WB1218

(E) 04/04

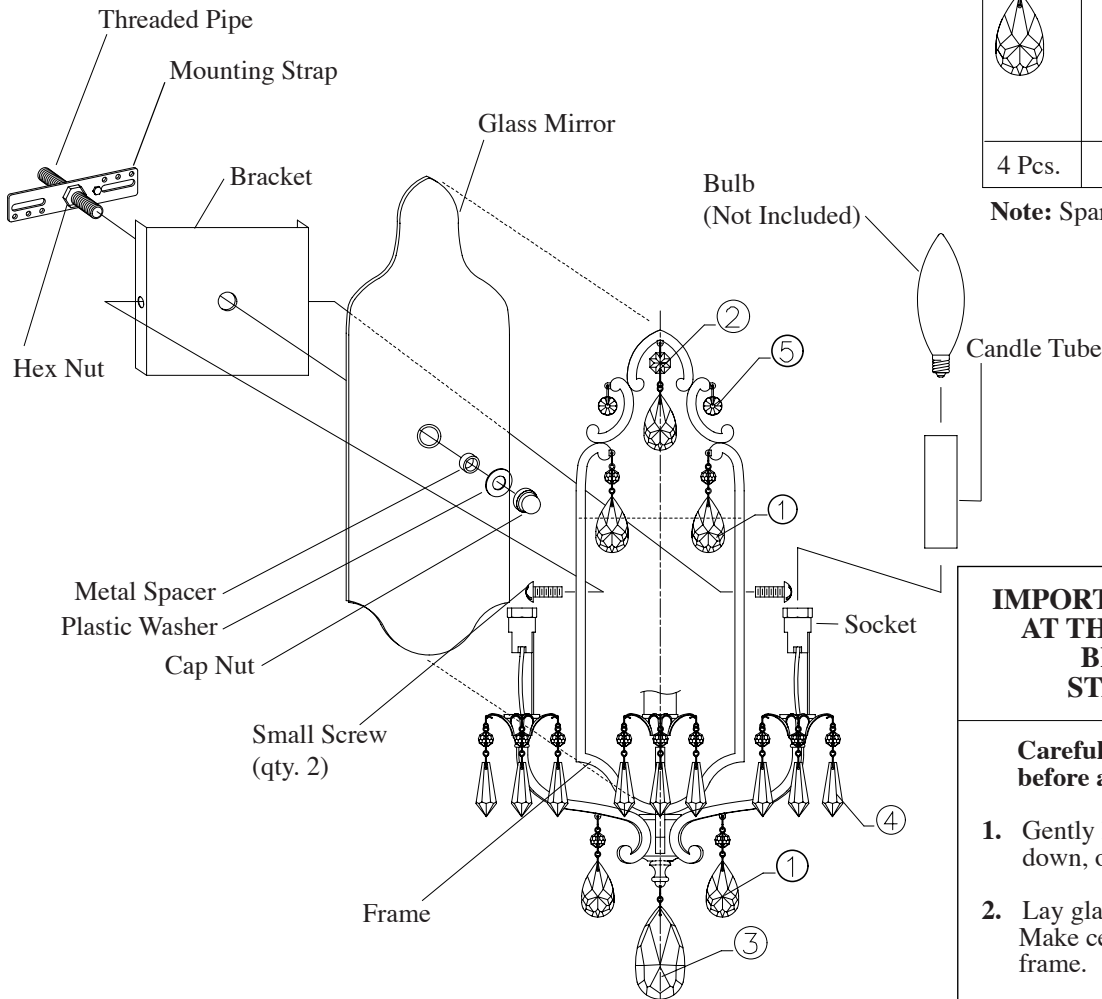

①	②	③	④	⑤
4 Pcs.	1 Pc.	1 Pc.	12 Pcs.	2 Pcs.

Note: Spare crystals enclosed in hardware bag

IMPORTANT TURN OFF THE POWER AT THE MAIN FUSE OR CIRCUIT BREAKER BOX BEFORE STARTING INSTALLATION

Carefully unpack and identify all parts before assembly. Bulbs are not included.

1. Gently lay frame, with socket side facing down, on a non abrasive surface.
2. Lay glass mirror face down on top of frame. Make certain glass mirror is centered within frame.
3. Secure glass mirror to frame by fastening bracket with small screws as shown in illustration.
4. Place candle tubes over candelabra sockets and screw bulbs (not included) into sockets to secure. See relamping label on candle tube for type and maximum allowed wattage.
5. Follow enclosed **“Multiple Standard Installation Instructions”** for electrical and fixture installation onto ceiling outlet box. Be sure to assemble metal spacer inside hole in mirror and plastic washer under cap nut during finial installation.
6. Hang all crystal glass parts as shown on drawing. **NOTE:** To replace broken crystals extras are included in hardware bag. Replace by gently bending open pins, remove broken crystal, hook new one, then close back pins. Avoid bending pins into sharp angle.