

# Assembly Instructions For

# F2533/6 (E) 11/09

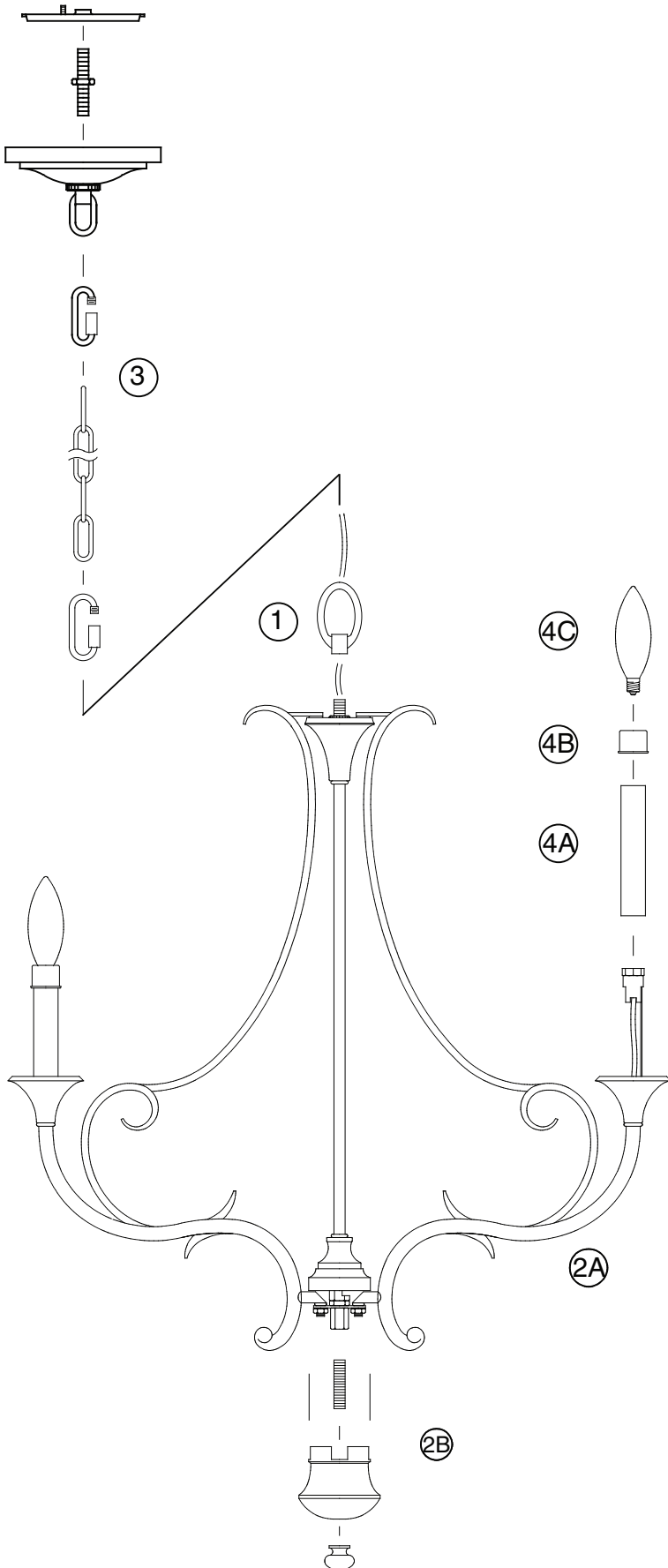

## **IMPORTANT TURN OFF THE POWER AT THE MAIN FUSE OR CIRCUIT BREAKER BOX BEFORE STARTING INSTALLATION**

Carefully unpack and identify all parts before assembly.  
Bulbs not included.

1. Slip fixture loop through fixture wires, then install by screwing on top of fixture.
2. A. Spread open all arms so they are equally spaced apart to each other.  
B. Screw bottom threaded pipe into bottom coupler.  
C. Slip cover onto bottom of fixture, making certain its notches are aligned onto arms. Then secure by fastening with finial.
3. Follow enclosed supplement installation instructions for electrical and fixture installation onto house outlet box. If you do not have an outlet box at desired location to attach the fixture then hire a qualified electrician to create one.
4. A. Slip candle tube over sockets.  
B. Install candle follower over candle tubes.  
C. Install bulb (not included). See relamping label located near socket area for type and maximum allowed wattage.

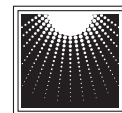

**MURRAY  
FEISS**

GENERATION  
BRANDS™ 