

Assembly Instructions For

OL6007, OL6008 (E) 11/07

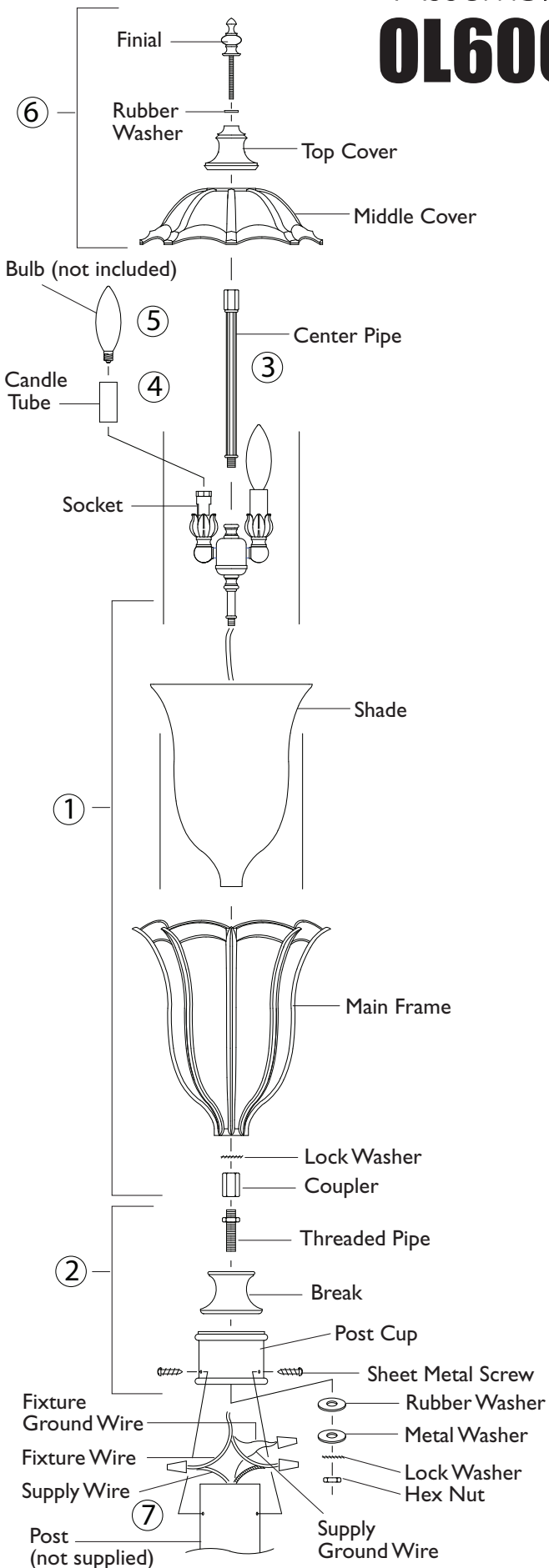

IMPORTANT TURN OFF THE POWER AT THE MAIN FUSE OR CIRCUIT BREAKER BOX BEFORE STARTING INSTALLATION

Carefully unpack and identify all parts before assembly. Bulbs not included.

- Gently place glass shade inside of main frame.
 - Thread fixture wires through shade and main frame bottom holes.
 - Lock them into position by fastening with lock washer and coupler.
- Install a hex nut onto one end of threaded pipe leaving about 3/8" (10 mm) thread exposed. Screw same end of threaded pipe into coupler. Tighten hex nut.
 - Then slide break and post cup through the installed pipe.
 - Slip rubber washer and then metal washer.
 - Lock them into position by fastening with lock washer and hex nut.
- Screw short threaded end of center pipe into top coupler.
- Slip candle cover tube onto sockets.
- Install light bulb (not included). See relamping label at socket area for type and maximum allowed wattage.
- Slide middle cover and top cover thru center pipe till checks onto main frame. Lock them into position with rubber washer and finial.
- Electrical installation onto post: If you are replacing an existing fixture, disconnect and remove the old fixture.

A) Slip post cup over post. Mark position of holes in post cup on post.

B) Remove post cup and expose the supply wiring from above post. Drill 1/8" (3mm) diameter pilot holes in post at places where marked.

C) Make wire connections. (wire connectors not provided). Refer to chart below for correct connections. Wire supply wires to fixture wires accordingly.

Connect Black Fixture Wire to:	Connect White Fixture Wire to:
Black Supply Wire or	White Supply Wire or
*Parallel cord (round & smooth)	*Parallel cord (square & ridged)
Clear, Brown, Gold or Black without tracer	Clear, Brown, Gold or Black with tracer
Insulated wire (other than green) with copper conductor	Insulated wire (other than green) with silver conductor

*Note: When parallel wire (SPT 1 & SPT 2) is used. One wire is square shaped or ridged and the other wire will be round in shape or smooth. (See Illustration)

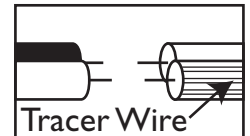

D) Connect ground wire from supply source to fixture ground wire with connector. Never connect ground wire to black or white power supply wires. Carefully place wires inside post.

E) Slip post cup onto post. Align holes in post cup with holes in post. Attach post cup to post with sheet metal screws.

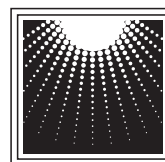

MURRAY
F E I S S
Generation Brands™