

# Assembly Instructions For F2689/5 (E) 6/11

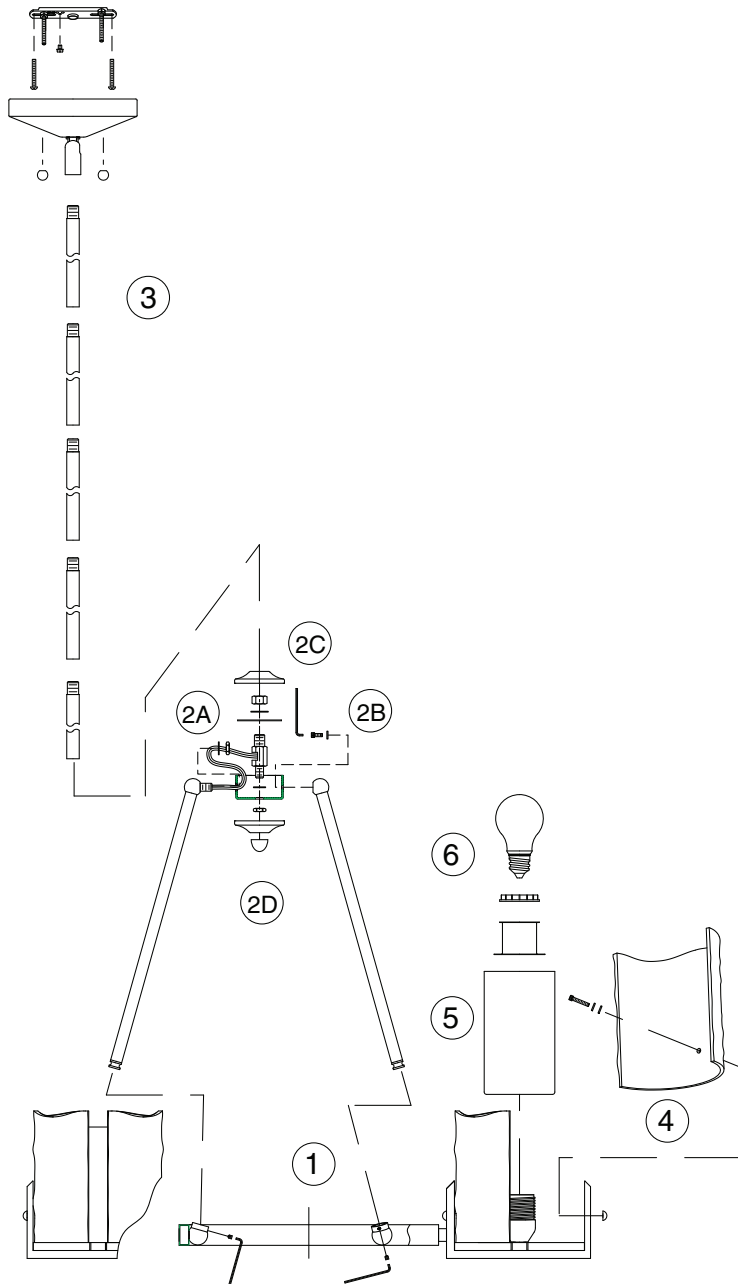
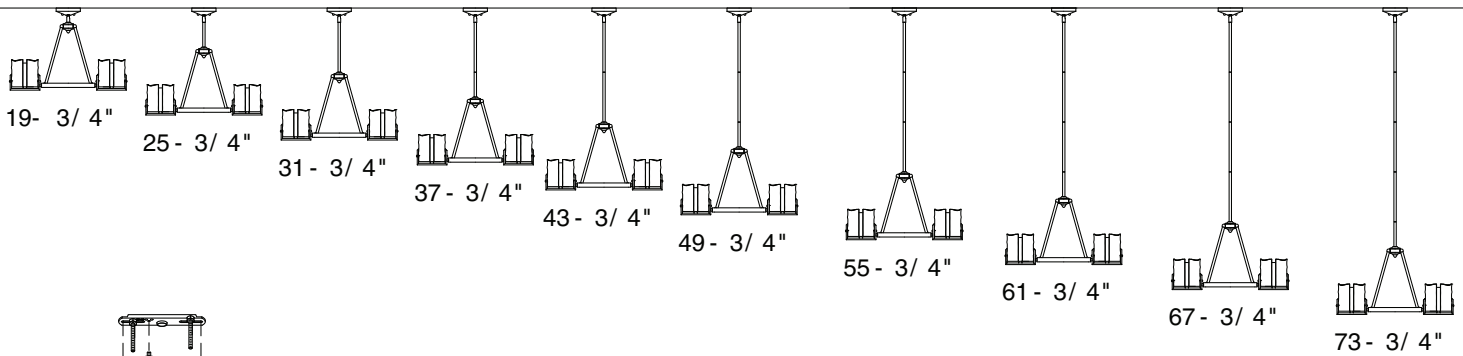

## IMPORTANT TURN OFF THE POWER AT THE MAIN FUSE OR CIRCUIT BREAKER BOX BEFORE STARTING INSTALLATION

Carefully unpack and identify all parts before assembly. Bulbs not included.

1. Thread the bottom section of the arms into the main frame and secure with screws and hex key.
2. A. Install the arm with the cord into the top of the fixture with a hex nut and washer.  
B. Install top section of the arms into the top of the fixture with screws and hex key as shown.  
C. Install coupler into the top of the fixture with washers, hex nuts and top cap.  
D. Secure bottom cap onto the fixture with the finial.
3. Follow enclosed supplement installation instructions for electrical and fixture installation onto house outlet box. If you do not have an outlet box at desired location to attach the fixture then hire a qualified electrician to create one.
4. Install the glass panels onto the fixture with the thumb screws and washers as shown.
5. Install shade by fastening with counter ring and spacer.
6. Install light bulb (not included). See relamping label at socket area for type and maximum allowed wattage.

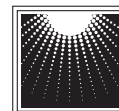

**MURRAY  
FEISS**

GENERATION  
BRANDS™