

Assembly Instructions For

F2696/6+3 (E) 4/11

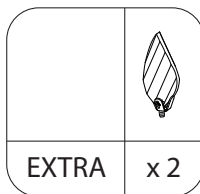

IMPORTANT
TURN OFF THE POWER AT THE MAIN FUSE
OR CIRCUIT BREAKER BOX
BEFORE STARTING INSTALLATION

Carefully unpack and identify all parts before assembly. Bulbs not included.

1. Install the center column onto the fixture body.
2. Follow enclosed supplement installation instructions for electrical and fixture installation onto house outlet box. If you do not have an outlet box at desired location to attach the fixture then hire a qualified electrician to create one.
3. A. Install candle tube by slipping through sockets.
 B. Install type-B, candelabra base, of 60 Watt maximum bulbs (not included).
 C. Install shade onto bulb.
4. A. Install the cap and the bottom crystal assembly onto the bottom of the fixture. Secure with finial.
 B. Install all crystal glass parts as shown on drawing.
 NOTE: To replace broken crystal, extras are included in hardware bag.

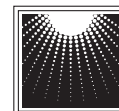
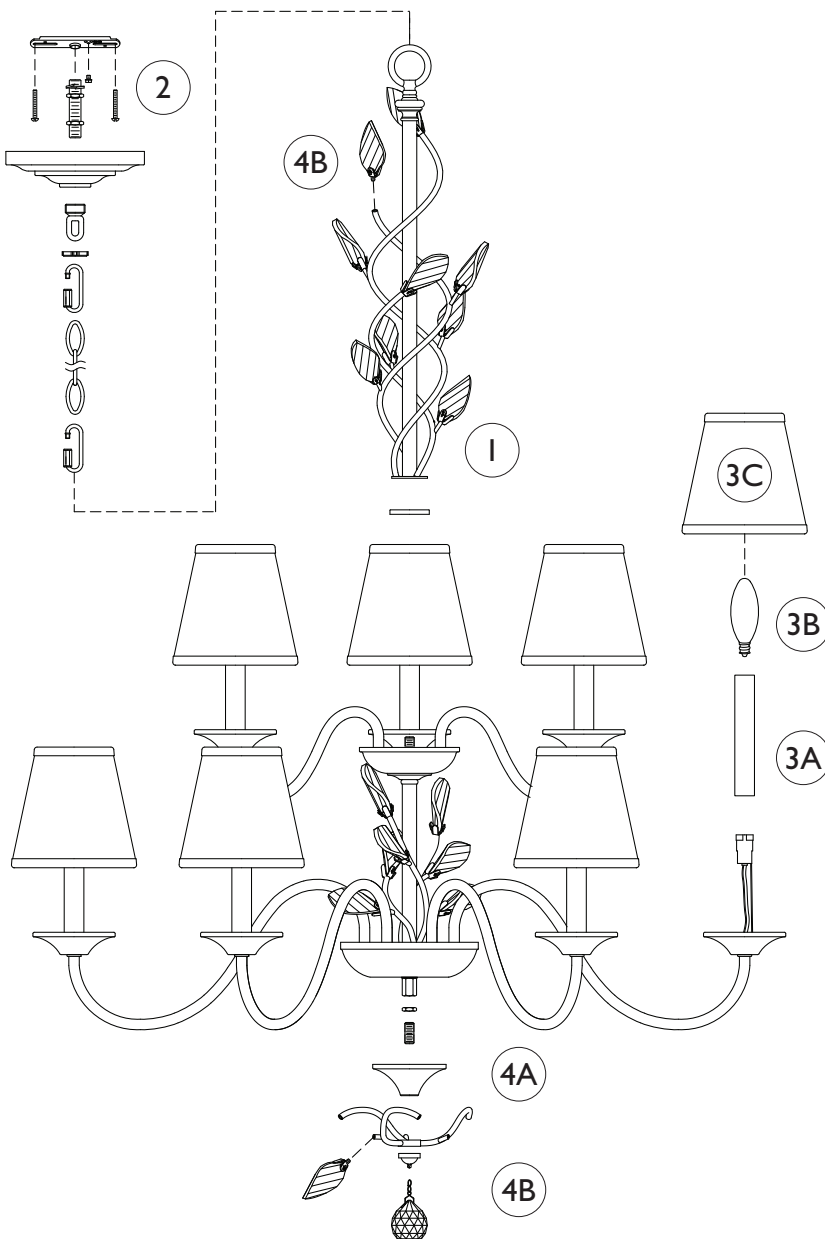

MURRAY
F E I S S

GENERATION
 BRANDS™ 