

Quick tips

Maximizing performance

1. Empty dirt container as dirt reaches "full" line
2. Check pre-motor and Airtight® HEPA filter monthly; clean and replace as needed

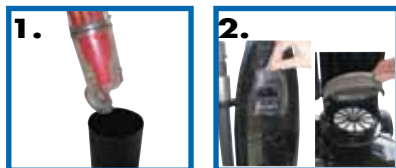

Rotating brush information

1. Brush will only activate when brush switch is on and vacuum is reclined
2. It is recommended to turn off brush switch when vacuuming frieze carpet



Telescoping extension Wand

1. Twist collar to "unlock" and extend wand, lock into place
2. To retract, twist to unlock

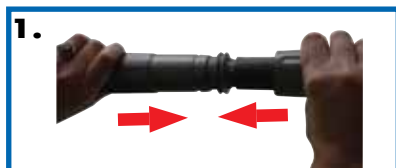

TurboBrush

1. For maximum cleaning; avoid heavy pressure which could stop the rotating brush



For additional tips and troubleshooting

Please refer to User's Guide

Earn BISSELL rewards! Register your product today!

Visit: www.bissell.com

© 2010 BISSELL Homecare, Inc.
BISSELL Homecare, Inc.
P.O. Box 1888
Grand Rapids, MI 49501



Quick Start users guide

BISSELL is happy to be of service.
Contact us directly at **1-800-237-7691** or
visit the website for helpful instructions at
www.bissell.com

PLEASE DO NOT RETURN THIS PRODUCT TO THE STORE
PLEASE KEEP FOR FUTURE REFERENCE

POWERclean® MULTI CYCLONIC HEALTHYhome VACUUM™ 16N5 SERIES

For complete users guide visit www.bissell.com



- | | |
|----------------------------------|--------------------------------------|
| a. Vacuum base | f. Combination Brush |
| b. Handle (with hardware packet) | g. Telescoping Extension Wand |
| c. Hose rack | Crevice Tool (inside Extension wand) |
| d. 14 ft Hose | h. 2 Long Screws and |
| e. TurboBrush® | 2 Short Screws |

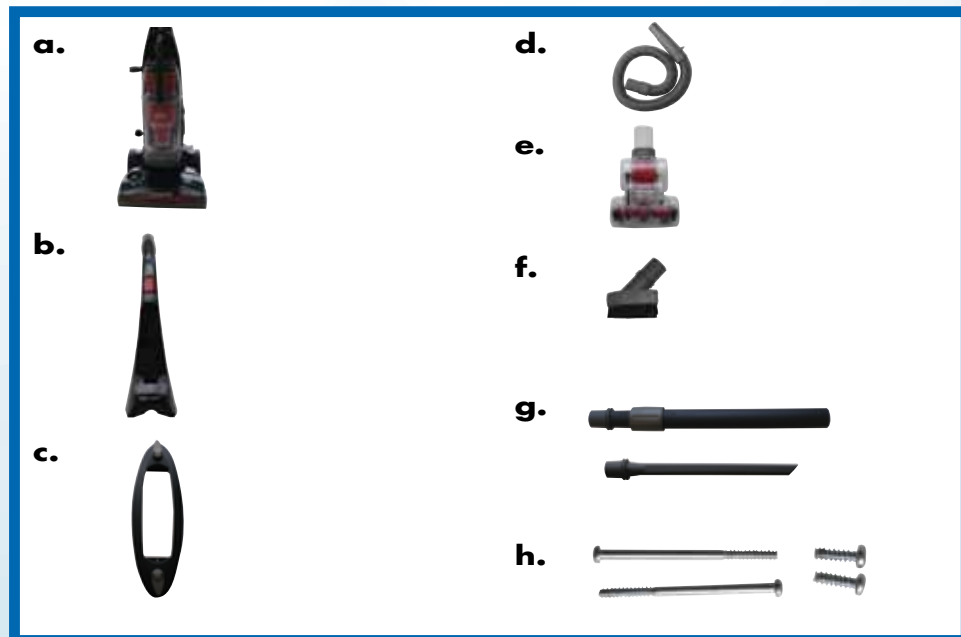

What's needed for assembly: Phillips head screw driver

Assembly

1. Slide handle onto vacuum base, tighten with longer screws
2. Attach hose rack to back of vacuum. Feed power cord through center opening
3. Tighten with shorter screws
4. Identify tabbed end of hose and lock into left opening
5. Feed opposite end of hose into holder on lower right, press down firmly to engage the white suction diverter
6. Slide crevice tool into extension wand and store in clip
7. Snap combination tool into storage clip
8. Attach TurboBrush to handle



Your assembly is now complete.

Ready to vacuum

1. Adjust height for carpet or bare floor
2. Plug into electrical outlet and push power on
3. Step on handle release to lower into cleaning position
4. Be sure to press rotating brush switch on
5. Attach tool for above floor and stair cleaning
6. Empty dirt cup after each use

