

JULIEN

Donnez vie à vos idées.
Make your ideas real.

SPECIFICATIONS

Category: **Fireclay - Speciality sink**
Type: **Undermount single bowl**
Product Name: **Norwalk**

MODEL: **085 102 - White**
085 112 - Biscuit

FEATURES:

- Handcrafted in England
 - Made from heavy fireclay – Solid throughout
 - Up to 40 hours of gradual drying period
 - Fired at more than 1200°C – 2200°F
 - 30 mm (1-1/8") material thickness *
 - Center 3-1/2" drain placement
 - Scratch and chip resistant
 - Waste disposal unit compatible
- (* dimensions may vary by +/- 2%)

AVAILABLE COLOURS:

White

Biscuit



SINK DIMENSIONS:

Model	Overall	Bowl (s)	Depth	Recommended Cabinet size
085 102 085 112	18	15	6 1/2	24

WARRANTY:

Julien inc. offers a 1-YEAR LIMITED WARRANTY against manufacturing defects and a 10-YEAR LIMITED WARRANTY on fading/staining issues on its fireclay sinks. For further details on our product warranty, please refer to our catalog or Web site.

- All dimensions are in inches
- Cutout template supplied with every sink and available on our web site

PRODUCT SPECIFICATIONS:

Sink to be undermount round single bowl. Sink to be manufactured from heavy fireclay - solid throughout. Sink to be fired at more than 1200C - 2200F. Sink to feature 30mm thickness material. Sink to feature center drain placement. Sink to be compatible with waste disposal units. Sink overall dimensions* to be 18". Bowl dimensions* to be 15". Sink to be Julien Fireclay collection with bowl depth of 6 1/2". (* dimensions may vary by +/- 2%)

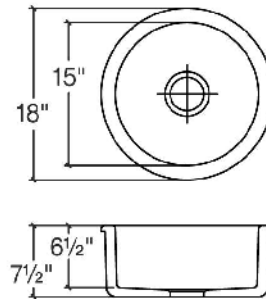

PROJECT/JOB INFORMATION:

Project/Job name: _____

Specifier: _____

Contractor: _____

This specification is subject to change without notice. Julien assumes no responsibility for the use of superseded or voided specifications.