

OUT 

INVISIBLE

55-9733-05-M1

Design by Francesc Vilaró



The photograph may not match the reference exactly. Please read the product description to identify the finish.

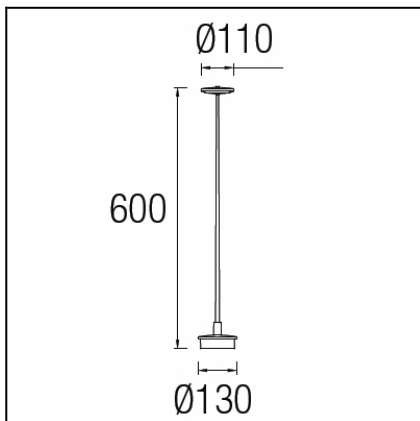

Download photometric file .ldt / .ies

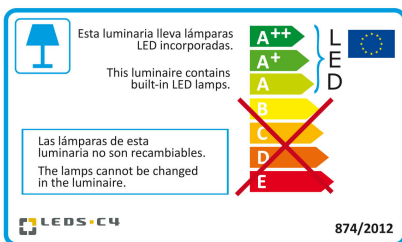

Click on image to download energy label

TECHNICAL CHARACTERISTICS

Type:	Beacon
Adjustable:	Adjustable 355° on the horizontal axis.
IP Protection degrees:	IP54
IK Protection degrees:	IK04
Light source 1:	104 x LED 9W Warm White - 3000K 864 lm ^(N)
Total power consumption (W):	12.2W
Voltage / Frequency:	100-240V/50-60Hz
Warranty (Years):	2
Option to extend the guarantee (Years):	5
Units per box:	2
Net Weight (Kg):	0.49
EAN:	8435381412708

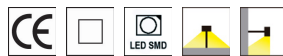

MATERIALS / FINISHES

Structure material:	High purity aluminium Fiber glass	Diffuser material:	Polycarbonate
Structure finish:	Black	Diffuser finish:	Opal

GEAR

Multi-voltage electronic gear included (100-240V / 50-60Hz)

Lm^(N): Nominal flow of light in actual working conditions. Its actual flow will depend on the environmental conditions and the efficiency of the optics and/or diffuser.

LEDS-C4 reserves the right to make the necessary technical changes they deem adequate, in order to improve the features of the product.
Please consult the sales team to clarify any doubt.

(+34) 973 468 100
leds-c4@leds-c4.com
www.leds-c4.com

Luminaire		Measur.		Lamp		
Code	55-9733	Code	55-9733	Code		
Name	CHILLOUT	Name	CHILLOUT	Number	27	
Line	INVISIBLE	Date	25-02-2014	Position		
Efficiency	1199.63%	Coordinate system	CG	Total Flux	27.00 lm	
Maximum value	146.88 cd	Position	C=0.00 G=10.00	Asymmetrical		
Rectangular Luminaire	Length	1 mm	Width	1 mm	Height	1 mm
Rectangular Luminous Area	Length	1 mm	Width	1 mm	Height	0 mm
Horizontal Luminous Area	0.000001 m2	Emitting area on Plane 180°		0.000000 m2		
Emitting area on Plane 0°	0.000000 m2	Emitting area on Plane 270°		0.000000 m2		
Emitting area on Plane 90°	0.000000 m2	Glare area at 76°		0.000000 m2		
Symmetry Type	Asymmetrical	Maximum Gamma Angle		90		
Measurement Distance	0.00	Measurement Flux		27.00 lm		
Operator		Source voltage				
Temperature	25.00 °C	Source current				
Humidity	60.00 %	Photocell				
Notes						

Line	Code	Luminaire Name	Flux [lm]	Pow. [W]	Q.ty
IESNA-2002			1.00	0.00	27
C.I.E.	55 86 98 100 1200	D DIN 5040			
F UTE	12.00 D	B NBN			
		A40			
		BZ 3			

1mm x 1mm

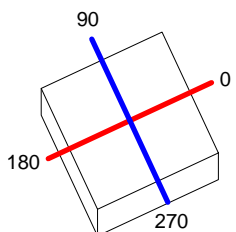

C Halfplanes

180.0 — 0.0

270.0 — 90.0

ULOR 0.00 %

DLOR 1199.63 %

RN 0.00 %

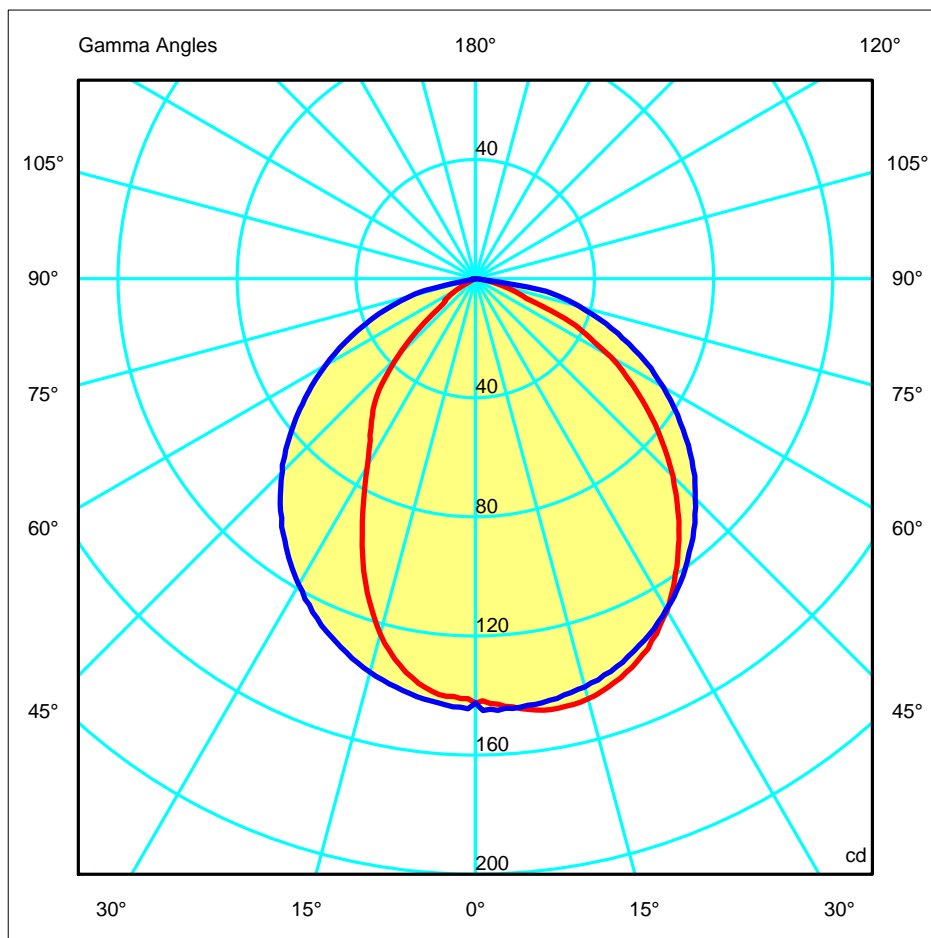

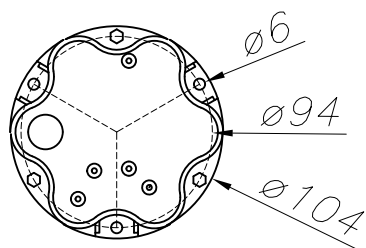
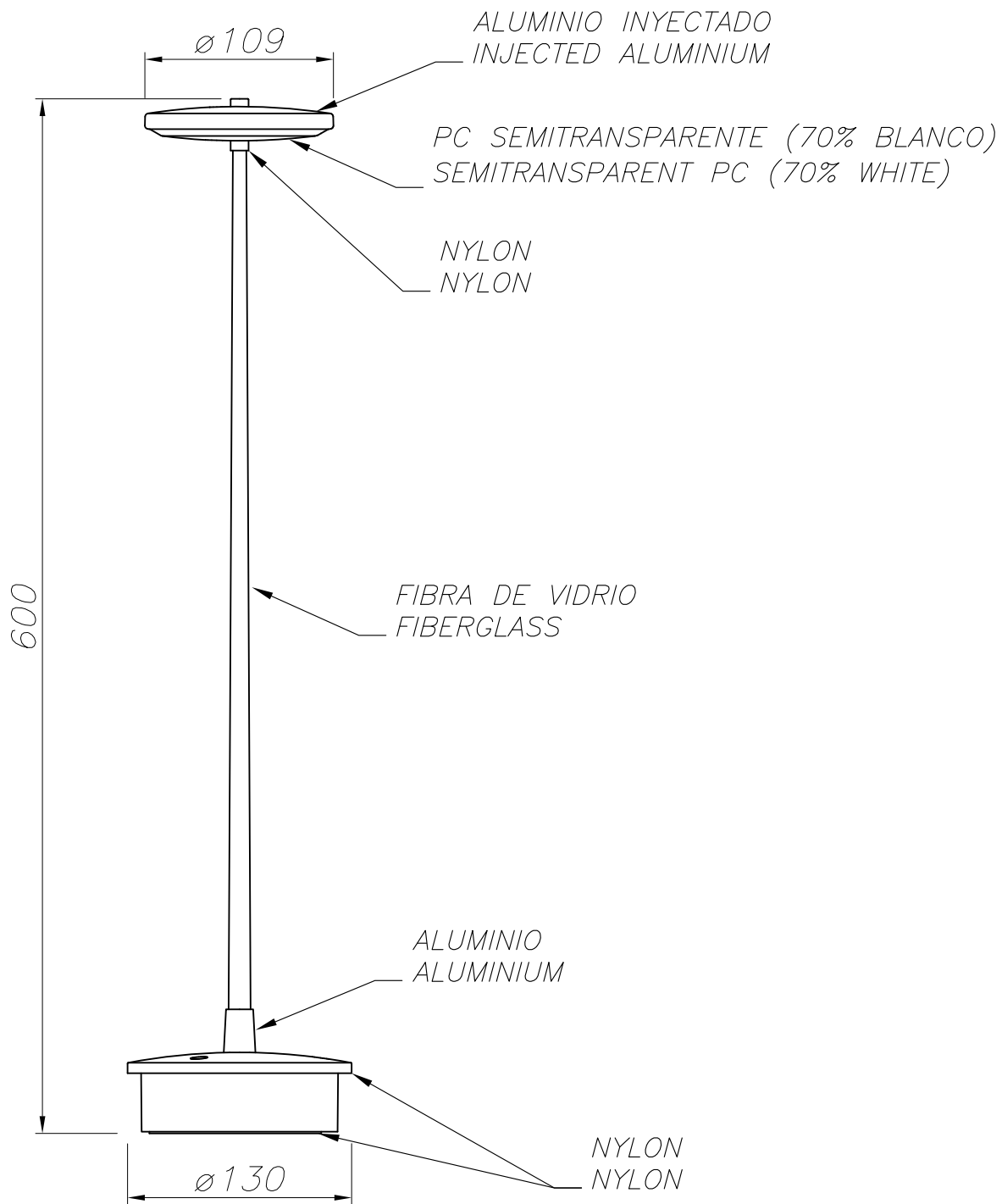

PLANTILLA DE INSTALACION
INSTALLATION TEMPLATE

