

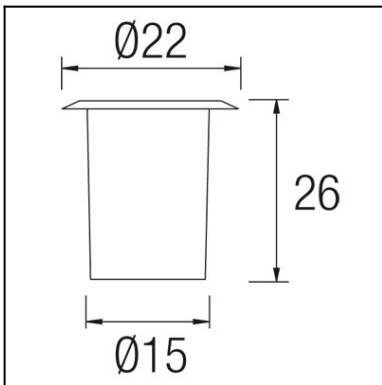

The photograph may not match the reference exactly. Please read the product description to identify the finish.



TECHNICAL CHARACTERISTICS

Type:	UPLIGHT RECESSED
Adjustable:	Adjustable $\pm 15^\circ$ on the vertical axis
IP Protection degrees:	IP67
IK Protection degrees:	IK10
Light source 1:	1 x G12 HIT-T-70W
Total power consumption (W):	80
Angle of the optics / Reflector:	100°, 18°
Voltage / Frequency:	230V/50Hz
Warranty (Years):	2
Units per box:	2
Net Weight (Kg):	5.045
EAN:	8435111089538

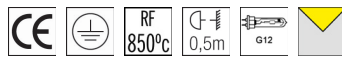

MATERIALS / FINISHES

Structure material: Stainless steel AISI316 Injected aluminium	Diffuser material: Glass
Structure finish: Polished	Diffuser finish: Tempered

GEAR

Gear included: Yes, Magnetic

D(m)	MedLux	D(m)	MedLux
11.22	21	1.06	788
8.97	33	0.85	1231
6.73	58	0.64	2189
4.49	130	0.42	4926
2.24	522	0.21	19704

H Alpha=48.3°+48.3° Alpha=6.0°+6.0°

Download photometric file .ldt / .ies

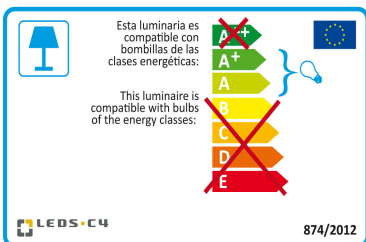

Click on image to download energy label

71-9187-Y4-37

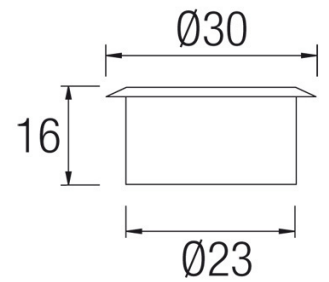
**Structure material:** Stainless steel AISI304**Structure finish:** Polished**Diffuser material:** Glass**Diffuser finish:** TransparentIP67 RF
850°C

71-9638-CA-CA

**Structure material:** Stainless steel AISI316**Structure finish:** Polished

Luminaire		Measur.		Lamp		
Code	55-9187	Code	LEDS017	Code	HIT 70/830	
Name	GEA	Name	GEA	Number	1	
Line	Eulumdat	Date	29-04-1994	Position		
Efficiency	56.71%	Coordinate system	CG	Total Flux	5500.00 lm	
Maximum value	1534.50 cd	Position	C=0.00 G=0.00	Asymmetrical		
Rectangular Luminaire	Length	220 mm	Width	220 mm	Height	257 mm
Rectangular Luminous Area	Length	110 mm	Width	110 mm	Height	0 mm
Horizontal Luminous Area	0.012100 m2	Emitting area on Plane 180°		0.000000 m2		
Emitting area on Plane 0°	0.000000 m2	Emitting area on Plane 270°		0.000000 m2		
Emitting area on Plane 90°	0.000000 m2	Glare area at 76°		0.002927 m2		
Symmetry Type	Asymmetrical	Maximum Gamma Angle		180		
Measurement Distance	0.00	Measurement Flux		5500.00 lm		
Operator		Source voltage				
Temperature	25.00 °C	Source current				
Humidity	60.00 %	Photocell				
Notes						

Line		Code		Luminaire Lamps		Flux [lm]	Pow. [W]	Q.ty
Eulumdat		HIT 70/830		Name		5500.00	0.00	1
C.I.E.	63 96 100 100 57			D DIN 5040	A50			
F UTE	0.57 C			B NBN	BZ 3 / 1.5 / BZ 2			

220mm x 220mm

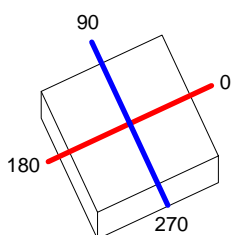

C Halfplanes

180.0 — 0.0 (Red line)

270.0 — 90.0 (Blue line)

ULOR 0.00 %

DLOR 56.71 %

RN 0.00 %

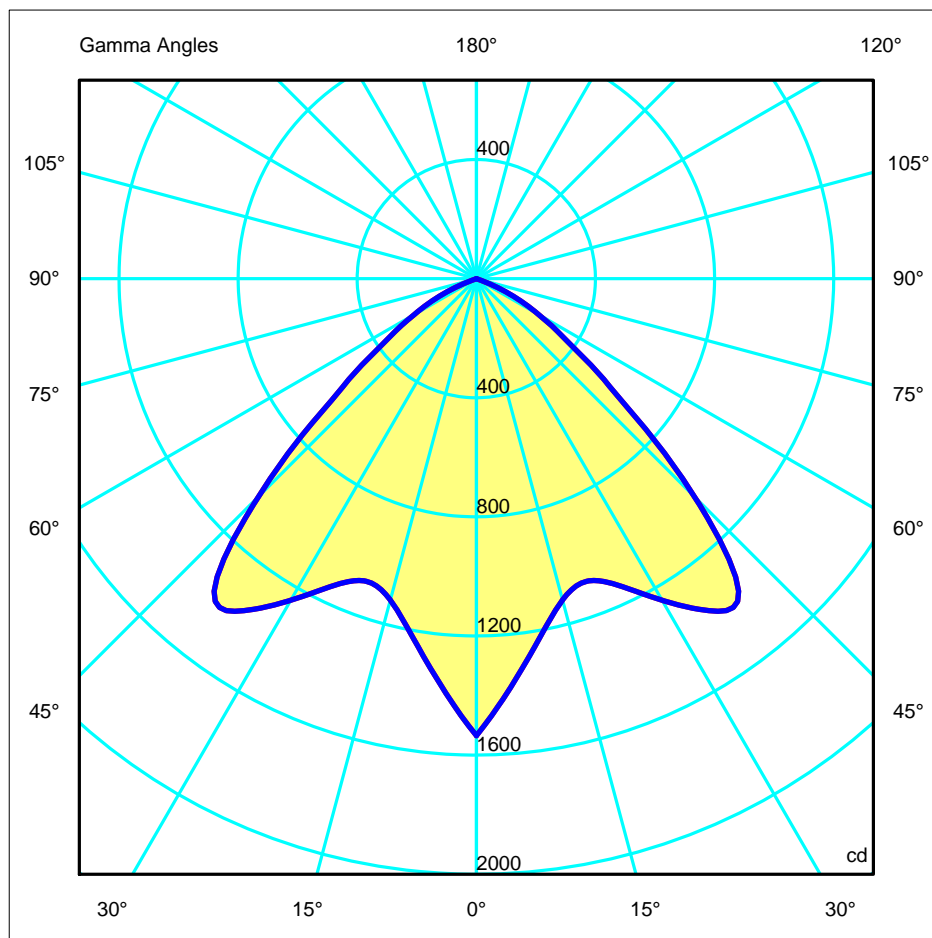

Luminaire		Measur.		Lamp	
Code	55-9187-Y4-37	Code	IF060057	Code	PHILIPS MASTER COLOUR CDM-T 70W G12 - 7600 K
Name	55-9187-Y4-37	Name	55-9187-Y4-37	Number	1
Line	Eulumdat	Date	12-06-2006	Position	
Efficiency	56.65%	Coordinate system	CG	Total Flux	6600.00 lm
Maximum value	1242.52 cd	Position	C=0.00 G=135.00	Rotosymmetrical	
Round Luminaire	Diam.	223 mm	Height	1 mm	
Round Luminous Area	Diam.	152 mm	Height	0 mm	
Horizontal Luminous Area	0.018146 m2	Emitting area on Plane 180°	0.000000 m2	Emitting area on Plane 270°	0.000000 m2
Emitting area on Plane 0°	0.000000 m2	Glare area at 76°	0.004390 m2		
Emitting area on Plane 90°	0.000000 m2				
Symmetry Type	Rotosymmetrical	Maximum Gamma Angle	180		
Measurement Distance	0.00	Measurement Flux	6600.00 lm		
Operator		Source voltage			
Temperature	25.00 °C	Source current			
Humidity	60.00 %	Photocell			
Notes					

Luminaire Lamps						
Line	Code	Name	Flux [lm]	Pow. [W]	Q.ty	
Eulumdat	PHILIPS MASTER COLOUR CDM-T 70W G12 - 7600 K	PHILIPS MASTER COLOUR CDM-T 70W G12 - 7600 K	6600.00	70.00	1	
C.I.E.	0 0 0 0 57	D DIN 5040	--			
F UTE	0.57 T	B NBN	--			

Diam=223mm

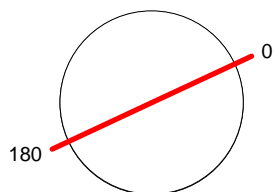

C Halfplanes

180.0 — 0.0

ULOR 56.65 %
DLOR 0.00 %
RN 100.00 %

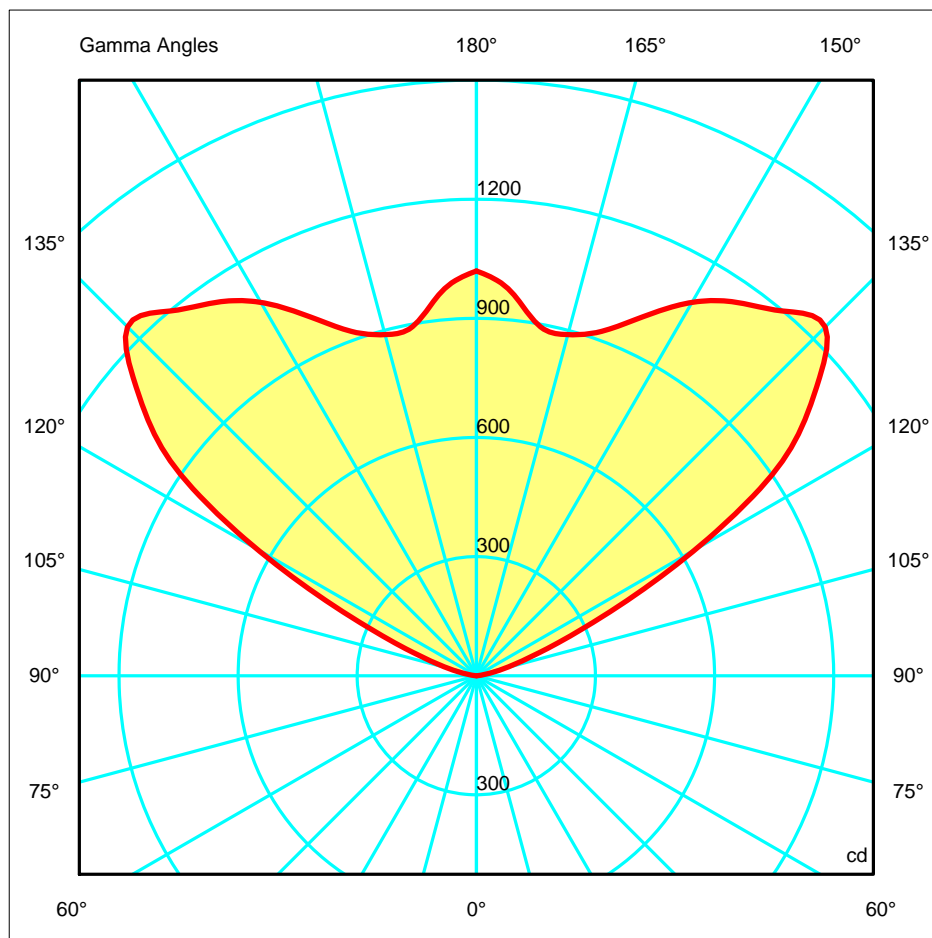

Luminaire		Measur.		Lamp		
Code	55-9187	Code	LEDS017	Code	HIT 70/830	
Name	GEA	Name	GEA	Number	1	
Line	Eulumdat	Date	29-04-1994	Position		
Efficiency	56.71%	Coordinate system	CG	Total Flux	5500.00 lm	
Maximum value	1534.50 cd	Position	C=0.00 G=0.00	Asymmetrical		
Rectangular Luminaire	Length	220 mm	Width	220 mm	Height	257 mm
Rectangular Luminous Area	Length	110 mm	Width	110 mm	Height	0 mm
Horizontal Luminous Area	0.012100 m2	Emitting area on Plane 180°		0.000000 m2		
Emitting area on Plane 0°	0.000000 m2	Emitting area on Plane 270°		0.000000 m2		
Emitting area on Plane 90°	0.000000 m2	Glare area at 76°		0.002927 m2		
Symmetry Type	Asymmetrical	Maximum Gamma Angle		180		
Measurement Distance	0.00	Measurement Flux		5500.00 lm		
Operator		Source voltage				
Temperature	25.00 °C	Source current				
Humidity	60.00 %	Photocell				
Notes						

Line		Code		Luminaire Lamps		Flux [lm]	Pow. [W]	Q.ty
Eulumdat		HIT 70/830		Name		5500.00	0.00	1
C.I.E.	63 96 100 100 57			D DIN 5040	A50			
F UTE	0.57 C			B NBN	BZ 3 / 1.5 / BZ 2			

220mm x 220mm

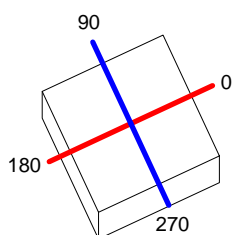

C Halfplanes

180.0 — 0.0 (Red line)

270.0 — 90.0 (Blue line)

ULOR 0.00 %

DLOR 56.71 %

RN 0.00 %

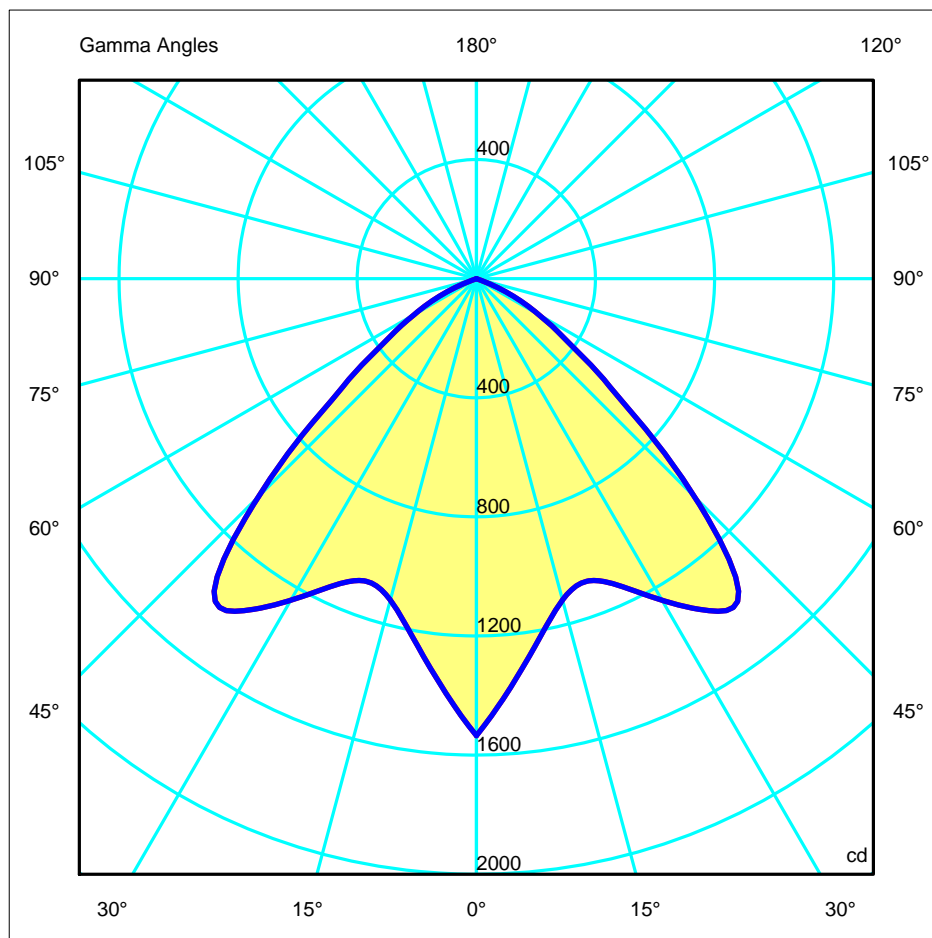

ALUMINIO INYECTADO
INJECTED ALUMINUM

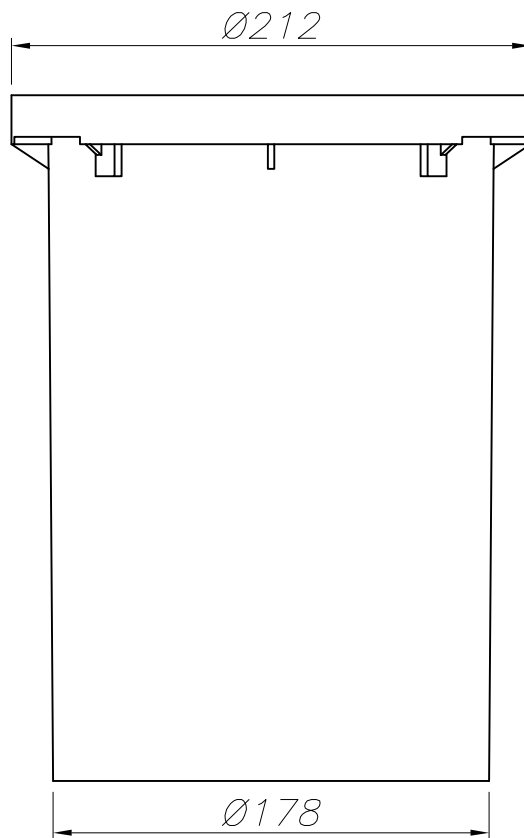
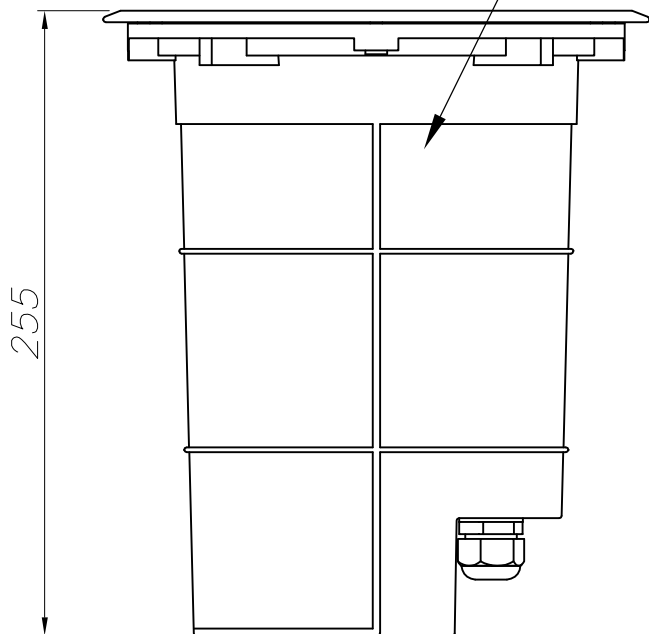

CAJA DE EMPOTRAR
FLUSH FITTING BOX

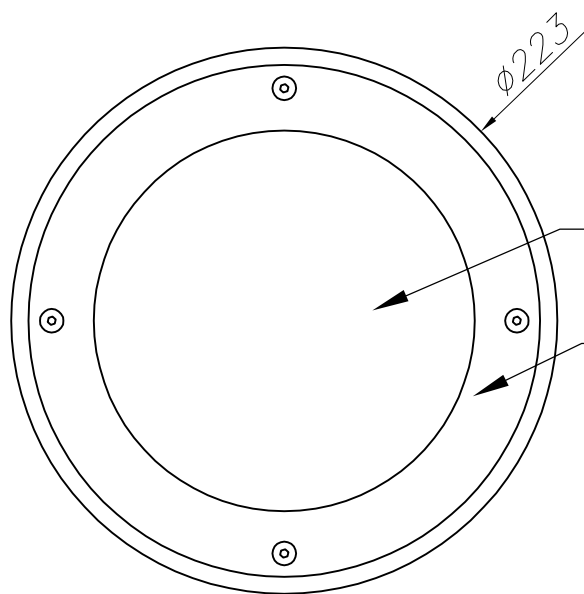

CRISTAL TEMPLADO TRANSPARENTE
TEMPERED TRANSPARENT GLASS

ACERO INOXIDABLE AISI 304
STAINLESS STEEL AISI 304

