

Design by Estudi Ribaudí

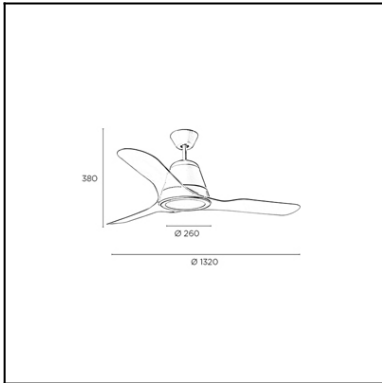

The photograph may not match the reference exactly. Please read the product description to identify the finish.



[Download photometric file .ldt / .ies](#)

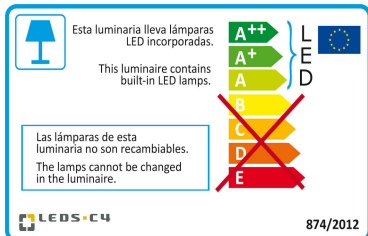

[Click on image to download energy label](#)

TECHNICAL CHARACTERISTICS

Type:	Fan
RPM:	80/145/195
IP Protection degrees:	IP20
Light source 1:	91 x LED Refond 16,6W Warm White - 3000K 1800 lm ^(N) CRI 80
Total power consumption (W):	76
Voltage / Frequency:	230V/50Hz
Warranty (Years):	2
Option to extend the guarantee (Years):	5
Units per box:	1
Net Weight (Kg):	7.845
EAN:	8435381412524



MATERIALS / FINISHES

Structure material:	Steel Aluminium	Diffuser material:	Plastic
Structure finish:	BRIGHT WHITE	Diffuser finish:	White Tinted
Blades material:	Acrylic		
Blades finishes:	Transparent		

GEAR

Gear included: Yes, electronic

Lm^(N): Nominal flow of light in actual working conditions. Its actual flow will depend on the environmental conditions and the efficiency of the optics and/or diffuser.

LEDS-C4 reserves the right to make the necessary technical changes they deem adequate, in order to improve the features of the product.

Please consult the sales team to clarify any doubt.

71-1844-CF-CF

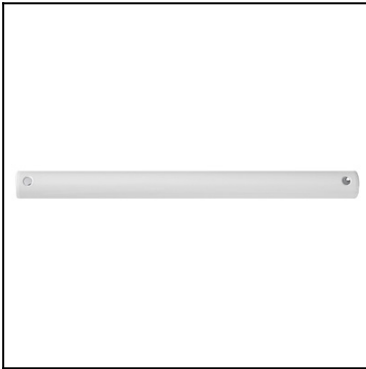

Down rod, 460 mm., Bright white

Structure material: Steel
Structure finish: BRIGHT WHITE



71-1843-CF-CF

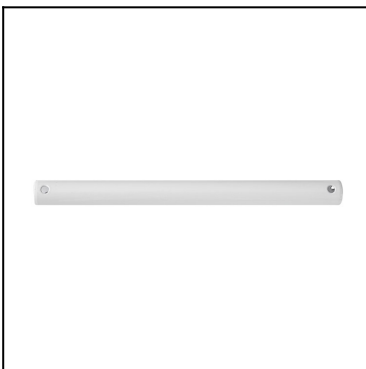

Down rod, 304 mm., Bright white

Structure material: Steel
Structure finish: BRIGHT WHITE



71-4932-00-00



Optional lighting kit, Bright white

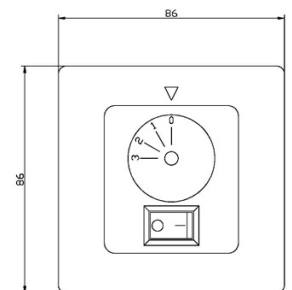

71-4867-13-13



Structure material: Acrylic
Structure finish: Magenta

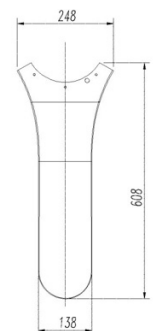

71-4867-11-11

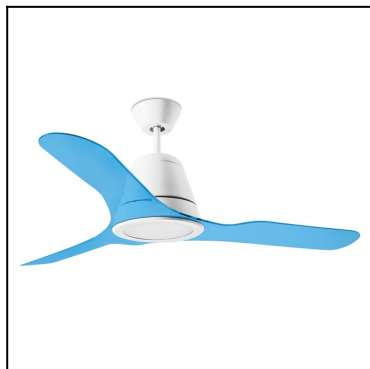

Structure material:
Structure finish:

Acrylic
Cyan

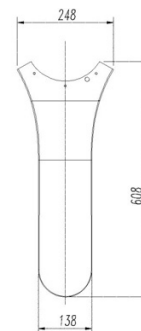

71-4867-24-24



Structure material:
Structure finish:

Acrylic
Yellow green

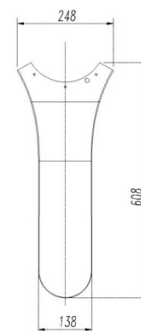

71-4867-CV-CV



Structure material:
Structure finish:

Acrylic
Multicolor

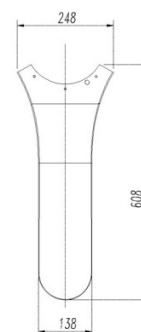

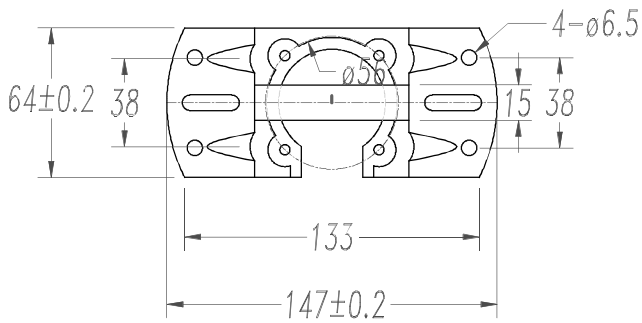
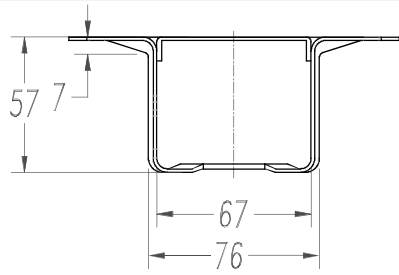

(2:1)

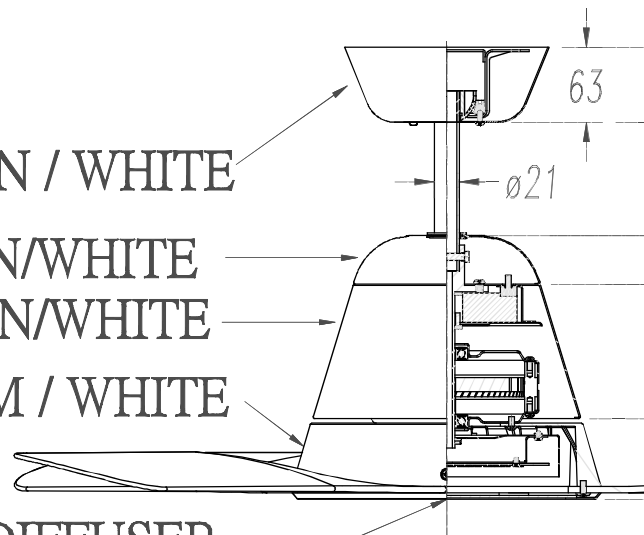

IRON / WHITE

IRON/WHITE

IRON/WHITE

ALUMINIUM / WHITE

FROSTED ACRYLIC DIFFUSER

ACRYLIC TRANSPARENT BLADE

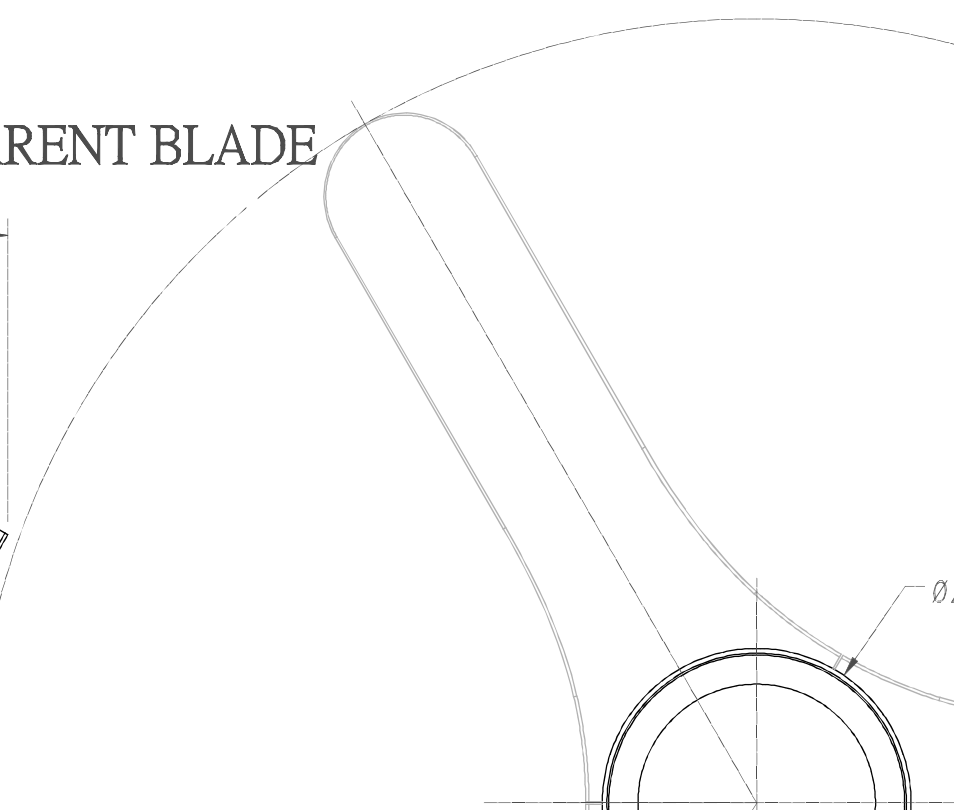
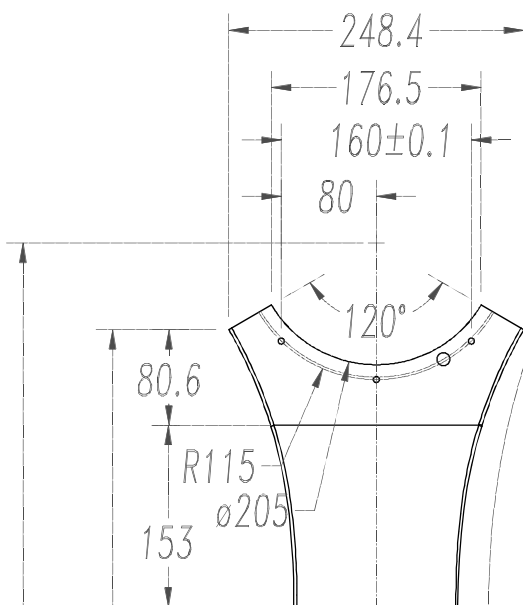



LED S-C4

30-3249-CF-M1

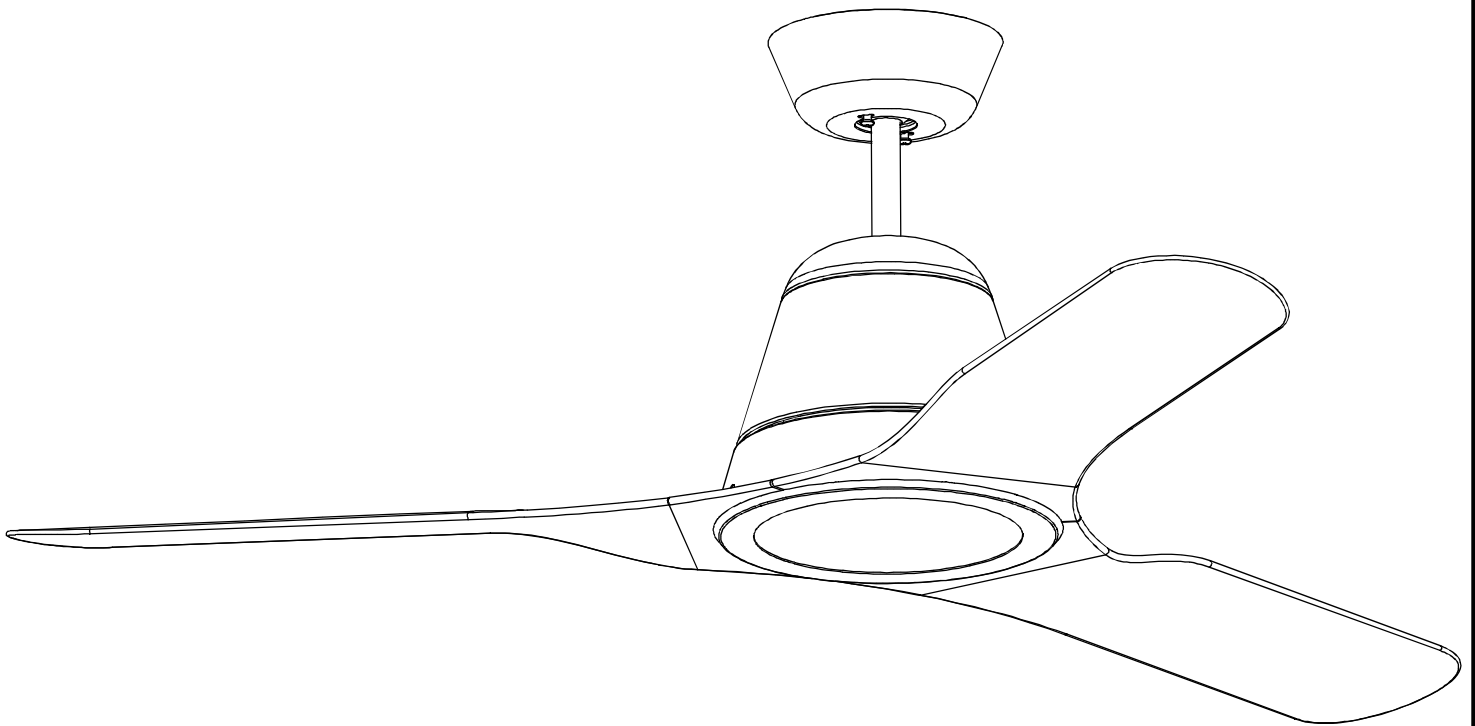



1

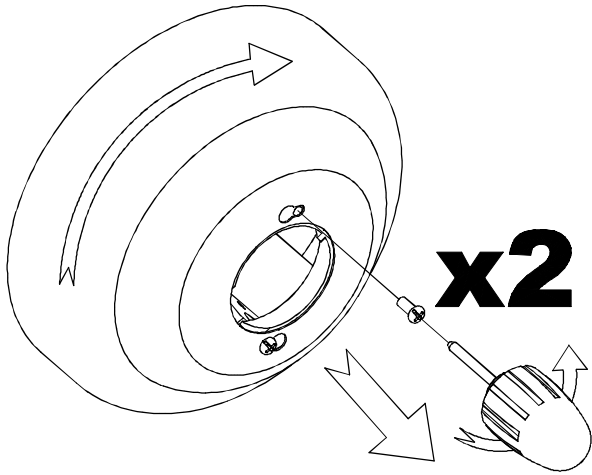

2

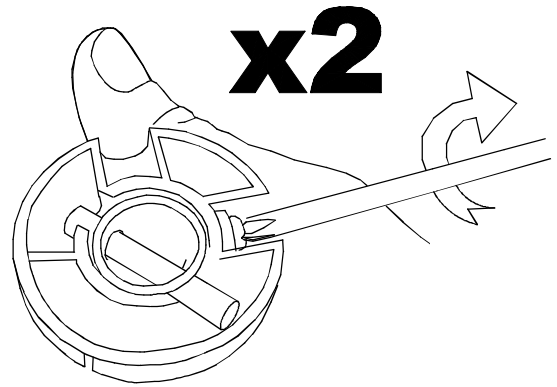

3

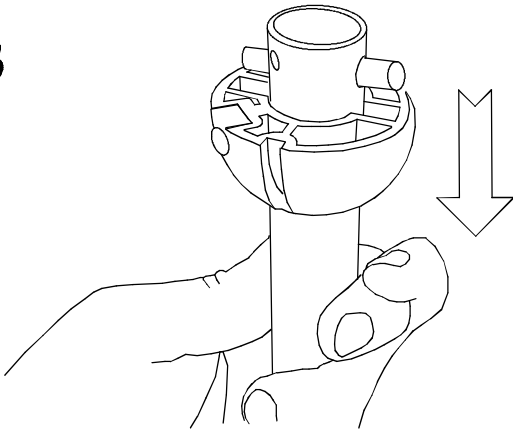

4

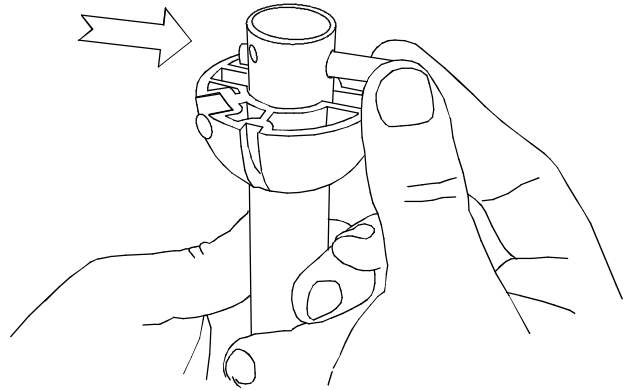

5

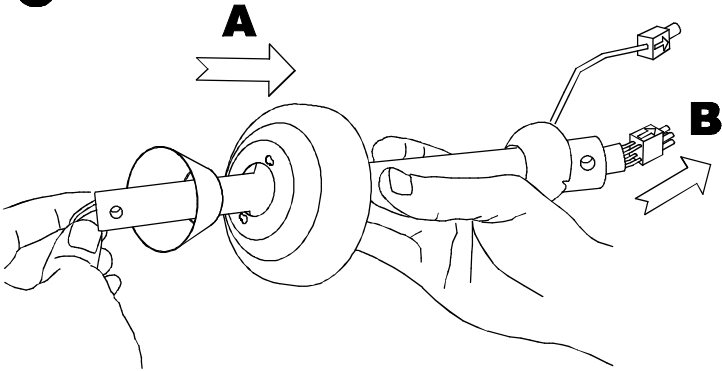

6

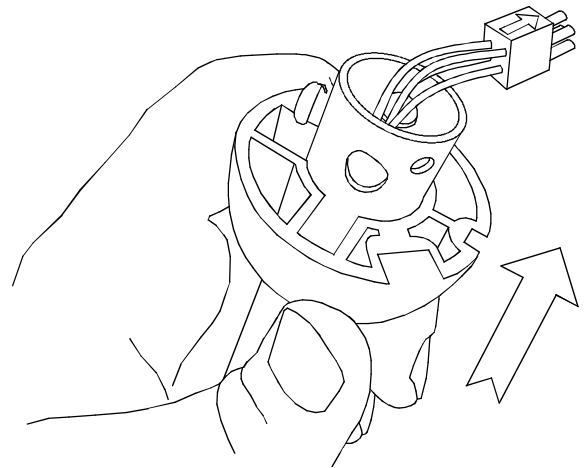

7

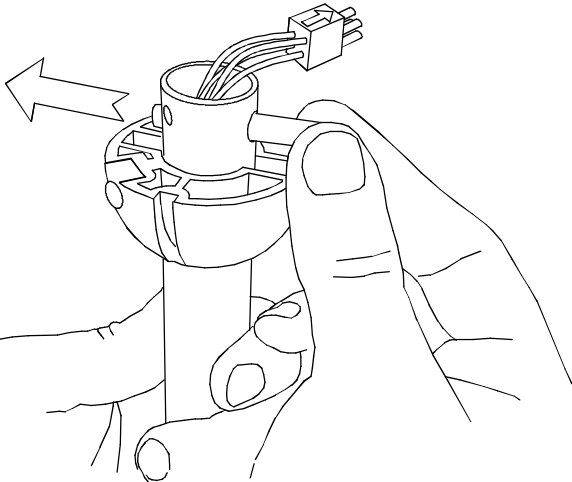

8

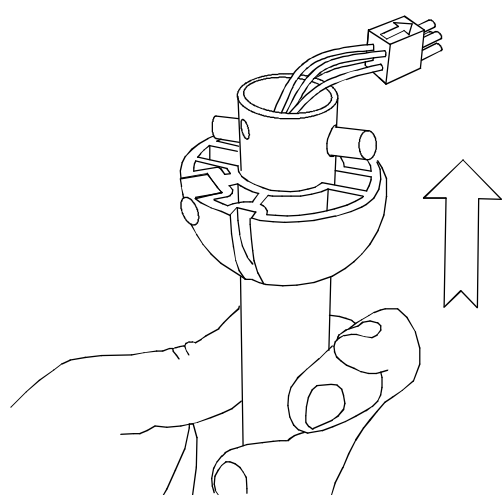



9

x2

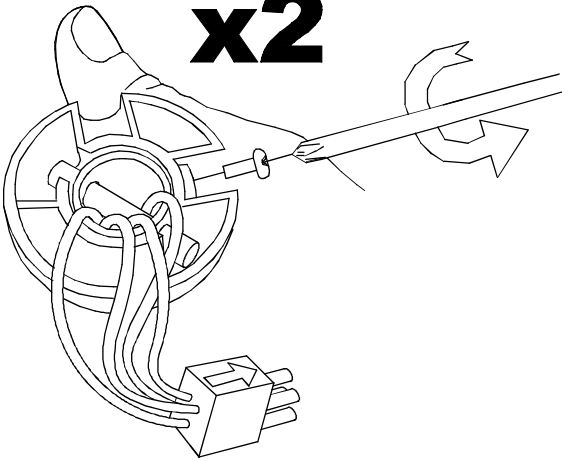

10

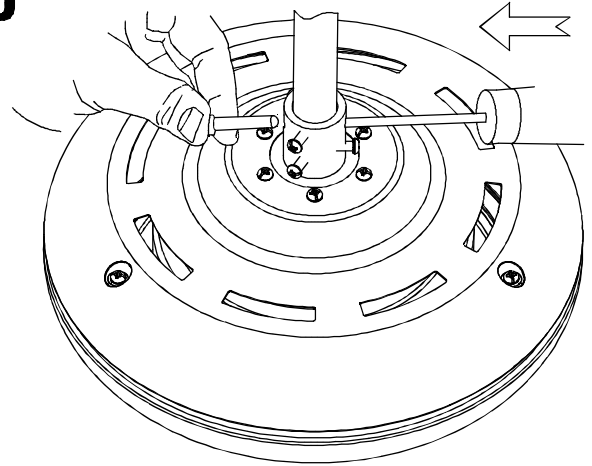

11

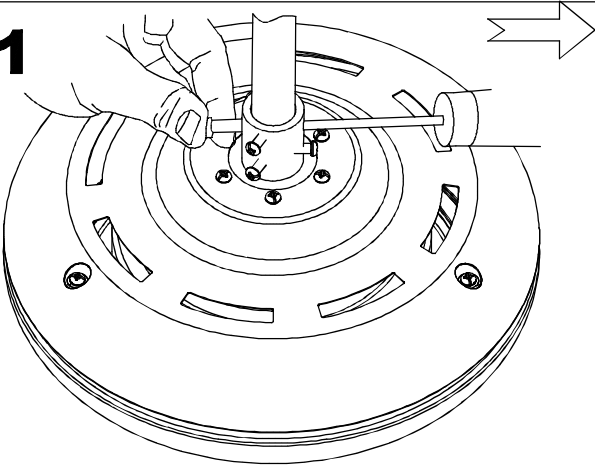

12

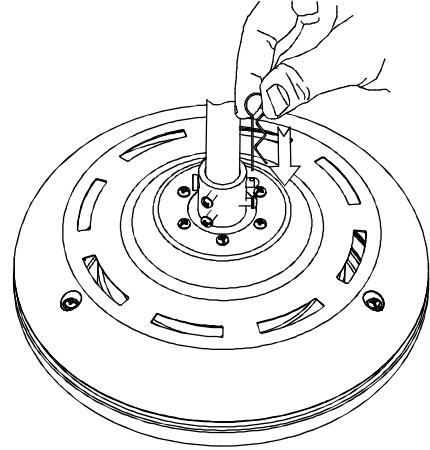

13

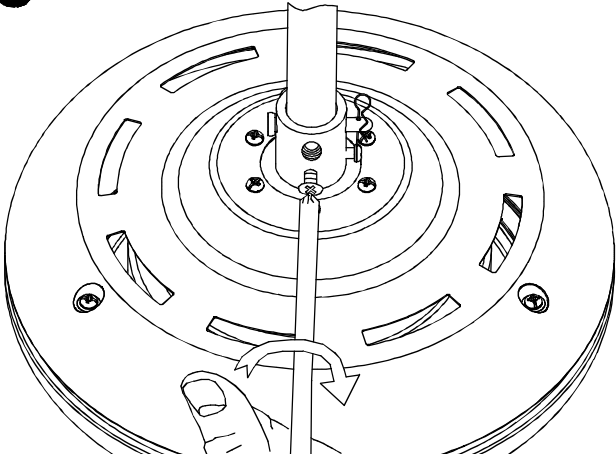

14

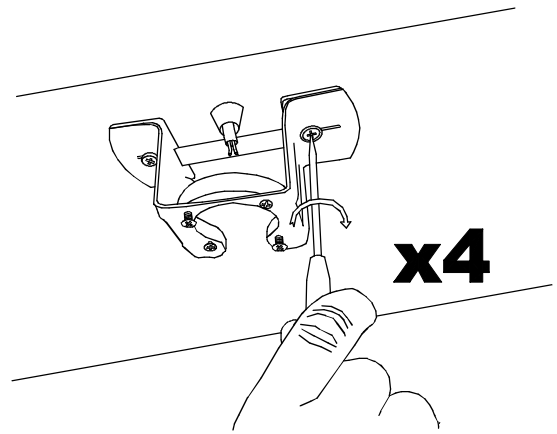

15

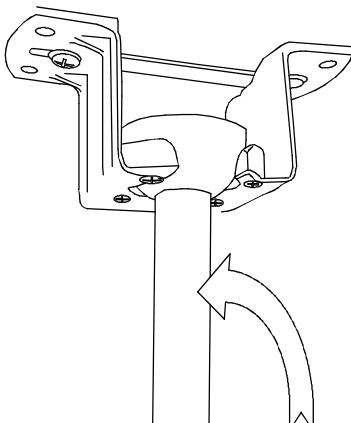

16

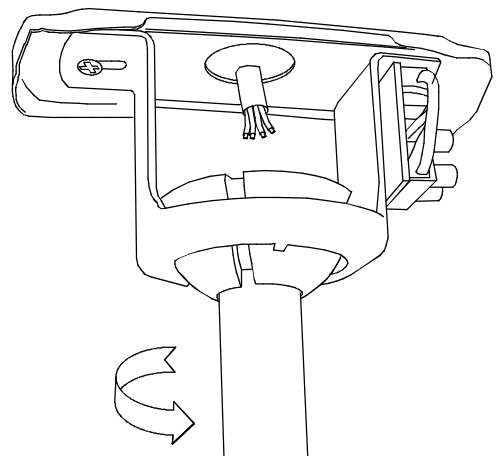

17

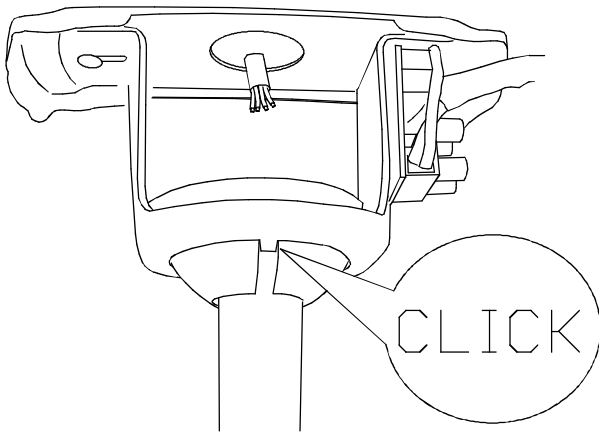

18

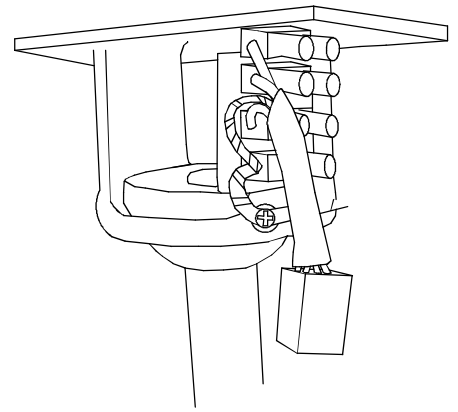

19

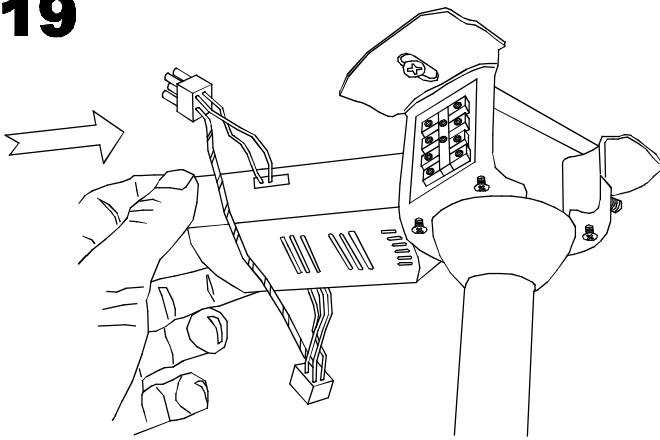

20

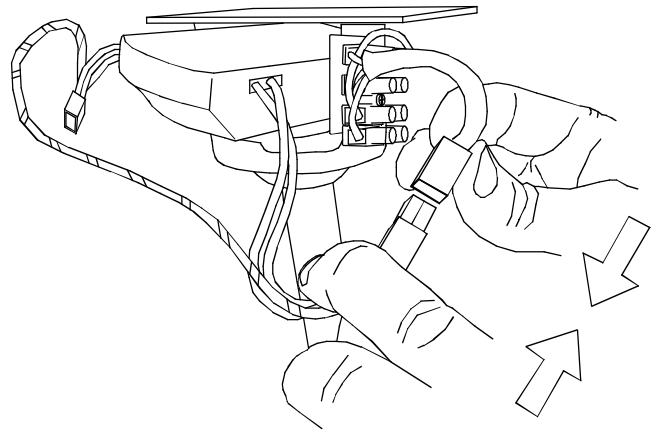

21

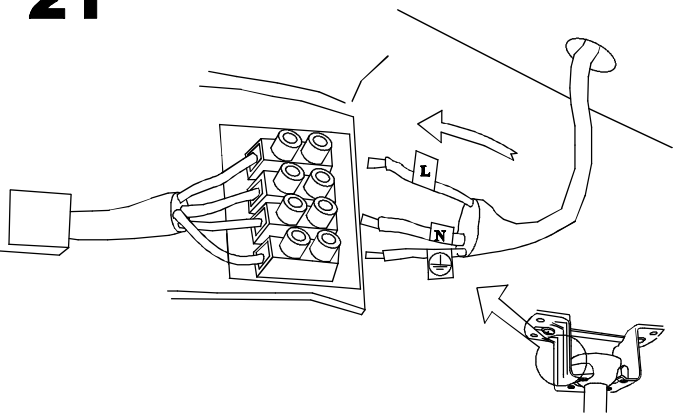

22

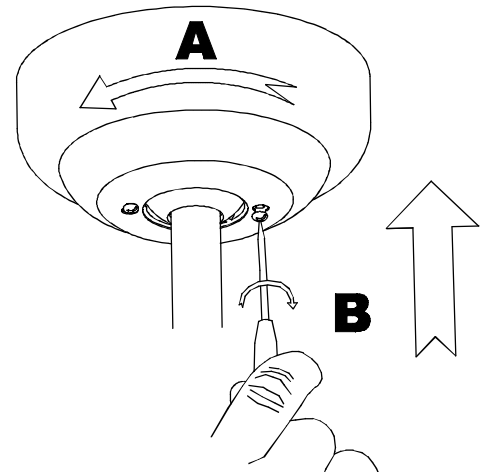

23

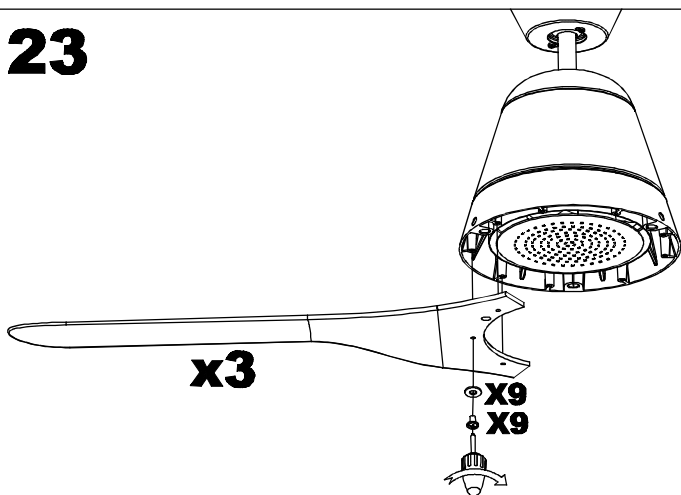

24

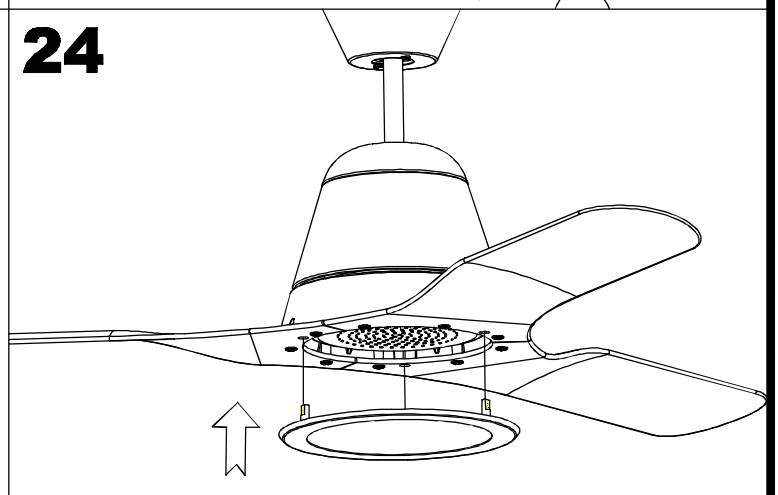



LEDS-C4

25

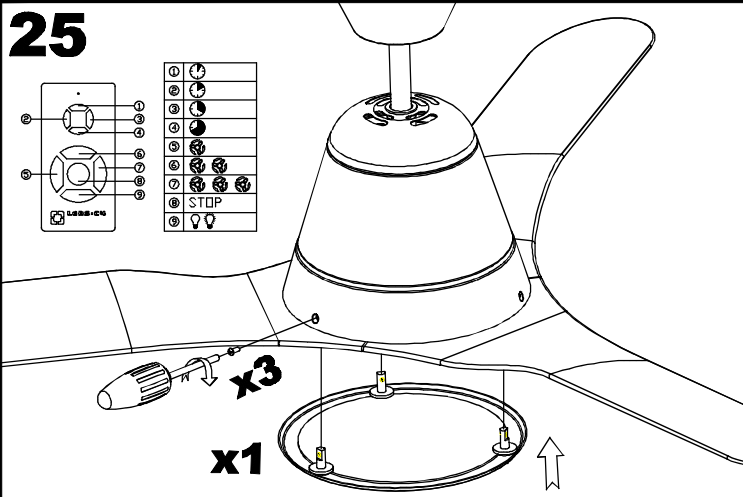

26

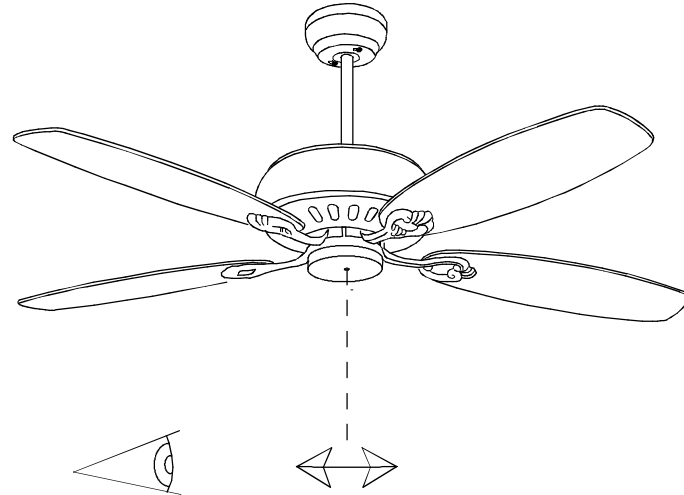
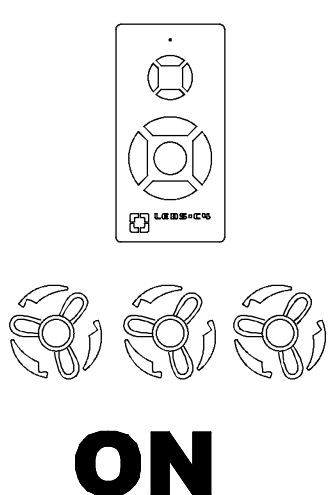
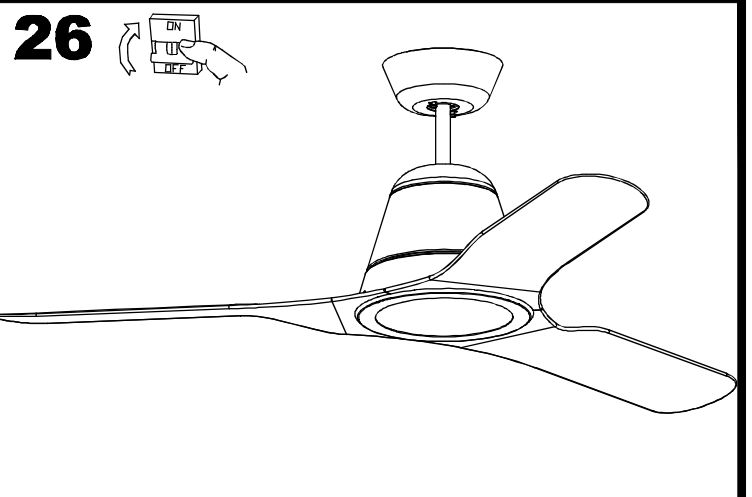

= OK

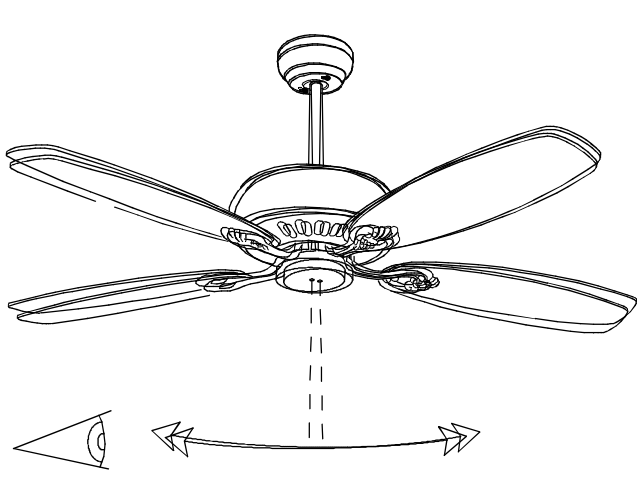
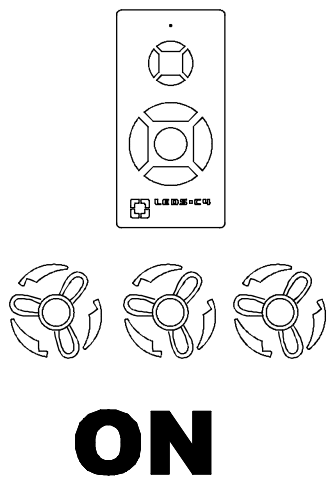

= NO

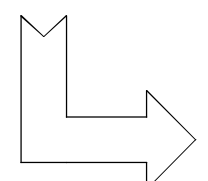

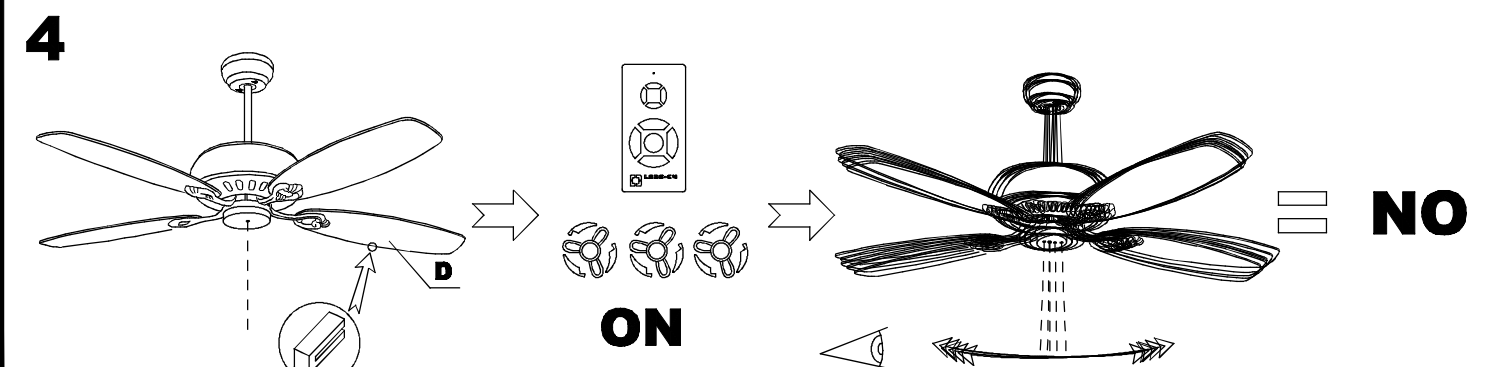
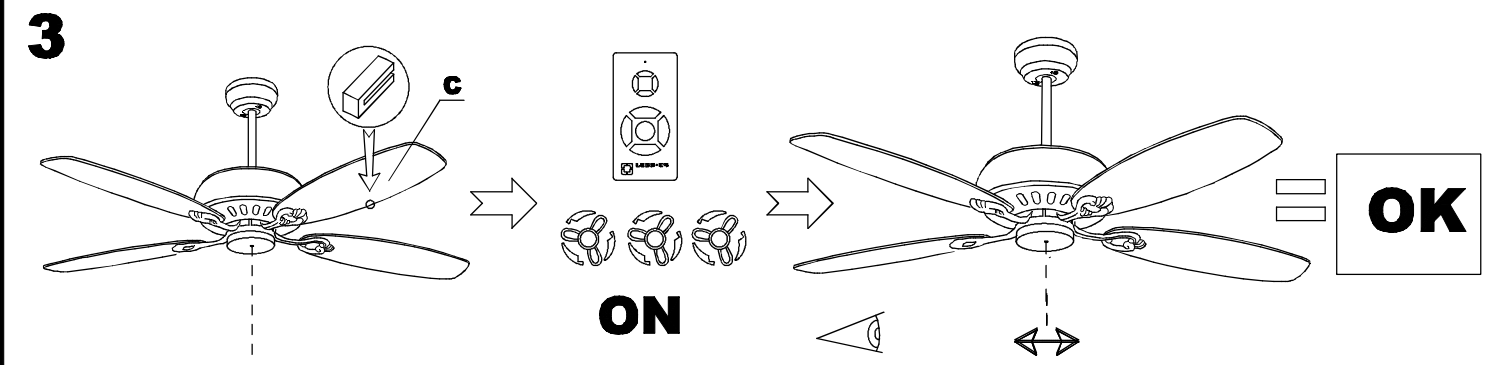
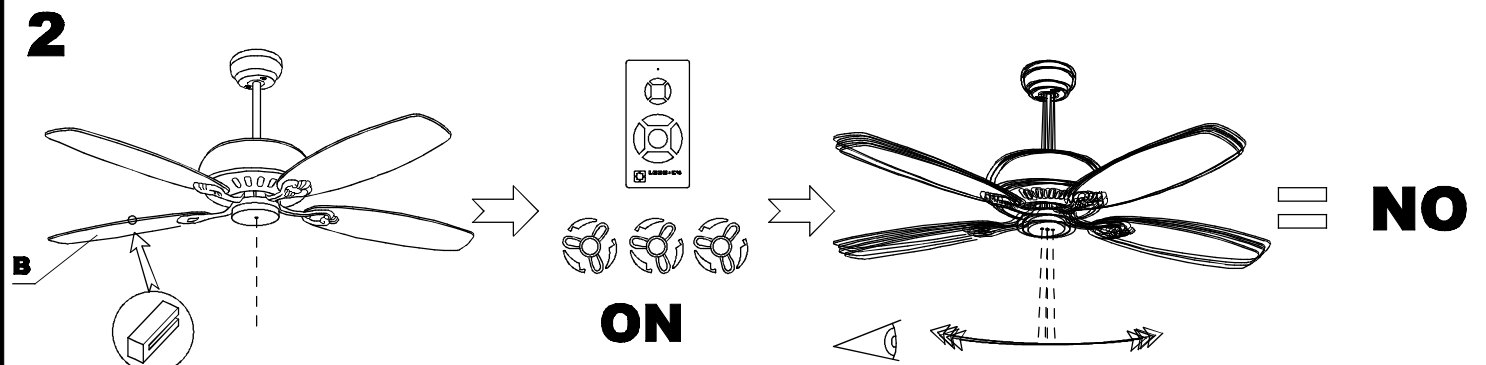
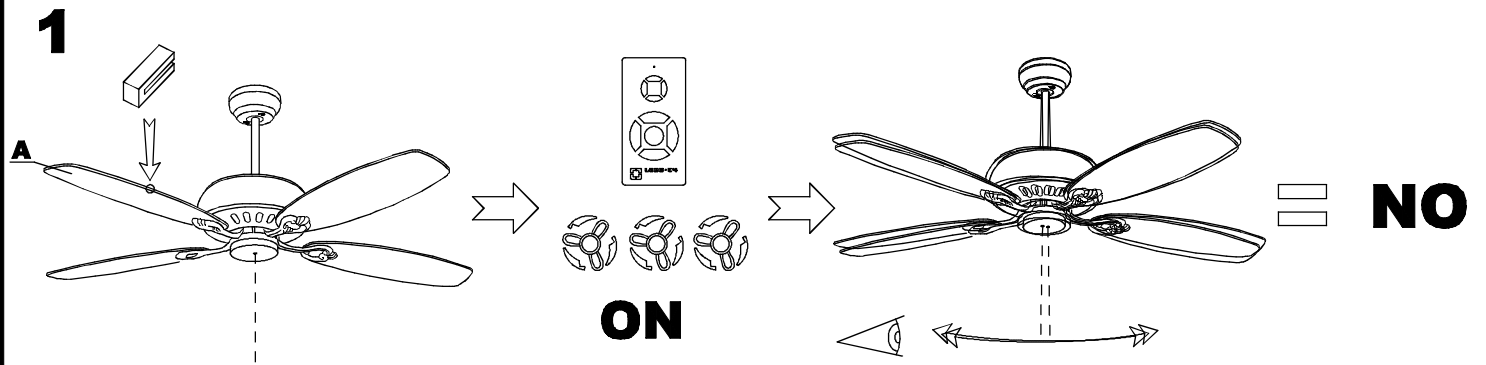
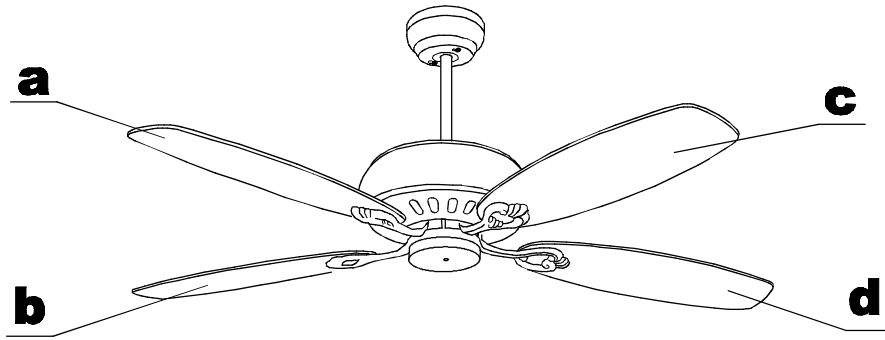

5

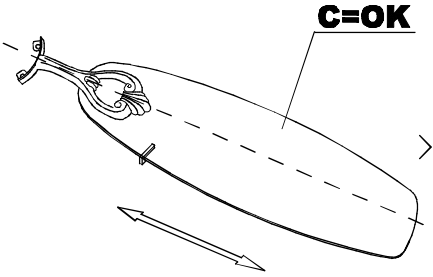

ON

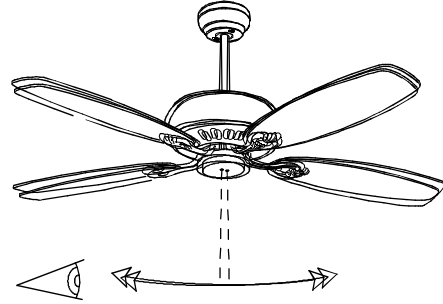

= NO

6

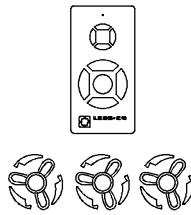
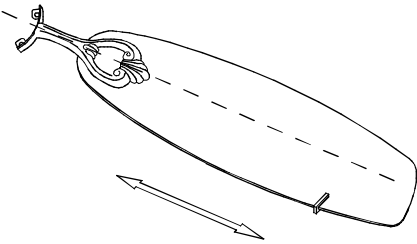

ON

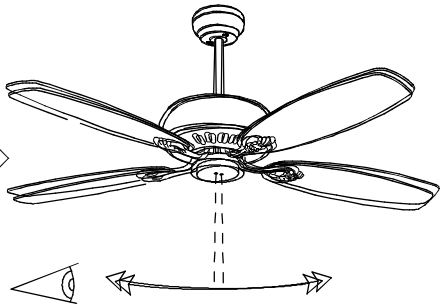

= NO

7

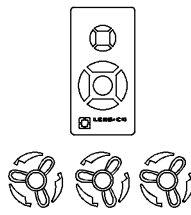
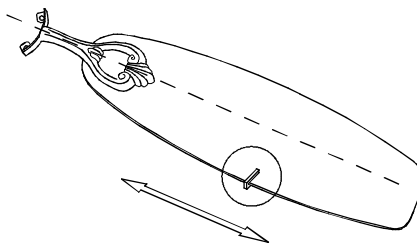

ON

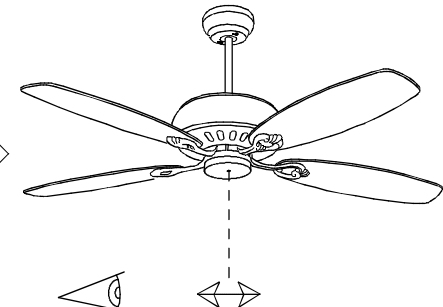

= OK

8

OK

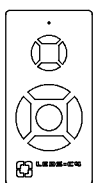
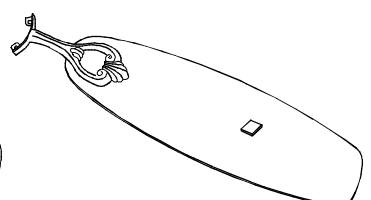
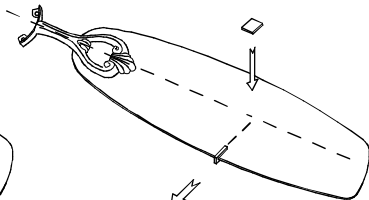
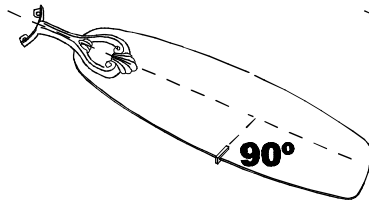
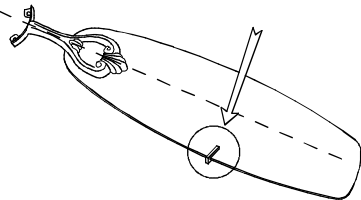

ON

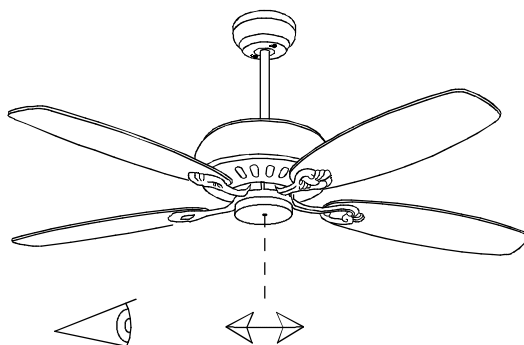

= OK