

INSTALLATION INSTRUCTIONS
FOR P4078

WARNING! SHUT POWER OFF AT FUSE OR CIRCUIT BREAKER.

RAIL SYSTEM

Installing your Rail System

READ THESE INSTALLATION INSTRUCTIONS BEFORE YOU BEGIN INSTALLING THIS NEW RAIL SYSTEM.

THIS PRODUCT MUST BE INSTALLED BY A PERSON FAMILIAR WITH TH CONSTRUCTION AND OARATION OF THE PRODUCT AND THE HAZARDS INVOLVED,IN ACCORDANCE WITH THE APPLICABLE INSTALLATION CODE

1. Use maximum 35 Watt/12v MR 16 bulbs on this system.
2. Make sure all connections are tight and secure.
3. Do not install any components of this system to any metal surface.
4. For use with models P4078 rail systems only.
5. This system may be dimmed with a low voltage magnetic dimmer.
6. The connectors can not come in contact with the power feed, standoffs or fixtures during installation or operation the system.

Tools needed for Installation:

Phillips Screwdriver; Flat Head Screwdriver, Hammer
Wire Cutters and (M3 and M4 Allen Wrench provided).

Track System: Use only with the electrical fittings identified for use with the P4078-084&P4078-467 Rail systems.

| Table of Contents | Page |
|--------------------------------------|-------------|
| A.Package Contents | 1 |
| B.Important Safety Instructions | 2 |
| C.Install the Transformer | 3 |
| D.Prepare the Rail | 4 |
| E.Install the Mounting Hardware | 4/5 |
| F.Secure the rail to the Bottom plat | 6 |
| G.Install the Fixtures | 7 |
| H.Check for Loose Connections | 8 |

This track system is to be supplied by a single branch circuit of 120 volts, single phase. Not intended for use with a powersupply cord or convenience receptacle adapter.

This track is only to be used with other electrical fittings identified for use with the track system.

A.Take Inventory

CAUTION: Before you begin installing your new rail system; **disconnect the power** by removing the fuses or turning off the circuit breakers.

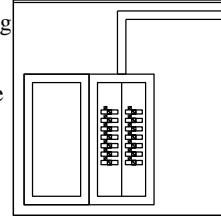

A. Package Contents

Model no:P4078-084&P4078-467

| Description | Qty |
|--|------------|
| a. 300w Transformer w/Canopy | 1 |
| b. 37-3/4" track rail with connector | 7 |
| c. Standoffs included Threaded Washer. | 8 |
| d. Fixture Assemblies w/o Glass Shades | 8 |
| e. Glass shade | 8 |

A. Hardware Bag;

| | |
|------------------------------------|---|
| A1. Drywall Anchors | 2 |
| A2. Drywall Anchor Screws | 2 |
| A3. Wire Nuts | 3 |
| A4. Crossbar with Allthread Nipple | 1 |
| A5. Crossbar Screws | 2 |
| A6. Hex Nut | 1 |

B. Hardware Bag;

| | |
|---------------------------|---|
| B1. Drywall Anchors | 8 |
| B2. Drywall Anchor Screws | 8 |
| B3. M4 Allen Wrench | 1 |
| B4. M3 Allen Wrench | 1 |
| B5. M3 Allen | 2 |
| B6. M4 Allen | 2 |

PS-853-08D1

P4078-084&P4078-467

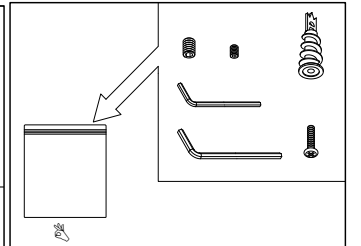
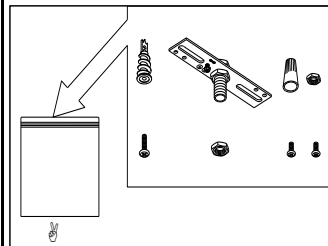
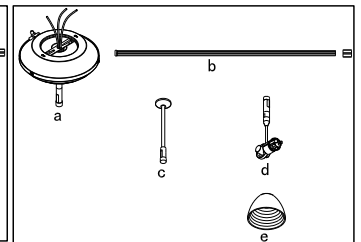
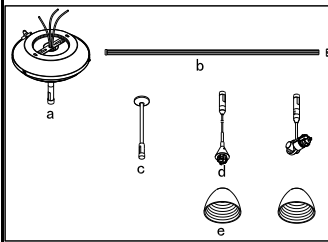

LA-1231E