



DEC019 Francesca 55" Double Sink Vanity Set (Faucets Not Included)



Design Element™
Bath Furniture



The Designer's Pick Collection

The rich black wood cabinet of the 55" Francesca double-sink vanity adds a beautiful contemporary touch to any bathroom. Two ceramic sinks nest atop a composite stone countertop, stylishly accenting the solid black lacquer cabinet, which is constructed of a birch frame and hardwood paneling that will withstand years of use. This design features four pullout drawers and includes a matching mirror with shelf.

Francesca 55" Double Sink Vanity Set

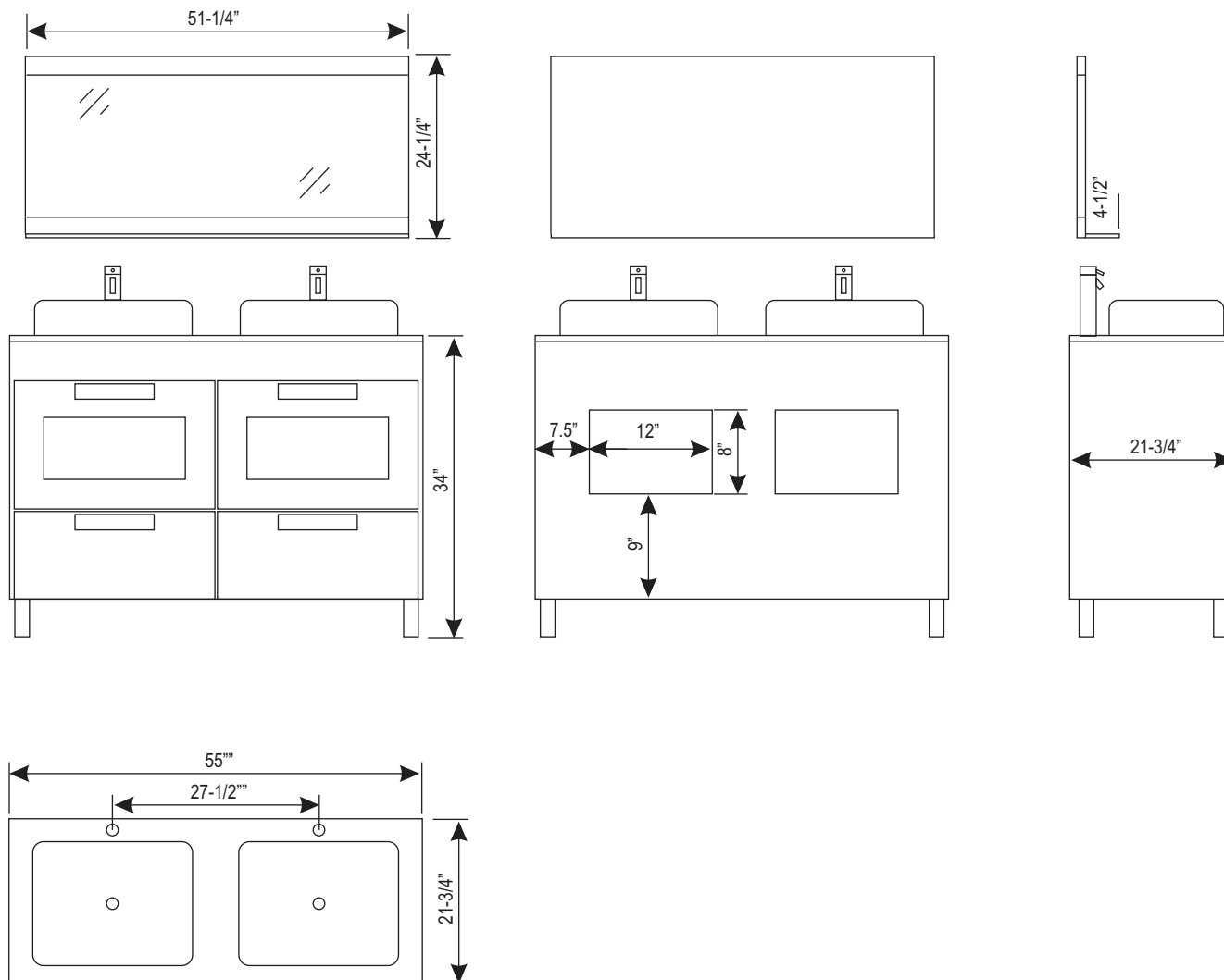

DEC019 Product Features

- Black Wood Cabinet
- Composite White Stone Countertop
- Matching Mirror with Shelf
- Designer Ceramic Vessel Sinks
- Chrome Pop-Up Drains
- Dimensions: 55-1/4"W x 21-3/4"D x 35-1/4"H

Includes: Cabinet, Countertop, Sinks, and Mirror



Design Element
Bath Furniture

8715 Boston Place
Rancho Cucamonga, CA 91730

www.DesignElementUSA.com