



**M-D Building
Products**

**4041 N Santa Fe
Oklahoma City, OK 73118
800.654.8454
www.mdteam.com**

09902011



**M-D Building
Products**

WEATHERIZATION PRODUCTS • FLOOR TRIMS & ACCESSORIES • TOOLS

PRODUCT CATALOG

Effective January 1, 2011



THE M-D STORY

M-D Building Products is a diverse manufacturing company that has been part of the Oklahoma City landscape since 1920. Founded as the Macklanburg-Duncan Company, M-D has a rich history of product innovation, development and quality manufacturing expertise. This legacy of products used by contractors, professionals and homeowners alike continue to protect, enhance and beautify homes across America and around the world.

Today, M-D Building Products is a leading domestic manufacturer of a wide variety of home energy related and remodeling products including Weatherstrip, Thresholds, Floor Trims and Tools. Our products are available at local home improvement retailers across the United States, Canada and Mexico.

At M-D Building Products, we have a knack for success. We take pride in our ability to draw strength from your inspiration, to provide a healthy dose of innovation with 90 years of ingenuity, and to ultimately generate creative solutions for your manufacturing needs.

M-D Building Products...American made since 1920.



CONTENTS

TERMS & CONDITIONS 2

GREEN STATEMENT 2

NEW PRODUCTS 3

WEATHERSTRIP, THRESHOLDS & DOOR ACCESSORIES

RESIDENTIAL

Rolled Packaged Door & Window Weatherstrip 10

Window Specialty Weatherstrip 12

Garage Door Weatherstrip 13

Air Conditioner Weatherstrip and Covers 15

Specialty Application Weatherstrip 16

Pipe Insulation 17

Door Sweeps 18

Door Bottoms & Drip Caps 20

Rigid Door Jamb Weatherstrip Kits 22

Bronze Spring Sealing Door Weatherstrip Kits 24

Adjustable Height Thresholds 24

Aluminum Thresholds w/Vinyl Seal 24

Hardwood Thresholds 26

Saddle Thresholds 27

Bumper Thresholds for Outswing Doors 27

Sill Nosings 28

Vinyl Replacement Inserts For Thresholds 28

Weatherstrip & Thresholds – Commercial 30

ULTRA COMMERCIAL DOOR COMPONENTS

Code Acceptability 30

ULTRA Commercial Thresholds 31

Rolled Packaged Door & Window Weatherstrip 32

ULTRA Commercial Door Bottoms & Sweeps 33

ULTRA Commercial Weatherstrip/Astragals/Smoke Seals 33

ULTRA RESIDENTIAL DOOR COMPONENTS

ULTRA Residential Prehung/Millwork

 Sills 33

 Door Bottoms & Sweeps 34

ULTRA Residential Thresholds 36

ULTRA Residential – Weatherstrip/Astragals 38

DOOR ACCESSORIES

Screen Door Grilles 40

Mail Slots 40

SMARTTOOL™

Levels and Modules 42

Digital Levels (Domestic) Inches per Foot 42

Digital Levels (International) Millimeters per Meter 42

ADA Digital Slope Walker™ 42

SMARTLASER™ 42

Carrying Cases 42

FLOORING INSTALLATION TOOLS

Tile Installation Tools 44

Carpet Installation Tools 52

FLOORING PRODUCTS

Aluminum Floor & Carpet Trim 56

Hardwood Floor Trim 62

Ceramic Tile Edging 64

Floor & Carpet Accessories 66

Vinyl Wall Base 68

Vinyl Flooring Accessories 69

Stick 'n Step 70

DECORATIVE MOULDINGS

Decorative Aluminum Mouldings 72

ALUMINUM SHAPES & METAL SHEETS

Aluminum Shapes 76

Metal Sheets 82

ASSORTMENTS

WEATHERSTRIP, THRESHOLDS & DOOR ACCESSORIES

Weatherstrip Assortments 86

Threshold, Door Bottoms, Sweeps and Door Jamb Assortments .. 86

Ultra Residential Door Weatherstrip Assortments 87

Door Grille Assortment 87

FLOORING INSTALLATION TOOLS

Tile Installation Tool Assortments 88

FLOORING PRODUCTS

Aluminum Carpet Trim Assortments 89

Hardwood Floor Trim Assortment 89

Ceramic Tile Edging Assortment 90

Wall Base Assortments 90

Stick 'n Step Assortments 90

ALUMINUM SHAPES & METAL SHEETS

Aluminum Shapes Assortments 91

Metal Sheets Assortments 91

INDEX 92

TERMS & CONDITIONS

M-D Building Products, Inc. is a national supplier of building material products. We sell to the retail and wholesale building material market for the following types of customers:

- Lumber Yards
- Building Supply Centers
- Building Material Suppliers
- Building Material Wholesalers
- Home Centers
- Hardware Stores

We do not sell directly to contractors or consumers and do not accept COD's.

ORDERING

All orders are subject to acceptance by M-D Building Products, Inc. in Oklahoma City, Oklahoma. Prices and terms of sale are subject to change without notice. M-D reserves the right to discontinue any product without notice.

All M-D products will be invoiced at M-D's current price. At anytime M-D reserves the right to change prices, make changes regarding product design, materials, specifications, and to discontinue any product or products without notice.

Minimum order \$250; any order less than \$250 will not be accepted.

PHONE

Local: 405-528-4411

Within the US call Toll Free:

800-654-8454 (Customer Service)

800-654-0003 (Credit Dept)

800-654-0007 (Automated Switchboard)

e-mail: orderentry@mdteam.com

FAX

Local: 405-557-3568

Within the US call Toll Free:

800-557-3568

LIMITED WARRANTY

All M-D products are warranted to be free from defects in material and workmanship if installed and used in strict accordance with our installation instructions. Our liability is limited to our sale price of any products proven to be defective or, at our option, to the replacement of such products upon their return to us.

TRANSPORTATION

Orders are shipped prepaid and M-D reserves the right to ship all merchandise in the most efficient manner. In the event a customer requests specific routing or expedited special handling, M-D will charge in accordance with current transportation rates.

DELIVERY

Back Orders: M-D Building Products reserves the right to cancel back orders.

Returned Goods: Written authorization from M-D Customer Service is required prior to returning goods. Only unopened cartons, not priced for resale, are eligible for authorization.

Authorized returns must be shipped freight prepaid to the location designated by M-D. Credit will be issued from original invoice price, less a 20% restocking charge. Merchandise which is obsolete, discontinued and/or older than one year is not eligible for return.

Claims: Claims resulting from loss, shortages or damage-in-transit must be acknowledged on the delivery receipt. Concealed damages must be filed with M-D Building Products within 15 days of delivery. The recipient's signing the delivery receipts transfers ownership of product from M-D Building Products to you, the customer. Make written notes on delivery receipt to help protect yourself from liability for loss, damage, etc. Please report any shipping problems as soon as possible to M-D at 1-800-654-8454.

REMITTANCE

The buyer is responsible for any taxes, fees, excises, duties or other charges resulting from the buyer's purchase of M-D Products.

Payment Terms: M-D Building Products' terms are 1% 30, net 45. Remittance by mail should be sent to: M-D Building Products, Inc., P.O. Box 269075, Oklahoma City, OK 73126. We also accept MasterCard and Visa.

Credit Limits: All orders are subject to credit approval at time of placement.

INTERNATIONAL TERMS

Export order minimum is \$750 USD Ex-Works Oklahoma City, OK. Customer is responsible for all charges from Oklahoma City, OK to destination. \$1000 minimum order for prepaid freight – FOB any continental US port or US border. All products are quoted in US dollars. Export orders require payment in advance via bank draft or wire transfer. Customer will provide M-D Building Products, Inc. with the information pertaining to freight forwarder/customs broker and required shipping instructions.

The freight forwarder/customs broker will be expected to refuse any shipment that arrives at the FOB point in an unsatisfactory condition. The freight forwarder/customs broker will provide the freight carrier written documentation of condition of shipment at the time that it arrives if it is refused. Acceptance of a shipment by the freight forwarder/customs broker cancels any and all claims against damage, or any irregularities that can be encountered by the ultimate consignee upon receipt of goods at final destination. The responsibility for an FOB export shipment transfers from M-D Building Products, Inc. to the consignee's designated agent at the FOB point within the continental US port or US border upon delivery and acceptance. The responsibility for an Ex-Works export shipment is assumed by the consignee and the designated carrier as soon as the goods are picked up at M-D Building Products, Inc. dock in Oklahoma City, OK.

GREEN STATEMENT

M-D Building Products makes efforts to operate our business in an environmentally and socially responsible manner. We recognize that reducing the environmental impact of our products and operations is an important part of the value we deliver to our customers. We strive to achieve environmental excellence and work with our employees, customers, partners and suppliers to meet these environmental commitments.

M-D Building Products is committed to providing quality products that help the American Homeowner save money by saving energy. At the same time, M-D Building Products has embarked on an on-going effort to reduce the amount of energy we consume in our manufacturing processes, reduce our corporate waste-stream to nearly zero and use as much recycled material as is available for our products and packaging. Finally, for 90 years M-D Building Products has maintained American manufacturing operations resulting in the lowest transportation carbon footprint of any company in our category.

NEW PRODUCTS





Weatherizing for Dummies™ (#50060)

Weatherizing for Dummies is a smart and easy way for consumers to make their home more comfortable and save hundreds of dollars a year on utility bills. Kit includes products and instructions to easily seal common areas of energy loss plus up to \$100 in rebates on other energy saving products.

Garage Door Threshold Kit (#50100, #50101)

Designed to help keep your garage clean and more comfortable by forming a weathertight seal under your garage door. It helps prevent drafts, dust, moisture, debris and insects from entering under the door. Produced from high quality, durable vinyl. It will provide years of service on residential garage floor applications. Included with the kit is a premium quality silicone adhesive to insure a strong bond to both concrete and the vinyl and will bridge any imperfections in the garage floor.



Garage Door Insulation Kit (#43157)

M-D's Garage Door Insulation kit uses a radiant foil insulation to help make your garage more comfortable and reduce energy costs in your home.

Helps keep your garage warmer in the winter by preventing warm air from escaping through your garage door to help keep your garage and home warmer.

Helps keep your garage cooler in the summer by blocking up to 97% of the sun's radiant energy to help keep your garage and home cooler.



Expand 'N Seal Waterproof Foam Weatherseal (#03100)

Expands to seal seams and joints. When fully compressed Expand 'N Seal provides a waterproof seal. Use to seal out drafts, moisture, dust and pests. Seals a variety of areas including air conditioner units, around foundations, siding, gutters and flashings.



MetalDecor™ Finish Door Sealing Products

M-D's exclusive MetalDecor™ finish provides the durability of aluminum with the beauty of finished hardwood. We are now offering two of our best selling items – M-D's Deluxe Aluminum & Vinyl Threshold and M-D's Deluxe Door Sweep with the MetalDecor™ Oak finish. M-D's exclusive MetalDecor™ process, allow these door weatherization products to complement existing hardwood doors or flooring.



Shrink n' Seal® Window Film Bulk Roll with Tape (#43100, #43101)

Our new bulk rolls of film are an easy and economical way to seal multiple windows in a home. Reduced packaging and longer rolls of film saves money and reduces waste. Available in 64 in x 25 ft rolls or 84 in x 25 ft. Each roll includes enough film and two sided tape to seal multiple windows.

NEW SmartTool™ Products and New Features:

New International Version – Provides rise over run measurement in mm/M.

Angle Copy Mode – Allows end user to set the beeper to sound at any angle (not just at level & plumb).

Alternate Zero Mode – Allows end user to reset the reference angle “0” to any angle.

Directional Beep – Audible tone and rate increases as target angle approaches, guiding user when display cannot be seen.

Go to smarttoollevels.com for additional information



1 HP Fusion Wet Saw (#48191)

Our 1 HP Fusion Wet Saw, with a 3600 RPM direct drive motor, cuts through the toughest stone, porcelain, ceramic, marble, and granite tiles. Includes a patented rigid steel frame to protect all of the wet saw’s vital components. It features adjustable rip guide that mounts securely to the heavy-duty cast aluminum cutting table, tilting table for miter cuts, drain plug for easy water change, and slip resistant feet.

7" Wet Saw Replacement Blade (#48088)

7" continuous rim diamond replacement blade fits both ¾ HP and 1 HP M-D Fusion Wet Saws, 5/8" Arbor.

Ceramic Floor Tile Installation Bucket Kit (#49834)

The new Ceramic Floor Tile Installation Bucket Kit is perfect for the DIY'er. It's complete with all the essential professional grade items needed to install ceramic floor tile.

Installation Bucket Kit includes a tile installation trowel, tile nippers, grout float, sponge, gloves, tile spacers and sturdy reusable 2.5 gallon plastic bucket. The bucket serves as a mixing bucket for grouts and mortars and allows you to store your tools together when the job is complete.



14" & 20" Tile Cutters (#49194, #49195)

New 14" and 20" manual tile cutters for cutting floor and wall tiles. Both are equipped with dual chrome plated steel rails and a high leverage handle to make clean, efficient cuts. Body of the cutters are padded with durable rubber to prevent tile from slipping. Replaceable tungsten carbide cutting wheel.

MetalDecor™ Stair Edging

Our popular oak and cherry MetalDecor™ finishes have been added to our standard Stair Edging floor trims! Durable aluminum with the beauty of finished hardwood. Available in 36" and 72" lengths.





Carpet Seaming Tapes (#31142, #31143, #31144)

New line of three professional hot melt carpet seaming tapes: Standard M-D 20, Premium M-D 40, & Ultra M-D 50. Quick melting adhesives for easy attachment to popular carpet backings in the marketplace.

1" Extra-Wide Tack Strip (#75312, #75314)

Intended for all-purpose residential and commercial use, our new tack strip is now 1" wide in both wood nail and concrete nail styles.

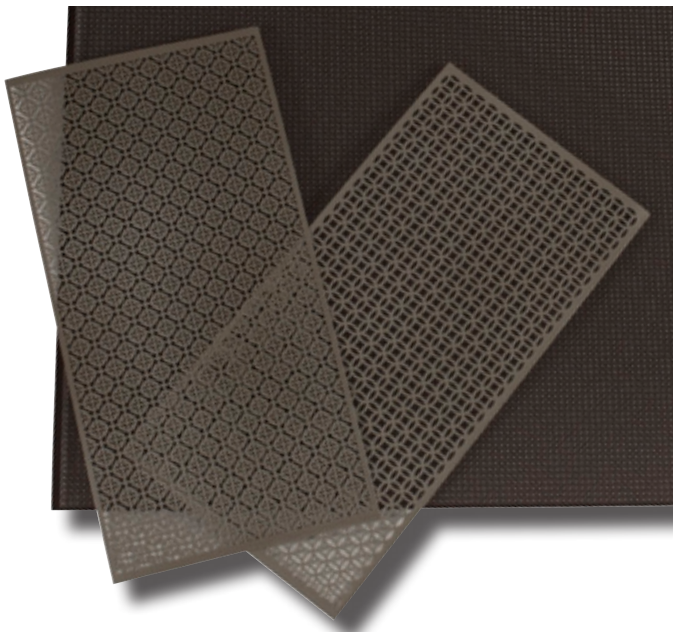

Aluminum Sheets – New Elliptical & Mosaic Patterns in Satin Nickel Finish (#57010, #57005) and New Venetian Bronze Finish (#57015)

Updated perforated sheets patterns Elliptical & Mosaic (in Satin Nickel finish) now available in 1ft x 2ft sheets and new Venetian Bronze finish (Lincane 3ft x 3ft).

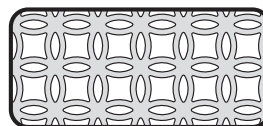

ELLIPTICAL

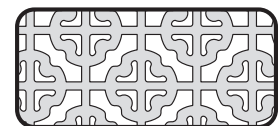

MOSAIC

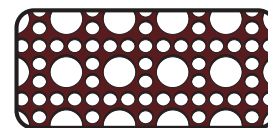

LINCANE – VENETIAN BRONZE

WEATHERSTRIP THRESHOLDS DOOR ACCESSORIES



M-D#

DESCRIPTION

COLOR

PACK QTY

ROLLED PACKAGED DOOR & WINDOW WEATHERSTRIP



Weatherizing for Dummies™

A smart and easy way to weatherize a home and reduce utility costs. Includes products and instructions to seal common areas of energy loss – plus up to \$100 in rebates for other energy saving products.

| | | | |
|-------|-------------------------------|--|---|
| 50060 | WEATHERIZING FOR DUMMIES™ KIT | | 4 |
|-------|-------------------------------|--|---|



All-Climate ThermalBlend® Weatherstrip

Durable Silicone/EPDM ThermalBlend® rubber stays flexible in extreme cold or hot temperatures. The unique “Wave” profile adjusts to fill a variety of gaps around doors and windows. **Lifetime Warranty**

WAVE PROFILE 3/8" thick x 3/8" wide

| | | | | |
|-------|-----|--|-------|----|
| 43846 | 17' | | WHITE | 12 |
| 43848 | 17' | | BROWN | 12 |

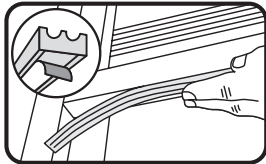

All-Climate EPDM Rubber Weatherstrip

High quality EPDM rubber seals out drafts, dust and moisture around doors and windows. Self-adhesive application. Remains flexible from -40°F to 140°F. Guaranteed to remain flexible for 10 years.

K PROFILE (for small gaps) 1/8" thick x 3/8" wide

| | | | | |
|-------|-----|----------|-------|----|
| 02592 | 17' | ADHESIVE | BROWN | 12 |
| 02618 | 17' | ADHESIVE | WHITE | 12 |

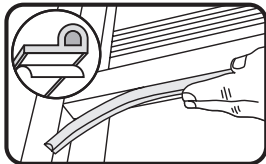

P PROFILE (for medium gaps) 7/32" thick x 3/8" wide

| | | | | |
|-------|-----|----------|-------|----|
| 02550 | 17' | ADHESIVE | BROWN | 12 |
| 02576 | 17' | ADHESIVE | WHITE | 12 |

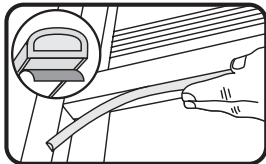

D PROFILE (for large gaps) 5/16" thick x 11/32" wide

| | | | | |
|-------|-----|----------|-------|----|
| 63602 | 17' | ADHESIVE | BROWN | 12 |
| 63628 | 17' | ADHESIVE | WHITE | 12 |

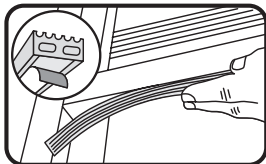

ALL PROFILE (for extra large gaps) 5/16" thick x 19/32" wide

| | | | | |
|-------|-----|----------|-------|----|
| 63644 | 10' | ADHESIVE | BROWN | 12 |
| 63669 | 10' | ADHESIVE | WHITE | 12 |

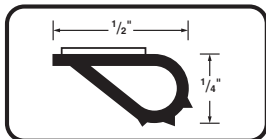

Commercial Grade – Silicone Door Seal

WS 108

Silicone gasketing. UL listed and tested to limit air and smoke infiltration. Not affected by mildew, fungus or UV light.



1/4" thick x 1/2" wide

| | | | | |
|-------|-----|--|-------|---|
| 68510 | 20' | | BROWN | 6 |
| 68668 | 20' | | BLACK | 6 |
| 68676 | 20' | | WHITE | 6 |

M-D# DESCRIPTION COLOR PACK QTY

ROLLED PACKAGED DOOR & WINDOW WEATHERSTRIP

Expand 'N Seal

Waterproof Expandable Foam Weatherseal. Expands to seal seams and joints. Waterproof seal when compressed.

1/4" thick x 1" wide x 13' long

03100 EXPANDS TO 1" THICKNESS

6

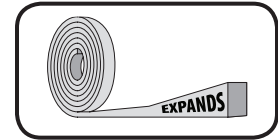

Premium Sponge Rubber Weatherstrip Tape

High density, self adhesive weatherproofing tape. Tough sponge rubber ensures long lasting seal.

| T x W x L | | | | |
|-----------|---------------------|----------|-------|----|
| 06577 | 1/4" X 1/2" X 10' | ADHESIVE | BLACK | 12 |
| 06593 | 1/4" X 3/4" X 10' | ADHESIVE | BLACK | 12 |
| 43155 | 1/4" X 1" X 10' | ADHESIVE | BLACK | 6 |
| 06619 | 3/8" X 1/2" X 10' | ADHESIVE | BLACK | 12 |
| 06635 | 3/8" X 3/4" X 10' | ADHESIVE | BLACK | 12 |
| 43154 | 3/8" X 1-1/4" X 10' | ADHESIVE | BLACK | 6 |

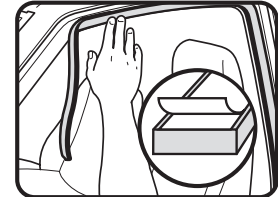

High Density Foam Tape – Closed-Cell

Closed-cell, PVC foam. A self-adhesive weatherproofing foam tape for eliminating air and moisture leaks.

| T x W x L | | | | |
|-----------|--------------------|----------|-------|----|
| 02238 | 1/8" X 1/4" X 17' | ADHESIVE | GRAY | 12 |
| 02253 | 3/16" X 3/8" X 17' | ADHESIVE | GRAY | 12 |
| 02279 | 1/4" X 1/2" X 17' | ADHESIVE | GRAY | 12 |
| 02295 | 3/8" X 1/2" X 10' | ADHESIVE | GRAY | 12 |
| 02311 | 1/2" X 3/4" X 10' | ADHESIVE | GRAY | 12 |
| 02790 | 3/16" X 3/8" X 17' | ADHESIVE | BROWN | 12 |
| 02816 | 1/4" X 1/2" X 17' | ADHESIVE | BROWN | 12 |
| 02733 | 3/16" X 3/8" X 17' | ADHESIVE | WHITE | 12 |
| 02758 | 1/4" X 1/2" X 17' | ADHESIVE | WHITE | 12 |

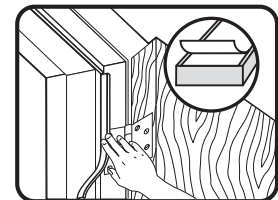
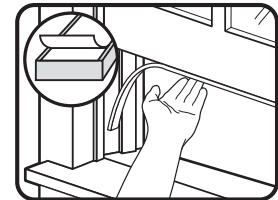

2 ROLL BONUS PACK

| | | | | |
|-------|--------------------|----------|-------|----|
| 02873 | 3/16" X 3/8" X 34' | ADHESIVE | BROWN | 12 |
| 02899 | 1/4" X 1/2" X 34' | ADHESIVE | BROWN | 12 |
| 02832 | 3/16" X 3/8" X 34' | ADHESIVE | WHITE | 12 |
| 02857 | 1/4" X 1/2" X 34' | ADHESIVE | WHITE | 12 |

Low Density Foam Tape – Open-Cell

A self-adhesive resilient open-cell foam tape that compresses flat to form a tight seal.

| T x W x L | | | | |
|-----------|--------------------|----------|------|----|
| 02055 | 3/16" X 3/8" X 17' | ADHESIVE | GRAY | 12 |
| 02071 | 1/4" X 1/2" X 17' | ADHESIVE | GRAY | 12 |
| 02097 | 3/8" X 1/2" X 17' | ADHESIVE | GRAY | 12 |
| 02113 | 1/2" X 3/4" X 17' | ADHESIVE | GRAY | 12 |

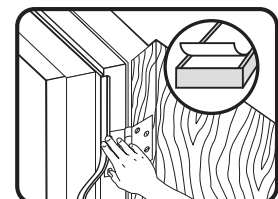
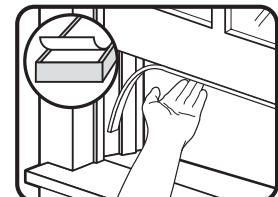

ROLLED PACKAGED DOOR & WINDOW WEATHERSTRIP

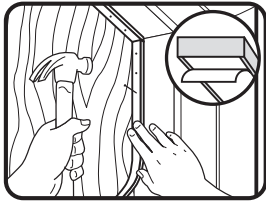

Felt Weatherstrip
Economical multi-purpose felt weatherstrip

MULTI-PURPOSE

| | T x W x L | COLOR | PACK QTY |
|-------|----------------------|-------|----------|
| 03335 | 3/16" X 5/8" X 17' | GRAY | 12 |
| 03350 | 3/16" X 1-1/4" X 17' | GRAY | 6 |

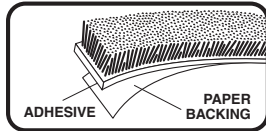

Storm Door & Window Replacement Weatherstrip
Tight woven pile seals out air, moisture and dust. Self-adhesive back holds weatherstrip in place. Use as replacement for pile weatherstrip in storm doors and windows.

| | | | | |
|-------|-----|----------|------|---|
| 04267 | 17' | ADHESIVE | GRAY | 6 |
|-------|-----|----------|------|---|

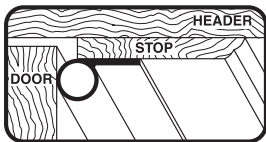

Vinyl Gasket Weatherstrip
Flexible vinyl "bulb" seals around doors and windows. May be nailed or stapled in place.

| | | | |
|-------|------------|-------|---|
| 78394 | 1/2" X 17' | WHITE | 6 |
| 78196 | 1/2" X 17' | BROWN | 6 |

WINDOW SPECIALTY WEATHERSTRIP

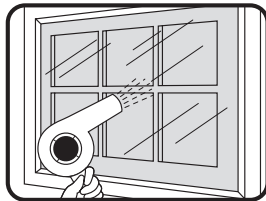

Shrink & Seal® Indoor Window Kits
See through film and tape. Installs around entire window or patio door. Eliminates drafts and frost build-up. Creates dead air space to increase insulating R-Value.

WINDOW INSULATION KITS

| | | | |
|-------|--|-------|----|
| 04184 | 42" X 62" SHEET - FITS ONE STANDARD SIZE WINDOW | CLEAR | 12 |
| 04440 | 3 - 42" X 62" SHEETS - FITS THREE STANDARD SIZE WINDOWS | CLEAR | 12 |
| 04200 | 62" X 210" SHEET - FITS FIVE STANDARD SIZE WINDOWS | CLEAR | 6 |
| 04283 | 84" X 110" SHEET - FITS ONE PATIO DOOR OR PICTURE WINDOW | CLEAR | 6 |



Shrink & Seal® Window Film Bulk Roll With Tape

| | | | |
|-------|---------------------------------|-------|----|
| 43100 | 64" X 25' WITH 1/2" X 120' TAPE | CLEAR | 12 |
| 43101 | 84" X 25' WITH 1/2" X 180' TAPE | CLEAR | 12 |

Replacement Tape for Shrink & Seal® Indoor Window Kits

| | | | |
|-------|--|-------|----|
| 31203 | 18' REPLACEMENT WINDOW TAPE - INDOOR/OUTDOOR | CLEAR | 12 |
| 04598 | 54' REPLACEMENT WINDOW TAPE - INDOOR/OUTDOOR | CLEAR | 12 |

Economy Storm Window Kits

| | | | |
|-------|-------------------------------|-------|----|
| 08264 | 3' X 6' X 1.25 MIL (1 WINDOW) | CLEAR | 36 |
| 08273 | 3' X 6' X 1.25 MIL (4 WINDOW) | CLEAR | 18 |

WEATHERSTRIP, THRESHOLDS & DOOR ACCESSORIES

M-D# DESCRIPTION COLOR PACK QTY

WINDOW SPECIALTY WEATHERSTRIP

Transparent Weatherstrip Tape

Clear polyethylene. A heavy duty tape for sealing air and moisture leaks around windows.

| | | | | |
|-------|-----------|----------|-------|----|
| 03509 | 2" X 25' | ADHESIVE | CLEAR | 12 |
| 04630 | 2" X 100' | ADHESIVE | CLEAR | 12 |

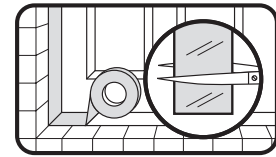

Plastic Sheeting – Clear Film

Clear heavy duty vinyl film is clear for a variety of interior/exterior household uses.

| | | | | |
|-------|-----------|------|-------|----|
| 04762 | 36" X 25' | 4MIL | CLEAR | 12 |
| 04770 | 48" X 25' | 4MIL | CLEAR | 12 |
| 04788 | 36" X 25' | 8MIL | CLEAR | 6 |
| 04796 | 48" X 25' | 8MIL | CLEAR | 6 |



Snap Lock Framing Strips Kit – White

| | | | | |
|-------|---------------------|--|-------|----|
| 08286 | 7 PIECES – 26" LONG | | WHITE | 24 |
|-------|---------------------|--|-------|----|

Economy Nail-On Framing Strips

Fiber framing strips for storm window (includes nails).

| | | | | |
|-------|------------|-----------|-------|----|
| 07766 | 3/4" X 36" | 18 PIECES | BROWN | 24 |
|-------|------------|-----------|-------|----|

GARAGE DOOR WEATHERSTRIP

Garage Door Threshold Kit

Durable vinyl threshold forms a weather tight seal under garage door. Helps block drafts, dust and moisture from entering under the door. Silicone adhesive tube included.

| | | | | |
|-------|-----------------|--|------|---|
| 50100 | 10' SINGLE DOOR | | GRAY | 2 |
| 50101 | 20' DOUBLE DOOR | | GRAY | 2 |



Garage Door Insulation Kit

Radiant foil insulation. Helps keep garage cooler in the summer and warmer in the winter. Reduces energy loss. Kit is designed for a single car garage door. Includes double-sided adhesive tape.

| | | | | |
|-------|-----------|------------------------------|--------------|---|
| 43157 | 22" X 40' | SEALS SINGLE CAR GARAGE DOOR | WHITE/SILVER | 2 |
|-------|-----------|------------------------------|--------------|---|



GARAGE DOOR WEATHERSTRIP

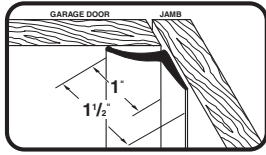

Vinyl Garage Door Seal for Top & Sides

Extruded vinyl. Designed to seal the sides and top of overhead garage doors.

| | | | | |
|-------|-----|-------|-------|---|
| 03822 | 30' | NAILS | WHITE | 6 |
|-------|-----|-------|-------|---|

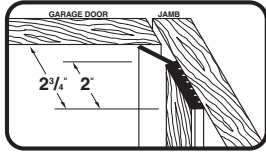

Dual Vinyl Garage Door Seal for Top & Sides

Flexible vinyl seal formed with firm vinyl base to provide an excellent garage door weatherstrip. Nail around garage door to seal out air, moisture and dust. Can be painted to match trim.

| | | | | |
|-------|----|--|-------|----|
| 87726 | 7' | | BROWN | 10 |
| 87742 | 9' | | BROWN | 10 |
| 87684 | 7' | | WHITE | 10 |
| 87700 | 9' | | WHITE | 10 |
| 08472 | 7' | | BEIGE | 10 |
| 08456 | 9' | | BEIGE | 10 |

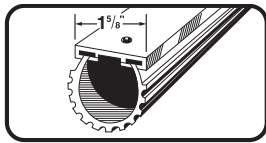

Universal Aluminum & Rubber Garage Door Bottom

Low temperature vinyl seal closes gaps up to 3/4" at bottom of garage door to seal out air, moisture and dust. Stays flexible to -30°. Seal insert is held in place with a sturdy aluminum extrusion fastened to bottom of door with screws (included).

| | | | | |
|-------|-----|--------|-------|---|
| 87643 | 9' | SCREWS | BLACK | 3 |
| 87668 | 18' | SCREWS | BLACK | 3 |

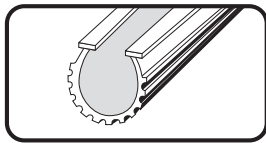

Replacement Vinyl for Universal Garage Door Bottom

| | | | | |
|-------|-----|--|-------|---|
| 08460 | 9' | | BLACK | 6 |
| 08462 | 18' | | BLACK | 6 |

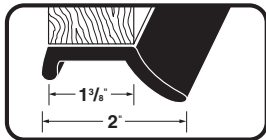

Premium Rubber Garage Door Bottom

An insulating premium rubber door seal that cushions shock as garage door is closed. Remains flexible at low temperatures. Seals out moisture and weather.

| | | | | |
|-------|-----|-------|-------|---|
| 03723 | 9' | NAILS | BLACK | 6 |
| 03749 | 16' | NAILS | BLACK | 6 |

M-D# DESCRIPTION COLOR PACK QTY

AIR CONDITIONER WEATHERSTRIP AND COVERS

Air Conditioner Covers

Durable polyethylene blocks out water, ice, dust and leaves during off season.

WINDOW UNITS

| | H x W x L | | COLOR | PACK QTY |
|-------|-----------------|---------------------------------|--------|----------|
| 03392 | 18" X 27" X 16" | FOR UNITS UP TO 10,000 BTU | SILVER | 12 |
| 50042 | 18" X 27" X 22" | FOR UNITS 10,000 TO 15,000 BTU | SILVER | 12 |
| 87619 | 20" X 28" X 30" | FOR UNITS 15,000 BTU AND LARGER | SILVER | 6 |

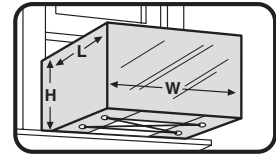

CENTRAL AIR UNITS – ROUND

| | | | | |
|-------|-----------|--|--------|---|
| 03426 | 34" X 30" | | SILVER | 6 |
|-------|-----------|--|--------|---|

CENTRAL AIR UNITS – SQUARE

| | | | | |
|-------|-----------------|--|--------|---|
| 03772 | 34" X 34" X 30" | | SILVER | 6 |
|-------|-----------------|--|--------|---|

Interior Window Air Conditioner Cover

"Stretch to fit" cover for interior face of A/C unit. Fits most sizes of window units.

| | | | | |
|-------|-------------------|--|-------|----|
| 50040 | ECONOMY – PLASTIC | | CLEAR | 12 |
|-------|-------------------|--|-------|----|

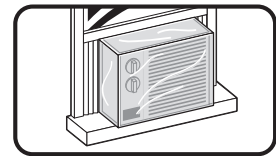

Air Conditioner Side Panel Kit

Foam panels insulate and reduce vibration. Can be trimmed to fit most sizes of A/C units. Self-adhesive installation strips included.

| | | | | |
|-------|-----------------------|----------|------|---|
| 08308 | 9" X 18" X 7/8" THICK | 2 PANELS | GRAY | 6 |
|-------|-----------------------|----------|------|---|

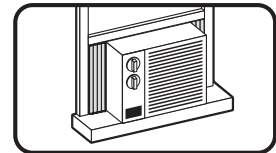

Air Conditioner Filters

Open cell foam filter can be trimmed to fit most sizes of A/C units. Washable and reusable.

| | | | | |
|-------|------------------------|----------------|------|----|
| 08311 | 24" X 15" X 1/4" THICK | OPEN CELL FOAM | GRAY | 24 |
|-------|------------------------|----------------|------|----|

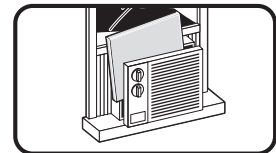

Air Conditioner Weatherstrip

HIGH DENSITY FOAM

Premium, high density foam tape. A compressible strip for sealing out air, insects and dust around window air conditioners. Colors match most window trim.

| | | | | |
|-------|---------------------|--|-------|----|
| 50005 | 1-3/8" X 1/2" X 42" | | BEIGE | 12 |
| 50007 | 1-3/8" X 1/2" X 42" | | BROWN | 12 |

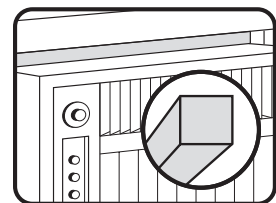

OPEN CELL FOAM

Resilient, open cell foam tape. A compressible strip for sealing out air, insects and dust around window air conditioners. Cushions vibrations.

| | | | | |
|-------|-----------------------|--|------|----|
| 02006 | 1-1/4" X 1-1/4" X 42" | | GRAY | 12 |
| 02535 | 2-1/4" X 2-1/4" X 42" | | GRAY | 6 |

SPECIALTY APPLICATION WEATHERSTRIP

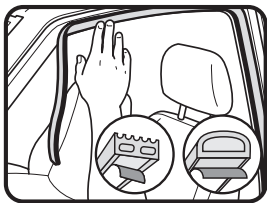

All Climate – Auto & Marine EPDM Rubber Weatherstrip

D PROFILE

5/16" thick x 11/32" wide

| | | | | |
|-------|-----|----------|-------|----|
| 01025 | 17' | ADHESIVE | BLACK | 12 |
|-------|-----|----------|-------|----|

ALL PROFILE

5/16" thick x 19/32" wide

| | | | | |
|-------|-----|----------|-------|----|
| 01033 | 10' | ADHESIVE | BLACK | 12 |
|-------|-----|----------|-------|----|

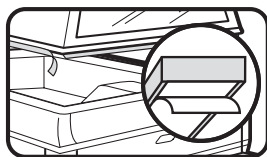

Camper Seal Self-Adhesive Foam Tape

High density, self-adhesive PVC foam tape. Designed to seal between truck bed and camper. Also recommended for use to cushion truck tool boxes. Extra wide foam cushions vibrations, blocks out air and moisture.

| | | | | |
|-------|----------------------|--|------|---|
| 02352 | 3/16" X 1-1/4" X 30' | | GRAY | 6 |
|-------|----------------------|--|------|---|

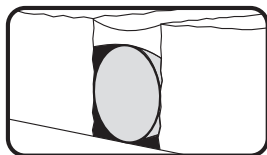

Backer Rod for Gaps & Joints

Non-absorbent, closed-cell polyethylene pre-caulking material. Use before caulking to fill gaps and openings larger than 1/2" x 1/2". Prevents 3-point bonding.

| | | | | |
|-------|------------|--|--|----|
| 71464 | 3/8" X 20' | | | 12 |
| 71480 | 1/2" X 20' | | | 12 |
| 71506 | 5/8" X 20' | | | 12 |

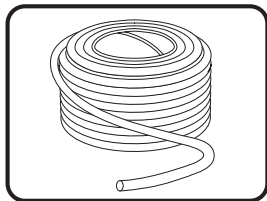

Replaceable Cord Weatherstrip

Forms a flexible seal inside or outside. Requires no tools. Easy to apply.

| | | | | |
|-------|-------|--|------|---|
| 71522 | 30 FT | | GRAY | 8 |
| 71548 | 90 FT | | GRAY | 6 |

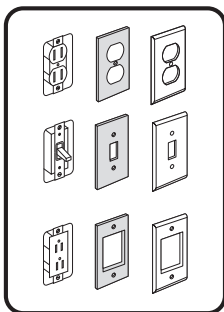

Switch & Wall Plate Sealers

Closed-cell foam sealers. UL and CSA approved.

| | | | | |
|-------|---|--|-------|----|
| 03434 | 6 LIGHT SWITCH SEALERS | | WHITE | 12 |
| 87916 | 6 OUTLET PLATE SEALERS | | WHITE | 12 |
| 06668 | 6 ROCKER SWITCH/ GFCI OUTLET SEALERS | | WHITE | 12 |

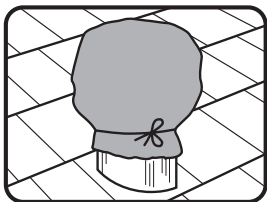

Turbine Vent Cover – Plastic

Heavy duty polyethylene. Black plastic with tie strings.

| | | | | |
|-------|--------------------|--|-------|----|
| 03376 | FITS MOST TURBINES | | BLACK | 12 |
|-------|--------------------|--|-------|----|

M-D# DESCRIPTION COLOR PACK QTY

PIPE INSULATION

Faucet Cover

Insulates and protects faucet in cold weather

03939 FAUCET COVER WHITE 100



Insulated Foam Pipe Wrap

PVC foam with aluminum shell. Aluminum foil shell reflects heat. Closed-cell foam insulates and protects.

02378 1/8" X 2" X 15' ADHESIVE BLACK/SILVER 6
 02394 1/8" X 2" X 30' ADHESIVE BLACK/SILVER 12

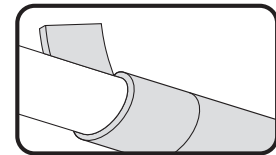

Fiberglass Pipe Wrap

Features 1/2" thick fiberglass insulation. Includes clear plastic wrap to provide moisture barrier.

04929 3" X 25' YELLOW 24
 04937 6" X 25' YELLOW 12

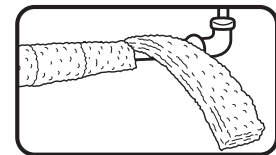

Tube Pipe Insulation

Blocks heat loss or gain to save energy. Use on hot or cold pipes. Stops condensation on cold pipes to prevent water damage.

PACKED 4 PER PACKAGE

Polyethylene (3/8") thickness

| | | | COPPER | IRON | PVC | |
|-------|-----------|------|--------|------|------|----|
| 50140 | 1/2" X 3' | FITS | 1/2" | 3/8" | 3/8" | 24 |
| 50142 | 3/4" X 3' | FITS | 3/4" | 1/2" | 1/2" | 18 |
| 50144 | 1" X 3' | FITS | 1" | 3/4" | 3/4" | 14 |

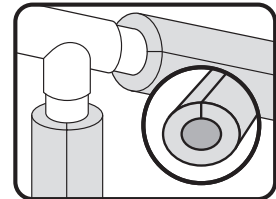

BULK PACKED

Polyethylene (3/8") thickness

| | | | COPPER | IRON | PVC | |
|-------|-----------|------|--------|------|------|----|
| 50148 | 1/2" X 6' | FITS | 1/2" | 3/8" | 3/8" | 70 |
| 50150 | 3/4" X 6' | FITS | 3/4" | 1/2" | 1/2" | 50 |
| 50154 | 1" X 6' | FITS | 1" | 3/4" | 3/4" | 40 |

Self-Sealing Tube Pipe Insulation

Blocks heat loss or gain to save energy. Use on hot or cold pipes. Stops condensation on cold pipes to prevent water damage. Pre-cut, self-sealing slits for easy application.

| | | | COPPER | IRON | PVC | |
|-------|-----------|------|--------|------|------|----|
| 50158 | 1/2" X 6' | FITS | 1/2" | 3/8" | 3/8" | 70 |
| 50162 | 3/4" X 6' | FITS | 3/4" | 1/2" | 1/2" | 50 |
| 50164 | 1" X 6' | FITS | 1" | 3/4" | 3/4" | 40 |

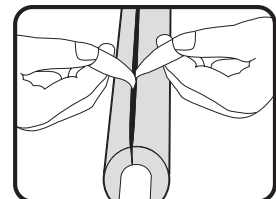

PIPE INSULATION

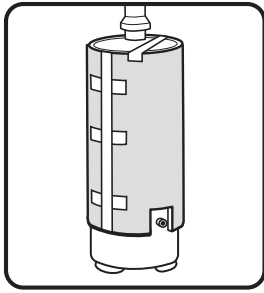

Water Heater Insulation Blankets

Designed for gas, oil or electric heaters. White vinyl backed fiberglass blanket. Includes adhesive tape for easy installation. Fits up to 60 gallons.

| | | | |
|-------|---------------------------------------|-------------------|---|
| 04663 | R-6.7 INSULATING VALUE 2" X 48" X 75" | NEW - LOWER PRICE | 4 |
| 04689 | R-11 INSULATING VALUE 3" X 48" X 75" | NEW | 4 |

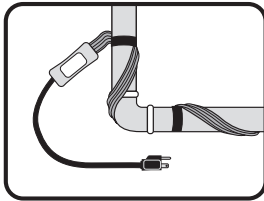

Pipe Heating Cable w/Thermostat

UL and CSA approved pipe heating cable designed to prevent water line freeze up. Ready to install, grounded cord and plug, thermostat controlled, with pilot light.

| | | | |
|-------|-----|--|---|
| 04309 | 3' | | 5 |
| 04325 | 6' | | 5 |
| 64386 | 9' | | 5 |
| 04341 | 13' | | 5 |
| 64428 | 18' | | 5 |
| 04366 | 24' | | 5 |
| 64444 | 30' | | 5 |

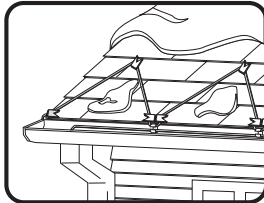

Roof & Gutter Cable

UL and CSA approved roof & gutter cable designed to prevent ice dams and water damage. Includes fasteners.

| | | | |
|-------|------|--|---|
| 64469 | 40' | | 5 |
| 64394 | 80' | | 3 |
| 64501 | 100' | | 3 |

DOOR SWEEPS

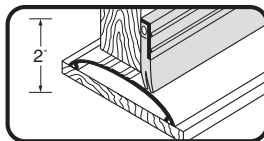

Deluxe Aluminum & Vinyl Door Sweep

Heavy duty door sweep seals gaps up to 3/4" high. Slotted holes for easy adjustment.

| | | | |
|-------|-----|----------|---|
| 05389 | 36" | ALUMINUM | 6 |
| 05413 | 48" | ALUMINUM | 6 |



NEW MetalDecor™ Finish

PREMIUM FINISH

| | | | |
|-------|-----|-----------------|---|
| 43153 | 36" | METALDECOR™ OAK | 6 |
| 48996 | 36" | SATIN NICKEL | 6 |
| 05744 | 36" | BRITE GOLD | 6 |
| 05652 | 36" | BRONZE | 6 |
| 05769 | 36" | WHITE | 6 |

WEATHERSTRIP, THRESHOLDS & DOOR ACCESSORIES

M-D# DESCRIPTION COLOR PACK QTY

DOOR SWEEPS

Triple Fin Aluminum & Vinyl Door Sweep

Triple fin vinyl seal provides superior seal for uneven floor surfaces. Slotted holes for easy adjustment.

05090 36" ALUMINUM 6

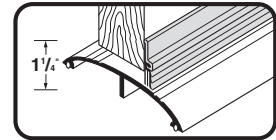

PREMIUM FINISH

05702 36" BRITE GOLD 6
 05173 36" BRONZE 6
 05215 36" WHITE 6

Aluminum & Felt Door Sweep

05017 36" ALUMINUM 6



PREMIUM FINISH

05058 36" BRITE GOLD 6

Hardwood & Vinyl Door Sweep

Unfinished hardwood doorsweep with triple fin vinyl seal blocks drafts. Can be stained or painted to match door.

06411 36" UNFINISHED 6

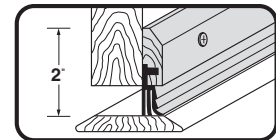

Self-Adhesive Door Sweep

ECONOMY

Rigid vinyl with soft vinyl sweep. Sticks to all doors. Flexible to compensate for carpet or uneven doors.

05603 36" BROWN 24
 05587 36" WHITE 24

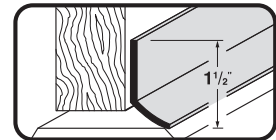

Economy Aluminum & Vinyl Door Sweep

ECONOMY

05629 36" ALUMINUM 20

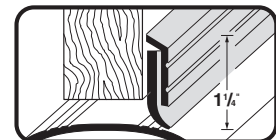

Flex-O-Matic Automatic Door Sweep

As the door opens, the spring action door sweep automatically raises to clear the carpet. When the door is closed, the door sweep automatically lowers to firmly press against floor or carpet.

07237 36" ALUMINUM 6



PREMIUM FINISH

07153 36" BRONZE 6
 07179 36" WHITE 6

M-D#

DESCRIPTION

COLOR

PACK QTY

DOOR SWEEPS

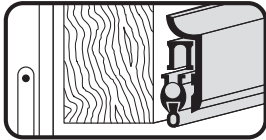

Seal-O-Matic Automatic Door Sweep

Weatherproofs and soundproofs. Vinyl bottom raises automatically to clear carpet when door opens. Vinyl bottom lowers automatically to make tight seal when door closes.

| | | | |
|-------|-----|----------|---|
| 07039 | 36" | ALUMINUM | 6 |
|-------|-----|----------|---|

DOOR BOTTOMS & DRIP CAPS

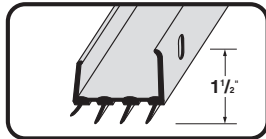

U-Shaped Door Bottom w/Vinyl Fins

Durable vinyl door bottom has soft vinyl fins to seal against top of threshold and sill. Great for steel doors.

FITS MOST 1-3/4" STEEL OR WOOD DOORS

| | | | |
|-------|-----|-------|---|
| 05991 | 36" | BROWN | 6 |
| 06528 | 36" | WHITE | 6 |

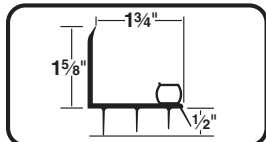

Replacement Door Bottom w/Vinyl Fins

Fits most brands of entry doors.

L-SHAPED - FITS A VARIETY OF 1-3/4" STEEL OR WOOD DOORS

| | | | |
|-------|-----|-------|---|
| 82578 | 36" | BROWN | 6 |
| 43816 | 36" | WHITE | 6 |

82578/43816

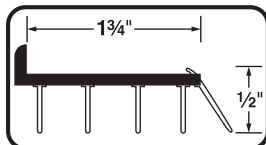

82586

FITS A VARIETY OF 1-3/4" STEEL OR WOOD DOORS

| | | | | |
|-------|-----|------------------|-------|---|
| 82586 | 36" | SCREW OR NAIL-ON | BROWN | 6 |
|-------|-----|------------------|-------|---|

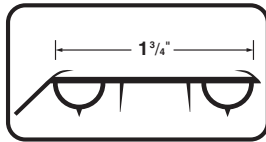

47000

FITS A VARIETY OF 1-3/4" STEEL OR WOOD DOORS

| | | | | |
|-------|-----|------------------|-------|---|
| 47000 | 36" | SCREW OR NAIL-ON | BROWN | 6 |
|-------|-----|------------------|-------|---|

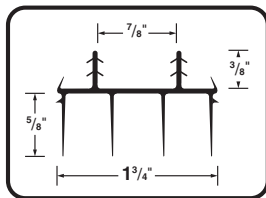

67967

KERF STYLE - FITS A VARIETY OF DOORS WITH NOTCHED KERFS

| | | | |
|-------|---------|-------|---|
| 67967 | 35-3/4" | BROWN | 6 |
|-------|---------|-------|---|

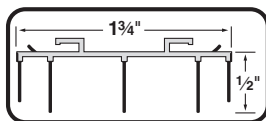

82594

FITS PEASE STYLE DOORS

| | | | |
|-------|---------|-------|---|
| 82594 | 35-3/4" | BEIGE | 6 |
|-------|---------|-------|---|

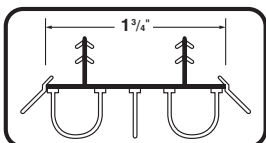

43820

KERF STYYLE - FITS A VARIETY OF DOORS WITH NOTCHED KERFS

| | | | |
|-------|----------|-------|---|
| 43820 | 35 3/16" | BEIGE | 6 |
|-------|----------|-------|---|

M-D# DESCRIPTION COLOR PACK QTY

DOOR BOTTOMS & DRIP CAPS

U-Shaped Door Bottom w/Vinyl Seal

FITS 1-3/4" DOORS

05322 36" U-SHAPED ALUMINUM 6

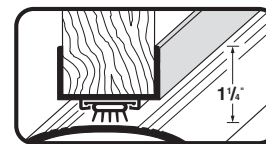

L-Shaped Door Bottom w/Drip Cap

L-shaped door bottom with drip cap, fits both 1-3/8" and 1-3/4" doors. Seals between bottom of door and threshold to block out air and moisture. Slotted fastener holes allow easy installation and adjustment.

06015 36" ALUMINUM 6

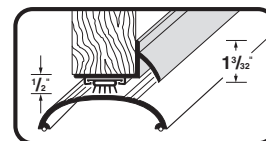

PREMIUM FINISH

48998 36" SATIN NICKEL 6
 06098 36" BRITE GOLD 6
 06056 36" BRONZE 6
 06395 36" WHITE 6

U-Shaped Door Bottom w/Drip Cap

U-shaped door bottom with drip cap. Seals between bottom of door and threshold to block out air and moisture. Slotted fastener holes allow easy installation and adjustment.

FITS 1-3/8" DOORS

06114 36" ALUMINUM 6

FITS 1-3/4" DOORS

06155 36" ALUMINUM 6

PREMIUM FINISH

49000 36" SATIN NICKEL 6
 06478 36" BRITE GOLD 6
 06197 36" BRONZE 6
 06403 36" WHITE 6

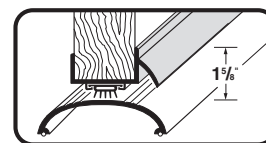

Concealed Door Bottom w/Vinyl Seal

Extruded aluminum with vinyl seal.

05512 36" ALUMINUM 6

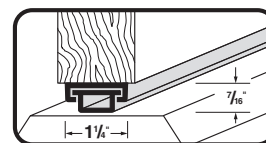

Drip Cap w/Vinyl Seal

Drip cap with flap seal to block out air and moisture. Slotted holes for easy adjustment.

05546 36" ALUMINUM 6

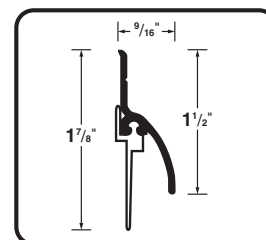

DOOR BOTTOMS & DRIP CAPS

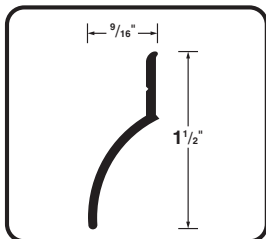

Aluminum Drip Cap

Aluminum drip cap diverts rainwater away from bottom of door. Slotted holes for easy adjustment.

| | | | |
|-------|-----|----------|---|
| 06247 | 36" | ALUMINUM | 6 |
|-------|-----|----------|---|

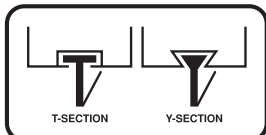

Storm Door Bottom Vinyl Replacement

A vinyl replacement for aluminum storm doors.

| | | | | |
|-------|-----|-----------|------|----|
| 04226 | 37" | T SECTION | GRAY | 12 |
| 04242 | 37" | Y SECTION | GRAY | 12 |

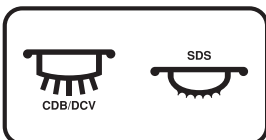

Vinyl Replacement Inserts For Door Bottoms

| | | | | |
|-------|-----|--|-------|----|
| 06304 | 36" | FOR L-SHAPE AND U-SHAPED ALUMINUM DOOR BOTTOMS | GRAY | 10 |
| 25756 | 36" | FOR L-SHAPE AND U-SHAPED ALUMINUM DOOR BOTTOMS | BLACK | 10 |
| 05520 | 36" | FOR CONCEALED ALUMINUM DOOR BOTTOM – SDS | GRAY | 10 |

RIGID DOOR JAMB WEATHERSTRIP KITS

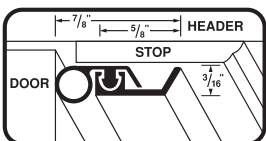

Universal Door Jamb Weatherstrip Kit

Aluminum and vinyl. Nail fasteners for wood frame doors, screw fasteners for wood or steel frame doors. Fasteners included. Install on doorstop. Slotted fastener holes ensure easy installation and adjustment.

| | | | | |
|-------|-----------|--------|----------|----|
| 01040 | 36" X 84" | NAILS | ALUMINUM | 10 |
| 01073 | 36" X 84" | SCREWS | ALUMINUM | 10 |

PREMIUM FINISH

| | | | | |
|-------|-----------|--------|--------------|----|
| 49002 | 36" X 84" | SCREWS | SATIN NICKEL | 10 |
| 01156 | 36" X 84" | SCREWS | BRONZE | 10 |
| 01958 | 36" X 84" | SCREWS | WHITE | 10 |
| 01271 | 36" X 84" | SCREWS | BRITE GOLD | 10 |

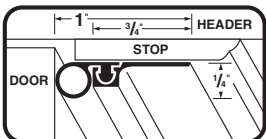

Flat Profile Door Jamb Weatherstrip Kit

Aluminum and vinyl. Flat design recommended for commercial or residential application. Screw fasteners for wood or steel frame doors. Fasteners included. Install on doorstop. Slotted fastener holes ensure easy installation and adjustment.

| | | | | |
|-------|-----------|--------|----------|----|
| 01438 | 36" X 84" | SCREWS | ALUMINUM | 10 |
|-------|-----------|--------|----------|----|

PREMIUM FINISH

| | | | | |
|-------|-----------|--------|------------|----|
| 01677 | 36" X 84" | SCREWS | BRONZE | 10 |
| 87635 | 36" X 84" | SCREWS | WHITE | 10 |
| 01669 | 36" X 84" | SCREWS | BRITE GOLD | 10 |

M-D# DESCRIPTION COLOR PACK QTY

RIGID DOOR JAMB WEATHERSTRIP KITS

Extreme Temperature Door Jamb Weatherstrip Kit

Aluminum and santoprene. Ideal product for extremely cold or hot climates. Screw fasteners for wood or steel frame doors. Fasteners included. Install on doorstop. Santoprene seal remains flexible at -40°, resists drying and cracking in hot temperatures. Slotted fastener holes ensure easy installation and adjustment.

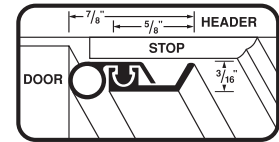

PREMIUM FINISH

| | | | | |
|-------|-----------|--------|-------|----|
| 01750 | 36" X 84" | SCREWS | WHITE | 10 |
|-------|-----------|--------|-------|----|

Wood & Vinyl Door Jamb Weatherstrip Kit

Wood with flexible vinyl bulb provides a weathertight seal. Installs on doorstop. Pre-Primed Wood may be painted.

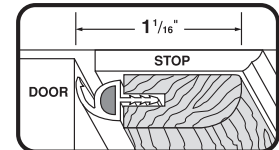

| | | | | |
|-------|-----------|-------|-------------|----|
| 43818 | 36" X 84" | NAILS | PRIMED WOOD | 10 |
|-------|-----------|-------|-------------|----|

Compression Weatherstrip w/ Wood Stop Door Jamb Kit

Straight grained wood with foam and vinyl seal. For residential use. Fasteners included. Install on doorstop or use to replace doorstop. Pre-Primed Wood may be painted.

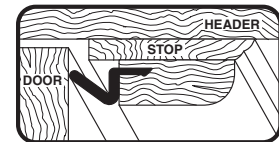

| | | | | |
|-------|-----------|--|---------------------|---|
| 91884 | 36" X 84" | | BROWN / PRIMED WOOD | 6 |
| 87981 | 36" X 84" | | WHITE / PRIMED WOOD | 6 |

Compression Weatherstrip w/Aluminum Stop Door Jamb Kit

Aluminum with foam and vinyl seal. For commercial or residential use. Screw fasteners for wood or metal frame doors. Fasteners included. Install on doorstop. Slotted fastener holes ensure easy installation and adjustment.

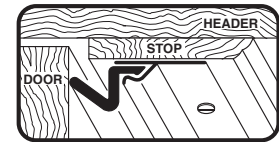

PREMIUM FINISH

| | | | | |
|-------|-----------|--------|--------|---|
| 91850 | 36" X 84" | SCREWS | WHITE | 6 |
| 87783 | 36" X 84" | SCREWS | BRONZE | 6 |

Compression Replacement Weatherstrip

Vinyl clad foam. Recommended for commercial or residential use. Kerf installation.

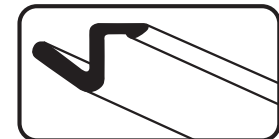

| | | | | |
|-------|-----|------|-------|----|
| 91868 | 81" | KERF | WHITE | 20 |
| 87767 | 81" | KERF | BROWN | 20 |
| 91800 | 81" | KERF | BEIGE | 20 |

Steel Door Magnetic Weatherstrip

For steel entry doors. Installed in kerf / slot in doorstop. Magnetic pulling power, along with flexible gasket, compensates for unevenness in doors. For door frames with kerfs of at least 3/8" and doorstop width of 7/16". Three piece set.

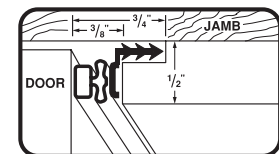

LOW TEMPERATURE T.P.E. VINYL – STEEL DOOR MAGNETIC WEATHERSTRIP SET

| | | | | |
|-------|-----------|------|-------|---|
| 01610 | 36" X 81" | KERF | BEIGE | 6 |
| 01636 | 36" X 81" | KERF | BROWN | 6 |

VINYL CLAD FOAM – STEEL DOOR MAGNETIC WEATHERSTRIP SET

| | | | | |
|-------|-----------|------|-------|---|
| 47002 | 36" X 81" | KERF | BEIGE | 6 |
|-------|-----------|------|-------|---|

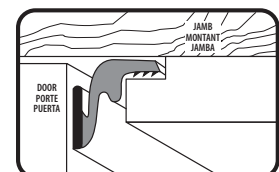

BRONZE SPRING SEALING DOOR WEATHERSTRIP KITS

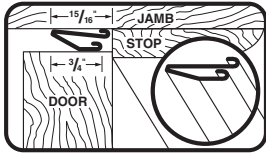

H-4 Door Weatherstrip

Install on wood doorjamb. Bronze strips may be cut to fit smaller doors. V-shape presses seal against door to block out air and moisture. Fasteners included.

THE ORIGINAL WEATHERSTRIP

.005" THICKNESS

| | | | | |
|-------|-----------|-------|--------|----|
| 01305 | 36" X 84" | NAILS | BRONZE | 10 |
|-------|-----------|-------|--------|----|

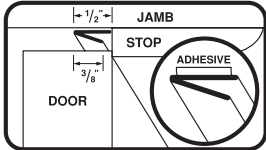

V-Flex Weatherstrip

Polypropylene with adhesive back. A superior self-adhesive V-shaped plastic weatherstrip for sealing doors and windows.

| | | | | |
|-------|------------|----------|-------|----|
| 03541 | 7/8" X 17' | ADHESIVE | BROWN | 12 |
| 03525 | 7/8" X 17' | ADHESIVE | WHITE | 12 |

ADJUSTABLE HEIGHT THRESHOLDS

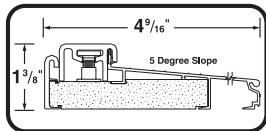

Adjustable/Thermal Break Threshold

Set screws allow for easy adjustment to seal uneven gaps between bottom of door and floor for a weathertight seal. "Thermal-break" design prevents frost build-up on interior surface of threshold.

WIDTH 4-9/16" – adjusts from 1-3/8" to 1-5/8" high

| | | | | |
|-------|-----|--|----------|---|
| 43822 | 36" | | ALUMINUM | 6 |
|-------|-----|--|----------|---|

PREMIUM FINISH

| | | | | |
|-------|-----|--|--------------|-----|
| 49008 | 36" | | SATIN NICKEL | 1/3 |
|-------|-----|--|--------------|-----|

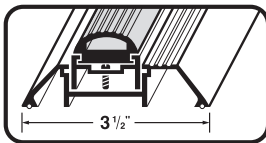

Adjustable Aluminum Threshold w/ Vinyl Seal

Set screws allow for easy adjustment to seal uneven gaps between bottom of door.

| | | | | |
|-------|-----|--|----------|-----|
| 08664 | 36" | | ALUMINUM | 1/6 |
|-------|-----|--|----------|-----|

ALUMINUM THRESHOLDS W/VINYL SEAL

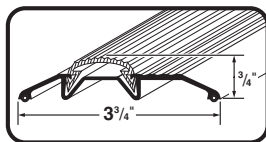

Deluxe Low Threshold w/Vinyl Seal

A deluxe low threshold available in premium finishes. Heavy extruded aluminum design with replaceable vinyl insert. Vinyl caulking feet seal bottom of threshold.

WIDTH 3-3/4" – HEIGHT 3/4"

| | | | | |
|-------|-----|--|----------|-----|
| 08086 | 32" | | ALUMINUM | 1/6 |
| 08102 | 36" | | ALUMINUM | 1/6 |
| 08151 | 72" | | ALUMINUM | 1/6 |

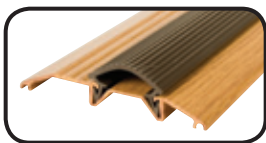

NEW MetalDecor™ Finish

PREMIUM FINISH

| | | | | |
|-------|-----|--|-----------------|-----|
| 43151 | 36" | | METALDECOR™ OAK | 1/6 |
| 49004 | 36" | | SATIN NICKEL | 1/6 |
| 09043 | 36" | | BRITE GOLD | 1/6 |
| 09159 | 72" | | BRITE GOLD | 1/6 |
| 10116 | 36" | | BRONZE | 1/6 |

WEATHERSTRIP, THRESHOLDS & DOOR ACCESSORIES

M-D# DESCRIPTION COLOR PACK QTY

ALUMINUM THRESHOLDS W/VINYL SEAL

Deluxe High Threshold w/Vinyl Seal

A deluxe high threshold available in premium finishes. Heavy extruded aluminum design with replaceable vinyl insert. Vinyl caulking feet seal bottom of threshold.

WIDTH 3-3/4" – HEIGHT 1-1/8"

| | | | |
|-------|-----|----------|-----|
| 08003 | 32" | ALUMINUM | 6 |
| 08029 | 36" | ALUMINUM | 1/6 |
| 08078 | 72" | ALUMINUM | 1/6 |

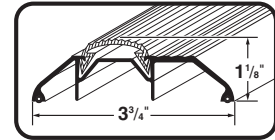

PREMIUM FINISH

| | | | |
|-------|-----|--------------|-----|
| 49006 | 36" | SATIN NICKEL | 1/6 |
| 09365 | 36" | BRITE GOLD | 1/6 |
| 10017 | 36" | BRONZE | 1/6 |

Deluxe Extra High Threshold w/Vinyl Seal

A deluxe extra high threshold. Heavy extruded aluminum design. Replaceable vinyl insert. Vinyl caulk feet seal bottom of threshold.

WIDTH 3-3/4" – HEIGHT 1-1/2"

| | | | |
|-------|-----|----------|-----|
| 08185 | 36" | ALUMINUM | 1/6 |
|-------|-----|----------|-----|

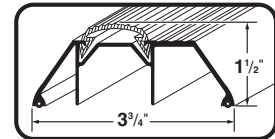

Low Mini Threshold w/Vinyl Seal

Extruded aluminum threshold with replaceable vinyl insert. Installs on door bottom or on top of existing wooden threshold.

WIDTH 1-3/8" – HEIGHT 7/16"

| | | | |
|-------|-----|----------|---|
| 08243 | 36" | ALUMINUM | 6 |
|-------|-----|----------|---|

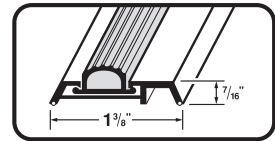

Standard Duty Low Threshold w/Vinyl Seal

Extruded aluminum threshold with vinyl seal. Vinyl caulking strips under legs.

WIDTH 3-3/8" – HEIGHT 3/4"

| | | | |
|-------|-----|----------|-----|
| 08383 | 36" | ALUMINUM | 1/6 |
|-------|-----|----------|-----|

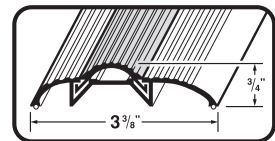

Standard Duty High Threshold w/Vinyl Seal

Extruded aluminum threshold with vinyl seal. Vinyl caulking strips under legs. Designed for use with thick pile carpet.

WIDTH 3-3/8" – HEIGHT 1-1/8"

| | | | |
|-------|-----|----------|-----|
| 08409 | 36" | ALUMINUM | 1/6 |
|-------|-----|----------|-----|

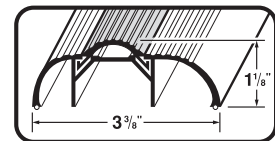

Economy Low Threshold w/Vinyl Seal

Economy aluminum threshold, low style, with vinyl seal.

WIDTH 3" – HEIGHT 3/4"

| | | | |
|-------|-----|----------|----|
| 08748 | 36" | ALUMINUM | 10 |
|-------|-----|----------|----|

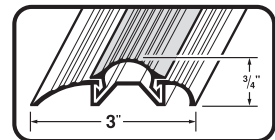

HARDWOOD THRESHOLDS

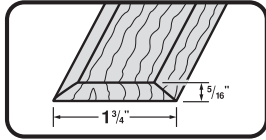

1-3/4" Flat Hardwood Threshold

Hardwood.

WIDTH 1-3/4" – HEIGHT 5/16"

| | | | |
|-------|-----|------------|---|
| 11882 | 36" | UNFINISHED | 6 |
|-------|-----|------------|---|

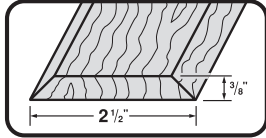

2-1/2" Flat Hardwood Threshold

Hardwood.

WIDTH 2-1/2" – HEIGHT 3/8"

| | | | |
|-------|-----|------------|---|
| 11908 | 36" | UNFINISHED | 6 |
|-------|-----|------------|---|

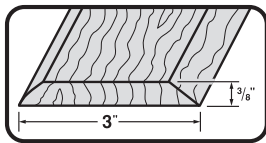

3" Flat Hardwood Threshold

Hardwood.

WIDTH 3" – HEIGHT 3/8"

| | | | |
|-------|-----|------------|---|
| 11924 | 36" | UNFINISHED | 6 |
|-------|-----|------------|---|

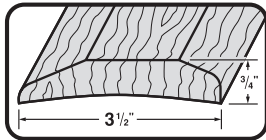

Hardwood Low Threshold

Attractive, hardwood provides a durable residential threshold. Low thermal transfer coefficient of wood helps save energy.

WIDTH 3-1/2" – HEIGHT 3/4"

| | | | |
|-------|-----|------------|-----|
| 11742 | 36" | UNFINISHED | 1/6 |
| 11874 | 72" | UNFINISHED | 6 |

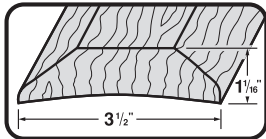

Hardwood High Threshold

Attractive, hardwood provides a durable residential threshold. Low thermal transfer coefficient of wood helps save energy.

WIDTH 3-1/2" – HEIGHT 1-1/16"

| | | | |
|-------|-----|------------|---|
| 11767 | 36" | UNFINISHED | 6 |
|-------|-----|------------|---|

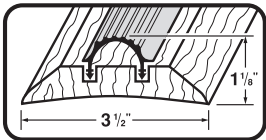

Hardwood Low Threshold w/Replaceable Vinyl Seal

Attractive, hardwood with flexible vinyl seal provides an attractive seal to block out cold air.

WIDTH 3-1/2" – HEIGHT 1-1/8" - LOW

| | | | |
|-------|-----|------------|-----|
| 11783 | 36" | UNFINISHED | 1/6 |
|-------|-----|------------|-----|

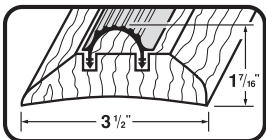

Hardwood High Threshold w/Replaceable Vinyl Seal

PREMIUM

Attractive, hardwood with flexible vinyl seal provides an attractive seal to block out cold air.

WIDTH 3-1/2" – HEIGHT 1-7/16" - HIGH

| | | | |
|-------|-----|------------|-----|
| 11809 | 36" | UNFINISHED | 1/6 |
|-------|-----|------------|-----|

M-D# DESCRIPTION COLOR PACK QTY

SADDLE THRESHOLDS

1-3/4" Flat Top

Extruded aluminum smooth flat top threshold.

WIDTH 1-3/4" – HEIGHT 1/8"

11056 36" ALUMINUM 6

PREMIUM FINISH

49010 36" SATIN NICKEL 6

09563 36" BRITE GOLD 6

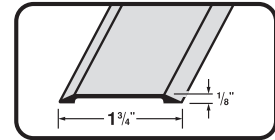

2-1/2" Flat Top

Extruded aluminum smooth flat top threshold.

WIDTH 2-1/2" – HEIGHT 1/4"

11072 36" ALUMINUM 6

PREMIUM FINISH

09613 36" BRITE GOLD 6

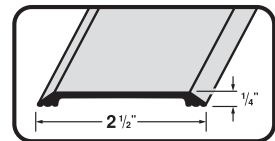

Low Dome Top

Extruded aluminum threshold with vinyl caulking strips under legs.

WIDTH 3-1/2" – HEIGHT 5/8"

11205 36" ALUMINUM 1/6

PREMIUM FINISH

09415 36" BRITE GOLD 6

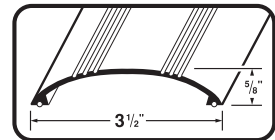

NOTE: Additional sizes and finishes available in M-D Ultra line on pages 36-37.

High Dome Top

Extruded aluminum threshold with vinyl caulking strips under legs.

WIDTH 3-1/2" – HEIGHT 1"

11346 36" ALUMINUM 6

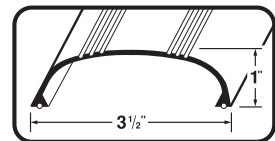

NOTE: Additional sizes and finishes available in M-D Ultra line on pages 36-37.

BUMPER THRESHOLDS FOR OUTSWING DOORS

Deluxe Low Bumper Threshold – 5/8"

A top quality extruded aluminum low threshold with replaceable vinyl insert and vinyl caulking strips under legs.

WIDTH 3-3/16" – HEIGHT 5/8"

08433 36" ALUMINUM 1/6

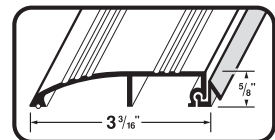

Low Bumper Threshold – 3/4"

Quality extruded aluminum threshold with replaceable vinyl inserts. Vinyl caulking strips under legs.

WIDTH 3-1/2" – HEIGHT 3/4"

08599 36" ALUMINUM 6

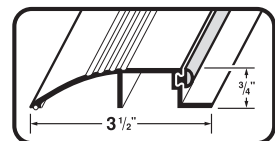

BUMPER THRESHOLDS FOR OUTSWING DOORS

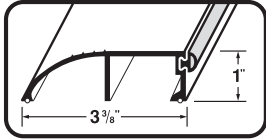

High Bumper Threshold – 1"

Quality extruded aluminum threshold with replaceable insert. Vinyl caulking strips under legs.

WIDTH 3-3/8" – HEIGHT 1"

| | | | |
|-------|-----|----------|-----|
| 08631 | 36" | ALUMINUM | 1/6 |
| 08656 | 72" | ALUMINUM | 1/6 |

PREMIUM FINISH

| | | | |
|-------|-----|------------|---|
| 09548 | 36" | BRITE GOLD | 6 |
| 10322 | 36" | BRONZE | 6 |

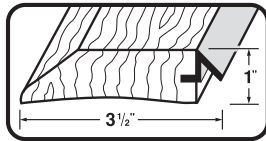

Hardwood Bumper Threshold – 1"

Attractive, hardwood bumper threshold with vinyl seal blocks out air and moisture.

WIDTH 3-1/2" – HEIGHT 1"

| | | | |
|-------|-----|--|---|
| 13748 | 36" | | 6 |
|-------|-----|--|---|

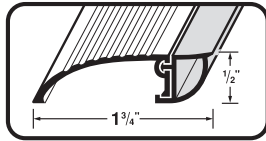

Low Mini Bumper Threshold – 1/2"

Vinyl insert designed to deflect water away from door.

WIDTH 1-3/4" – HEIGHT 1/2"

| | | | |
|-------|-----|----------|---|
| 08904 | 36" | ALUMINUM | 6 |
|-------|-----|----------|---|

PREMIUM FINISH

| | | | |
|-------|-----|--------------|---|
| 94091 | 36" | SATIN NICKEL | 6 |
|-------|-----|--------------|---|

SILL NOSINGS

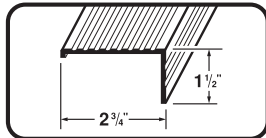

WIDTH 2-3/4" – HEIGHT 1-1/2"

| | | | |
|-------|-----|----------|---|
| 13029 | 36" | ALUMINUM | 6 |
|-------|-----|----------|---|

WIDTH 4-1/2" – HEIGHT 1-1/2"

| | | | |
|-------|-----|----------|---|
| 13094 | 36" | ALUMINUM | 6 |
|-------|-----|----------|---|

NOTE: Additional sizes and finishes available in M-D Ultra line on pages 37-38.

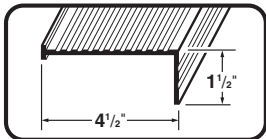

NOTE: Additional sizes and finishes available in M-D Ultra line on pages 37-38.

VINYL REPLACEMENT INSERTS FOR THRESHOLDS



Fits Deluxe Aluminum Thresholds w/Vinyl Seal

| | | | |
|-------|-----|------|---|
| 43824 | 36" | GRAY | 6 |
| 43826 | 72" | GRAY | 6 |

M-D# DESCRIPTION COLOR PACK QTY

VINYL REPLACEMENT INSERTS FOR THRESHOLDS

Fits Thresholds w/Metal Retainer Strip

13219 36" GRAY 6

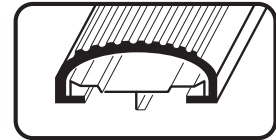

Fits Deluxe Bumper Thresholds with "Flap" style insert

13383 36" GRAY 6



Fits Bumper Thresholds with "Bulb" style insert

13409 36" GRAY 6



Fits a variety of threshold styles

13417 36" GRAY 10

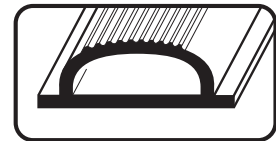

Fits Standard and Economy style Aluminum Thresholds w/Vinyl Seal

13466 36" GRAY 10

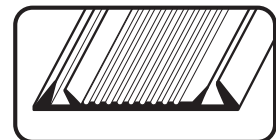

Fits Hardwood Thresholds with vinyl seals

13565 36" BRONZE 10

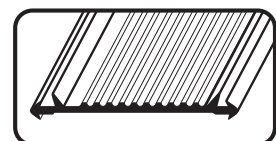

For Adjustable Height Aluminum Thresholds w/Vinyl Seals

13524 36" GRAY 6

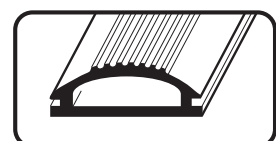

Weatherstrip Assortments

See Assortment Catalog for Assortment Contents and Costs

09427600 4 FT PACKAGED WEATHERSTRIP ASSORTMENT

09427618 8 FT PACKAGED WEATHERSTRIP ASSORTMENT

Threshold, Door Bottoms Sweeps and Door Jamb Assortments

See Assortment Catalog for Assortment Contents and Costs

09417470 4 FT THRESHOLDS / SWEEPS / DOOR JAMB ASSORTMENT

09417471 8 FT THRESHOLDS / SWEEPS / DOOR JAMB ASSORTMENT

09416553 VINYL CLAD WEATHERSTRIP ASSORTMENT

M-D#

DESCRIPTION

COLOR

PACK QTY

WEATHERSTRIP & THRESHOLDS – COMMERCIAL

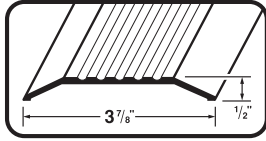

Fluted Top

Extruded aluminum saddle threshold.



WIDTH 3-7/8" – HEIGHT 1/2"

| | | | |
|-------|-----|----------|-----|
| 08763 | 36" | ALUMINUM | 1/6 |
|-------|-----|----------|-----|

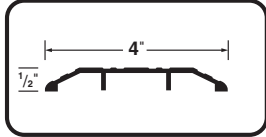

4" Heavy Duty Fluted Top

COMMERCIAL

Ideal for commercial use. Heavy duty aluminum fluted top threshold.



EXTRA HEAVY DUTY

WIDTH 4" – HEIGHT 1/2"

| | | | |
|-------|-----|----------|-----|
| 11502 | 36" | ALUMINUM | 1/6 |
| 11544 | 72" | ALUMINUM | 1/6 |

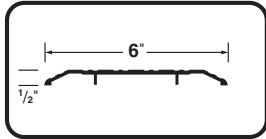

6" Heavy Duty Fluted Top

COMMERCIAL

Extruded aluminum fluted top threshold.



HEAVY DUTY

WIDTH 6" – HEIGHT 1/2"

| | | | |
|-------|-----|----------|-----|
| 11619 | 36" | ALUMINUM | 1/6 |
|-------|-----|----------|-----|

ULTRA COMMERCIAL THRESHOLDS



FIRE LABELED – Products displaying this symbol are labeled as Gasketing Material FOR FIRE DOORS CLASSIFIED BY UNDERWRITERS LABORATORIES INC.



INTENDED FOR APPLICATION TO SWINGING TYPE FIRE DOORS; RATED UP TO 3 HOURS. Tested in accordance with **ASTM E-152, NFPA 252, UL-10B, UBC-432, CAN4-S104-M80.**

These products have been labeled and classified resulting from testing done by Underwriters Laboratories Inc. that these gasketing products do not adversely affect the fire resistance of the door or frame according to its rating in UL Building Materials Directory. All products are continuously monitored by UL to ensure compliance under the follow-up inspection service.



HANDICAPPED – Products displaying this symbol are 1/2" high or less and have no more than 1/4" vertical rise with slope portions not greater than 1:2. Meets requirements of **ADAAG-1992, CABO/ANSI A 117.1-1992, Title 24, CAC Sec 2-3303(i).** All products meet or exceed ADA requirements.



SMOKE TESTED – Meets requirements of: **NFPA-105-1989.** Products displaying this symbol have been successfully tested for smoke and draft. Performance evaluated with testing procedures defined by NFPA-105-1989. All products meet or exceed the performance criteria for allowable air leakage as specified by NFPA 105-1989 installation of Smoke-Control Door Assemblies. See below for test results.



AIR INFILTRATION – Tested to **ASTM E-283 and SDI 116.** Products displaying this symbol have been Air Infiltration tested in accordance with the requirements of ASTM E-283 Rate of Air Leakage Through Exterior Windows, Curtain Walls & Doors and SDI 116 Test Procedure and acceptance of Rate of Air Flow Through Closed Steel Door and Frame Assemblies (Steel Door Institute). All products shown with this symbol are well below the maximum leakage allowed.



SOUND/LIGHT – Products displaying this symbol are designed for use in openings where reduction of light and/or sound is necessary. Due to the variety of door and frame combinations, these products may vary in their performance. Tested to **ASTM E 90-90 and ASTM E-1408-91.**

M-D# DESCRIPTION COLOR PACK QTY

ULTRA COMMERCIAL THRESHOLDS

Fluted Saddle Thresholds – 1/2" Height

TH014

1/2" X 4" fluted saddle.



| | | | |
|-------|-----|--------|---|
| 68288 | 36" | MILL | 6 |
| 68296 | 72" | MILL | 6 |
| 68304 | 36" | BRONZE | 6 |
| 68312 | 72" | BRONZE | 6 |



Fluted Saddle Thresholds – 1/2" Height

TH015

1/2" X 5" fluted saddle.



| | | | |
|-------|-----|--------|---|
| 68320 | 36" | MILL | 6 |
| 68338 | 72" | MILL | 6 |
| 68346 | 36" | BRONZE | 6 |
| 68353 | 72" | BRONZE | 6 |

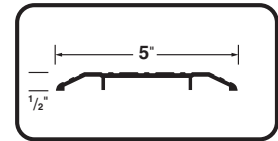

Fluted Saddle Thresholds – 1/2" Height

TH019

1/2" x 6" fluted saddle.



| | | | |
|-------|-----|--------|---|
| 68635 | 36" | MILL | 6 |
| 68692 | 72" | MILL | 6 |
| 69828 | 36" | BRONZE | 6 |
| 69833 | 72" | BRONZE | 6 |

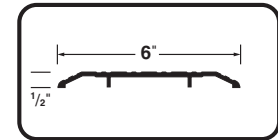

Fluted Saddle Thresholds – 1/4" Height

TH041

1/4" X 4" fluted saddle.



| | | | |
|-------|-----|------|---|
| 68361 | 36" | MILL | 6 |
|-------|-----|------|---|



Fluted Saddle Thresholds – 1/4" Height

TH042

1/4" X 5" fluted saddle.



| | | | |
|-------|-----|--------|-----|
| 68387 | 36" | MILL | 1/6 |
| 69808 | 72" | MILL | 6 |
| 68395 | 36" | BRONZE | 6 |
| 69811 | 72" | BRONZE | 6 |

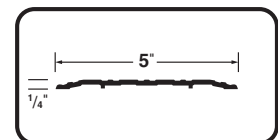

M-D#

DESCRIPTION

COLOR

PACK QTY

ROLLED PACKAGED DOOR & WINDOW WEATHERSTRIP

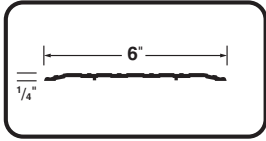

Fluted Saddle Thresholds – 1/4" Height

TH043

1/4" X 6" fluted saddle.



| | | | |
|-------|-----|--------|---|
| 68627 | 36" | MILL | 6 |
| 68684 | 72" | MILL | 6 |
| 69816 | 36" | BRONZE | 6 |
| 69824 | 72" | BRONZE | 6 |

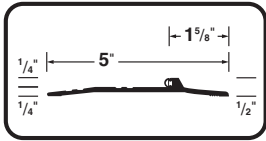

Panic Exit – Latch Track

TH040

1/2" X 5" panic exit.



| | | | |
|-------|-----|------|---|
| 68403 | 36" | MILL | 6 |
| 69791 | 72" | MILL | 6 |

ULTRA COMMERCIAL DOOR BOTTOMS & SWEEPS

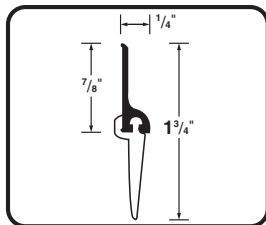

Door Sweeps

DB005

1-3/4" door sweep. Vinyl insert.

| | | | |
|-------|-----|------|---|
| 68601 | 36" | MILL | 6 |
|-------|-----|------|---|

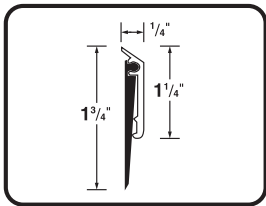

Commercial Grade Door Sweep

DB006

1-1/4" door sweep. EPDM rubber insert.



| | | | |
|-------|-----|--------|---|
| 68247 | 36" | MILL | 6 |
| 69604 | 48" | MILL | 6 |
| 68254 | 36" | BRONZE | 6 |
| 69609 | 48" | BRONZE | 6 |

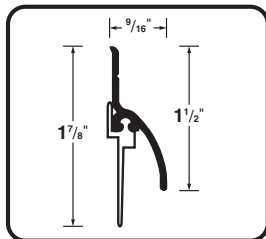

Door Sweeps w/Drip Caps

DB037

1-7/8" door sweep with drip cap. Vinyl insert.



| | | | |
|-------|-----|--------|---|
| 68726 | 36" | MILL | 6 |
| 68734 | 36" | BRONZE | 6 |

WEATHERSTRIP, THRESHOLDS & DOOR ACCESSORIES

M-D# DESCRIPTION COLOR PACK QTY

ULTRA COMMERCIAL DOOR BOTTOMS & SWEEPS

Door Bottoms

DB054

1-3/4" extended door shoe. Vinyl insert.



68593

36"

MILL/VINYL

3

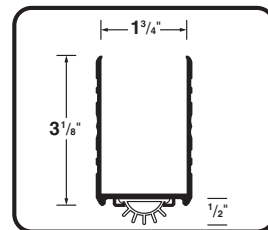

ULTRA COMMERCIAL WEATHERSTRIP/ASTRAGALS/SMOKESEALS

Silicone Smoke Seal Gasketing

WS108

Silicone gasketing. U.L. listed and tested to limit air and smoke infiltration. Not affected by mildew, fungus or UV light.



1/4" THICK X 1/2" WIDE

68510

20'

BROWN

6

68668

20'

BLACK

6

68676

20'

WHITE

6

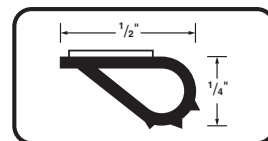

ULTRA RESIDENTIAL PREHUNG/MILLWORK – SILLS

Fixed Vinyl Sills – Inswing

TH397

1-1/8" x 5-3/4" fixed sill-rigid vinyl top.

78691

36"

ALUMINUM MILL

1/6

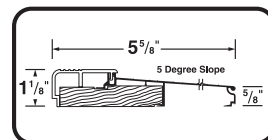

Fixed Aluminum & Hardwood Sills – Outswing Bumper

TH184

1" x 5-3/8" outswing sill. Foam insert.

78840

36"

MILL

6

78873

36"

BRONZE

6

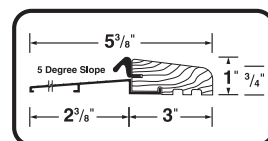

Adjustable Aluminum & Hardwood Sills – Inswing

TH393

1-1/8" x 4-9/16" aluminum & hardwood adjustable sill. Adjustment to 1-3/8" - slope 5 degrees.

76265

36"

MILL

1/6

76281

73"

MILL

6

77792

36"

BRONZE

6

77800

73"

BRONZE

6

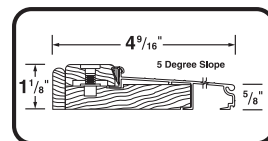

ULTRA RESIDENTIAL PREHUNG/MILLWORK – SILLS

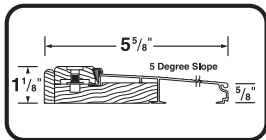

Adjustable Aluminum & Hardwood Sills – Inswing

TH394

1-1/8" x 5-5/8" aluminum & hardwood adjustable sill. Adjustment to 1-3/8" - slope 5 degrees.

| | | | |
|-------|-----|--------|-----|
| 78600 | 36" | MILL | 1/6 |
| 78618 | 73" | MILL | 6 |
| 78634 | 36" | BRONZE | 6 |

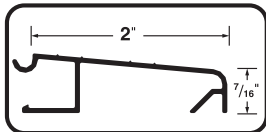

Inswing Extenders

TH200

2" aluminum sill extender (for TH394 and TH397 style sills).

| | | | |
|-------|-----|--------|---|
| 67106 | 36" | MILL | 3 |
| 67109 | 72" | MILL | 3 |
| 67107 | 36" | BRONZE | 3 |
| 67110 | 72" | BRONZE | 3 |

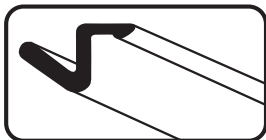

Kerf Weatherstrip

WS089

Vinyl clad foam. Recommended for commercial or residential use. Kerf installation.

| | | | |
|-------|-----|-------|----|
| 70056 | 96" | BROWN | 50 |
| 70068 | 96" | WHITE | 50 |

ULTRA RESIDENTIAL PREHUNG/MILLWORK – DOOR BOTTOMS & SWEEPS

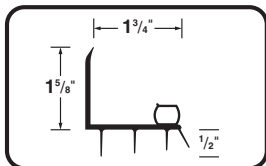

Door Bottoms

DB 347

Adjustable 1-3/4" door bottom (undersized 5/16" door size). PVC insert.

| | | | |
|-------|-----|-------|---|
| 78899 | 36" | BROWN | 6 |
| 78907 | 36" | WHITE | 6 |

M-D# DESCRIPTION COLOR PACK QTY

ULTRA RESIDENTIAL PREHUNG/MILLWORK – DOOR BOTTOMS & SWEEPS

Heavy Duty Door Sweep w/Vinyl Seal

DB038

2-1/4" door sweep. Vinyl insert.

| | | | |
|-------|-----|----------------|---|
| 69612 | 36" | MILL | 6 |
| 69620 | 48" | MILL | 6 |
| 69633 | 36" | BRONZE | 6 |
| 69638 | 48" | BRONZE | 6 |
| 69644 | 36" | WHITE | 6 |
| 69648 | 48" | WHITE | 6 |
| 69652 | 36" | BRITE-DIP GOLD | 6 |
| 25716 | 36" | SATIN NICKEL | 6 |
| 25718 | 48" | SATIN NICKEL | 6 |

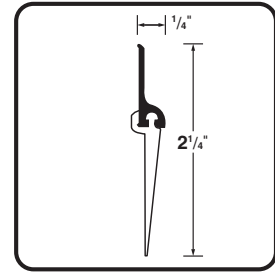

L-Shaped Door Bottom w/Drip Cap

DB001

1-3/8" or 1-3/4" L-shaped door shoe with drip. Vinyl insert.



| | | | |
|-------|-----|----------------|---|
| 81901 | 36" | MILL | 6 |
| 69500 | 48" | MILL | 6 |
| 81927 | 36" | BRONZE | 6 |
| 69505 | 48" | BRONZE | 6 |
| 81935 | 36" | WHITE | 6 |
| 69514 | 48" | WHITE | 6 |
| 81919 | 36" | BRITE-DIP GOLD | 6 |
| 69521 | 48" | BRITE-DIP GOLD | 6 |
| 25706 | 36" | SATIN NICKEL | 6 |
| 25708 | 48" | SATIN NICKEL | 6 |

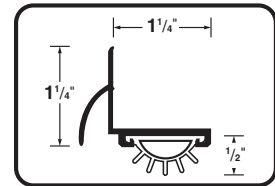

U-Shaped Door Bottom w/Drip Cap

DB002

1-3/8" U-shaped door shoe with rain drip. Vinyl Insert.



| | | | |
|-------|-----|--------|---|
| 80622 | 36" | MILL | 6 |
| 80630 | 36" | BRONZE | 6 |

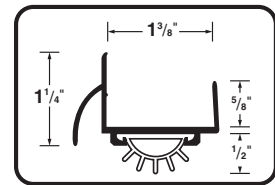

ULTRA RESIDENTIAL PREHUNG/MILLWORK – DOOR BOTTOMS & SWEEPS

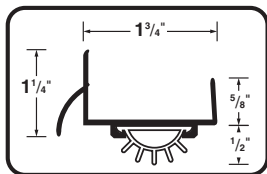

DB003

1-3/4" U-shaped door shoe with rain drip. Vinyl insert.



| | | | |
|-------|-----|----------------|---|
| 69539 | 36" | MILL | 6 |
| 69547 | 48" | MILL | 6 |
| 69554 | 36" | BRONZE | 6 |
| 69562 | 48" | BRONZE | 6 |
| 69570 | 36" | WHITE | 6 |
| 69588 | 48" | WHITE | 6 |
| 69591 | 36" | BRITE-DIP GOLD | 6 |
| 69596 | 48" | BRITE-DIP GOLD | 6 |
| 25710 | 36" | SATIN NICKEL | 6 |
| 25714 | 48" | SATIN NICKEL | 6 |

Vinyl Replacement Insert For Door Bottoms

| | | | | |
|-------|-----|--|-------|----|
| 25756 | 36" | FOR L-SHAPE AND U-SHAPED ALUMINUM DOOR BOTTOMS | BLACK | 10 |
|-------|-----|--|-------|----|

ULTRA RESIDENTIAL THRESHOLDS

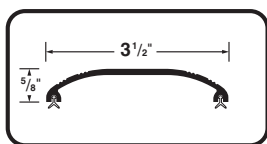

Low Dome Top Threshold

TH008

5/8" X 3-1/2" all purpose.



| | | | |
|-------|-----|----------------|---|
| 79996 | 36" | MILL | 6 |
| 79962 | 72" | MILL | 6 |
| 80374 | 36" | BRONZE | 6 |
| 79988 | 72" | BRONZE | 6 |
| 80465 | 36" | WHITE | 6 |
| 81661 | 72" | WHITE | 6 |
| 80317 | 36" | BRITE-DIP GOLD | 6 |
| 79970 | 72" | BRITE-DIP GOLD | 6 |
| 25734 | 36" | SATIN NICKEL | 6 |
| 25736 | 72" | SATIN NICKEL | 6 |

M-D# DESCRIPTION COLOR PACK QTY

ULTRA RESIDENTIAL THRESHOLDS

High Dome Top Threshold

TH009

1" X 4" all purpose.



| | | | |
|-------|-----|----------------|---|
| 81679 | 36" | MILL | 6 |
| 81687 | 72" | MILL | 6 |
| 81810 | 36" | BRONZE | 6 |
| 70077 | 72" | BRONZE | 6 |
| 81828 | 36" | WHITE | 6 |
| 69737 | 72" | WHITE | 6 |
| 81697 | 36" | BRITE-DIP GOLD | 6 |
| 81703 | 72" | BRITE-DIP GOLD | 6 |
| 25740 | 36" | SATIN NICKEL | 6 |
| 25742 | 72" | SATIN NICKEL | 6 |

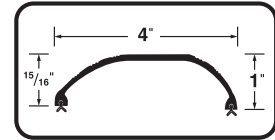

Extra High Dome Top Threshold

TH010

1-1/4" X 4" all purpose.



| | | | |
|-------|-----|--------|---|
| 69733 | 36" | MILL | 6 |
| 69745 | 72" | MILL | 6 |
| 69749 | 36" | BRONZE | 6 |
| 69752 | 72" | BRONZE | 6 |

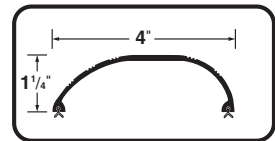

Bumper Threshold

TH153

1-1/4" X 4" all purpose.



| | | | |
|-------|-----|--------|---|
| 69694 | 36" | MILL | 6 |
| 69698 | 72" | MILL | 6 |
| 69703 | 36" | BRONZE | 6 |
| 69709 | 72" | BRONZE | 6 |

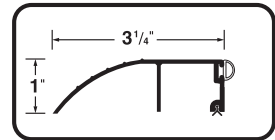

ULTRA RESIDENTIAL THRESHOLDS

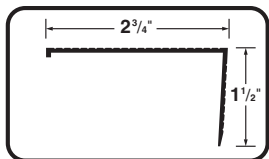

Sill Nosing

TH026

2-3/4" X 1-1/2" Sill Nosing.

| | | | |
|-------|-----|----------------|---|
| 81869 | 36" | MILL | 6 |
| 81877 | 72" | MILL | 6 |
| 77891 | 36" | BRONZE | 6 |
| 81893 | 72" | BRONZE | 6 |
| 77883 | 36" | WHITE | 6 |
| 69839 | 72" | WHITE | 6 |
| 77909 | 36" | BRITE GOLD | 6 |
| 81885 | 72" | BRITE-DIP GOLD | 6 |
| 25744 | 36" | SATIN NICKEL | 6 |
| 25748 | 72" | SATIN NICKEL | 6 |

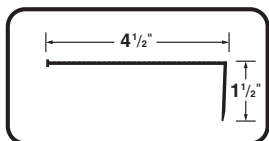

Sill Nosing

TH083

4-1/2" X 1-1/2" Sill Nosing.

| | | | |
|-------|-----|----------------|---|
| 69848 | 36" | MILL | 6 |
| 69844 | 72" | MILL | 6 |
| 69851 | 36" | BRONZE | 6 |
| 69858 | 72" | BRONZE | 6 |
| 69860 | 36" | WHITE | 6 |
| 69867 | 72" | WHITE | 6 |
| 69875 | 36" | BRITE-DIP GOLD | 6 |
| 69871 | 72" | BRITE-DIP GOLD | 6 |
| 25750 | 36" | SATIN NICKEL | 6 |
| 25752 | 72" | SATIN NICKEL | 6 |

ULTRA RESIDENTIAL - WEATHERSTRIP/ASTRAGALS

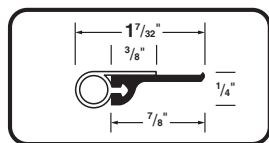

Flat Profile Door Jamb Weatherstrip Kits

WS003

1/4" x 7/8" jamb strip.



| | | | |
|-------|-----------|----------------|----|
| 68429 | 36" X 84" | MILL | 10 |
| 69909 | 72" X 84" | MILL | 10 |
| 69901 | 72" X 96" | MILL | 10 |
| 68437 | 36" X 84" | BRONZE | 10 |
| 69911 | 72" X 84" | BRONZE | 10 |
| 69918 | 72" X 96" | BRONZE | 10 |
| 69923 | 36" X 84" | WHITE | 10 |
| 69927 | 72" X 84" | WHITE | 10 |
| 69938 | 72" X 96" | WHITE | 10 |
| 69935 | 36" X 84" | BRITE-DIP GOLD | 10 |
| 69940 | 72" X 84" | BRITE-DIP GOLD | 10 |
| 69945 | 72" X 96" | BRITE-DIP GOLD | 10 |
| 25730 | 36" X 84" | SATIN NICKEL | 10 |
| 25732 | 72" X 96" | SATIN NICKEL | 10 |

WEATHERSTRIP, THRESHOLDS & DOOR ACCESSORIES

M-D# DESCRIPTION COLOR PACK QTY

ULTRA RESIDENTIAL – WEATHERSTRIP/ASTRAGALS

Wedge Style Door Jamb Weatherstrip Kits

WS268

Wedge weatherstrip. 3/8" thick vinyl bulb.



77768 36" X 80" FLAP MILL 10

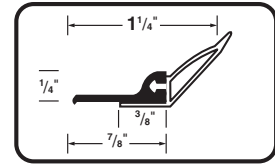

T-Astragal

WS009

3/4" x 7/8" astragal. Vinyl insert.

| | | | |
|-------|-----|----------------|---|
| 69956 | 84" | MILL | 6 |
| 69969 | 84" | BRONZE | 6 |
| 69962 | 84" | WHITE | 6 |
| 69974 | 84" | BRITE-DIP GOLD | 6 |
| 25722 | 84" | SATIN NICKEL | 6 |
| 25724 | 96" | SATIN NICKEL | 6 |

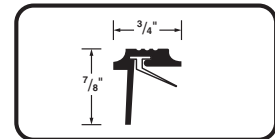

T-Astragal

WS011

7/8" x 1-5/16" astragal. Vinyl insert.

| | | | |
|-------|-----|-------|---|
| 68544 | 84" | MILL | 3 |
| 69989 | 84" | WHITE | 3 |

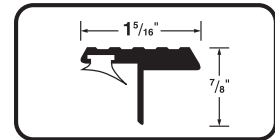

Aluminum Locking Slide Bolt Combination Astragal

WS059

Surface mount astragal. Vinyl insert for a weathertight seal. Locking bolt for security. 7/16"-1/2" clearance required between doors.

| | | | |
|-------|-----|----------------|---|
| 01560 | 80" | CLEAR ANODIZED | 2 |
| 01586 | 80" | BRONZE | 2 |
| 70023 | 96" | BRONZE | 2 |
| 87791 | 80" | WHITE | 2 |
| 70031 | 96" | WHITE | 2 |
| 87809 | 80" | BRITE-DIP GOLD | 2 |
| 25726 | 80" | SATIN NICKEL | 2 |

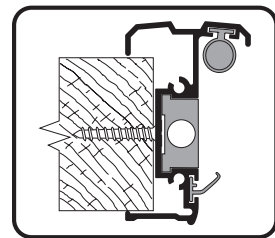

Threshold, Door Bottoms Sweeps and Door Jamb Assortments

See Assortment Catalog for Assortment Contents and Costs

- 09417472 2 FT ULTRA RESIDENTIAL THRESHOLD & DOOR BOTTOM ASSORTMENT
- 09417473 2 FT ULTRA JAMB-UP / INSERTS / DOOR BOTTOMS ASSORTMENT
- 09417474 4 FT ULTRA THRESHOLDS / SWEEPS / DOOR BOTTOMS ASSORTMENT
- 09417475 8 FT ULTRA THRESHOLD / DOOR BOTTOM ASSORTMENT

DOOR ACCESSORIES

Screen Door Grilles

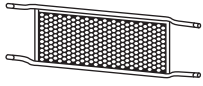

PUSH GRILLES

| | | | |
|-------|----------|------|---|
| 33167 | 8" X 32" | MILL | 3 |
| 33209 | 8" X 36" | MILL | 3 |

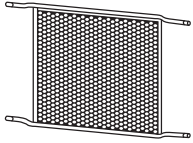

DOOR GRILLES

| | | | |
|-------|-----------|--------|---|
| 33282 | 19" X 32" | MILL | 3 |
| 33308 | 19" X 32" | WHITE | 3 |
| 33324 | 19" X 32" | BRONZE | 3 |
| 33340 | 19" X 36" | MILL | 3 |
| 33365 | 19" X 36" | WHITE | 3 |
| 33381 | 19" X 36" | BRONZE | 3 |

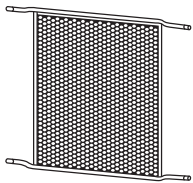

PATIO GRILLES

| | | | |
|-------|-----------|--------|---|
| 33605 | 30" X 36" | MILL | 3 |
| 33118 | 30" X 36" | WHITE | 3 |
| 33621 | 30" X 36" | BRONZE | 3 |

Door Grille Assortment

See Assortment Catalog for Assortment Contents and Costs

09945346 DOOR GRILLE ASSORTMENT

MAIL SLOTS

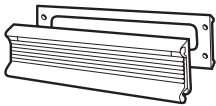

Mail Slots

ALUMINUM MAIL SLOTS – FLAP & BACK PLATE

| | | | |
|-------|-----|------------------------|---|
| 28472 | 10" | SILVER | 3 |
| 28787 | 10" | BRITE BRASS (ALUMINUM) | 3 |
| 28506 | 13" | SILVER | 3 |
| 28795 | 13" | BRITE BRASS (ALUMINUM) | 3 |

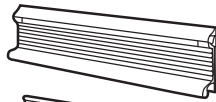

ALUMINUM MAIL SLOTS – FLAP & HOOD

| | | | |
|-------|-----|------------------------|---|
| 28555 | 13" | SILVER | 3 |
| 28571 | 13" | BLACK | 3 |
| 28803 | 13" | BRITE BRASS (ALUMINUM) | 3 |

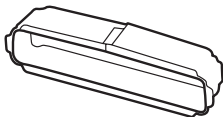

Mail Slot Liners

| | | | |
|-------|---------------------------------|--|---|
| 28639 | FOR 10" MAIL SLOT & 1-3/4" DOOR | | 6 |
| 28654 | FOR 13" MAIL SLOT & 1-3/4" DOOR | | 6 |

SMARTTOOL™



SMARTTOOL™ LEVELS & MODULES

Go to smarttoollevels.com for additional information

SMARTTOOL™ THE DIGITAL LEVEL LEADER FOR OVER 20 YEARS

SmartTool™ Levels and Modules

Digitally displays all angles (not just level and plumb) in degrees, % slope or rise/run. Runs for over five-hundred hours on included 9 volt battery. SmartTool beeps at any angle you choose. Custom sensor is manufactured in the USA for unmatched accuracy.



SmartTool™ Digital Levels (Domestic) Inches Per Foot

| | | | |
|-------|--|-----|---|
| 92346 | BUILDER'S ANGLE SENSOR MODULE (IN/ FT) W/CARRYING CASE | | 1 |
| 92288 | 24" SMARTTOOL DIGITAL LEVEL (IN/FT) | | 1 |
| 92379 | 24" SMARTTOOL DIGITAL LEVEL (IN/FT) W/ CARRYING CASE | NEW | 1 |
| 92296 | 48" SMARTTOOL DIGITAL LEVEL (IN/FT) | | 1 |
| 92325 | 48" SMARTTOOL DIGITAL LEVEL (IN/FT) W/ CARRYING CASE | NEW | 1 |
| 92395 | MAGNETIC BRACKET (USE WITH MODULE) | | 1 |

SmartTool™ Digital Levels (International) Millimeters Per Meter

| | | | |
|-------|---|-----|---|
| 93969 | BUILDER'S ANGLE SENSOR MODULE (MM/M) W/CARRYING CASE | NEW | 1 |
| 93967 | 60 CM SMARTTOOL DIGITAL LEVEL (MM/M) | NEW | 1 |
| 94005 | 60 CM SMARTTOOL DIGITAL LEVEL (MM/M) W/CARRYING CASE | NEW | 1 |
| 93968 | 120 CM SMARTTOOL DIGITAL LEVEL (MM/M) | NEW | 1 |
| 94010 | 120 CM SMARTTOOL DIGITAL LEVEL (MM/M) W/CARRYING CASE | NEW | 1 |
| 92395 | MAGNETIC BRACKET (USE WITH MODULE) | | 1 |

ADA Digital Slope Walker™

Measures slopes, cross slopes, sidewalks, and curb height in handicap accessible areas. 16" SmartTool with two pivoting feet set at 12" spacing to provide stable readings. Designed to save your back and knees. 1-1/2" clearance over debris at construction sites. Designed for ADA contractors and inspectors.

| | | | |
|-------|--|-----|---|
| 93975 | SMARTTOOL ADA DIGITAL SLOPE WALKER W/CARRYING CASE | NEW | 1 |
|-------|--|-----|---|

SmartLaser™

Combines high accuracy (0.05°) SmartTool™ electronic module with laser technology. A professional tool that will extend a line at any angle. Saves time and labor. Includes soft sided carrying case.

| | | | |
|-------|---|--|---|
| 92437 | SMARTLASER (SMARTTOOL™ W/LASER) IN / FT | | 1 |
|-------|---|--|---|

SmartTool™ Carrying Cases

Durable SmartTool™ carrying cases are padded for tool protection. Builder's Angle Sensor Module Carrying Case features a belt clip for easy access.

| | | | |
|-------|---|-----|---|
| 92910 | BUILDER'S ANGLE SENSOR MODULE CARRYING CASE | NEW | 1 |
| 92908 | 24" / 60CM PADDED VINYL CASE | | 1 |
| 92924 | 48" / 120CM PADDED VINYL CASE | | 1 |

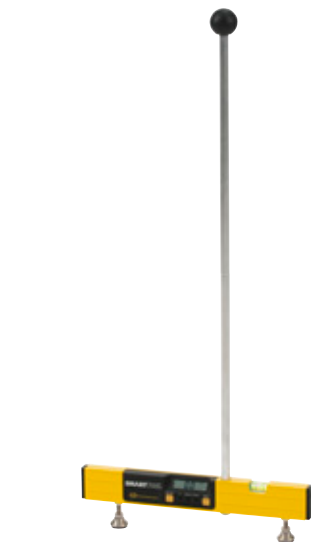

FLOORING INSTALLATION TOOLS



M-D#

DESCRIPTION

COLOR

PACK QTY

TILE INSTALLATION TOOLS

Fusion™ Series Tools

Fusion™ Wet Saws – Portable and ridged wet saws for cutting tile, stone, granite & marble

48190 7" FUSION™ WET SAW
3/4 HP with patented ridged steel cage frame 1

48191 7" FUSION™ WET SAW
1 HP with cast aluminum cutting table and patented steel cage frame NEW 1

48088 7" FUSION™ WET SAW REPLACEMENT BLADE
Wet-cutting continuous rim type blade - designed to provide long life and chip free cutting. 5/8" arbor fits #48190 and #48191 Fusion™ Wet Saws. NEW 1

49046 4" FUSION™ MARBLE/TILE SAW
Includes laser guide and adjustable steel base for bevel cuts 1

Fusion™ Mixer & Mixing Paddles

48152 FUSION™ MIXER
The ultimate mixer for mortars, grouts and other viscous materials. Thumb dial for complete RPM control. 1

48154 FUSION™ MIXER REPLACEMENT PADDLE
Replacement paddle for Fusion™ Mixer. Threaded shaft creates a positive connection. 6

49058 DELUXE MIXER PADDLE
Fits a standard 1/2" drive drill. Mixes a variety of materials. 3

Tile Cutters & Accessories

Manual tile cutters for repetitive cutting. Selection covers first-time users to seasoned professionals.

49194 14" TILE CUTTER
Economy cutter for general purpose use NEW 4

49195 20" TILE CUTTER
General purpose cutter for cutting up to 14" x 14" tile (diagonally) NEW 4

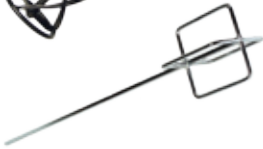

| M-D# | DESCRIPTION | COLOR | PACK QTY |
|------|-------------|-------|----------|
|------|-------------|-------|----------|

TILE INSTALLATION TOOLS

Tile Cutters & Accessories (continued)

49047 20" TILE CUTTER (PRO)
Ball bearing carriage for smooth operation. Includes handy carrying bag.

1



49905 24" TILE CUTTER (PRO)
Heavy-duty extruded aluminum base. Includes handy carrying bag.

1



49096 1/2" CARBIDE CUTTING WHEEL
For use with #49194 (14" Tile Cutter)

6



49078 7/8" TITANIUM COATED CARBIDE CUTTING WHEEL
For use with #49195 (20" Tile Cutter)

6



48158 7/8" TITANIUM COATED CARBIDE CUTTING WHEEL (PRO)
For use with #49047 & #49905 (20" & 24" Tile Cutters)

6

Layout Tools

Tools assist in determining starting point of your job, creating straight tile lines and allowing cut tiles to fall at the edges of a room.

49887 LASER CHALK LINE (PRO)
Eliminate the need for chalk with this versatile laser line

4



00760 CONTRACTOR CHALK REEL
100' Tuff Line™ Braided Poly/Cotton line for strength

6



00687 100' CHALK REPLACEMENT REEL LINE
Replacement Poly/Cotton Line for M-D #00760

6



M-D#

DESCRIPTION

COLOR

PACK QTY

TILE INSTALLATION TOOLS

Scrapers

Heavy-duty scrapers remove old floor or wall coverings. High carbon replaceable steel blades.

49847 4" ADJUSTABLE FLOOR & WALL SCRAPER (PRO) 3
Removes adhesive and wall coverings. Handle extends to 24".

49977 4" FLOOR & WALL SCRAPER REPLACEMENT BLADES 6
Replacement blades for #49847, #48114, and #48160

49126 7" HEAVY DUTY FLOOR SCRAPER 3
Provides increased leverage when removing old flooring

49084 7" FLOOR SCRAPER REPLACEMENT BLADE 6
Replacement blade for #49126

Hand Tools

Variety of saws and cutting tools when making irregular cuts or holes in tile/backer board.

49054 TILE NIPPERS 6
Tungsten tipped - great for irregular cuts

49943 COMPOUND TILE NIPPERS (PRO) 6
Twice the power of conventional nippers

49062 TILE PLIERS / HAND CUTTER 6
Only cutting tool you need for small format tile. Great when tiling around toilets.



| M-D# | DESCRIPTION | COLOR | PACK QTY |
|------|-------------|-------|----------|
|------|-------------|-------|----------|

TILE INSTALLATION TOOLS

Hand Tools (continued)

49074 COPING SAW
Clean, controllable cutting action for cutting curves in tile

6



49094 6" ROD SAW BLADE
Replacement blade for #49074

6



49070 BACKER BOARD SCORING KNIFE
Dust free - scores all types of cement based backer boards

6



49985 CONTOUR GAUGE
No-rust plastic - creates an instant template for marking precise cuts

6



49144 CHINA MARKERS
Installer's choice – great way to mark tile, marble and granite before making your cut. Easy clean up.

6



Economy Trowels

Economy grade trowels in common sizes for the DIY'er.

49100 ECONOMY SQUARE NOTCH 1/4" X 1/4" X 1/4"

12

49102 ECONOMY SQUARE NOTCH 1/4" X 3/8" X 1/4"

12

49104 ECONOMY SQUARE NOTCH 1/2" X 1/2" X 1/2"

12

20064 ECONOMY SQUARE NOTCH 1/16" X 1/16" X 1/16"

12

49108 ECONOMY V NOTCH 3/16" X 5/32"

12

20065 ECONOMY V NOTCH 1/8" X 1/8" X 1/16"

12

20063 ECONOMY U NOTCH 1/16" X 1/32" X 1/32"

12

30004 ECONOMY FLAT V NOTCH 3/32" X 3/32" X 3/32"

12



TILE INSTALLATION TOOLS

Premium Trowels

Comfortable TPR handle - Designed for contractors.



Notch Size Etched on Blade



TPR Handle

| | | |
|-------|--|---|
| 49110 | PREMIUM SQUARE NOTCH 1/4" X 1/4" X 1/4" | 6 |
| 49112 | PREMIUM SQUARE NOTCH 1/4" X 3/8" X 1/4" | 6 |
| 49038 | PREMIUM SQUARE NOTCH 1/2" X 1/2" X 1/2" | 6 |
| 20045 | PREMIUM SQUARE NOTCH 1/4" X 1/8" X 1/4" | 6 |
| 20056 | PREMIUM SQUARE NOTCH 1/16" X 1/16" X 1/16" | 6 |
| 20098 | PREMIUM SQUARE NOTCH (LH) 1/16" X 1/16" X 1/16" | 6 |
| 20057 | PREMIUM SQUARE NOTCH 1/8" X 1/8" X 1/8" | 6 |
| 20058 | PREMIUM SQUARE NOTCH 3/16" X 3/16" X 3/16" | 6 |
| 20048 | PREMIUM SQUARE NOTCH (14") 1/16" X 1/16" X 1/16" | 6 |
| 20044 | PREMIUM U NOTCH 1/16" X 1/32" X 5/64" | 6 |
| 20051 | PREMIUM U NOTCH 1/16" X 1/32" X 1/32" | 6 |
| 20097 | PREMIUM U NOTCH (LH) 1/16" X 1/32" X 1/32" | 6 |
| 20052 | PREMIUM U NOTCH 1/16" X 1/16" X 3/32" | 6 |
| 20053 | PREMIUM U NOTCH 1/8" X 1/8" X 1/16" | 6 |
| 20054 | PREMIUM U NOTCH 1/8" X 3/16" X 1/8" | 6 |
| 20055 | PREMIUM U NOTCH 1/8" X 1/8" X 1/8" | 6 |
| 20047 | PREMIUM U NOTCH (14") 1/16" X 1/32" X 1/32" | 6 |
| 49116 | PREMIUM V NOTCH 1/4" X 3/16" | 6 |
| 20059 | PREMIUM V NOTCH 3/16" X 5/32" | 6 |
| 20060 | PREMIUM FLAT V NOTCH 3/32" X 3/32" X 3/32" | 6 |
| 20061 | PREMIUM FLAT V NOTCH 1/8" X 1/8" X 1/16" | 6 |
| 20099 | PREMIUM FLAT V NOTCH (LH) 1/8" X 1/8" X 1/16" | 6 |
| 30000 | PREMIUM FLAT V NOTCH 3/16" X 1/4" X 5/16" | 6 |
| 20049 | PREMIUM FLAT V NOTCH (14") 1/8" X 1/8" X 1/16" | 6 |
| 20062 | PREMIUM FLAT TROWEL 4" X 14" | 6 |
| 20050 | PREMIUM FLAT POOL FINISHING 4" X 16" | 6 |

Professional Trowels

Professional grade Stainless Steel trowels. Easy to clean and rust resistant. Ergonomic handle.

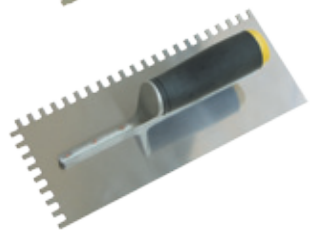
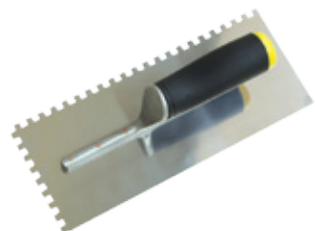

| | | |
|-------|-------------------------------------|---|
| 49819 | PRO SQUARE NOTCH 1/4" X 1/4" X 1/4" | 6 |
| 49821 | PRO SQUARE NOTCH 1/4" X 3/8" X 1/4" | 6 |
| 49807 | PRO SQUARE NOTCH 1/2" X 1/2" X 1/2" | 6 |
| 49823 | PRO V NOTCH 3/16" X 5/32" | 6 |

| M-D# | DESCRIPTION | COLOR | PACK QTY |
|------|-------------|-------|----------|
|------|-------------|-------|----------|

TILE INSTALLATION TOOLS

Miscellaneous Trowels

Specialized trowels to make the job faster and for getting into tight spaces

| | | | |
|-------|---------------|--|---|
| 49120 | MARGIN TROWEL | | 6 |
|-------|---------------|--|---|



| | | | |
|-------|-----------------|--|---|
| 49124 | POINTING TROWEL | | 6 |
|-------|-----------------|--|---|



Spacers

For accurate tile alignment in a range of sizes.

| | | | |
|-------|---------------|---------|----|
| 49162 | 1/16 SPACERS | 250/BAG | 12 |
| 49168 | 1/8" SPACERS | 200/BAG | 12 |
| 49164 | 3/16" SPACERS | 150/BAG | 12 |
| 49160 | 1/4" SPACERS | 100/BAG | 12 |
| 49166 | 3/8" SPACERS | 50/BAG | 12 |



Grout Floats

Multiple grouting floats for job specific applications. Include ergonomic TPR handles.

| | | | |
|-------|---|--|---|
| 49118 | ECONOMY GROUT FLOAT Lightweight molded grout float | | 6 |
|-------|---|--|---|



| | | | |
|-------|--|--|---|
| 49827 | GUM RUBBER GROUT FLOAT (PRO) Lightweight float - edges are beveled and two front corners rounded for spreading grout evenly | | 6 |
|-------|--|--|---|



| | | | |
|-------|---|--|---|
| 49829 | EPOXY GROUT FLOAT (PRO) Dense green rubber pad used with tough-to-spread epoxy and modified grouts | | 6 |
|-------|---|--|---|



| | | | |
|-------|---|--|---|
| 49837 | MARGIN FLOAT (PRO) Ideal for spreading grout around backsplashes and toe kicks | | 6 |
|-------|---|--|---|



M-D#

DESCRIPTION

COLOR

PACK QTY

TILE INSTALLATION TOOLS

Grouting Supplies

Various grouting tools for spreading or removing grout.



48155 M-D GROUT MONSTER SAW 6
Use to remove damaged grout prior to repair. Vibrating carbide grit-edge blade makes grout removal effortless.



49066 TILE GROUT SAW – HEAVY DUTY 6
For use in repairing or replacing damaged grout



49090 TILE GROUT SAW REPLACEMENT BLADES 6
Replacement blades for #49066



49136 GROUT BAG 6
For easy application of grout on detailed installations



49174 GROUT SPREADER 6
Lightweight reusable spreader



49146 TILE AND GROUT BRUSH 6
Quality brush effectively scrubs dirty grout lines



49142 GROUTING GLOVES 6
Protects hands from harsh chemicals

M-D# DESCRIPTION COLOR PACK QTY

TILE INSTALLATION TOOLS

Grouting Supplies (continued)

49134 SEAL 'O WHEEL
Easy applicator bottle for use with sealer to protect new and restore old grout

6



49152 SPONGE
For clean-up of grout haze and hardened grout. Maximum holding power.

10



49156 SCRUBBING SPONGE
Double texture – grout sponge on one side and scrubbing sponge on the other

10



Tile Installation Bucket

Complete with all the essential professional grade items needed to install floor tile.

49834 CERAMIC FLOOR TILE INSTALLATION BUCKET KIT
Kit includes a tile installation trowel, tile nippers, grout float, sponge, gloves, tile spacers and a sturdy reusable 2.5 gallon plastic bucket

NEW

4



Folding Saw Horse

Made from galvanized steel. Heavy duty load capacity.

27094 28-1/2" HIGH X 31" WIDE

1



Tile Installation Tools Assortments

See Assortment Catalog for Assortment Contents and Costs

- 09417084 4 FT TILE INSTALLATION TOOL ASSORTMENT
- 09417370 4 FT PRO TILE INSTALLATION TOOL ASSORTMENT

M-D#

DESCRIPTION

COLOR

PACK QTY

CARPET INSTALLATION TOOLS



Knee Kickers

Stretches carpet over tack strip to ensure carpet fits tight and lies flat.

60000 PROFESSIONAL KNEE KICKER
Adjustable pin depth and handle. Includes carrying bag. 1



48113 ADJUSTABLE KNEE KICKER
Adjustable pin depth allows for use with any carpet. Handle adjusts from 19" to 24". 1



Seam Rollers

Used to roll soft flooring goods, carpet seams and wall coverings to strengthen adhesive bond.

48076 SMOOTH SEAM ROLLER – 3"
Improves seam strength by forcing adhesive into carpet backing 6



48078 SMOOTH SEAM ROLLER – 6"
Improves seam strength by forcing adhesive into carpet backing 6



48080 STAR WHEEL CARPET SEAM ROLLER – 3"
Star wheel design blends carpet yarn at seam 6



48082 STAR WHEEL CARPET SEAM ROLLER – 6"
Star wheel design blends carpet yarn at seam 6



48084 EXTENDABLE WALL AND FLOOR ROLLER
Raised handle provides increased leverage and control 3

| M-D# | DESCRIPTION | COLOR | PACK QTY |
|------|-------------|-------|----------|
|------|-------------|-------|----------|

CARPET INSTALLATION TOOLS

Cutters

Cut all types of carpet for any installation method.

48098 CUSHION BACK CUTTER 6
Locking dual blades allow for close cuts on either side of the row



48100 LOOP PILE CUTTER 6
Adjustable throat opening for precise cuts



Shears

48104 7" DUCKBILL NAPPING SHEARS 6
Offset handle allows level cutting



Tucking Tools

Will tuck and set carpet into stair crevices and tack strip.

48106 PLASTIC TUCKING TOOL – 3-1/2" 6
For tucking around delicate materials, baseboards, tile, and plumbing fixtures



48108 STAIR TOOL – 3-1/2" 6
Heavy duty tucking tool for setting carpet into stair crevices and tack strip



Knives

Three types of knives for cutting a variety of materials including carpet, carpet pad, vinyl tile, vinyl sheet goods, linoleum, wallpaper etc.

48086 PRO UTILITY 6
Internal blade storage and slip resistant grip



48092 LINOLEUM KNIFE 6
Excellent tucking tool with high carbon steel blade



48094 PRO RAZOR KNIFE 6
Cuts hard to reach areas. Thumb screw for easy blade exchange.



48090 LED KNIFE 6
Quick blade change feature, takes standard utility blades. Has built in light that allows for precise cuts in dimly lit areas.



M-D#

DESCRIPTION

COLOR

PACK QTY

CARPET INSTALLATION TOOLS

Scrapers

Ideal for scraping floors, walls and countertops.

48114 4" SCRAPER WITH 12" HANDLE
Extra durable blade holder with three tightening screws 3

48160 4" SCRAPER WITH 18" HANDLE
Extra durable blade holder with three tightening screws 6

49977 4" FLOOR & WALL SCRAPER REPLACEMENT BLADES
Replacement blades for item #'s 49847, 48114, 48160 6

Chrome Rollers

48194 75 POUND HARD CHROME ROLLER
Corrosion resistant hard chrome plated solid 5" steel rollers. Removable handle for convenient storage and a protective padded cover. 1

48195 100 POUND HARD CHROME ROLLER
Corrosion resistant hard chrome plated solid 5" steel rollers. Removable handle for convenient storage and a protective padded cover. 1

Miscellaneous Carpet Tools

48110 STAPLE HAMMER
Ideal for stapling pad. Well balanced for easy use. 6

48120 ROW RUNNER
Dual heads for use on cut pile or loop pile carpet 6



FLOORING PRODUCTS

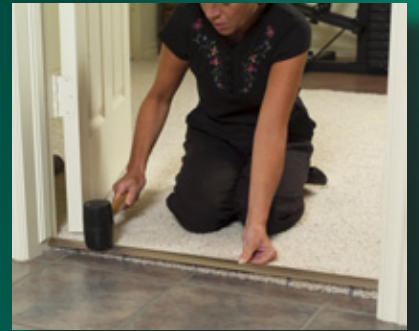

ALUMINUM FLOOR & CARPET TRIM



MultiFloor Transitions with Hidden Fasteners

Adjust to varying floor heights for easy DIY installation! Can be positioned after hard surface floors and adjoining floors have been installed. Hidden fasteners for safety and better appearance.

| | | | |
|-------|-----|--------|---|
| 46131 | 36" | SILVER | 3 |
| 46133 | 72" | SILVER | 3 |
| 46137 | 36" | GOLD | 3 |
| 46139 | 72" | GOLD | 3 |
| 43811 | 36" | PEWTER | 3 |
| 43813 | 72" | PEWTER | 3 |



MultiFloor Transitions with Hidden Fasteners – MetalDecor™ Finish

Aluminum MultiFloor Transitions with the look of finished hardwood (MetalDecor™)

| | | | |
|-------|-----|--------|---|
| 46141 | 36" | OAK | 3 |
| 46145 | 72" | OAK | 3 |
| 46147 | 36" | CHERRY | 3 |
| 46149 | 72" | CHERRY | 3 |
| 46240 | 36" | BEECH | 3 |
| 46244 | 72" | BEECH | 3 |

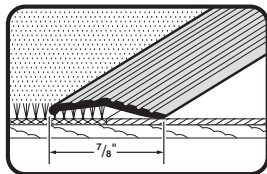

Carpet Trim

FLUTED

| | | | | |
|-------|------------|-------------|-------------|----|
| 78006 | 7/8" X 36" | SCREW NAILS | SILVER | 6 |
| 78089 | 7/8" X 72" | SCREW NAILS | SILVER | 6 |
| 79004 | 7/8" X 36" | SCREW NAILS | SATIN BRASS | 6 |
| 79087 | 7/8" X 72" | SCREW NAILS | SATIN BRASS | 6 |
| 43748 | 7/8" X 96" | BULK | SATIN BRASS | 12 |

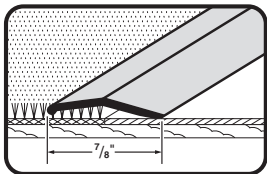

SMOOTH

| | | | | |
|-------|------------|-------------|----------|---|
| 66001 | 7/8" X 36" | SCREW NAILS | POLISHED | 6 |
| 66217 | 7/8" X 72" | SCREW NAILS | POLISHED | 6 |

M-D# DESCRIPTION COLOR PACK QTY

ALUMINUM FLOOR & CARPET TRIM

Carpet Trim – Wide

METALDECOR™ FINISH

Durable aluminum transitions with the look of finished hardwood. Matching fasteners.

| | | | | |
|-------|--------------|-------------|--------|---|
| 40120 | 1-3/8" X 36" | SCREW NAILS | OAK | 6 |
| 40122 | 1-3/8" X 72" | SCREW NAILS | OAK | 6 |
| 40124 | 1-3/8" X 36" | SCREW NAILS | CHERRY | 6 |
| 40126 | 1-3/8" X 72" | SCREW NAILS | CHERRY | 6 |



FLUTED

| | | | | |
|-------|--------------|-------------|-------------|----|
| 78071 | 1-3/8" X 36" | SCREW NAILS | SILVER | 6 |
| 78154 | 1-3/8" X 72" | SCREW NAILS | SILVER | 6 |
| 43712 | 1-3/8" X 96" | BULK | SILVER | 12 |
| 79079 | 1-3/8" X 36" | SCREW NAILS | SATIN BRASS | 6 |
| 79152 | 1-3/8" X 72" | SCREW NAILS | SATIN BRASS | 6 |
| 43714 | 1-3/8" X 96" | BULK | SATIN BRASS | 12 |
| 43854 | 1-3/8" X 36" | SCREWS | PEWTER | 6 |
| 43856 | 1-3/8" X 72" | SCREWS | PEWTER | 6 |
| 43928 | 1-3/8" X 96" | BULK | PEWTER | 12 |
| 74187 | 1-3/8" X 36" | SCREW NAILS | ALMOND | 6 |
| 74336 | 1-3/8" X 72" | SCREW NAILS | ALMOND | 6 |

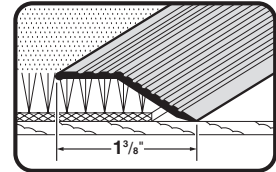

SMOOTH

| | | | | |
|-------|--------------|-------------|-------------|---|
| 45907 | 1-3/8" X 36" | SCREW NAILS | CHARCOAL | 6 |
| 45909 | 1-3/8" X 72" | SCREW NAILS | CHARCOAL | 6 |
| 66092 | 1-3/8" X 36" | SCREW NAILS | POLISHED | 6 |
| 66472 | 1-3/8" X 72" | SCREW NAILS | POLISHED | 6 |
| 67439 | 1-3/8" X 96" | SCREW NAILS | POLISHED | 6 |
| 72074 | 1-3/8" X 36" | SCREW NAILS | SATIN BRASS | 6 |
| 72256 | 1-3/8" X 72" | SCREW NAILS | SATIN BRASS | 6 |

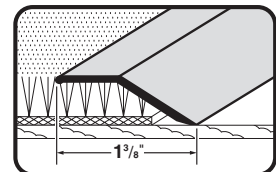

Carpet Trim – Wide

HAMMERED

| | | | | |
|-------|--------------|------|-------------|----|
| 43716 | 1-3/8" X 96" | BULK | SILVER | 6 |
| 43718 | 1-3/8" X 96" | BULK | SATIN BRASS | 12 |

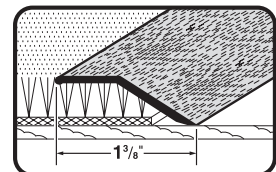

ALUMINUM FLOOR & CARPET TRIM

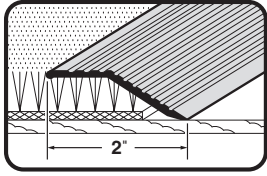

Carpet Trim – Extra Wide

FLUTED

| | | | | |
|-------|----------|-------------|-------------|----|
| 78212 | 2" X 36" | SCREW NAILS | SILVER | 6 |
| 78220 | 2" X 72" | SCREW NAILS | SILVER | 6 |
| 48188 | 2" X 96" | BULK | SILVER | 12 |
| 79244 | 2" X 36" | SCREW NAILS | SATIN BRASS | 6 |
| 79251 | 2" X 72" | SCREW NAILS | SATIN BRASS | 6 |
| 43755 | 2" X 96" | BULK | SATIN BRASS | 12 |
| 43858 | 2" X 36" | SCREW NAILS | PEWTER | 6 |
| 43860 | 2" X 72" | SCREW NAILS | PEWTER | 6 |
| 74930 | 2" X 36" | SCREW NAILS | ALMOND | 6 |
| 74971 | 2" X 72" | SCREW NAILS | ALMOND | 6 |

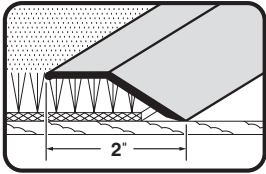

SMOOTH

| | | | | |
|-------|----------|-------------|-------------|---|
| 66084 | 2" X 36" | SCREW NAILS | POLISHED | 6 |
| 66449 | 2" X 72" | SCREW NAILS | POLISHED | 6 |
| 72066 | 2" X 36" | SCREW NAILS | SATIN BRASS | 6 |
| 72249 | 2" X 72" | SCREW NAILS | SATIN BRASS | 6 |

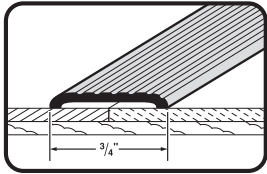

Seam Binder

FLUTED

| | | | | |
|-------|------------|-------------|-------------|---|
| 78048 | 3/4" X 36" | SCREW NAILS | SILVER | 6 |
| 78121 | 3/4" X 72" | SCREW NAILS | SILVER | 6 |
| 79046 | 3/4" X 36" | SCREW NAILS | SATIN BRASS | 6 |
| 79129 | 3/4" X 72" | SCREW NAILS | SATIN BRASS | 6 |

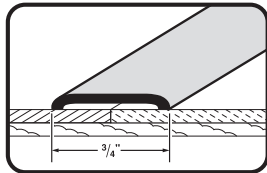

SMOOTH

| | | | | |
|-------|------------|-------------|----------|---|
| 66324 | 3/4" X 72" | SCREW NAILS | POLISHED | 6 |
|-------|------------|-------------|----------|---|

M-D# DESCRIPTION COLOR PACK QTY

ALUMINUM FLOOR & CARPET TRIM

Seam Binder – Wide

METALDECOR™ FINISH

Durable aluminum transitions with the look of finished hardwood. Matching fasteners.

| | | | | |
|-------|--------------|-------------|--------|---|
| 40132 | 1-1/4" X 36" | SCREW NAILS | OAK | 6 |
| 40134 | 1-1/4" X 72" | SCREW NAILS | OAK | 6 |
| 40136 | 1-1/4" X 36" | SCREW NAILS | CHERRY | 6 |
| 40138 | 1-1/4" X 72" | SCREW NAILS | CHERRY | 6 |



FLUTED

| | | | | |
|-------|--------------|-------------|-------------|----|
| 78014 | 1-1/4" X 36" | SCREW NAILS | SILVER | 6 |
| 78097 | 1-1/4" X 72" | SCREW NAILS | SILVER | 6 |
| 43732 | 1-1/4" X 96" | BULK | SILVER | 12 |
| 79012 | 1-1/4" X 36" | SCREW NAILS | SATIN BRASS | 6 |
| 79095 | 1-1/4" X 72" | SCREW NAILS | SATIN BRASS | 6 |
| 43734 | 1-1/4" X 96" | BULK | SATIN BRASS | 12 |
| 43872 | 1-1/4" X 36" | SCREW NAILS | PEWTER | 6 |
| 43874 | 1-1/4" X 72" | SCREW NAILS | PEWTER | 6 |
| 43932 | 1-1/4" X 96" | BULK | PEWTER | 12 |
| 74450 | 1-1/4" X 36" | SCREW NAILS | ALMOND | 6 |
| 74492 | 1-1/4" X 72" | SCREW NAILS | ALMOND | 6 |

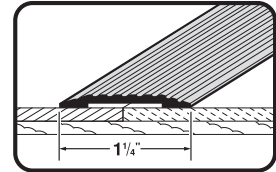

SMOOTH

| | | | | |
|-------|--------------|-------------|-------------|---|
| 66019 | 1-1/4" X 36" | SCREW NAILS | POLISHED | 6 |
| 66225 | 1-1/4" X 72" | SCREW NAILS | POLISHED | 6 |
| 72017 | 1-1/4" X 36" | SCREW NAILS | SATIN BRASS | 6 |
| 72132 | 1-1/4" X 72" | SCREW NAILS | SATIN BRASS | 6 |

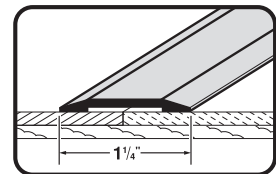

Seam Binder – Extra Wide

SMOOTH

| | | | | |
|-------|--------------|-------------|-------------|---|
| 06684 | 1-3/4" X 36" | SCREW NAILS | SILVER | 6 |
| 06700 | 1-3/4" X 36" | SCREW NAILS | BRITE BRASS | 6 |
| 55160 | 1-3/4" X 72" | SCREW NAILS | BRITE BRASS | 6 |

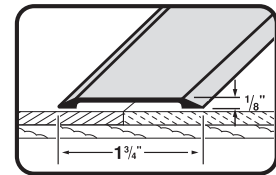

ALUMINUM FLOOR & CARPET TRIM

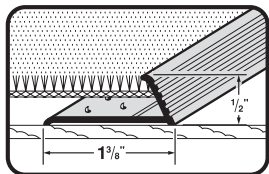

Carpet Gripper with Teeth – For Stretch-In Carpet

FLUTED

| | | | | |
|-------|-----|-------------|-------------|----|
| 78055 | 36" | SCREW NAILS | SILVER | 6 |
| 78139 | 72" | SCREW NAILS | SILVER | 6 |
| 43720 | 96" | BULK | SILVER | 12 |
| 79053 | 36" | SCREW NAILS | SATIN BRASS | 6 |
| 79137 | 72" | SCREW NAILS | SATIN BRASS | 6 |
| 43722 | 96" | BULK | SATIN BRASS | 6 |
| 43882 | 36" | SCREW NAILS | PEWTER | 12 |
| 43886 | 72" | SCREW NAILS | PEWTER | 12 |
| 43938 | 96" | BULK | PEWTER | 12 |
| 74534 | 36" | SCREW NAILS | ALMOND | 6 |
| 74575 | 72" | SCREW NAILS | ALMOND | 6 |

HAMMERED

| | | | | |
|-------|-----|------|-------------|---|
| 43726 | 96" | BULK | SATIN BRASS | 6 |
|-------|-----|------|-------------|---|

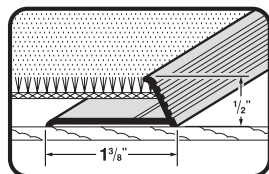

Carpet Gripper without Teeth – For Glue-Down Carpet

FLUTED

| | | | | |
|-------|-----|--|-------------|----|
| 78063 | 36" | | SILVER | 6 |
| 78147 | 72" | | SILVER | 6 |
| 79061 | 36" | | SATIN BRASS | 6 |
| 79145 | 72" | | SATIN BRASS | 6 |
| 43730 | 96" | | SATIN BRASS | 12 |

M-D# DESCRIPTION COLOR PACK QTY

ALUMINUM FLOOR & CARPET TRIM

Stair Edging

METALDECOR™ FINISH

Aluminum stair edgings with the look of finished hardwood. Matching fasteners.

| | | | | | |
|-------|-----|-------------|-----|--------|---|
| 32009 | 36" | SCREW NAILS | NEW | OAK | 6 |
| 32010 | 72" | SCREW NAILS | NEW | OAK | 6 |
| 32012 | 36" | SCREW NAILS | NEW | CHERRY | 6 |
| 32013 | 72" | SCREW NAILS | NEW | CHERRY | 6 |



FLUTED

| | | | | | |
|-------|-----------------------|-------------|--|-------------|----|
| 78022 | 1-1/8" X 1-1/8" X 36" | SCREW NAILS | | SILVER | 6 |
| 78105 | 1-1/8" X 1-1/8" X 72" | SCREW NAILS | | SILVER | 6 |
| 43742 | 1-1/8" X 1-1/8" X 96" | BULK | | SILVER | 12 |
| 79020 | 1-1/8" X 1-1/8" X 36" | SCREW NAILS | | SATIN BRASS | 6 |
| 79103 | 1-1/8" X 1-1/8" X 72" | SCREW NAILS | | SATIN BRASS | 6 |
| 43746 | 1-1/8" X 1-1/8" X 96" | BULK | | SATIN BRASS | 12 |
| 43878 | 1-1/8" X 1-1/8" X 36" | SCREW NAILS | | PEWTER | 6 |
| 43880 | 1-1/8" X 1-1/8" X 72" | SCREW NAILS | | PEWTER | 6 |
| 43936 | 1-1/8" X 1-1/8" X 96" | BULK | | PEWTER | 12 |
| 74690 | 1-1/8" X 1-1/8" X 36" | SCREW NAILS | | ALMOND | 6 |
| 74732 | 1-1/8" X 1-1/8" X 72" | SCREW NAILS | | ALMOND | 6 |

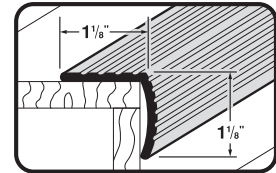

SMOOTH

| | | | | | |
|-------|-----------------------|-------------|--|----------|---|
| 66035 | 1-1/8" X 1-1/8" X 36" | SCREW NAILS | | POLISHED | 6 |
| 66266 | 1-1/8" X 1-1/8" X 72" | SCREW NAILS | | POLISHED | 6 |
| 67215 | 1-1/8" X 1-1/8" X 96" | SCREW NAILS | | POLISHED | 6 |

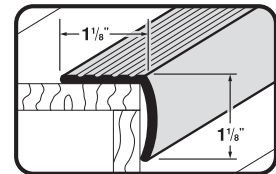

Stair Edging – Tall

FLUTED

| | | | | | |
|-------|-------------------|-------------|--|-------------|---|
| 73262 | 1" X 1-3/4" X 36" | SCREW NAILS | | SILVER | 6 |
| 73270 | 1" X 1-3/4" X 72" | SCREW NAILS | | SILVER | 6 |
| 73304 | 1" X 1-3/4" X 72" | SCREW NAILS | | SATIN BRASS | 6 |

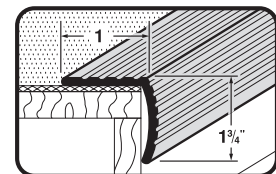

Vinyl Tile Edging

FLUTED

| | | | | | |
|-------|------------|-------------|--|-------------|---|
| 78030 | 3/4" X 36" | SCREW NAILS | | SILVER | 6 |
| 78113 | 3/4" X 72" | SCREW NAILS | | SILVER | 6 |
| 79038 | 3/4" X 36" | SCREW NAILS | | SATIN BRASS | 6 |
| 79111 | 3/4" X 72" | SCREW NAILS | | SATIN BRASS | 6 |

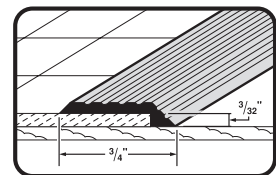

ALUMINUM CARPET TRIM ASSORTMENTS

See Assortment Catalog for Assortment Contents and Costs

- 09417476 2 FT FLOOR TRENDS ALUMINUM & WOOD TRIM ASSORTMENT
- 09417477 2 FT ALUMINUM FLOOR TRIM ASSORTMENT
- 09417479 4 FT ALUMINUM & HARDWOOD FLOOR TRIM ASSORTMENT
- 09417570 4 FT ALUMINUM FLOOR TRIM ASSORTMENT

HARDWOOD FLOOR TRIM

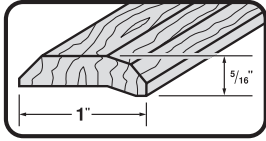

Carpet Trim

| | | | | |
|-------|----------|--------|------------|---|
| 85290 | 1" X 36" | SCREWS | UNFINISHED | 6 |
| 85308 | 1" X 72" | SCREWS | UNFINISHED | 6 |

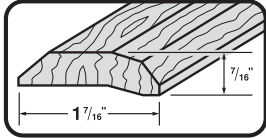

Carpet Trim - Wide

| | | | | |
|-------|---------------|--------|-------------|---|
| 85357 | 1-7/16" X 36" | SCREWS | UNFINISHED | 6 |
| 85365 | 1-7/16" X 72" | SCREWS | UNFINISHED | 6 |
| 85373 | 1-7/16" X 36" | SCREWS | LIGHT STAIN | 6 |
| 85381 | 1-7/16" X 72" | SCREWS | LIGHT STAIN | 6 |

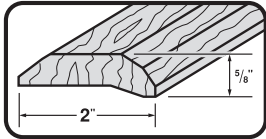

Carpet Trim - Extra Wide

| | | | | |
|-------|----------|--------|-------------|---|
| 85415 | 2" X 36" | SCREWS | UNFINISHED | 6 |
| 85423 | 2" X 72" | SCREWS | UNFINISHED | 6 |
| 85431 | 2" X 36" | SCREWS | LIGHT STAIN | 6 |
| 85449 | 2" X 72" | SCREWS | LIGHT STAIN | 6 |

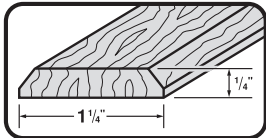

1-1/4" Seam Binder

| | | | | |
|-------|--------------|--------|-------------|---|
| 85233 | 1-1/4" X 36" | SCREWS | UNFINISHED | 6 |
| 85241 | 1-1/4" X 72" | SCREWS | UNFINISHED | 6 |
| 85258 | 1-1/4" X 36" | SCREWS | LIGHT STAIN | 6 |
| 85266 | 1-1/4" X 72" | SCREWS | LIGHT STAIN | 6 |

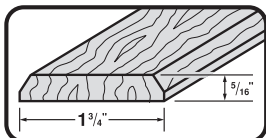

1-3/4" Seam Binder

| | | | | |
|-------|--------------|--------|-------------|---|
| 85621 | 1-3/4" X 36" | SCREWS | UNFINISHED | 6 |
| 85043 | 1-3/4" X 72" | SCREWS | UNFINISHED | 6 |
| 85001 | 1-3/4" X 36" | SCREWS | LIGHT STAIN | 6 |
| 85019 | 1-3/4" X 72" | SCREWS | LIGHT STAIN | 6 |

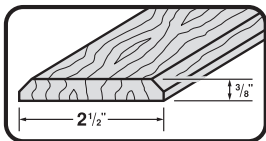

2-1/2" Seam Binder

| | | | | |
|-------|--------------|--------|-------------|---|
| 85639 | 2-1/2" X 36" | SCREWS | UNFINISHED | 6 |
| 85092 | 2-1/2" X 72" | SCREWS | UNFINISHED | 6 |
| 85050 | 2-1/2" X 36" | SCREWS | LIGHT STAIN | 6 |
| 85068 | 2-1/2" X 72" | SCREWS | LIGHT STAIN | 6 |

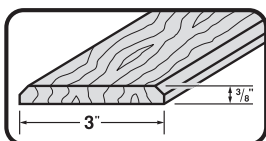

3" Seam Binder

| | | | | |
|-------|----------|--------|------------|---|
| 85613 | 3" X 36" | SCREWS | UNFINISHED | 6 |
| 85100 | 3" X 72" | SCREWS | UNFINISHED | 6 |

M-D# DESCRIPTION COLOR PACK QTY

HARDWOOD FLOOR TRIM

5" Seam Binder

| | | | | |
|-------|----------|--------|------------|---|
| 85597 | 5" X 36" | SCREWS | UNFINISHED | 3 |
| 85605 | 5" X 72" | SCREWS | UNFINISHED | 3 |

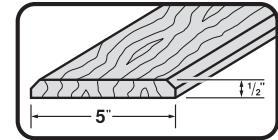

Reducer

| | | | | |
|-------|----------|--------|------------|---|
| 85472 | 1" X 36" | SCREWS | UNFINISHED | 6 |
| 85480 | 1" X 72" | SCREWS | UNFINISHED | 6 |

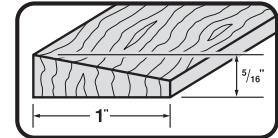

Reducer – Wide

| | | | | |
|-------|--------------|--------|------------|---|
| 85530 | 1-3/4" X 36" | SCREWS | UNFINISHED | 6 |
| 85548 | 1-3/4" X 72" | SCREWS | UNFINISHED | 6 |

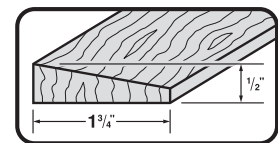

Hardwood Transitions with Snap Track

HARDWOOD TRANSITION – TILE TO LAMINATE

| | | | | |
|-------|-----|----------------|--|---|
| 48901 | 36" | ANCHORS/SCREWS | | 3 |
| 48905 | 72" | ANCHORS/SCREWS | | 3 |

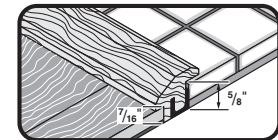

HARDWOOD TRANSITION – TILE TO VINYL

| | | | | |
|-------|-----|----------------|--|---|
| 48909 | 36" | ANCHORS/SCREWS | | 3 |
| 48913 | 72" | ANCHORS/SCREWS | | 3 |

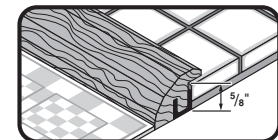

HARDWOOD TRANSITION – TILE TO CARPET

| | | | | |
|-------|-----|----------------|--|---|
| 48927 | 36" | ANCHORS/SCREWS | | 3 |
| 48931 | 72" | ANCHORS/SCREWS | | 3 |

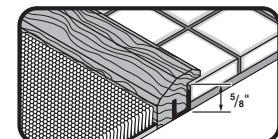

Hardwood Floor Assortments

See Assortment Catalog for Assortment Contents and Costs

09417478 2 FT HARDWOOD FLOOR TRIM ASSORTMENT

CERAMIC TILE EDGING

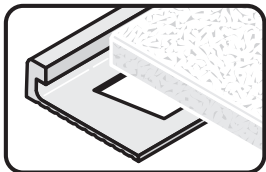

"L-Shape" Tile Edging

| | | | |
|--------------|-----|----------------------|---|
| 1/4" | | | |
| 10922 | 96" | MILL FINISH | 6 |
| 10751 | 96" | SATIN CLEAR ANODIZED | 6 |
| 10769 | 96" | SATIN BRASS ANODIZED | 6 |
| 10835 | 96" | BRIGHT DIPPED BRASS | 6 |
| 5/16" | | | |
| 10924 | 96" | MILL FINISH | 6 |
| 10777 | 96" | SATIN CLEAR ANODIZED | 6 |
| 10785 | 96" | SATIN BRASS ANODIZED | 6 |
| 10843 | 96" | BRIGHT DIPPED BRASS | 6 |
| 3/8" | | | |
| 10926 | 96" | MILL FINISH | 6 |
| 10793 | 96" | SATIN CLEAR ANODIZED | 6 |
| 10801 | 96" | SATIN BRASS ANODIZED | 6 |
| 10850 | 96" | BRIGHT DIPPED BRASS | 6 |
| 19750 | 96" | SANDSTONE | 6 |
| 1/2" | | | |
| 10928 | 96" | MILL FINISH | 6 |
| 10819 | 96" | SATIN CLEAR ANODIZED | 6 |
| 10827 | 96" | SATIN BRASS ANODIZED | 6 |
| 10868 | 96" | BRIGHT DIPPED BRASS | 6 |

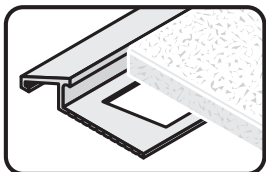

Tile Edge Reducers

| | | | |
|--------------|-----|----------------------|---|
| 5/16" | | | |
| 07385 | 96" | SATIN CLEAR ANODIZED | 6 |
| 07393 | 96" | SATIN BRASS ANODIZED | 6 |
| 07401 | 96" | BRIGHT DIPPED BRASS | 6 |
| 3/8" | | | |
| 07419 | 96" | SATIN CLEAR ANODIZED | 6 |
| 07427 | 96" | SATIN BRASS ANODIZED | 6 |
| 07435 | 96" | BRIGHT DIPPED BRASS | 6 |
| 19725 | 96" | SANDSTONE | 6 |
| 1/2" | | | |
| 07443 | 96" | SATIN CLEAR ANODIZED | 6 |
| 07112 | 96" | SATIN BRASS ANODIZED | 6 |
| 07468 | 96" | BRIGHT DIPPED BRASS | 6 |

M-D# DESCRIPTION COLOR PACK QTY

CERAMIC TILE EDGING

Tile Caps

| | | | |
|--------------|-----|----------------------|---|
| 1/4" | | | |
| 31894 | 96" | SATIN CLEAR ANODIZED | 6 |
| 31896 | 96" | SATIN BRASS ANODIZED | 6 |
| 5/16" | | | |
| 07476 | 96" | SATIN CLEAR ANODIZED | 6 |
| 07484 | 96" | SATIN BRASS ANODIZED | 6 |
| 07492 | 96" | BRIGHT DIPPED BRASS | 6 |
| 3/8" | | | |
| 07500 | 96" | SATIN CLEAR ANODIZED | 6 |
| 07518 | 96" | SATIN BRASS ANODIZED | 6 |
| 07526 | 96" | BRIGHT DIPPED BRASS | 6 |
| 19733 | 96" | SANDSTONE | 6 |

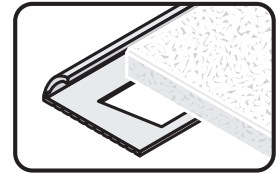

Tile to Carpet

| | | | |
|--------------|-----|----------------------|---|
| 5/16" | | | |
| 07534 | 96" | SATIN CLEAR ANODIZED | 6 |
| 07542 | 96" | SATIN BRASS ANODIZED | 6 |
| 07559 | 96" | BRIGHT DIPPED BRASS | 6 |
| 3/8" | | | |
| 07567 | 96" | SATIN CLEAR ANODIZED | 6 |
| 07575 | 96" | SATIN BRASS ANODIZED | 6 |
| 07583 | 96" | BRIGHT DIPPED BRASS | 6 |
| 19741 | 96" | SANDSTONE | 6 |

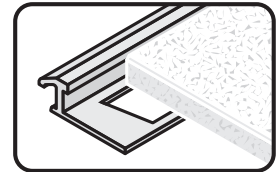

Stair Edging for Tile

| | | | |
|-------------|-----|----------------------|---|
| 3/8" | | | |
| 48170 | 96" | SATIN CLEAR ANODIZED | 6 |
| 48178 | 96" | SATIN BRASS ANODIZED | 6 |

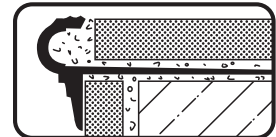

CERAMIC TILE EDGING

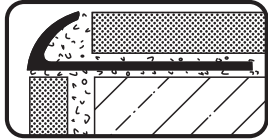

PVC Tile Caps
For installation at outside wall corners

| 1/4" | | | |
|-------|-----|-------|---|
| 73804 | 96" | BLACK | 6 |
| 73806 | 96" | WHITE | 6 |
| 73810 | 96" | BEIGE | 6 |
| 73812 | 96" | GRAY | 6 |
| 73814 | 96" | IVORY | 6 |
| 3/8" | | | |
| 73826 | 96" | BLACK | 6 |
| 73792 | 96" | WHITE | 6 |
| 73820 | 96" | BEIGE | 6 |
| 73822 | 96" | GRAY | 6 |
| 73794 | 96" | IVORY | 6 |

Ceramic Tile Edging Assortment

See Assortment Catalog for Assortment Contents and Costs
09416595 3 FT. CERAMIC TILE EDGING ASSORTMENT

FLOOR & CARPET ACCESSORIES

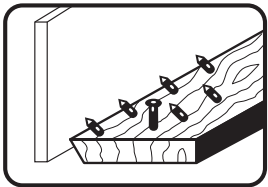

Carpet Tack Strip
3 PACKS
Three 4 ft. pieces of tackstrip per polybag. 30 sets per carton.

| 75093 | 48" | WOOD/CONCRETE NAIL | | 30 |
|----------------|-----|-----------------------------------|-----|-----|
| 75302 | 48" | WOOD/CONCRETE NAIL (CALIF REG) | | 30 |
| 100 PER CARTON | | | | |
| 75312 | 48" | 1" WITH WOOD NAIL | NEW | 100 |
| 75314 | 48" | 1" WITH CONCRETE NAIL | NEW | 100 |
| 75320 | 48" | 1" WITH WOOD NAIL (CALIF REG) | NEW | 100 |
| 75322 | 48" | 1" WITH CONCRETE NAIL (CALIF REG) | NEW | 100 |

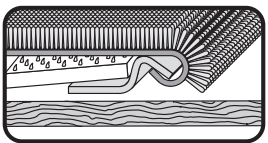

Z Bar
Creates a finished edge where stretch-in carpeting meets floor tile. Install with tack strip.

| 25 PER CARTON | | | | |
|---------------|-----|------|--|----|
| 65110 | 48" | MILL | | 25 |

| M-D# | DESCRIPTION | COLOR | PACK QTY |
|------|-------------|-------|----------|
|------|-------------|-------|----------|

FLOOR & CARPET ACCESSORIES

Screw Nails

FOR CARPET METAL – 12 PER PACKAGE

| | | | |
|-------|--------|--------|----|
| 21501 | 1-1/4" | SILVER | 20 |
| 21485 | 1-1/4" | BRASS | 20 |
| 21478 | 1-1/4" | PEWTER | 20 |

FOR CARPET METAL – 1 LB. PACKAGE

| | | | |
|-------|--------|--------|----|
| 95638 | 1-1/4" | SILVER | 10 |
| 95653 | 1-1/4" | BRASS | 10 |
| 91194 | 1-1/4" | PEWTER | 10 |

Concrete Nails

FOR CARPET METAL – 1 LB. PACKAGE

| | | | |
|-------|------|------|----|
| 19777 | 5/8" | MILL | 10 |
|-------|------|------|----|

Wooden Pegs

For use in installing floor trims over concrete floors.

FOR FLOOR TRIMS – 12 PER PACKAGE

| | | | |
|-------|------------------------|--|----|
| 95661 | 1-1/4" X 3/8" DIAMETER | | 20 |
|-------|------------------------|--|----|

Hot Melt Carpet Seaming Tapes

| | | | | |
|-------|----------|-------------------------------|-----|----|
| 31142 | 22 YARDS | M-D 20 STANDARD HOT MELT TAPE | NEW | 10 |
|-------|----------|-------------------------------|-----|----|



| | | | | |
|-------|----------|------------------------------|-----|----|
| 31143 | 22 YARDS | M-D 40 PREMIUM HOT MELT TAPE | NEW | 10 |
|-------|----------|------------------------------|-----|----|



| | | | | |
|-------|----------|----------------------------|-----|----|
| 31144 | 22 YARDS | M-D 50 ULTRA HOT MELT TAPE | NEW | 10 |
|-------|----------|----------------------------|-----|----|



VINYL WALL BASE

Dry Back

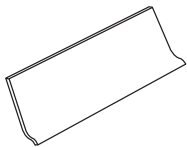

4 FT STRIPS

| | | | |
|-------|-------------|--------------|----|
| 75598 | 2-1/2" X 4' | BLACK | 18 |
| 75614 | 2-1/2" X 4' | BROWN | 18 |
| 75630 | 2-1/2" X 4' | ALMOND | 18 |
| 75655 | 2-1/2" X 4' | DESERT BEIGE | 18 |
| 75697 | 2-1/2" X 4' | WHITE | 18 |
| 75671 | 2-1/2" X 4' | SILVER GRAY | 18 |
| 75218 | 4" X 4' | BLACK | 18 |
| 75234 | 4" X 4' | BROWN | 18 |
| 75275 | 4" X 4' | ALMOND | 18 |
| 75259 | 4" X 4' | DESERT BEIGE | 18 |
| 75317 | 4" X 4' | WHITE | 18 |
| 75291 | 4" X 4' | SILVER GRAY | 18 |

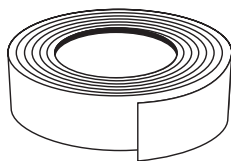

60 FT BULK ROLLS

| | | | |
|-------|----------|-------------|---|
| 73896 | 4" X 60' | BLACK | 1 |
| 73900 | 4" X 60' | BROWN | 1 |
| 73899 | 4" X 60' | ALMOND | 1 |
| 73897 | 4" X 60' | WHITE | 1 |
| 73898 | 4" X 60' | SILVER GRAY | 1 |

120 FT BULK ROLLS

| | | | |
|-------|---------------|--------------|---|
| 75887 | 2-1/2" X 120' | BLACK | 1 |
| 75903 | 2-1/2" X 120' | BROWN | 1 |
| 75960 | 2-1/2" X 120' | ALMOND | 1 |
| 75929 | 2-1/2" X 120' | WHITE | 1 |
| 75945 | 2-1/2" X 120' | SILVER GRAY | 1 |
| 75457 | 4" X 120' | BLACK | 1 |
| 75465 | 4" X 120' | BROWN | 1 |
| 75481 | 4" X 120' | ALMOND | 1 |
| 75473 | 4" X 120' | DESERT BEIGE | 1 |
| 75507 | 4" X 120' | WHITE | 1 |
| 75499 | 4" X 120' | SILVER GRAY | 1 |

Adhesive Back

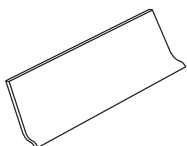

4 FT STRIPS

| | | | |
|-------|---------|--------------|----|
| 23662 | 4" X 4' | BLACK | 18 |
| 23688 | 4" X 4' | BROWN | 18 |
| 23621 | 4" X 4' | ALMOND | 18 |
| 23647 | 4" X 4' | DESERT BEIGE | 18 |
| 23944 | 4" X 4' | WHITE | 18 |
| 23886 | 4" X 4' | SILVER GRAY | 18 |

M-D# DESCRIPTION COLOR PACK QTY

VINYL WALL BASE

Adhesive Back (continued)

20 FT ROLLS

| | | | |
|-------|--------------|--------------|---|
| 65770 | 2-1/2" X 20' | WHITE | 4 |
| 93146 | 4" X 20' | BLACK | 4 |
| 93161 | 4" X 20' | BROWN | 4 |
| 93229 | 4" X 20' | ALMOND | 4 |
| 93187 | 4" X 20' | DESERT BEIGE | 4 |
| 93203 | 4" X 20' | WHITE | 4 |
| 93245 | 4" X 20' | SILVER GRAY | 4 |

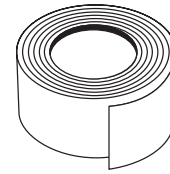

Vinyl Self-Stick Tub Cove Moulding

Protect bathtub, shower stall and flooring from scratches and water damage. Applied where flooring meets base of tub.

| | | | |
|-------|-----|-------|----|
| 65788 | 60" | WHITE | 24 |
|-------|-----|-------|----|

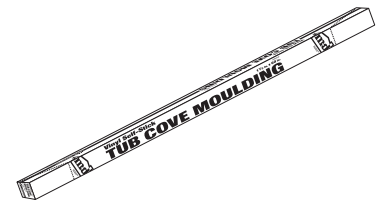

Wall Base Assortments

See Assortment Catalog for Assortment Contents and Costs

- 09415092 4 FT CORE VINYL WALL BASE ASSORTMENT
- 09417420 4 FT HORIZONTAL WALL BASE DRYBACK ASSORTMENT

VINYL FLOORING ACCESSORIES

Vinyl Stair Treads – Residential

| | | | |
|-------|--------------|-------|----|
| 75556 | 9-1/8" X 24" | BLACK | 24 |
| 75572 | 9-1/8" X 24" | BROWN | 24 |

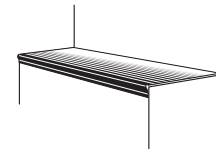

Vinyl Stair Edging

| | | | |
|-------|-----|-------|----|
| 29702 | 36" | BLACK | 12 |
| 29710 | 36" | BROWN | 12 |

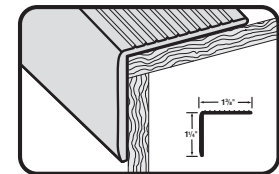

Vinyl Divider T with Metal Track

| | | | |
|-------|-----|-------|---|
| 31215 | 96" | BLACK | 6 |
| 31220 | 96" | BROWN | 6 |



STICK 'n STEP



Stick 'n Step®

ANTI-SKID ADHESIVE TREADS

Heavy-duty, peel and stick adhesive treads. Perform in all weather conditions. Apply to surfaces to improve traction and help prevent slips and falls. Adhere to wood, concrete, metal and more.

| | | | |
|-------|--------------|---------|----|
| 46618 | 2-3/4" X 14" | BLACK | 12 |
| 46620 | 2-3/4" X 14" | NATURAL | 12 |
| 46586 | 2-3/4" X 14" | GRAY | 12 |
| 46594 | 2-3/4" X 14" | YELLOW | 12 |
| 46596 | 4" X 16" | BLACK | 12 |
| 46600 | 4" X 16" | NATURAL | 12 |
| 46602 | 4" X 16" | GRAY | 12 |
| 46612 | 4" X 16" | YELLOW | 12 |

Stick 'n Step® Assortments

See Assortment Catalog for Assortment Contents and Costs

| | |
|----------|---|
| 09417346 | 2 FT. 4" X 16" STICK 'n STEP ASSORTMENT |
| 09417362 | 2 FT. COMBO STICK 'n STEP ASSORTMENT |
| 09417354 | 4 FT. COMBO STICK 'n STEP ASSORTMENT |

DECORATIVE MOULDINGS



DECORATIVE ALUMINUM MOULDINGS

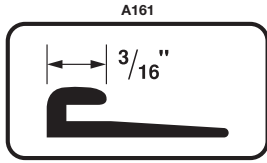

A161

Cap

A161 – FOR 1/16" MATERIAL THICKNESS

| | | | | |
|-------|-----|-------|----------|---|
| 70011 | 96" | NAILS | ANODIZED | 6 |
|-------|-----|-------|----------|---|

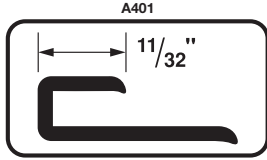

A401

A401 – FOR 1/8" MATERIAL THICKNESS

| | | | | |
|-------|-----|-------|----------|---|
| 70094 | 96" | NAILS | ANODIZED | 6 |
|-------|-----|-------|----------|---|

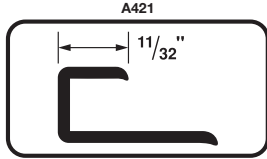

A421

A421 – FOR 1/4" MATERIAL THICKNESS

| | | | | |
|-------|-----|-------|----------|---|
| 70144 | 96" | NAILS | ANODIZED | 6 |
| 73098 | 96" | NAILS | ALBRAS | 6 |

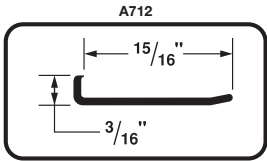

A712

Edging

A712 – FOR 7/8" MATERIAL

| | | | | |
|-------|-----|--------|----------|---|
| 70201 | 96" | SCREWS | ANODIZED | 6 |
| 73122 | 96" | SCREWS | ALBRAS | 6 |

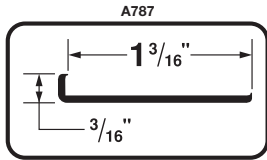

A787

A787 – FOR 1-1/8" MATERIAL

| | | | | |
|-------|-----|--------|----------|---|
| 66407 | 72" | SCREWS | POLISHED | 6 |
| 67363 | 96" | SCREWS | POLISHED | 6 |
| 70391 | 96" | SCREWS | ANODIZED | 6 |

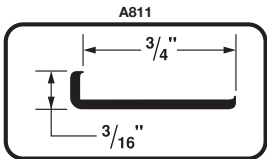

A811

A811 – FOR 3/4" MATERIAL

| | | | | |
|-------|-----|--------|----------|---|
| 67371 | 96" | SCREWS | POLISHED | 6 |
| 70409 | 96" | SCREWS | ANODIZED | 6 |

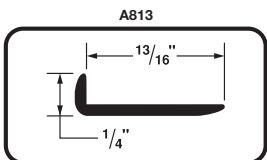

A813

A813 – FOR 13/16" MATERIAL

| | | | | |
|-------|-----|--------|----------|---|
| 69450 | 72" | SCREWS | ANODIZED | 6 |
| 70425 | 96" | SCREWS | ANODIZED | 6 |

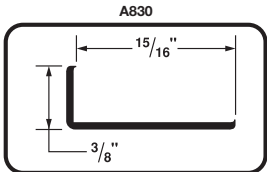

A830

A830 – FOR 15/16" MATERIAL

| | | | | |
|-------|-----|--------|----------|---|
| 70441 | 96" | SCREWS | ANODIZED | 6 |
|-------|-----|--------|----------|---|

M-D# DESCRIPTION COLOR PACK QTY

DECORATIVE ALUMINUM MOULDINGS

Corner – Inside

A773
70367 96" SCREWS ANODIZED 6

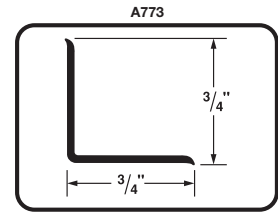

Corner – Outside

A772
67322 96" SCREWS POLISHED 6
70359 96" SCREWS ANODIZED 6

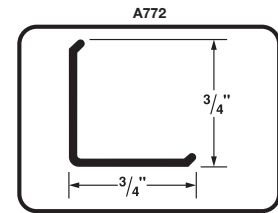

Cove

A164 – FOR 1/16" MATERIAL THICKNESS
70045 96" NAILS ANODIZED 6

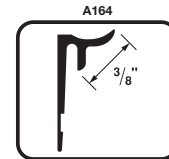

A747
70243 96" NAILS ANODIZED 6

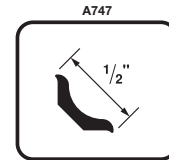

A751
70276 96" SCREWS ANODIZED 6

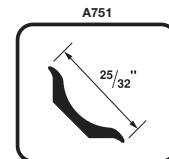

A767 – FOR 1/8" MATERIAL THICKNESS
70318 96" NAILS ANODIZED 6

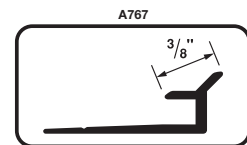

DECORATIVE MOULDINGS

M-D# DESCRIPTION COLOR PACK QTY

DECORATIVE ALUMINUM MOULDINGS

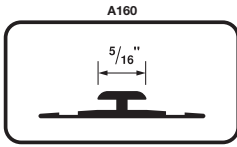

Divider

A160 – FOR 1/16" MATERIAL THICKNESS

69138 72" NAILS

ANODIZED

6

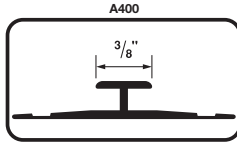

A400 – FOR 1/8" MATERIAL THICKNESS

70086 96" NAILS

ANODIZED

6

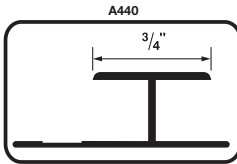

A440 - FOR 3/8" MATERIAL THICKNESS

67165 96" BULK

MILL

40

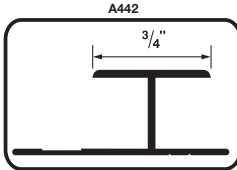

A442 - FOR 7/16" MATERIAL THICKNESS

67167 96" BULK

MILL

25

ALUMINUM SHAPES & METAL SHEETS



ALUMINUM SHAPES

Aluminum Shapes for Craft & Hobby Projects

To make braces, table legs, drawer slides, shelf brackets, reinforcements, and more. Available in mill and anodized finishes. 6063 Alloy, T-5 Hardness.



Flat Bar – Mill

| | A x T | | | |
|-------------------|--------|---------|--|---|
| 48" LENGTH | | | | |
| 60699 | 3/4" | X 1/16" | | 5 |
| 60723 | 1" | X 1/16" | | 5 |
| 60707 | 1-1/2" | X 1/16" | | 5 |
| 60772 | 1/2" | X 1/8" | | 5 |
| 60731 | 3/4" | X 1/8" | | 5 |
| 60749 | 1" | X 1/8" | | 5 |
| 60756 | 1-1/2" | X 1/8" | | 5 |
| 60715 | 2" | X 1/8" | | 5 |
| 60764 | 1" | X 1/4" | | 5 |
| 72" LENGTH | | | | |
| 58008 | 1/2" | X 1/16" | | 5 |
| 58016 | 3/4" | X 1/16" | | 5 |
| 58024 | 1" | X 1/16" | | 5 |
| 58032 | 1-1/2" | X 1/16" | | 5 |
| 58040 | 1/2" | X 1/8" | | 5 |
| 58057 | 3/4" | X 1/8" | | 5 |
| 58065 | 1" | X 1/8" | | 5 |
| 58073 | 1-1/4" | X 1/8" | | 5 |
| 58081 | 1-1/2" | X 1/8" | | 5 |
| 58099 | 2" | X 1/8" | | 5 |
| 58156 | 3/4" | X 1/4" | | 5 |
| 58164 | 1" | X 1/4" | | 5 |
| 58172 | 1-1/2" | X 1/4" | | 5 |
| 58180 | 2" | X 1/4" | | 5 |
| 96" LENGTH | | | | |
| 59014 | 3/4" | X 1/16" | | 5 |
| 59022 | 1" | X 1/16" | | 5 |
| 59030 | 1-1/2" | X 1/16" | | 5 |
| 59048 | 1/2" | X 1/8" | | 5 |
| 59055 | 3/4" | X 1/8" | | 5 |
| 59063 | 1" | X 1/8" | | 5 |
| 59071 | 1-1/4" | X 1/8" | | 5 |
| 59089 | 1-1/2" | X 1/8" | | 5 |
| 59097 | 2" | X 1/8" | | 5 |
| 59162 | 1" | X 1/4" | | 5 |
| 59188 | 2" | X 1/4" | | 5 |

M-D# DESCRIPTION COLOR PACK QTY

ALUMINUM SHAPES

Flat Bar – Anodized

| A x T | | | | | |
|-------------------|--------|---|-------|--|---|
| 72" LENGTH | | | | | |
| 61002 | 3/4" | X | 1/16" | | 5 |
| 61010 | 1" | X | 1/16" | | 5 |
| 61036 | 1/2" | X | 1/8" | | 5 |
| 61044 | 3/4" | X | 1/8" | | 5 |
| 61051 | 1" | X | 1/8" | | 5 |
| 61077 | 1-1/2" | X | 1/8" | | 5 |
| 61085 | 2" | X | 1/8" | | 5 |
| 61101 | 1" | X | 1/4" | | 5 |
| 96" LENGTH | | | | | |
| 62018 | 1" | X | 1/16" | | 5 |
| 62026 | 1-1/2" | X | 1/16" | | 5 |
| 62034 | 1/2" | X | 1/8" | | 5 |
| 62042 | 3/4" | X | 1/8" | | 5 |
| 62059 | 1" | X | 1/8" | | 5 |
| 62075 | 1-1/2" | X | 1/8" | | 5 |
| 62083 | 2" | X | 1/8" | | 5 |



Angle Equal Leg – Mill

| A x A x T | | | | | |
|-------------------|--------|---|--------|---|-------|
| 48" LENGTH | | | | | |
| 61644 | 1/2" | X | 1/2" | X | 1/16" |
| 60848 | 3/4" | X | 3/4" | X | 1/16" |
| 60855 | 1" | X | 1" | X | 1/16" |
| 60863 | 1-1/2" | X | 1-1/2" | X | 1/16" |
| 61634 | 2" | X | 2" | X | 1/16" |
| 61649 | 1/2" | X | 1/2" | X | 1/8" |
| 60871 | 3/4" | X | 3/4" | X | 1/8" |
| 60889 | 1" | X | 1" | X | 1/8" |
| 60822 | 1-1/4" | X | 1-1/4" | X | 1/8" |
| 60897 | 1-1/2" | X | 1-1/2" | X | 1/8" |
| 60830 | 2" | X | 2" | X | 1/8" |
| 72" LENGTH | | | | | |
| 58214 | 1/2" | X | 1/2" | X | 1/16" |
| 58230 | 3/4" | X | 3/4" | X | 1/16" |
| 58255 | 1" | X | 1" | X | 1/16" |
| 58289 | 1-1/2" | X | 1-1/2" | X | 1/16" |
| 58305 | 2" | X | 2" | X | 1/16" |
| 58222 | 1/2" | X | 1/2" | X | 1/8" |
| 58248 | 3/4" | X | 3/4" | X | 1/8" |
| 58263 | 1" | X | 1" | X | 1/8" |
| 58271 | 1-1/4" | X | 1-1/4" | X | 1/8" |
| 58297 | 1-1/2" | X | 1-1/2" | X | 1/8" |
| 58313 | 2" | X | 2" | X | 1/8" |

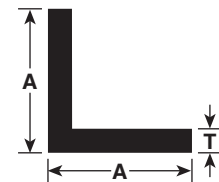

M-D#
DESCRIPTION
COLOR
PACK QTY

ALUMINUM SHAPES

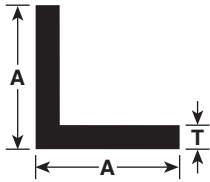

Angle Equal Leg – Mill

| | | A x A x T | | | | |
|------------|--------|-----------|--------|---|-------|---|
| 96" LENGTH | | | | | | |
| 59196 | 1/2" | X | 1/2" | X | 1/16" | 5 |
| 59212 | 3/4" | X | 3/4" | X | 1/16" | 5 |
| 59238 | 1" | X | 1" | X | 1/16" | 5 |
| 59261 | 1-1/2" | X | 1-1/2" | X | 1/16" | 5 |
| 59287 | 2" | X | 2" | X | 1/16" | 5 |
| | | | | | | |
| 59204 | 1/2" | X | 1/2" | X | 1/8" | 5 |
| 59220 | 3/4" | X | 3/4" | X | 1/8" | 5 |
| 59246 | 1" | X | 1" | X | 1/8" | 5 |
| 59253 | 1-1/4" | X | 1-1/4" | X | 1/8" | 5 |
| 59279 | 1-1/2" | X | 1-1/2" | X | 1/8" | 5 |
| 59295 | 2" | X | 2" | X | 1/8" | 5 |

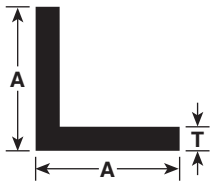

Angle Equal Leg – Anodized

| | | A x A x T | | | | |
|------------|--------|-----------|--------|---|-------|---|
| 72" LENGTH | | | | | | |
| 61119 | 1/2" | X | 1/2" | X | 1/16" | 5 |
| 61135 | 3/4" | X | 3/4" | X | 1/16" | 5 |
| 61150 | 1" | X | 1" | X | 1/16" | 5 |
| 61184 | 1-1/2" | X | 1-1/2" | X | 1/16" | 5 |
| 61200 | 2" | X | 2" | X | 1/16" | 5 |
| | | | | | | |
| 61143 | 3/4" | X | 3/4" | X | 1/8" | 5 |
| 61168 | 1" | X | 1" | X | 1/8" | 5 |
| 61192 | 1-1/2" | X | 1-1/2" | X | 1/8" | 5 |
| 61218 | 2" | X | 2" | X | 1/8" | 5 |
| | | | | | | |
| 96" LENGTH | | | | | | |
| 62109 | 1/2" | X | 1/2" | X | 1/16" | 5 |
| 62125 | 3/4" | X | 3/4" | X | 1/16" | 5 |
| 62141 | 1" | X | 1" | X | 1/16" | 5 |
| 62174 | 1-1/2" | X | 1-1/2" | X | 1/16" | 5 |
| 62190 | 2" | X | 2" | X | 1/16" | 5 |
| | | | | | | |
| 62133 | 3/4" | X | 3/4" | X | 1/8" | 5 |
| 62158 | 1" | X | 1" | X | 1/8" | 5 |
| 62182 | 1-1/2" | X | 1-1/2" | X | 1/8" | 5 |
| 62208 | 2" | X | 2" | X | 1/8" | 5 |

M-D# DESCRIPTION COLOR PACK QTY

ALUMINUM SHAPES

Round Rod – Mill

| A | | | |
|-------------------|------|--|---|
| 48" LENGTH | | | |
| 60632 | 3/8" | | 5 |
| 60640 | 1/2" | | 5 |
| 72" LENGTH | | | |
| 58354 | 3/8" | | 5 |
| 58362 | 1/2" | | 5 |
| 96" LENGTH | | | |
| 59337 | 3/8" | | 5 |



Round Rod – Anodized

| A | | | |
|-------------------|------|--|---|
| 72" LENGTH | | | |
| 61275 | 1/4" | | 5 |
| 61291 | 3/8" | | 5 |



Round Tubing – Mill

.055" Tubing can be telescoped

| A x T | | | |
|-------------------|--------|----------------------|---|
| 48" LENGTH | | | |
| 61665 | 3/4" | .055" WALL THICKNESS | 5 |
| 61674 | 1" | .055" WALL THICKNESS | 5 |
| 72" LENGTH | | | |
| 58420 | 5/8" | .093" WALL THICKNESS | 5 |
| 58438 | 3/4" | .055" WALL THICKNESS | 5 |
| 58453 | 7/8" | .055" WALL THICKNESS | 5 |
| 58461 | 1" | .055" WALL THICKNESS | 5 |
| 58479 | 1-1/4" | .055" WALL THICKNESS | 5 |
| 96" LENGTH | | | |
| 59428 | 3/4" | .055" WALL THICKNESS | 5 |
| 59451 | 1" | .055" WALL THICKNESS | 5 |
| 59469 | 1-1/4" | .055" WALL THICKNESS | 5 |

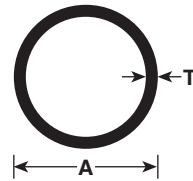

ALUMINUM SHAPES

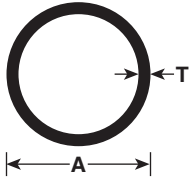

Round Tubing – Anodized

.055" Tubing can be telescoped

| A x T | | | |
|-------------------|------|----------------------|---|
| 72" LENGTH | | | |
| 61341 | 3/4" | .055" WALL THICKNESS | 5 |
| 61374 | 1" | .055" WALL THICKNESS | 5 |
| 96" LENGTH | | | |
| 62323 | 3/4" | .055" WALL THICKNESS | 5 |
| 62356 | 1" | .055" WALL THICKNESS | 5 |

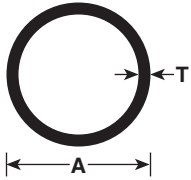

Round Tubing – Brite Dipped Aluminum

| A x T | | | |
|-------------------|--------|----------------------|---|
| 72" LENGTH | | | |
| 61440 | 1" | .047" WALL THICKNESS | 5 |
| 61465 | 1-1/4" | .057" WALL THICKNESS | 5 |

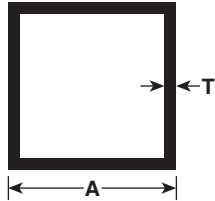

Square Tubing – Mill

| A x T | | | |
|-------------------|--------|----------------------|---|
| 72" LENGTH | | | |
| 58487 | 1" | 1/16" WALL THICKNESS | 5 |
| 58495 | 1-1/4" | 1/16" WALL THICKNESS | 5 |
| 96" LENGTH | | | |
| 59477 | 1" | 1/16" WALL THICKNESS | 5 |
| 59485 | 1-1/4" | 1/16" WALL THICKNESS | 5 |

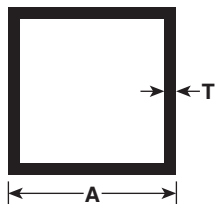

Square Tubing – Anodized

| A x T | | | |
|-------------------|----|----------------------|---|
| 72" LENGTH | | | |
| 61317 | 1" | 1/16" WALL THICKNESS | 5 |
| 96" LENGTH | | | |
| 62299 | 1" | 1/16" WALL THICKNESS | 5 |

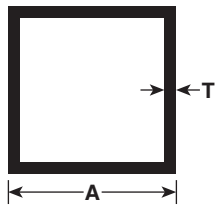

Square Tubing – Brite Dipped Aluminum

| A x T | | | |
|-------------------|----|----------------------|---|
| 72" LENGTH | | | |
| 61481 | 1" | .047" WALL THICKNESS | 5 |

M-D# DESCRIPTION COLOR PACK QTY

ALUMINUM SHAPES

Channel – Mill

| A x B x T | | | | | | | |
|-------------------|--------|---|-------|---|-------|------------------|---|
| 48" LENGTH | | | | | | | |
| 59857 | 25/64" | X | 1/2" | X | 1/16" | FOR 1/4" PLYWOOD | 5 |
| 59840 | 41/64" | X | 1/2" | X | 1/16" | FOR 1/2" PLYWOOD | 5 |
| 59865 | 57/64" | X | 9/16" | X | 1/16" | FOR 3/4" PLYWOOD | 5 |
| 72" LENGTH | | | | | | | |
| 58503 | 25/64" | X | 1/2" | X | 1/16" | FOR 1/4" PLYWOOD | 5 |
| 58511 | 33/64" | X | 1/2" | X | 1/16" | FOR 3/8" PLYWOOD | 5 |
| 58529 | 41/64" | X | 1/2" | X | 1/16" | FOR 1/2" PLYWOOD | 5 |
| 58537 | 57/64" | X | 9/16" | X | 1/16" | FOR 3/4" PLYWOOD | 5 |
| 58552 | 1" | X | 1" | X | 1/8" | | 5 |
| 96" LENGTH | | | | | | | |
| 59501 | 25/64" | X | 1/2" | X | 1/16" | FOR 1/4" PLYWOOD | 5 |
| 59519 | 33/64" | X | 1/2" | X | 1/16" | FOR 3/8" PLYWOOD | 5 |
| 59527 | 41/64" | X | 1/2" | X | 1/16" | FOR 1/2" PLYWOOD | 5 |
| 59535 | 57/64" | X | 9/16" | X | 1/16" | FOR 3/4" PLYWOOD | 5 |
| 59576 | 1" | X | 1" | X | 1/8" | | 5 |

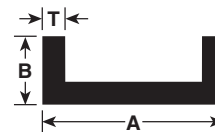

Channel – Anodized

| A x B x T | | | | | | | |
|-------------------|--------|---|-------|---|-------|------------------|---|
| 72" LENGTH | | | | | | | |
| 61226 | 25/64" | X | 1/2" | X | 1/16" | FOR 1/4" PLYWOOD | 5 |
| 61234 | 33/64" | X | 1/2" | X | 1/16" | FOR 3/8" PLYWOOD | 5 |
| 61242 | 41/64" | X | 1/2" | X | 1/16" | FOR 1/2" PLYWOOD | 5 |
| 61259 | 57/64" | X | 9/16" | X | 1/16" | FOR 3/4" PLYWOOD | 5 |
| 96" LENGTH | | | | | | | |
| 62216 | 25/64" | X | 1/2" | X | 1/16" | FOR 1/4" PLYWOOD | 5 |
| 62224 | 33/64" | X | 1/2" | X | 1/16" | FOR 3/8" PLYWOOD | 5 |
| 62232 | 41/64" | X | 1/2" | X | 1/16" | FOR 1/2" PLYWOOD | 5 |
| 62240 | 57/64" | X | 9/16" | X | 1/16" | FOR 3/4" PLYWOOD | 5 |

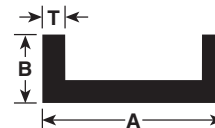

Tee – Mill

| A x B x T | | | | | | | |
|-------------------|------|---|----|---|-------|--|---|
| 96" LENGTH | | | | | | | |
| 59634 | 3/4" | X | 1" | X | 1/16" | | 5 |

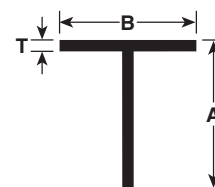

METAL SHEETS

Metal Sheets Project Center

Choose From a Wide Selection of Styles, Sizes and Finishes for a Variety of Projects

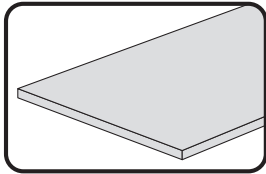

Solid Aluminum Sheets

Lightweight, will not rust. Easy to cut, form and fabricate.

ALUMINUM - .019" THICKNESS

| | | | | |
|-------|----------|--------------|-------|---|
| 56080 | 6" X 18" | PLAIN | MILL | 6 |
| 56040 | 1' X 1' | PLAIN | MILL | 6 |
| 56088 | 1' X 1' | PLAIN | BLACK | 6 |
| 56064 | 1' X 2' | PLAIN | MILL | 6 |
| 56086 | 1' X 2' | PLAIN | BLACK | 3 |
| 57794 | 2' X 3' | PLAIN | MILL | 6 |
| 57000 | 3' X 3' | PLAIN | MILL | 3 |
| 56090 | 1' X 1' | LEATHERGRAIN | MILL | 6 |
| 56030 | 1' X 2' | LEATHERGRAIN | MILL | 3 |
| 57810 | 2' X 3' | LEATHERGRAIN | MILL | 6 |
| 57026 | 3' X 3' | LEATHERGRAIN | MILL | 3 |

Perforated Aluminum Sheets

Choose from a selection of six distinct designs

.020" THICKNESS

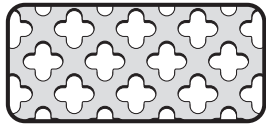

| | | | | |
|-------|---------|------------|--------|---|
| 57042 | 2' X 3' | CLOVERLEAF | MILL | 3 |
| 57166 | 3' X 3' | CLOVERLEAF | MILL | 3 |
| 56016 | 1' X 2' | CLOVERLEAF | ALBRAS | 3 |
| 57109 | 2' X 3' | CLOVERLEAF | ALBRAS | 3 |
| 57240 | 3' X 3' | CLOVERLEAF | ALBRAS | 3 |
| 56018 | 1' X 2' | CLOVERLEAF | BLACK | 3 |

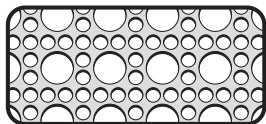

| | | | | |
|-------|---------|---------|---------------------|---|
| 57067 | 2' X 3' | LINCANE | MILL | 3 |
| 57182 | 3' X 3' | LINCANE | MILL | 3 |
| 56012 | 1' X 2' | LINCANE | ALBRAS | 3 |
| 57125 | 2' X 3' | LINCANE | ALBRAS | 3 |
| 57265 | 3' X 3' | LINCANE | ALBRAS | 3 |
| 56014 | 1' X 2' | LINCANE | BLACK | 3 |
| 56062 | 2' X 3' | LINCANE | BLACK | 3 |
| 57015 | 3' X 3' | LINCANE | NEW VENETIAN BRONZE | 3 |

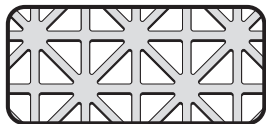

| | | | | |
|-------|---------|-----------|--------|---|
| 56008 | 1' X 2' | UNIONJACK | MILL | 3 |
| 57083 | 2' X 3' | UNIONJACK | MILL | 3 |
| 57208 | 3' X 3' | UNIONJACK | MILL | 3 |
| 56004 | 1' X 2' | UNIONJACK | ALBRAS | 3 |
| 57141 | 2' X 3' | UNIONJACK | ALBRAS | 3 |
| 57281 | 3' X 3' | UNIONJACK | ALBRAS | 3 |
| 56006 | 1' X 2' | UNIONJACK | BLACK | 3 |
| 56000 | 2' X 3' | UNIONJACK | BLACK | 3 |

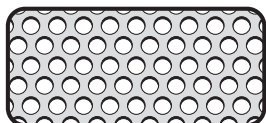

| | | | | |
|-------|---------|------------|-------|---|
| 84160 | 3' X 3' | SMALL HOLE | MILL | 3 |
| 84186 | 3' X 3' | SMALL HOLE | WHITE | 3 |
| 84327 | 3' X 3' | SMALL HOLE | BLACK | 3 |

ALUMINUM SHAPES & METAL SHEETS

M-D# DESCRIPTION COLOR PACK QTY

METAL SHEETS

Perforated Aluminum Sheets (continued)

57005 1' X 2' MOSAIC NEW SATIN NICKEL 3

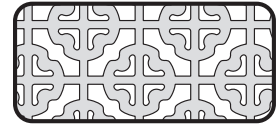

57010 1' X 2' ELLIPTICAL NEW SATIN NICKEL 3

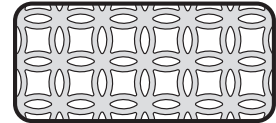

EM-2 Expanded Aluminum

HOLE SIZE - .255" X .100"

57349 3' X 4' SATIN 1

57364 2' X 4' ALBRAS 1

57372 3' X 4' ALBRAS 1

57398 2' X 4' BLACK 1

57406 3' X 4' BLACK 1

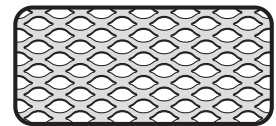

Polished Aluminum Treadplate (.073" Thickness)

Popular aluminum diamond tread pattern used in hundreds of decorative applications

56022 11-7/8" X 23-7/8" POLISHED 3



Faux Metal – Thermal Plastic Sheets

Easy to cut, form and fabricate. "Faux" diamond tread pattern. For interior use only.

56026 11-7/8" X 23-7/8" POLISHED 3



Steel Sheets

GALVANIZED STEEL – 28 GAUGE

Sheets are rust resistant for indoor or outdoor use. Great for roof repairs.

56072 6" X 18" STEEL GALVANIZED 6

56032 1' X 1' STEEL GALVANIZED 6

56020 1' X 2' STEEL GALVANIZED 3

57836 2' X 3' STEEL GALVANIZED 3

57851 3' X 3' STEEL GALVANIZED 3

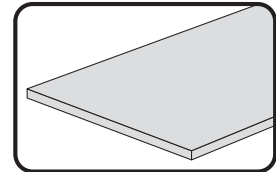

METAL SHEETS

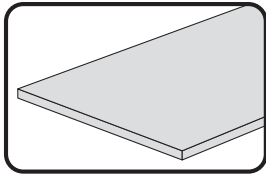
Steel Sheets

Weldable, uncoated cold-rolled steel. Paint to prevent rust.

22 GAUGE

| M-D# | DESCRIPTION | COLOR | PACK QTY |
|-------|-------------|-------|----------|
| 56074 | 6" X 18" | STEEL | 6 |
| 56034 | 1' X 1' | STEEL | 6 |
| 56066 | 1' X 2' | STEEL | 3 |

16 GAUGE

| M-D# | DESCRIPTION | COLOR | PACK QTY |
|-------|-------------|-------|----------|
| 56078 | 6" X 18" | STEEL | 6 |
| 56038 | 1' X 1' | STEEL | 6 |
| 56070 | 1' X 2' | STEEL | 3 |

Aluminum Shapes Assortments

See Assortment Catalog for Assortment Contents and Costs

| | |
|----------|--|
| 09944414 | 2 FT SHAPES ASSORTMENT – 6 FT & 8 FT LENGTHS |
| 09427113 | 2 FT SHAPES ASSORTMENT – 4 FT LENGTHS |
| 09416728 | 2 FT SHAPES ASSORTMENT - FREE STANDING – 4 FT LENGTHS |
| 09416736 | 2 FT SHAPES ASSORTMENT - FREE STANDING – 4 FT & 6 FT LENGTHS |

Metal Sheets Assortments

See Assortment Catalog for Assortment Contents and Costs

| | |
|----------|---------------------------------------|
| 09944406 | 3 FT ALUMINUM SHEETS ASSORTMENT |
| 09416544 | 4 FT SHEETS PROJECT CENTER ASSORTMENT |
| 09416536 | 4 FT SMALL SHEETS ASSORTMENT |

ASSORTMENTS

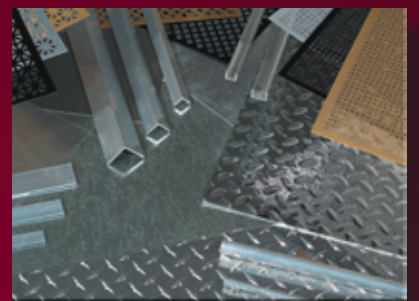
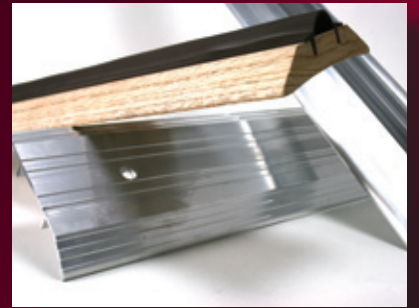

WEATHERSTRIP ASSORTMENTS

Weatherstrip Assortments

See Price Catalog for Assortment Contents and Costs

09427600 4 FT PACKAGED WEATHERSTRIP ASSORTMENT

09427618 8 FT PACKAGED WEATHERSTRIP ASSORTMENT

Threshold, Door Bottoms Sweeps and Door Jamb Assortments

See Price Catalog for Assortment Contents and Costs

09417470 4 FT THRESHOLDS / SWEEPS / DOOR JAMB ASSORTMENT

09417471 8 FT THRESHOLDS / SWEEPS / DOOR JAMB ASSORTMENT

09416553 VINYL CLAD WEATHERSTRIP ASSORTMENT



09417470 4 FT THRESHOLDS / SWEEPS / DOOR JAMB ASSORTMENT



09427618 8 FT PACKAGED WEATHERSTRIP ASSORTMENT



0941655 VINYL CLAD WEATHERSTRIP ASSORTMENT

WEATHERSTRIP ASSORTMENTS

Ultra Residential Door Weatherstrip Assortments

See Price Catalog for Assortment Contents and Costs

- 09417472 2 FT ULTRA RESIDENTIAL THRESHOLD & DOOR BOTTOM ASSORTMENT
- 09417473 2 FT ULTRA JAMB-UP / INSERTS / DOOR BOTTOMS ASSORTMENT
- 09417474 4 FT ULTRA THRESHOLDS / SWEEPS / DOOR BOTTOMS ASSORTMENT
- 09417475 8 FT ULTRA THRESHOLD / DOOR BOTTOM ASSORTMENT

Door Grille Assortment

See Price Catalog for Assortment Contents and Costs

- 09945346 DOOR GRILLE ASSORTMENT

09417472 2 FT ULTRA RESIDENTIAL THRESHOLD & DOOR BOTTOM ASSORTMENT



09417474 4 FT ULTRA THRESHOLDS / SWEEPS / DOOR BOTTOMS ASSORTMENT



09417473 2 FT ULTRA JAMB-UP / INSERTS / DOOR BOTTOMS ASSORTMENT

FLOORING INSTALLATION PRODUCTS ASSORTMENTS

Tile Installation Tools Assortments

See Price Catalog for Assortment Contents and Costs

09417084 4 FT TILE INSTALLATION TOOL ASSORTMENT

09417370 4 FT PRO TILE INSTALLATION TOOL ASSORTMENT



09417084 4 FT TILE INSTALLATION TOOL ASSORTMENT

FLOORING PRODUCTS ASSORTMENTS

Aluminum Carpet Trim Assortments

- See Price Catalog for Assortment Contents and Costs
 09417476 2 FT FLOOR TRENDS ALUMINUM & WOOD TRIM ASSORTMENT
 09417477 2 FT ALUMINUM FLOOR TRIM ASSORTMENT
 09417479 4 FT ALUMINUM & HARDWOOD FLOOR TRIM ASSORTMENT
 09417570 4 FT ALUMINUM FLOOR TRIM ASSORTMENT

Hardwood Floor Trim Assortments

- See Price Catalog for Assortment Contents and Costs
 09417478 2 FT HARDWOOD FLOOR TRIM ASSORTMENT



09417476 2 FT FLOOR TRENDS ALUMINUM & WOOD TRIM ASSORTMENT

09417477 2 FT ALUMINUM FLOOR TRIM ASSORTMENT

FLOORING PRODUCTS ASSORTMENTS

Ceramic Tile Edging Assortment

See Price Catalog for Assortment Contents and Costs
 09416595 3 FT. CERAMIC TILE EDGING ASSORTMENT

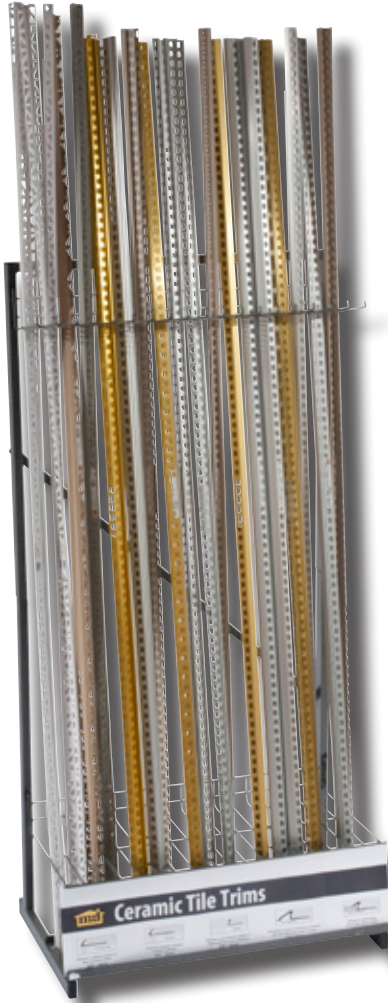

09416595 3 FT. CERAMIC TILE EDGING ASSORTMENT

Wall Base Assortments

See Price Catalog for Assortment Contents and Costs
 09415092 4 FT CORE VINYL WALL BASE ASSORTMENT
 09417420 4 FT HORIZONTAL WALL BASE DRYBACK ASSORTMENT



09415092 CORE VINYL WALL BASE ASSORTMENT

Stick 'n Step® Assortments

See Price Catalog for Assortment Contents and Costs
 09417346 2 FT. 4" X 16" STICK 'n STEP ASSORTMENT
 09417362 2 FT. COMBO STICK 'n STEP ASSORTMENT
 09417354 4 FT. COMBO STICK 'n STEP ASSORTMENT



09417346 2 FT. 4" X 16" STICK 'n STEP ASSORTMENT

ALUMINUM SHAPES & METAL SHEETS ASSORTMENTS

Aluminum Shapes Assortments

See Price Catalog for Assortment Contents and Costs

- 09944414 2 FT SHAPES ASSORTMENT – 6 FT & 8 FT LENGTHS
- 09427113 2 FT SHAPES ASSORTMENT – 4 FT LENGTHS
- 09416728 2 FT SHAPES ASSORTMENT - FREE STANDING – 4 FT LENGTHS
- 09416736 2 FT SHAPES ASSORTMENT - FREE STANDING – 4 FT & 6 FT LENGTHS

Metal Sheets Assortments

See Price Catalog for Assortment Contents and Costs

- 09944406 3 FT ALUMINUM SHEETS ASSORTMENT
- 09416544 4 FT SHEETS PROJECT CENTER ASSORTMENT
- 09416536 4 FT SMALL SHEETS ASSORTMENT



09944406 3 FT ALUMINUM SHEETS ASSORTMENT



09416736 2 FT SHAPES ASSORTMENT – FREE STANDING – 4 FT & 6 FT LENGTHS



FULL LINE CATALOG

PRODUCT INDEX

| M-D ITEM # | CATALOG PAGE # | M-D ITEM # | CATALOG PAGE # | M-D ITEM # | CATALOG PAGE # | M-D ITEM # | CATALOG PAGE # |
|------------|----------------|------------|----------------|------------|----------------|------------|----------------|
| 00687 | .45 | 03822 | .14 | 06619 | .11 | 08904 | .28 |
| 00760 | .45 | 03939 | .17 | 06635 | .11 | 09043 | .24 |
| 01025 | .16 | 04184 | .12 | 06668 | .16 | 09159 | .24 |
| 01033 | .16 | 04200 | .12 | 06684 | .59 | 09365 | .25 |
| 01040 | .22 | 04226 | .22 | 06700 | .59 | 09415 | .27 |
| 01073 | .22 | 04242 | .22 | 07039 | .20 | 09548 | .28 |
| 01156 | .22 | 04267 | .12 | 07112 | .64 | 09563 | .27 |
| 01271 | .22 | 04283 | .12 | 07153 | .19 | 09613 | .27 |
| 01305 | .24 | 04309 | .18 | 07179 | .19 | 10017 | .25 |
| 01438 | .22 | 04325 | .18 | 07237 | .19 | 10116 | .24 |
| 01560 | .39 | 04341 | .18 | 07385 | .64 | 10322 | .28 |
| 01586 | .39 | 04366 | .18 | 07393 | .64 | 10751 | .64 |
| 01610 | .23 | 04440 | .12 | 07401 | .64 | 10769 | .64 |
| 01636 | .23 | 04598 | .12 | 07419 | .64 | 10777 | .64 |
| 01669 | .22 | 04630 | .13 | 07427 | .64 | 10785 | .64 |
| 01677 | .22 | 04663 | .18 | 07435 | .64 | 10793 | .64 |
| 01750 | .23 | 04689 | .18 | 07443 | .64 | 10801 | .64 |
| 01958 | .22 | 04762 | .13 | 07468 | .64 | 10819 | .64 |
| 02006 | .15 | 04770 | .13 | 07476 | .65 | 10827 | .64 |
| 02055 | .11 | 04788 | .13 | 07484 | .65 | 10835 | .64 |
| 02071 | .11 | 04796 | .13 | 07492 | .65 | 10843 | .64 |
| 02097 | .11 | 04929 | .17 | 07500 | .65 | 10850 | .64 |
| 02113 | .11 | 04937 | .17 | 07518 | .65 | 10868 | .64 |
| 02238 | .11 | 05017 | .19 | 07526 | .65 | 10922 | .64 |
| 02253 | .11 | 05058 | .19 | 07534 | .65 | 10924 | .64 |
| 02279 | .11 | 05090 | .19 | 07542 | .65 | 10926 | .64 |
| 02295 | .11 | 05173 | .19 | 07559 | .65 | 10928 | .64 |
| 02311 | .11 | 05215 | .19 | 07567 | .65 | 11056 | .27 |
| 02352 | .16 | 05322 | .21 | 07575 | .65 | 11072 | .27 |
| 02378 | .17 | 05389 | .18 | 07583 | .65 | 11205 | .27 |
| 02394 | .17 | 05413 | .18 | 07766 | .13 | 11346 | .27 |
| 02535 | .15 | 05512 | .21 | 08003 | .25 | 11502 | .30 |
| 02550 | .10 | 05520 | .22 | 08029 | .25 | 11544 | .30 |
| 02576 | .10 | 05546 | .21 | 08078 | .25 | 11619 | .30 |
| 02592 | .10 | 05587 | .19 | 08086 | .24 | 11742 | .26 |
| 02618 | .10 | 05603 | .19 | 08102 | .24 | 11767 | .26 |
| 02733 | .11 | 05629 | .19 | 08151 | .24 | 11783 | .26 |
| 02758 | .11 | 05652 | .18 | 08185 | .25 | 11809 | .26 |
| 02790 | .11 | 05702 | .19 | 08243 | .25 | 11874 | .26 |
| 02816 | .11 | 05744 | .18 | 08264 | .12 | 11882 | .26 |
| 02832 | .11 | 05769 | .18 | 08273 | .12 | 11908 | .26 |
| 02857 | .11 | 05991 | .20 | 08286 | .13 | 11924 | .26 |
| 02873 | .11 | 06015 | .21 | 08308 | .15 | 13029 | .28 |
| 02899 | .11 | 06056 | .21 | 08311 | .15 | 13094 | .28 |
| 03100 | .11 | 06098 | .21 | 08383 | .25 | 13219 | .29 |
| 03335 | .12 | 06114 | .21 | 08409 | .25 | 13383 | .29 |
| 03350 | .12 | 06155 | .21 | 08433 | .27 | 13409 | .29 |
| 03376 | .16 | 06197 | .21 | 08456 | .14 | 13417 | .29 |
| 03392 | .15 | 06247 | .22 | 08460 | .14 | 13466 | .29 |
| 03426 | .15 | 06304 | .22 | 08462 | .14 | 13524 | .29 |
| 03434 | .16 | 06395 | .21 | 08472 | .14 | 13565 | .29 |
| 03509 | .13 | 06403 | .21 | 08599 | .27 | 13748 | .28 |
| 03525 | .24 | 06411 | .19 | 08631 | .28 | 19725 | .64 |
| 03541 | .24 | 06478 | .21 | 08656 | .28 | 19733 | .65 |
| 03723 | .14 | 06528 | .20 | 08664 | .24 | 19741 | .65 |
| 03749 | .14 | 06577 | .11 | 08748 | .25 | 19750 | .64 |
| 03772 | .15 | 06593 | .11 | 08763 | .30 | 19777 | .67 |





PRODUCT INDEX

| M-D ITEM # | CATALOG PAGE # | M-D ITEM # | CATALOG PAGE # | M-D ITEM # | CATALOG PAGE # | M-D ITEM # | CATALOG PAGE # |
|------------|----------------|------------|----------------|------------|----------------|------------|----------------|
| 20044 | 48 | 28555 | 40 | 43732 | 59 | 48086 | 53 |
| 20045 | 48 | 28571 | 40 | 43734 | 59 | 48088 | 44 |
| 20047 | 48 | 28639 | 40 | 43742 | 61 | 48090 | 53 |
| 20048 | 48 | 28654 | 40 | 43746 | 61 | 48092 | 53 |
| 20049 | 48 | 28787 | 40 | 43748 | 56 | 48094 | 53 |
| 20050 | 48 | 28795 | 40 | 43755 | 58 | 48098 | 53 |
| 20051 | 48 | 28803 | 40 | 43811 | 56 | 48100 | 53 |
| 20052 | 48 | 29702 | 69 | 43813 | 56 | 48104 | 53 |
| 20053 | 48 | 29710 | 69 | 43816 | 20 | 48106 | 53 |
| 20054 | 48 | 30000 | 48 | 43818 | 23 | 48108 | 53 |
| 20055 | 48 | 30004 | 47 | 43820 | 20 | 48110 | 54 |
| 20056 | 48 | 31142 | 67 | 43822 | 24 | 48113 | 52 |
| 20057 | 48 | 31143 | 67 | 43824 | 28 | 48114 | 54 |
| 20058 | 48 | 31144 | 67 | 43826 | 28 | 48120 | 54 |
| 20059 | 48 | 31203 | 12 | 43846 | 10 | 48152 | 44 |
| 20060 | 48 | 31215 | 69 | 43848 | 10 | 48154 | 44 |
| 20061 | 48 | 31220 | 69 | 43854 | 57 | 48155 | 50 |
| 20062 | 48 | 31894 | 65 | 43856 | 57 | 48158 | 45 |
| 20063 | 47 | 31896 | 65 | 43858 | 58 | 48160 | 54 |
| 20064 | 47 | 32009 | 61 | 43860 | 58 | 48170 | 65 |
| 20065 | 47 | 32010 | 61 | 43872 | 59 | 48178 | 65 |
| 20097 | 48 | 32012 | 61 | 43874 | 59 | 48188 | 58 |
| 20098 | 48 | 32013 | 61 | 43878 | 61 | 48190 | 44 |
| 20099 | 48 | 33118 | 40 | 43880 | 61 | 48191 | 44 |
| 21478 | 67 | 33167 | 40 | 43882 | 60 | 48194 | 54 |
| 21485 | 67 | 33209 | 40 | 43886 | 60 | 48195 | 54 |
| 21501 | 67 | 33282 | 40 | 43928 | 57 | 48901 | 63 |
| 23621 | 68 | 33308 | 40 | 43932 | 59 | 48905 | 63 |
| 23647 | 68 | 33324 | 40 | 43936 | 61 | 48909 | 63 |
| 23662 | 68 | 33340 | 40 | 43938 | 60 | 48913 | 63 |
| 23688 | 68 | 33365 | 40 | 45907 | 57 | 48927 | 63 |
| 23886 | 68 | 33381 | 40 | 45909 | 57 | 48931 | 63 |
| 23944 | 68 | 33605 | 40 | 46131 | 56 | 48996 | 18 |
| 25706 | 35 | 33621 | 40 | 46133 | 56 | 48998 | 21 |
| 25708 | 35 | 40120 | 57 | 46137 | 56 | 49000 | 21 |
| 25710 | 36 | 40122 | 57 | 46139 | 56 | 49002 | 22 |
| 25714 | 36 | 40124 | 57 | 46141 | 56 | 49004 | 24 |
| 25716 | 35 | 40126 | 57 | 46145 | 56 | 49006 | 25 |
| 25718 | 35 | 40132 | 59 | 46147 | 56 | 49008 | 24 |
| 25722 | 39 | 40134 | 59 | 46149 | 56 | 49010 | 27 |
| 25724 | 39 | 40136 | 59 | 46240 | 56 | 49038 | 48 |
| 25726 | 39 | 40138 | 59 | 46244 | 56 | 49046 | 44 |
| 25730 | 38 | 43100 | 12 | 46586 | 70 | 49047 | 45 |
| 25732 | 38 | 43101 | 12 | 46594 | 70 | 49054 | 46 |
| 25734 | 36 | 43151 | 24 | 46596 | 70 | 49058 | 44 |
| 25736 | 36 | 43153 | 18 | 46600 | 70 | 49062 | 46 |
| 25740 | 37 | 43154 | 11 | 46602 | 70 | 49066 | 50 |
| 25742 | 37 | 43155 | 11 | 46612 | 70 | 49070 | 47 |
| 25744 | 38 | 43157 | 13 | 46618 | 70 | 49074 | 47 |
| 25748 | 38 | 43712 | 57 | 46620 | 70 | 49078 | 45 |
| 25750 | 38 | 43714 | 57 | 47000 | 20 | 49084 | 46 |
| 25752 | 38 | 43716 | 57 | 47002 | 23 | 49090 | 50 |
| 25756 | 22 | 43718 | 57 | 48076 | 52 | 49094 | 47 |
| 25756 | 36 | 43720 | 60 | 48078 | 52 | 49096 | 45 |
| 27094 | 51 | 43722 | 60 | 48080 | 52 | 49100 | 47 |
| 28472 | 40 | 43726 | 60 | 48082 | 52 | 49102 | 47 |
| 28506 | 40 | 43730 | 60 | 48084 | 52 | 49104 | 47 |





FULL LINE CATALOG

PRODUCT INDEX

| M-D ITEM # | CATALOG PAGE # | M-D ITEM # | CATALOG PAGE # | M-D ITEM # | CATALOG PAGE # | M-D ITEM # | CATALOG PAGE # |
|------------|----------------|------------|----------------|------------|----------------|------------|----------------|
| 49108 | 47 | 56006 | 82 | 58065 | 76 | 59451 | 79 |
| 49110 | 48 | 56008 | 82 | 58073 | 76 | 59469 | 79 |
| 49112 | 48 | 56012 | 82 | 58081 | 76 | 59477 | 80 |
| 49116 | 48 | 56014 | 82 | 58099 | 76 | 59485 | 80 |
| 49118 | 49 | 56016 | 82 | 58156 | 76 | 59501 | 81 |
| 49120 | 49 | 56018 | 82 | 58164 | 76 | 59519 | 81 |
| 49124 | 49 | 56020 | 83 | 58172 | 76 | 59527 | 81 |
| 49126 | 46 | 56022 | 83 | 58180 | 76 | 59535 | 81 |
| 49134 | 51 | 56026 | 83 | 58214 | 77 | 59576 | 81 |
| 49136 | 50 | 56030 | 82 | 58222 | 77 | 59634 | 81 |
| 49142 | 50 | 56032 | 83 | 58230 | 77 | 59840 | 81 |
| 49144 | 47 | 56034 | 84 | 58248 | 77 | 59857 | 81 |
| 49146 | 50 | 56038 | 84 | 58255 | 77 | 59865 | 81 |
| 49152 | 51 | 56040 | 82 | 58263 | 77 | 60000 | 52 |
| 49156 | 51 | 56062 | 82 | 58271 | 77 | 60632 | 79 |
| 49160 | 49 | 56064 | 82 | 58289 | 77 | 60640 | 79 |
| 49162 | 49 | 56066 | 84 | 58297 | 77 | 60699 | 76 |
| 49164 | 49 | 56070 | 84 | 58305 | 77 | 60707 | 76 |
| 49166 | 49 | 56072 | 83 | 58313 | 77 | 60715 | 76 |
| 49168 | 49 | 56074 | 84 | 58354 | 79 | 60723 | 76 |
| 49174 | 50 | 56078 | 84 | 58362 | 79 | 60731 | 76 |
| 49194 | 44 | 56080 | 82 | 58420 | 79 | 60749 | 76 |
| 49195 | 44 | 56086 | 82 | 58438 | 79 | 60756 | 76 |
| 49807 | 48 | 56088 | 82 | 58453 | 79 | 60764 | 76 |
| 49819 | 48 | 56090 | 82 | 58461 | 79 | 60772 | 76 |
| 49821 | 48 | 57000 | 82 | 58479 | 79 | 60822 | 77 |
| 49823 | 48 | 57005 | 83 | 58487 | 80 | 60830 | 77 |
| 49827 | 49 | 57010 | 83 | 58495 | 80 | 60848 | 77 |
| 49829 | 49 | 57015 | 82 | 58503 | 81 | 60855 | 77 |
| 49834 | 51 | 57026 | 82 | 58511 | 81 | 60863 | 77 |
| 49837 | 49 | 57042 | 82 | 58529 | 81 | 60871 | 77 |
| 49847 | 46 | 57067 | 82 | 58537 | 81 | 60889 | 77 |
| 49887 | 45 | 57083 | 82 | 58552 | 81 | 60897 | 77 |
| 49905 | 45 | 57109 | 82 | 59014 | 76 | 61002 | 77 |
| 49943 | 46 | 57125 | 82 | 59022 | 76 | 61010 | 77 |
| 49977 | 46 | 57141 | 82 | 59030 | 76 | 61036 | 77 |
| 49977 | 54 | 57166 | 82 | 59048 | 76 | 61044 | 77 |
| 49985 | 47 | 57182 | 82 | 59055 | 76 | 61051 | 77 |
| 50005 | 15 | 57208 | 82 | 59063 | 76 | 61077 | 77 |
| 50007 | 15 | 57240 | 82 | 59071 | 76 | 61085 | 77 |
| 50040 | 15 | 57265 | 82 | 59089 | 76 | 61101 | 77 |
| 50042 | 15 | 57281 | 82 | 59097 | 76 | 61119 | 78 |
| 50060 | 10 | 57349 | 83 | 59162 | 76 | 61135 | 78 |
| 50100 | 13 | 57364 | 83 | 59188 | 76 | 61143 | 78 |
| 50101 | 13 | 57372 | 83 | 59196 | 78 | 61150 | 78 |
| 50140 | 17 | 57398 | 83 | 59204 | 78 | 61168 | 78 |
| 50142 | 17 | 57406 | 83 | 59212 | 78 | 61184 | 78 |
| 50144 | 17 | 57794 | 82 | 59220 | 78 | 61192 | 78 |
| 50148 | 17 | 57810 | 82 | 59238 | 78 | 61200 | 78 |
| 50150 | 17 | 57836 | 83 | 59246 | 78 | 61218 | 78 |
| 50154 | 17 | 57851 | 83 | 59253 | 78 | 61226 | 81 |
| 50158 | 17 | 58008 | 76 | 59261 | 78 | 61234 | 81 |
| 50162 | 17 | 58016 | 76 | 59279 | 78 | 61242 | 81 |
| 50164 | 17 | 58024 | 76 | 59287 | 78 | 61259 | 81 |
| 55160 | 59 | 58032 | 76 | 59295 | 78 | 61275 | 79 |
| 56000 | 82 | 58040 | 76 | 59337 | 79 | 61291 | 79 |
| 56004 | 82 | 58057 | 76 | 59428 | 79 | 61317 | 80 |





PRODUCT INDEX

| M-D ITEM # | CATALOG PAGE # | M-D ITEM # | CATALOG PAGE # | M-D ITEM # | CATALOG PAGE # | M-D ITEM # | CATALOG PAGE # |
|------------|----------------|------------|----------------|------------|----------------|------------|----------------|
| 61341 | .80 | 66472 | .57 | 69596 | .36 | 70086 | .74 |
| 61374 | .80 | 67106 | .34 | 69604 | .32 | 70094 | .72 |
| 61440 | .80 | 67107 | .34 | 69609 | .32 | 70144 | .72 |
| 61465 | .80 | 67109 | .34 | 69612 | .35 | 70201 | .72 |
| 61481 | .80 | 67110 | .34 | 69620 | .35 | 70243 | .73 |
| 61634 | .77 | 67165 | .74 | 69633 | .35 | 70276 | .73 |
| 61644 | .77 | 67167 | .74 | 69638 | .35 | 70318 | .73 |
| 61649 | .77 | 67215 | .61 | 69644 | .35 | 70359 | .73 |
| 61665 | .79 | 67322 | .73 | 69648 | .35 | 70367 | .73 |
| 61674 | .79 | 67363 | .72 | 69652 | .35 | 70391 | .72 |
| 62018 | .77 | 67371 | .72 | 69694 | .37 | 70409 | .72 |
| 62026 | .77 | 67439 | .57 | 69698 | .37 | 70425 | .72 |
| 62034 | .77 | 67967 | .20 | 69703 | .37 | 70441 | .72 |
| 62042 | .77 | 68247 | .32 | 69709 | .37 | 71464 | .16 |
| 62059 | .77 | 68254 | .32 | 69733 | .37 | 71480 | .16 |
| 62075 | .77 | 68288 | .31 | 69737 | .37 | 71506 | .16 |
| 62083 | .77 | 68296 | .31 | 69745 | .37 | 71522 | .16 |
| 62109 | .78 | 68304 | .31 | 69749 | .37 | 71548 | .16 |
| 62125 | .78 | 68312 | .31 | 69752 | .37 | 72017 | .59 |
| 62133 | .78 | 68320 | .31 | 69791 | .32 | 72066 | .58 |
| 62141 | .78 | 68338 | .31 | 69808 | .31 | 72074 | .57 |
| 62158 | .78 | 68346 | .31 | 69811 | .31 | 72132 | .59 |
| 62174 | .78 | 68353 | .31 | 69816 | .32 | 72249 | .58 |
| 62182 | .78 | 68361 | .31 | 69824 | .32 | 72256 | .57 |
| 62190 | .78 | 68387 | .31 | 69828 | .31 | 73098 | .72 |
| 62208 | .78 | 68395 | .31 | 69833 | .31 | 73122 | .72 |
| 62216 | .81 | 68403 | .32 | 69839 | .38 | 73262 | .61 |
| 62224 | .81 | 68429 | .38 | 69844 | .38 | 73270 | .61 |
| 62232 | .81 | 68437 | .38 | 69848 | .38 | 73304 | .61 |
| 62240 | .81 | 68510 | .10 | 69851 | .38 | 73792 | .66 |
| 62299 | .80 | 68510 | .33 | 69858 | .38 | 73794 | .66 |
| 62323 | .80 | 68544 | .39 | 69860 | .38 | 73804 | .66 |
| 62356 | .80 | 68593 | .33 | 69867 | .38 | 73806 | .66 |
| 63602 | .10 | 68601 | .32 | 69871 | .38 | 73810 | .66 |
| 63628 | .10 | 68627 | .32 | 69875 | .38 | 73812 | .66 |
| 63644 | .10 | 68635 | .31 | 69901 | .38 | 73814 | .66 |
| 63669 | .10 | 68668 | .10 | 69909 | .38 | 73820 | .66 |
| 64386 | .18 | 68668 | .33 | 69911 | .38 | 73822 | .66 |
| 64394 | .18 | 68676 | .10 | 69918 | .38 | 73826 | .66 |
| 64428 | .18 | 68676 | .33 | 69923 | .38 | 73896 | .68 |
| 64444 | .18 | 68684 | .32 | 69927 | .38 | 73897 | .68 |
| 64469 | .18 | 68692 | .31 | 69935 | .38 | 73898 | .68 |
| 64501 | .18 | 68726 | .32 | 69938 | .38 | 73899 | .68 |
| 65110 | .66 | 68734 | .32 | 69940 | .38 | 73900 | .68 |
| 65770 | .69 | 69138 | .74 | 69945 | .38 | 74187 | .57 |
| 65788 | .69 | 69450 | .72 | 69956 | .39 | 74336 | .57 |
| 66001 | .56 | 69500 | .35 | 69962 | .39 | 74450 | .59 |
| 66019 | .59 | 69505 | .35 | 69969 | .39 | 74492 | .59 |
| 66035 | .61 | 69514 | .35 | 69974 | .39 | 74534 | .60 |
| 66084 | .58 | 69521 | .35 | 69989 | .39 | 74575 | .60 |
| 66092 | .57 | 69539 | .36 | 70011 | .72 | 74690 | .61 |
| 66217 | .56 | 69547 | .36 | 70023 | .39 | 74732 | .61 |
| 66225 | .59 | 69554 | .36 | 70031 | .39 | 74930 | .58 |
| 66266 | .61 | 69562 | .36 | 70045 | .73 | 74971 | .58 |
| 66324 | .58 | 69570 | .36 | 70056 | .34 | 75093 | .66 |
| 66407 | .72 | 69588 | .36 | 70068 | .34 | 75218 | .68 |
| 66449 | .58 | 69591 | .36 | 70077 | .37 | 75234 | .68 |





FULL LINE CATALOG

PRODUCT INDEX

| M-D ITEM # | CATALOG PAGE # | M-D ITEM # | CATALOG PAGE # | M-D ITEM # | CATALOG PAGE # | M-D ITEM # | CATALOG PAGE # |
|------------|----------------|------------|----------------|------------|----------------|------------|----------------|
| 75259 | .68 | 78618 | .34 | 85043 | .62 | 92924 | .42 |
| 75275 | .68 | 78634 | .34 | 85050 | .62 | 93146 | .69 |
| 75291 | .68 | 78691 | .33 | 85068 | .62 | 93161 | .69 |
| 75302 | .66 | 78840 | .33 | 85092 | .62 | 93187 | .69 |
| 75312 | .66 | 78873 | .33 | 85100 | .62 | 93203 | .69 |
| 75314 | .66 | 78899 | .34 | 85233 | .62 | 93229 | .69 |
| 75317 | .68 | 78907 | .34 | 85241 | .62 | 93245 | .69 |
| 75320 | .66 | 79004 | .56 | 85258 | .62 | 93967 | .42 |
| 75322 | .66 | 79012 | .59 | 85266 | .62 | 93968 | .42 |
| 75457 | .68 | 79020 | .61 | 85290 | .62 | 93969 | .42 |
| 75465 | .68 | 79038 | .61 | 85308 | .62 | 93975 | .42 |
| 75473 | .68 | 79046 | .58 | 85357 | .62 | 94005 | .42 |
| 75481 | .68 | 79053 | .60 | 85365 | .62 | 94010 | .42 |
| 75499 | .68 | 79061 | .60 | 85373 | .62 | 94091 | .28 |
| 75507 | .68 | 79079 | .57 | 85381 | .62 | 95638 | .67 |
| 75556 | .69 | 79087 | .56 | 85415 | .62 | 95653 | .67 |
| 75572 | .69 | 79095 | .59 | 85423 | .62 | 95661 | .67 |
| 75598 | .68 | 79103 | .61 | 85431 | .62 | 09415092 | .69,90 |
| 75614 | .68 | 79111 | .61 | 85449 | .62 | 09416536 | .84,91 |
| 75630 | .68 | 79129 | .58 | 85472 | .63 | 09416544 | .84,91 |
| 75655 | .68 | 79137 | .60 | 85480 | .63 | 09416553 | .29,86 |
| 75671 | .68 | 79145 | .60 | 85530 | .63 | 09416595 | .66,90 |
| 75697 | .68 | 79152 | .57 | 85548 | .63 | 09416728 | .84,91 |
| 75887 | .68 | 79244 | .58 | 85597 | .63 | 09416736 | .84,91 |
| 75903 | .68 | 79251 | .58 | 85605 | .63 | 09417084 | .51,88 |
| 75929 | .68 | 79962 | .36 | 85613 | .62 | 09417346 | .70,90 |
| 75945 | .68 | 79970 | .36 | 85621 | .62 | 09417354 | .70,90 |
| 75960 | .68 | 79988 | .36 | 85639 | .62 | 09417362 | .70,90 |
| 76265 | .33 | 79996 | .36 | 87619 | .15 | 09417370 | .51,88 |
| 76281 | .33 | 80317 | .36 | 87635 | .22 | 09417420 | .69,90 |
| 77768 | .39 | 80374 | .36 | 87643 | .14 | 09417470 | .29,86 |
| 77792 | .33 | 80465 | .36 | 87668 | .14 | 09417471 | .29,86 |
| 77800 | .33 | 80622 | .35 | 87684 | .14 | 09417472 | .39,87 |
| 77883 | .38 | 80630 | .35 | 87700 | .14 | 09417473 | .39,87 |
| 77891 | .38 | 81661 | .36 | 87726 | .14 | 09417474 | .39,87 |
| 77909 | .38 | 81679 | .37 | 87742 | .14 | 09417475 | .39,87 |
| 78006 | .56 | 81687 | .37 | 87767 | .23 | 09417476 | .61,89 |
| 78014 | .59 | 81697 | .37 | 87783 | .23 | 09417477 | .61,89 |
| 78022 | .61 | 81703 | .37 | 87791 | .39 | 09417478 | .63,89 |
| 78030 | .61 | 81810 | .37 | 87809 | .39 | 09417479 | .61,89 |
| 78048 | .58 | 81828 | .37 | 87916 | .16 | 09417570 | .61,89 |
| 78055 | .60 | 81869 | .38 | 87981 | .23 | 09427113 | .84,91 |
| 78063 | .60 | 81877 | .38 | 91194 | .67 | 09427600 | .29,86 |
| 78071 | .57 | 81885 | .38 | 91800 | .23 | 09427618 | .29,86 |
| 78089 | .56 | 81893 | .38 | 91850 | .23 | 09944406 | .84,91 |
| 78097 | .59 | 81901 | .35 | 91868 | .23 | 09944414 | .84,91 |
| 78105 | .61 | 81919 | .35 | 91884 | .23 | 09945346 | .40,87 |
| 78113 | .61 | 81927 | .35 | 92288 | .42 | | |
| 78121 | .58 | 81935 | .35 | 92296 | .42 | | |
| 78139 | .60 | 82578 | .20 | 92325 | .42 | | |
| 78147 | .60 | 82586 | .20 | 92346 | .42 | | |
| 78154 | .57 | 82594 | .20 | 92379 | .42 | | |
| 78196 | .12 | 84160 | .82 | 92395 | .42 | | |
| 78212 | .58 | 84186 | .82 | 92395 | .42 | | |
| 78220 | .58 | 84327 | .82 | 92437 | .42 | | |
| 78394 | .12 | 85001 | .62 | 92908 | .42 | | |
| 78600 | .34 | 85019 | .62 | 92910 | .42 | | |

