

SELECTRONIC™ PROXIMITY TOILET FLUSH VALVE 1.1, 1.6 & 1.28 GPF (After June 2013)

PRODUCT NUMBERS

6065.161	6065.111
6065.121	6065.525
6065.565	7095.121

A917376-0070A
COVER SET SCREW



M962665-0021100A
COVER ASSEMBLY FOR
FLUSH VALVE WITH 1.1 gpf
(BATTERY INCLUDED)

M962665-0021600A
COVER ASSEMBLY FOR
FLUSH VALVE WITH 1.6 gpf
(BATTERY INCLUDED)

M962665-0021280A
COVER ASSEMBLY FOR
FLUSH VALVE WITH 1.28 gpf
(BATTERY INCLUDED)

ADAPTER IS INCLUDED,
BUT NOT REQUIRED

A906680-0070A
BONNET NUT



M964302-0070A
SOLENOID ASSEMBLY

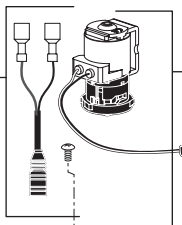

M964312-0070A
SOLENOID & PISTON
SUBASSEMBLY



M962663-0070A
PISTON ASSEMBLY

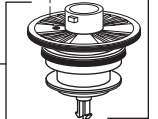

A912809-0070A
O-RING



OPTIONAL ADJUSTABLE TAILPIECE
(Purchased Separately)

M962836-0020A (8-1/4" to 9-1/4" Rough-in)

M962835-0020A (7-1/4" to 8-1/4" Rough-in)

M962834-0020A (6-1/4" to 7-1/4" Rough-in)

M962833-0020A (5-1/4" to 6-1/4" Rough-in)

M962920-0020A
ADJUSTABLE TAILPIECE
(4-1/4" to 5-1/4" Rough-in)



M962666-0020A
MANUAL VALVE



M964402-0070A
VACUUM BREAKER KIT



M964411-0020A
VACUUM BREAKER
ASSEMBLY 11-1/2"
(220mm) ROUGH-IN



M952269-0020A
ESCUTCHEON KIT

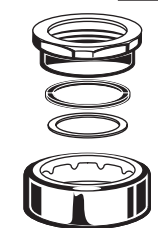

M950319-0071600A
SENSOR ASSEMBLY
W/MTG. KIT.
FOR FLUSH VALVE
WITH 1.6 gpf

M950319-0071280A
SENSOR ASSEMBLY
W/MTG. KIT.
FOR FLUSH VALVE
WITH 1.28 gpf

M950319-0071100A
SENSOR ASSEMBLY
W/MTG. KIT.
FOR FLUSH VALVE
WITH 1.1 gpf

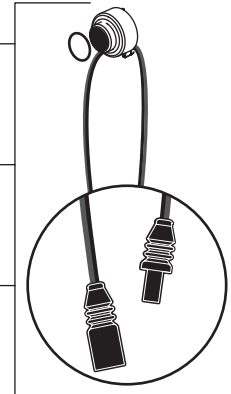

M962928-0020A
STAMPED FLANGE



M962927-0020A
COVER TUBE

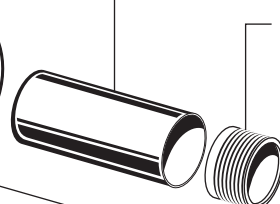

M962926-0070A
SWEAT ADAPTER



A955056-0020A
1" SUPPLY STOP



A955057-0020A
INLET PIPE ASSEMBLY



M964059-0020A
CAP (1" SUPPLY STOP)



HOT LINE FOR HELP
For toll-free information and answers to your questions, call:
1 (800) 442-1902
Weekdays 8:00 a.m. to 6:00 p.m. EST
IN MEXICO 01-800-839-1200
IN CANADA 1-800-387-0369 (TORONTO 1-905-306-1093)
Weekdays 8:00 a.m. to 7:00 p.m. EST

Product names listed herein are trademarks of AS America, Inc. 2009

American Standard

SELECTRONIC™ PROXIMITY TOILET FLUSH VALVE 1.1, 1.6 & 1.28 GPF (Before June 2013)

PRODUCT NUMBERS

6065.161	6065.111
6065.121	6065.525
6065.565	7095.121

A917376-0070A
COVER SET SCREW

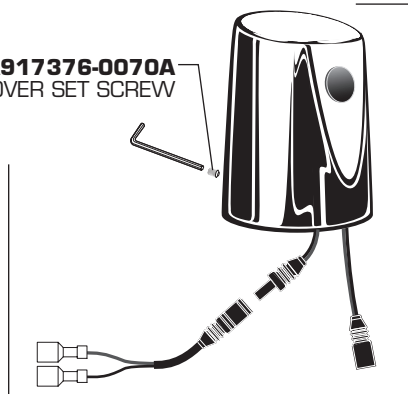

M962665-0021100A
COVER ASSEMBLY FOR
FLUSH VALVE WITH 1.1 gpf
(BATTERY INCLUDED)

M962665-0021600A
COVER ASSEMBLY FOR
FLUSH VALVE WITH 1.6 gpf
(BATTERY INCLUDED)

M962665-0021280A
COVER ASSEMBLY FOR
FLUSH VALVE WITH 1.28 gpf
(BATTERY INCLUDED)

A906680-0070A
BONNET NUT



A923654-0070A
BATTERY 6VCR-P2

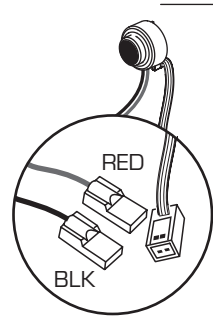

A950223-0071600A
SENSOR ASSEMBLY
W/MTG. KIT.
FOR FLUSH VALVE
WITH 1.6 gpf

A950223-0071280A
SENSOR ASSEMBLY
W/MTG. KIT.
FOR FLUSH VALVE
WITH 1.28 gpf

A950223-0071100A
SENSOR ASSEMBLY
W/MTG. KIT.
FOR FLUSH VALVE
WITH 1.1 gpf

M962664-0070A
SOLENOID ASSEMBLY

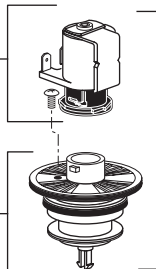

M962956-0070A
SOLENOID & PISTON
SUBASSEMBLY

A912809-0070A
O-RING



OPTIONAL ADJUSTABLE TAILPIECE
(Purchased Separately)

M962836-0020A (8-1/4" to 9-1/4" Rough-in)

M962835-0020A (7-1/4" to 8-1/4" Rough-in)

M962834-0020A (6-1/4" to 7-1/4" Rough-in)

M962833-0020A (5-1/4" to 6-1/4" Rough-in)

M962663-0070A
PISTON ASSEMBLY

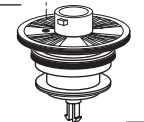

M962920-0020A
ADJUSTABLE TAILPIECE
(4-1/4" to 5-1/4" Rough-in)

M962666-0020A
MANUAL VALVE

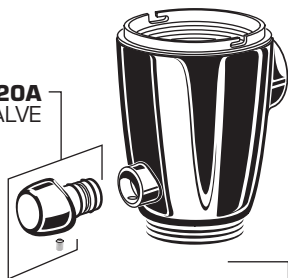

M962928-0020A
STAMPED FLANGE



M962927-0020A
COVER TUBE

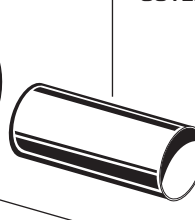

M962926-0070A
SWEAT ADAPTER

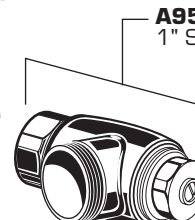

A955056-0020A
1" SUPPLY STOP

M964402-0070A
VACUUM BREAKER KIT



A955057-0020A
INLET PIPE ASSEMBLY



M964059-0020A
CAP (1" SUPPLY STOP)



M964411-0020A
VACUUM BREAKER
ASSEMBLY 11-1/2"
(220mm) ROUGH-IN



M952269-0020A
ESCUTCHEON KIT

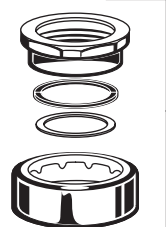

HOT LINE FOR HELP
For toll-free information and answers to your questions, call:
1 (800) 442-1902
Weekdays 8:00 a.m. to 6:00 p.m. EST
IN MEXICO 01-800-839-1200
IN CANADA 1-800-387-0369 (TORONTO 1-905-306-1093)
Weekdays 8:00 a.m. to 7:00 p.m. EST
Product names listed herein are trademarks of AS America, Inc.