

American Standard

**SELECTRONIC™
PROXIMITY URINAL FLUSH VALVE
0.125 GPF
(After June 2013)**

MODEL NUMBERS

**6063.013
6063.513
6590.525**

A917376-0070A
COVER SET SCREW



M962665-0020130A
COVER ASSEMBLY FOR
FLUSH VALVE WITH 0.125 gpf
(BATTERY INCLUDED)

ADAPTER IS INCLUDED,
BUT NOT REQUIRED



A923654-0070A
BATTERY 6VCR-P2



M950514-0070A
BATTERY HOLDER



M950319-0070130A
SENSOR

A906680-0070A
BONNET NUT



M964302-0070A
SOLENOID ASSEMBLY

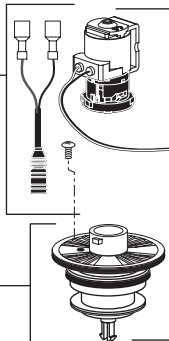

M964311-0070A
SOLENOID & PISTON
SUBASSEMBLY

A912809-0070A
O-RING



OPTIONAL ADJUSTABLE TAILPIECE
(Purchased Separately)

M962836-0020A (8-1/4" to 9-1/4" Rough-in)
M962835-0020A (7-1/4" to 8-1/4" Rough-in)
M962834-0020A (6-1/4" to 7-1/4" Rough-in)
M962833-0020A (5-1/4" to 6-1/4" Rough-in)

M962907-0070A
PISTON ASSEMBLY

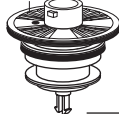

M962920-0020A
ADJUSTABLE TAILPIECE
(4-1/4" to 5-1/4" Rough-in)

M962666-0020A
MANUAL VALVE



M962801-0070A
FLOW REGULATOR



M964074-0020A
STAMPED FLANGE



M964076-0020A
COVER TUBE

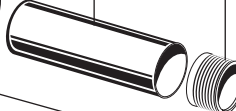

M964075-0070A
SWEAT ADAPTER



M955058-0020A
3/4" SUPPLY STOP

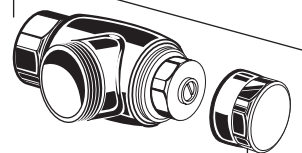

M964402-0070A
VACUUM BREAKER KIT

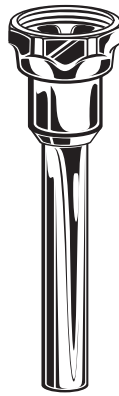

M964412-0020A
3/4" VACUUM
BREAKER ASSEMBLY

M952261-0020A
3/4" INLET PIPE ASSEMBLY

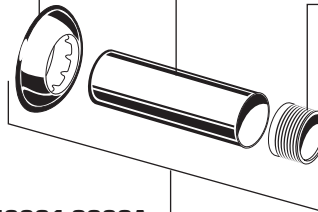

M964403-0020A
CAP (3/4" SUPPLY STOP)



M952262-0020A
3/4" SPUD ASSEMBLY



HOT LINE FOR HELP
For toll-free information and answers to your questions, call:
1 (800) 442-1902
Weekdays 8:00 a.m. to 6:00 p.m. EST
IN MEXICO 01-800-839-1200
IN CANADA 1-800-387-0369 (TORONTO 1-905-306-1093)
Weekdays 8:00 a.m. to 7:00 p.m. EST

Product names listed herein are trademarks of AS America, Inc. 2009

American Standard

**SELECTRONIC™
PROXIMITY URINAL FLUSH VALVE
0.125 GPF
(Before June 2013)**

MODEL NUMBERS

**6063.013
6063.513
6590.525**

A917376-0070A
COVER SET SCREW

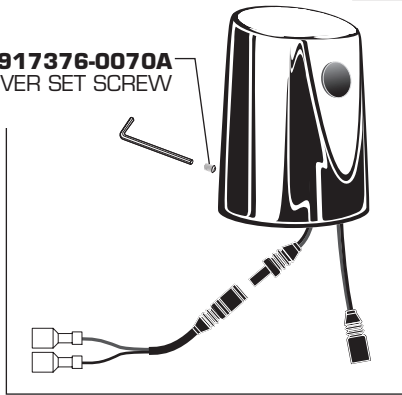

M962665-0020120A
COVER ASSEMBLY FOR
FLUSH VALVE WITH 0.125 gpf
(BATTERY INCLUDED)



A923654-0070A
BATTERY 6VCR-P2

A950223-0070500A
SENSOR ASSEMBLY
W/MTG. KIT.
FOR FLUSH VALVE
WITH 0.5 gpf

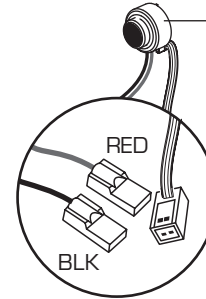

A950223-0071000A
SENSOR ASSEMBLY
W/MTG. KIT.
FOR FLUSH VALVE
WITH 1.0 gpf

A906680-0070A
BONNET NUT



M962664-0070A
SOLENOID ASSEMBLY

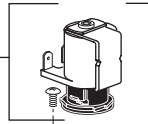

M962955-0070A
SOLENOID & PISTON
SUBASSEMBLY

M962907-0070A
PISTON ASSEMBLY

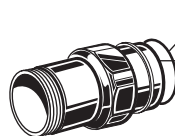
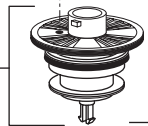

A912809-0070A
O-RING
OPTIONAL ADJUSTABLE TAILPIECE
(Purchased Separately)
M962836-0020A (8-1/4" to 9-1/4" Rough-in)
M962835-0020A (7-1/4" to 8-1/4" Rough-in)
M962834-0020A (6-1/4" to 7-1/4" Rough-in)
M962833-0020A (5-1/4" to 6-1/4" Rough-in)



M962920-0020A
ADJUSTABLE TAILPIECE
(4-1/4" to 5-1/4" Rough-in)

M962666-0020A
MANUAL VALVE

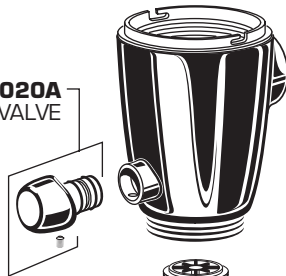

M962801-0070A
FLOW REGULATOR



M964074-0020A
STAMPED FLANGE

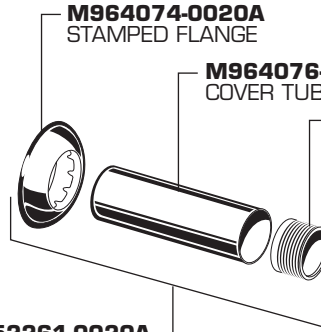

M964076-0020A
COVER TUBE

M964075-0070A
SWEAT ADAPTER

M955058-0020A
3/4" SUPPLY STOP

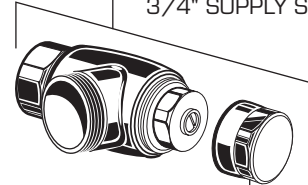

M964402-0070A
VACUUM BREAKER KIT



M952261-0020A
3/4" INLET PIPE ASSEMBLY

M964412-0020A
3/4" VACUUM
BREAKER ASSEMBLY

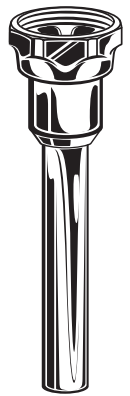

M952262-0020A
3/4" SPUD ASSEMBLY

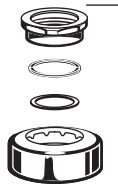

HOT LINE FOR HELP
For toll-free information and answers to your questions, call:
1 (800) 442-1902
Weekdays 8:00 a.m. to 6:00 p.m. EST
IN MEXICO 01-800-839-1200
IN CANADA 1-800-387-0369 (TORONTO 1-905-306-1093)
Weekdays 8:00 a.m. to 7:00 p.m. EST

Product names listed herein are trademarks of AS America, Inc. 2009