



IF PARTS ARE MISSING AND OR DEFECTIVE, IF INSTRUCTIONS ARE NOT CLEAR
OR IF YOU ARE EXPERIENCING PROBLEMS ASSEMBLING OUR PRODUCT.

**BEFORE YOU RETURN THE PRODUCT TO THE STORE,
PLEASE CALL US TOLL FREE FOR CUSTOMER SERVICE ASSISTANCE
(888) 777-8250**

**OR SEND US EMAIL AT
help@spartakent.com**

PLEASE HAVE MODEL AND W/O NUMBER READY, AND A REPRESENTATIVE WILL GLADLY
ASSIST YOU

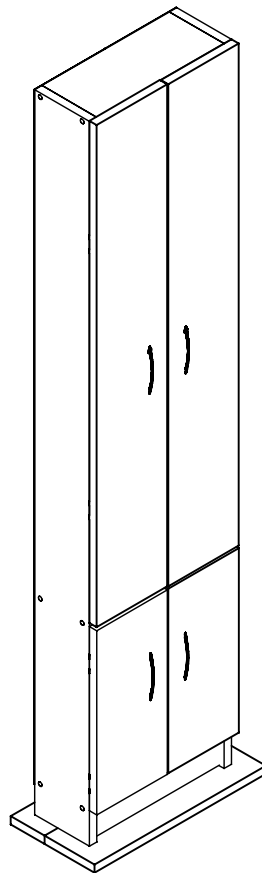

HARDWARE

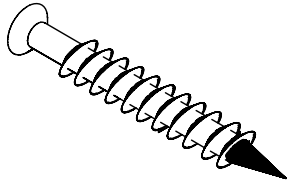

WOOD SCREW-16PCS
PART #SFH845A

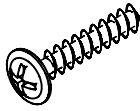

HANDLE SCREW-8PCS
PART #SP832BL

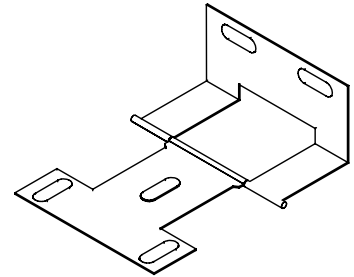

HINGE-8PCS
PART #HIN50SW

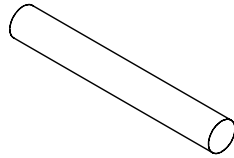

PIN-8PCS
PART #DOWW525

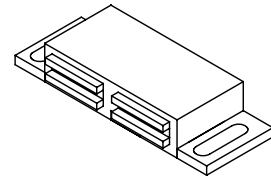

MAGNET KIT-2PCS
PART #MAGDB

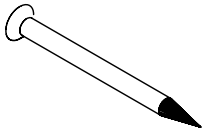

NAIL-40PCS
PART #NAIL25B

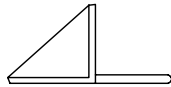

SHELF SUPPORT-28 PCS
PART #BP

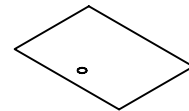

STRKE PLATE-4PCS
PART#STPLTBL



SMALL SCREW-32 PCS
PART #SP811BL



COVER CAP-12PCS
PART #SCXXS



HANDLE-4PCS
PART #PUPL128XX

TOOLS REQUIRED

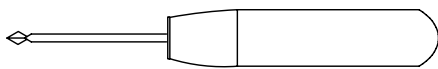

PHILIPS SCREWDRIVER

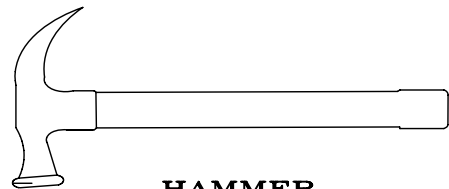

HAMMER

PARTS IDENTIFICATION

NOTE: FIRST MAKE SURE THAT YOU HAVE ALL OF THE PARTS LISTED ON THIS SHEET. IF YOU ARE MISSING ANY PIECE(S), DO NOT ASSEMBLE THE UNIT. INSTEAD, CALL OUR CUSTOMER SERVICE NUMBER AT: (888) 777 8250. WE WILL BE HAPPY TO ASSIST YOU.

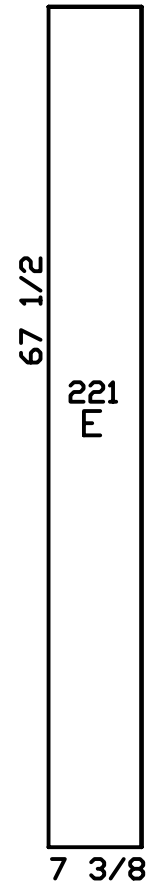
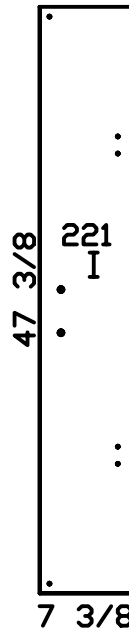
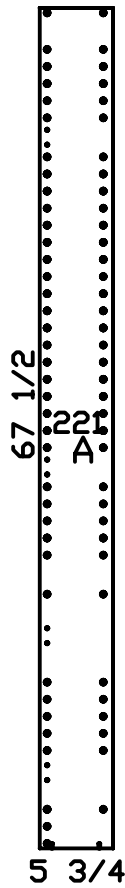
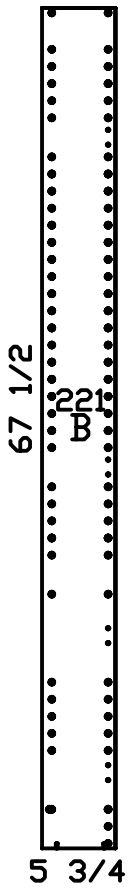
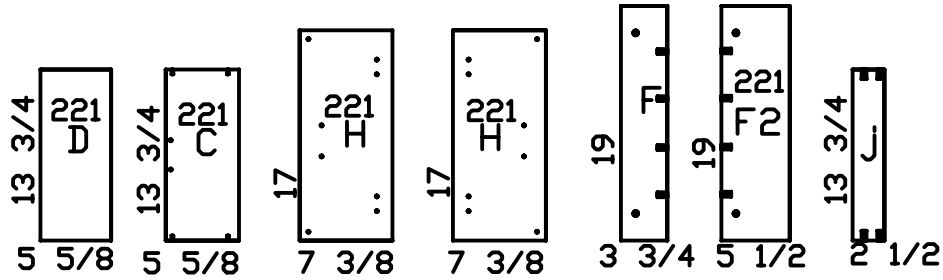

2211A-Left Side	1pc	2210E-Back Panel	2pcs
2211B-Right Side	1pc	2211F-Base	1pc
2210C-Fixed Shelf	3pcs	2211F2-Base	1pc
2210D-Adjustable Shelf	7pcs	2210H-Small Door	2pcs
		2210I-Large Door	2pcs

Locate parts (H) and (I). Using
smallscrews, screw the doors.

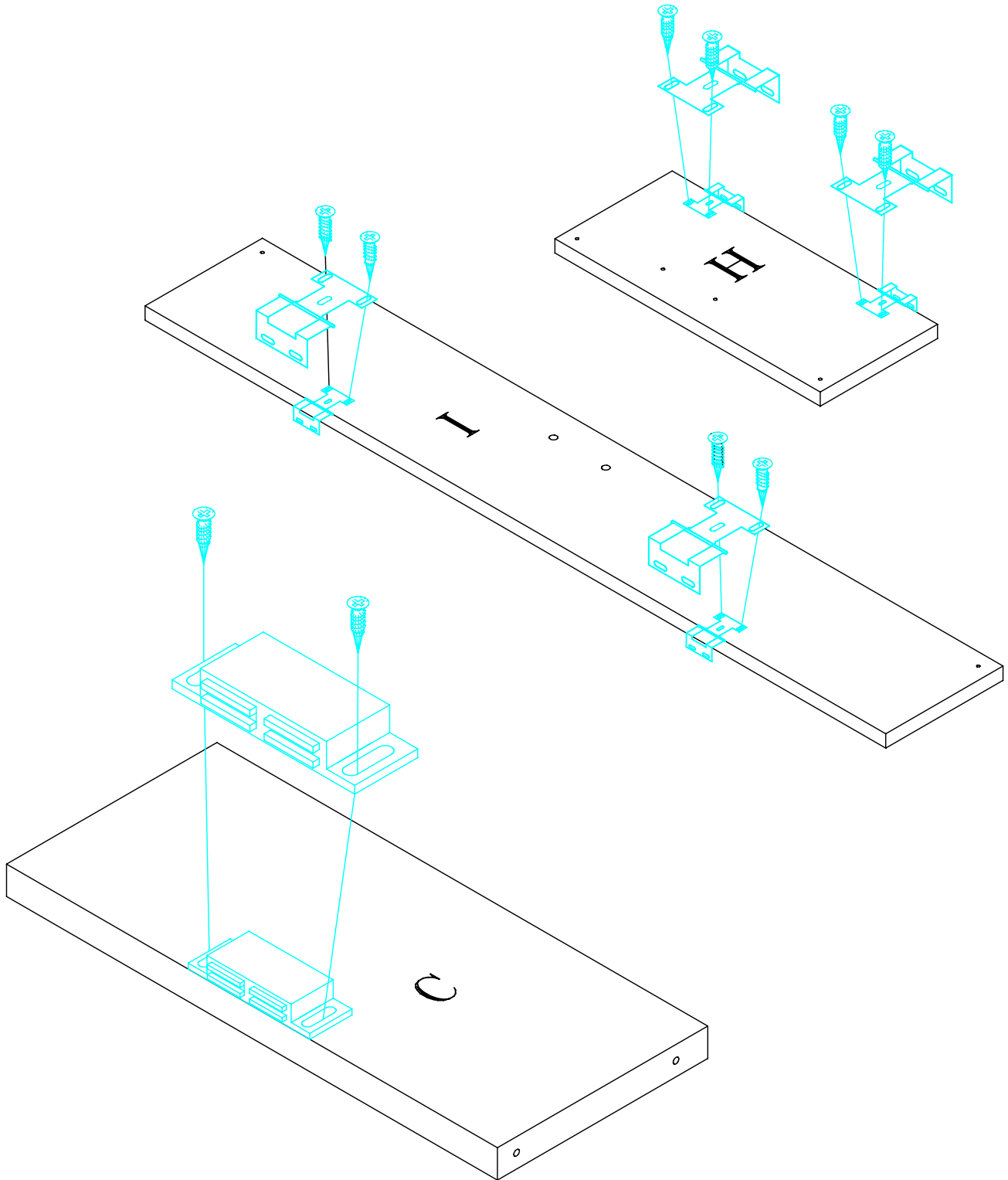

Using the large screws from the
magnet pack, screw the magnet
onto 2 out of the 3 parts C's.

2

Now, screw the bottom and middle shelf, (parts C), onto the right side panel using four wood screws. Again, make sure that the laminated edges of these parts are facing the floor.

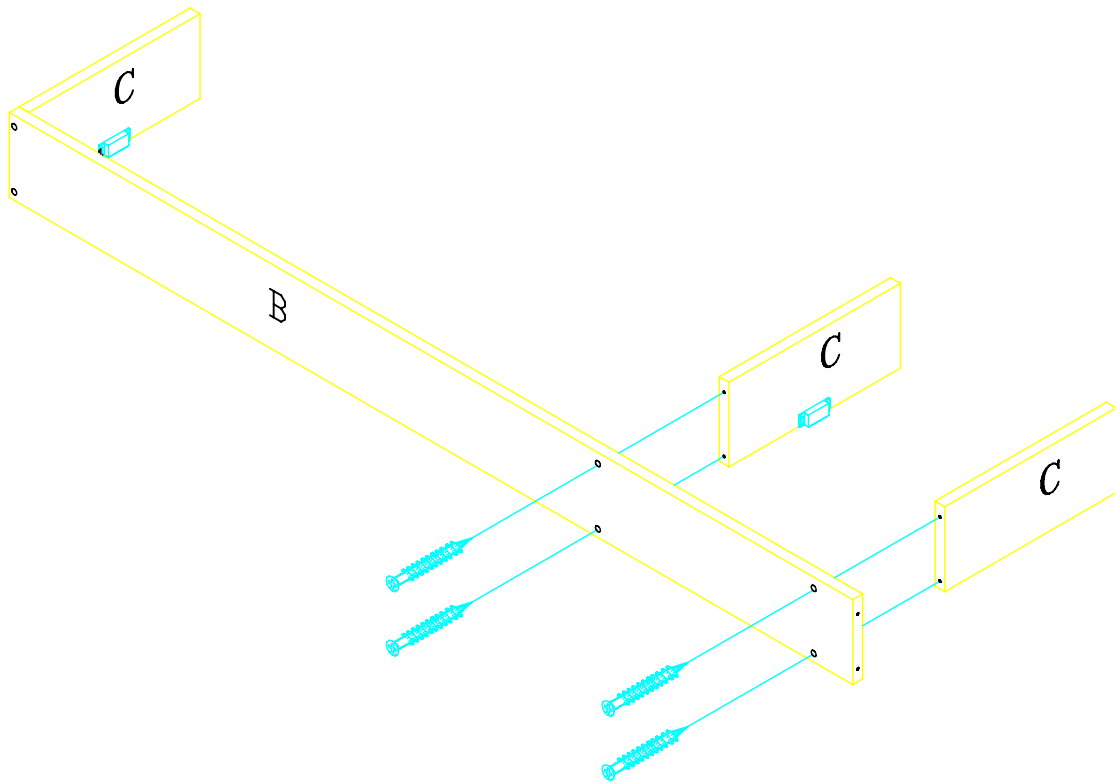

3

Using six wood screws, attach the left side panel, (part A), onto the unit as shown.

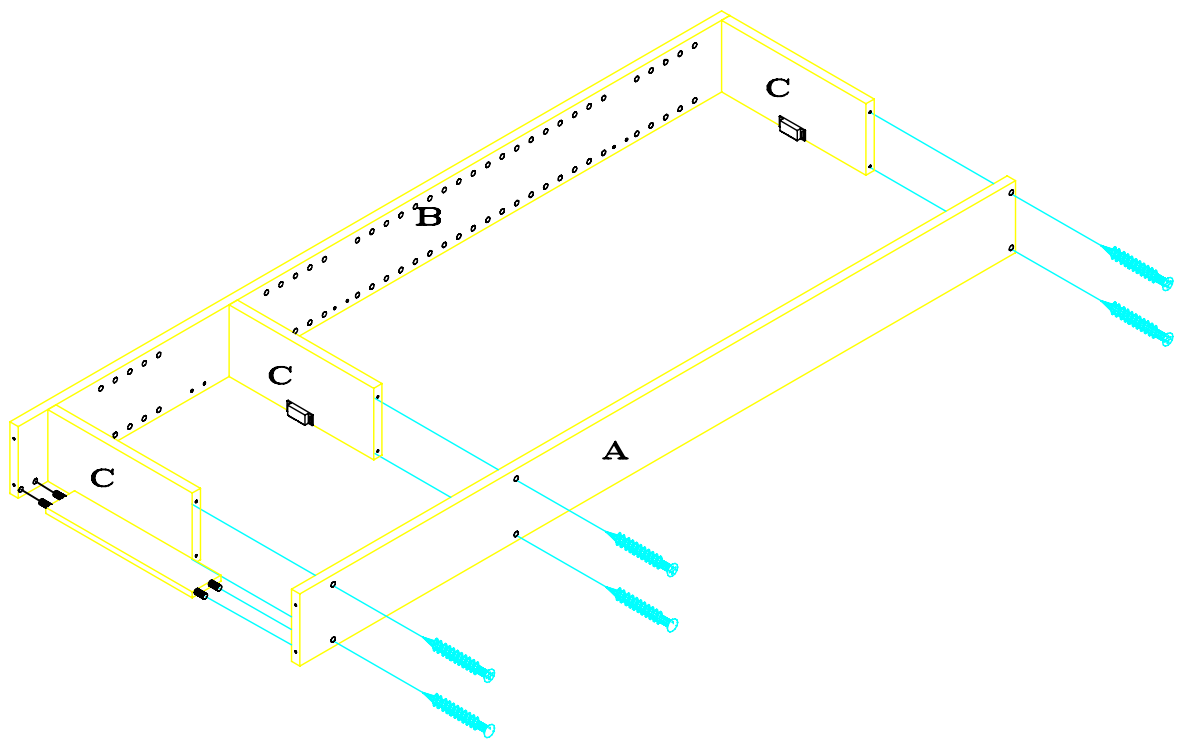

4

Now, nail the back panel onto the back of the unit. Before nailing, make sure you have placed the back panel onto the unit evenly, leaving equal amount of margins on all sides. The laminated surface of the back panel should be facing down towards the inside of the unit.

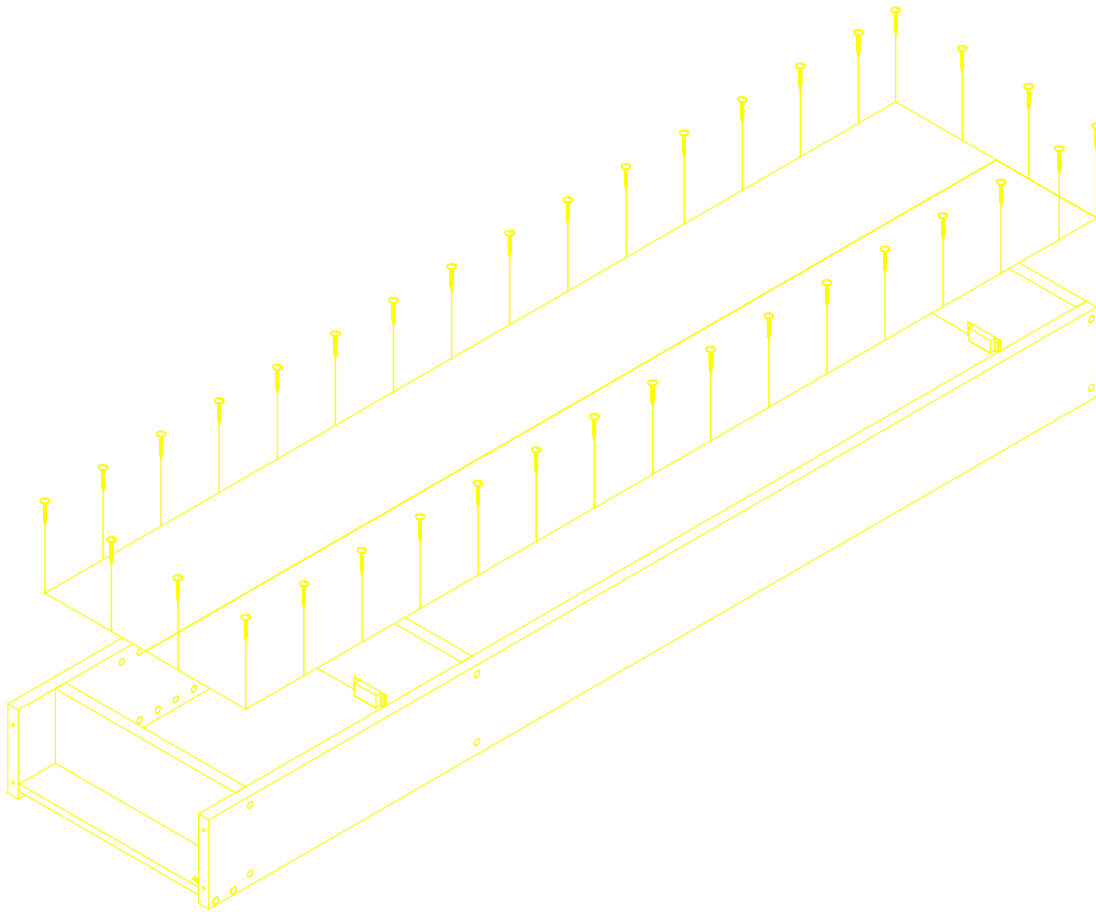

Repeat last step with large doors.

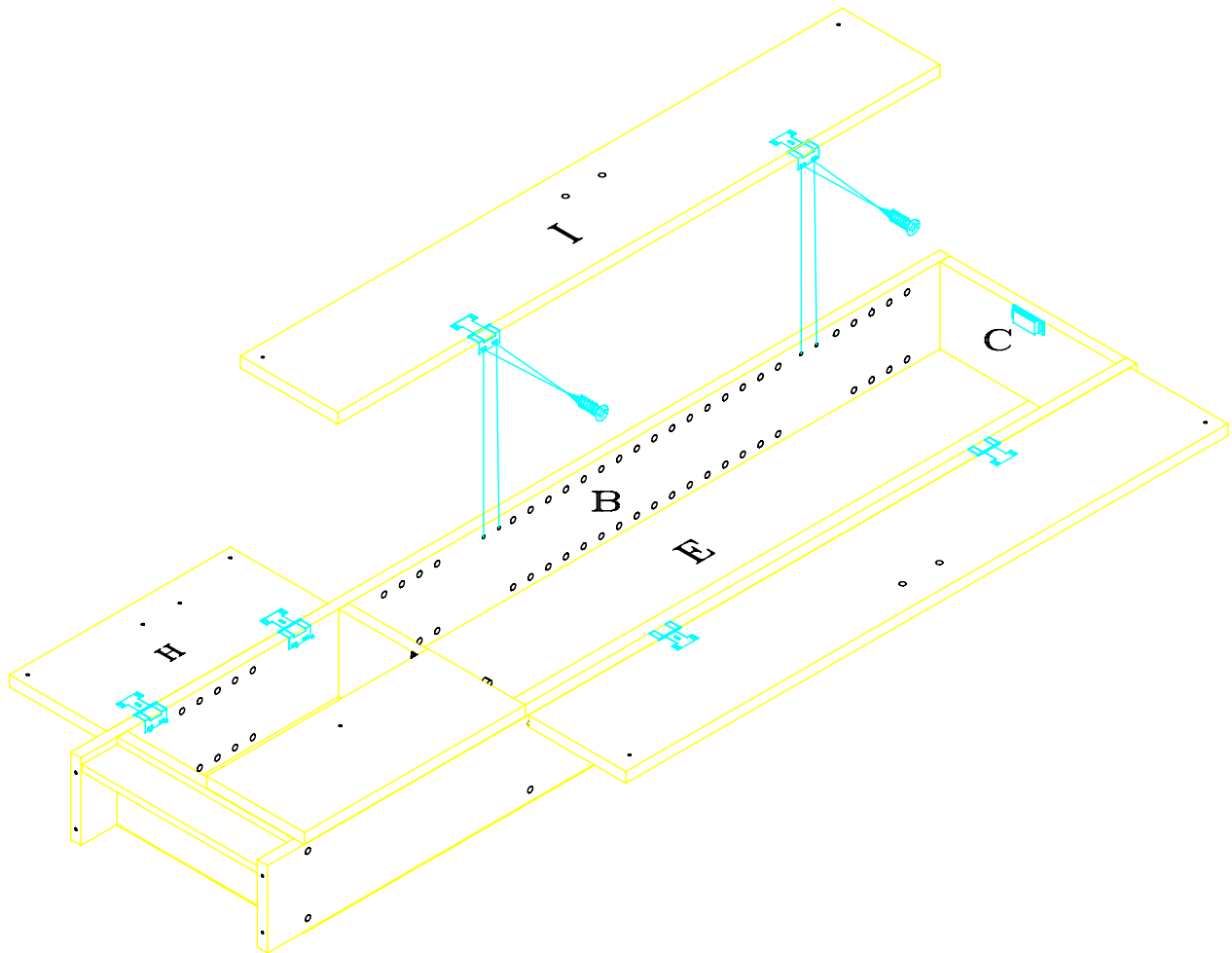

6

Attach base, F onto the unit using four wood screws. Make sure the laminated edge of part F is facing up.

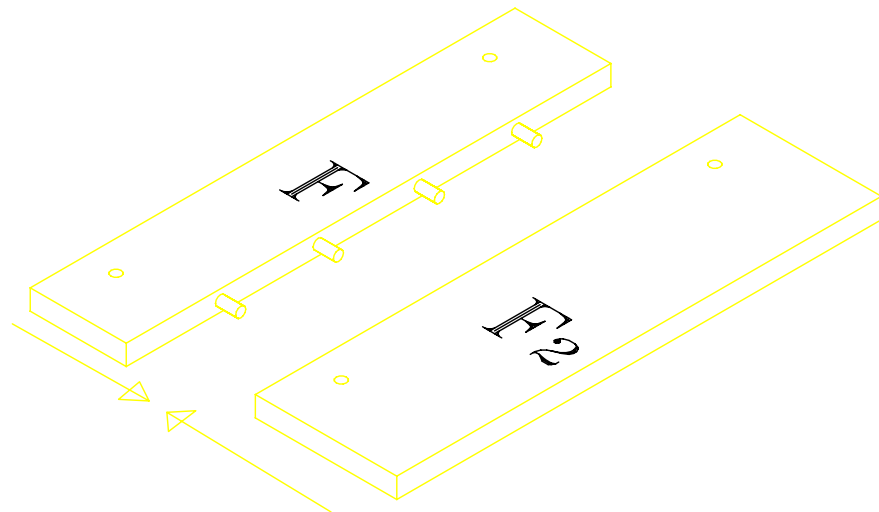
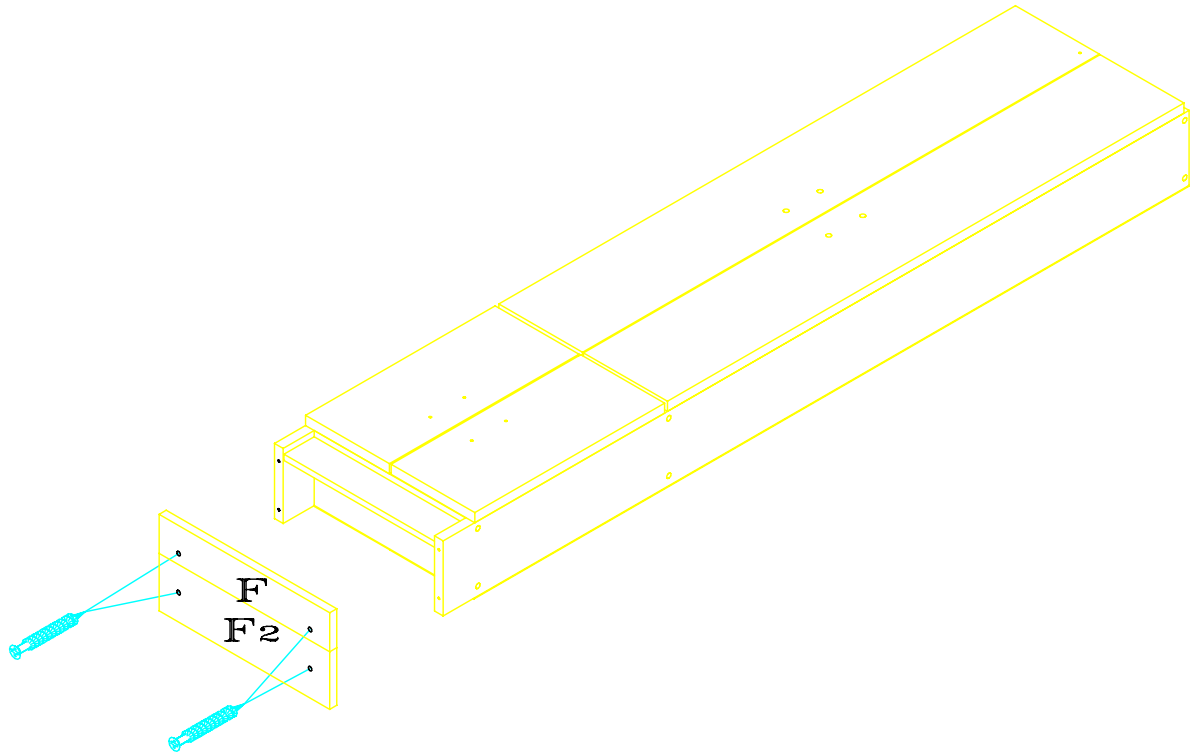

Using four metal pins connect two parts F together.

7

Attach strike plates for the magnets using small screw provided in magnet kit. Position shelves at desired levels using plastic shelf supports.

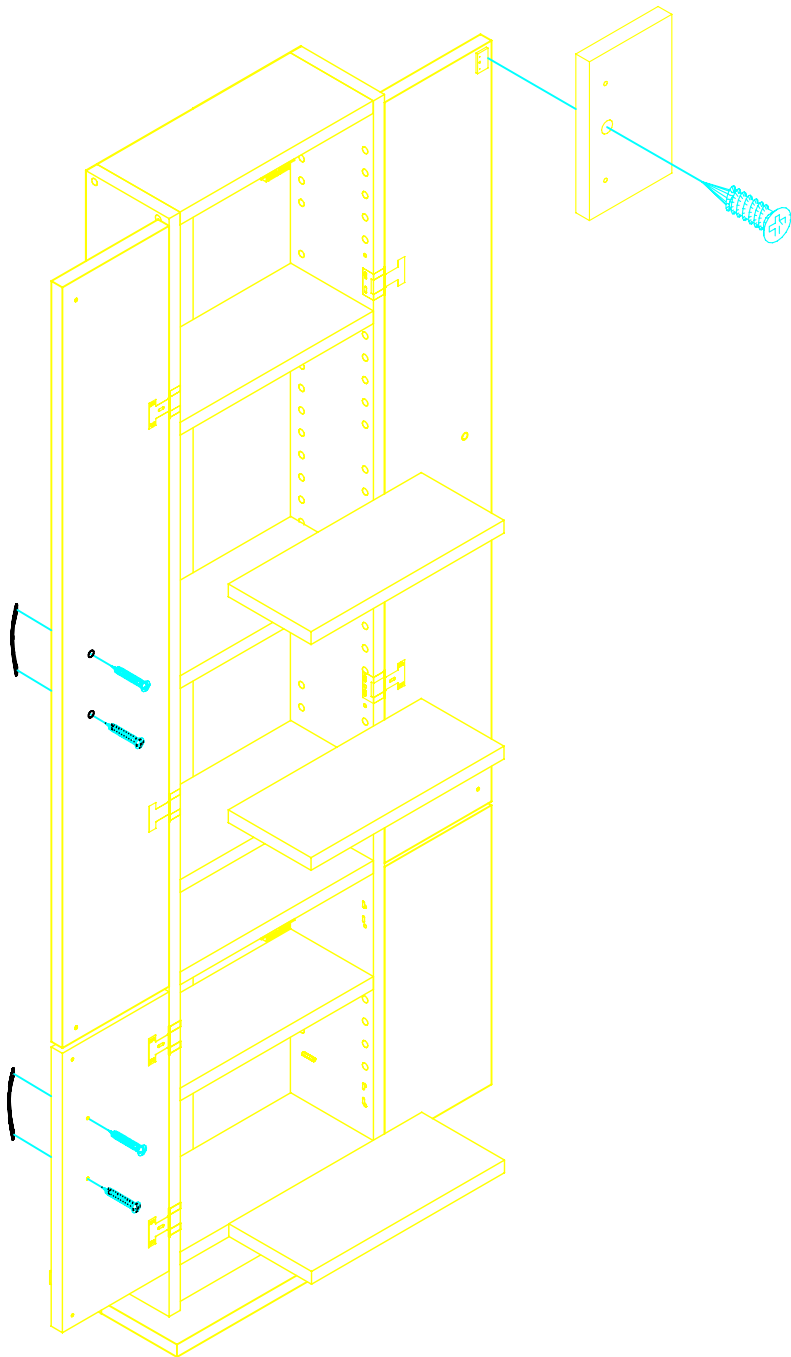

Attach door handles on all four doors.

8

Install cover caps to cover screw heads by gently tapping with the hammer. Wipe the dust off and you are ready to use the unit.

Should you find the gap between the doors uneven, you can adjust it. The slots on the hinges allow door adjustment in four directions.

