

# KENSINGTON 3-Way Diverter

MODEL # 19271

*Pure Freude an Wasser*

**GROHE**

GROHE America, Inc | 200 North Gary Avenue, Suite G, Roselle, IL 60172  
Phone: +1 (800) 444-7643 | Fax: +1 (800) 225-2778 | us-customerservice@grohe.com

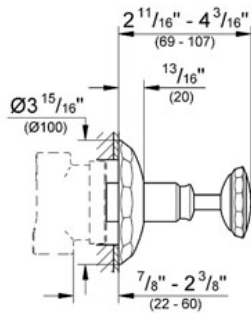

## Product Description: 3-Way Diverter

### Standard Specification:

- GROHE StarLight® finish
- Corona handle
- Set for final installation (for 29 712)
- Without concealed body
- Escutcheon with wall sealing
- Threaded
- Adjustable installation depth
- For use with Rough-In Valve 29 712

### Applicable Codes & Standards:

- Energy Policy Act of 1992
- ASME A112.18.1/CSA B125.1

### Color:

- 19271 000 chrome
- 19271 EN0 Brushed Nickel
- 19271 VP0