



# ASSEMBLY GUIDE

## Traditional Fan Trellis

TREL1 [10.11.12]



### TOOLS

- Screwdriver/Square bit #1  
(Power screwdriver/Square bit #1 recommended)

### COMPONENTS

Part	Description	Qty
(A)	Trellis (Partially-assembled)	1
(B)	Top cross-brace	1
(C)	Middle cross-brace	1
(D)	Stainless steel screws	10
	Square bit #1	1

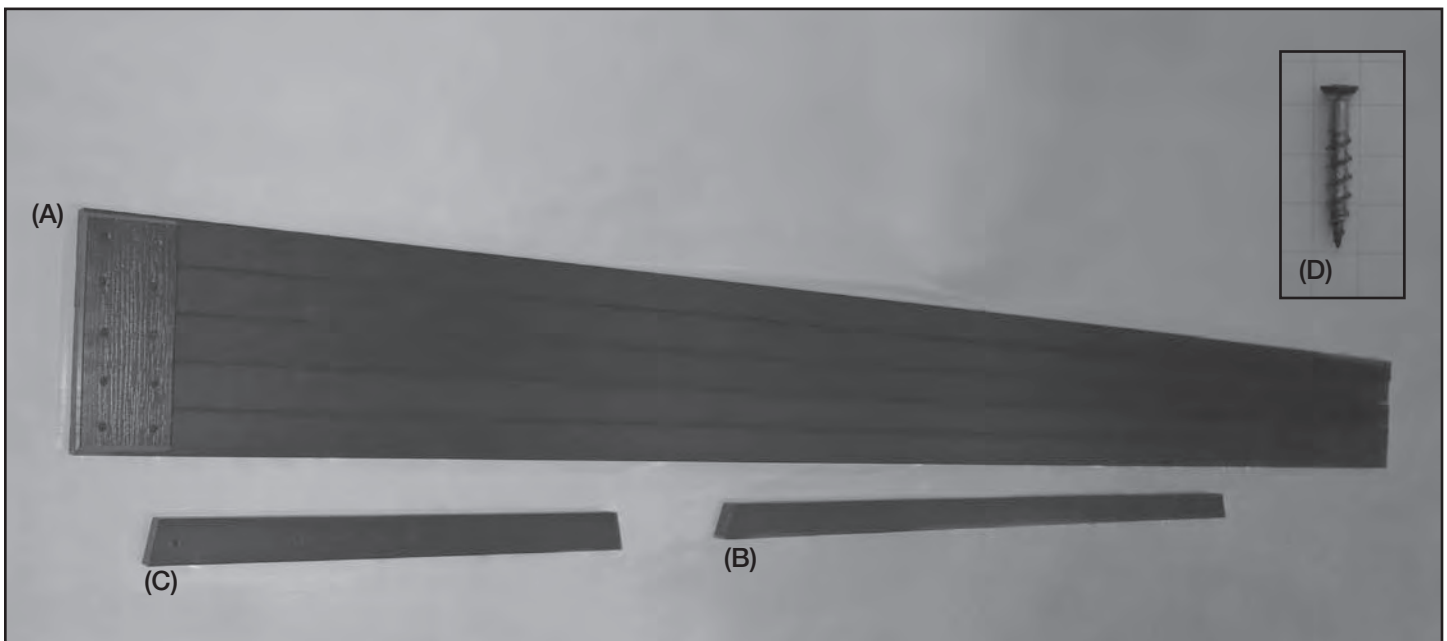

# Before you start

We recommend that this item is assembled on a flat surface.

**Note:** The front side of your trellis should be smooth. This means that the vertical spines are on the front and the horizontal pieces are on the rear of your trellis.

## STEP 1

### Attach Middle Cross-brace

Line Middle Cross-brace (C) up centrally so that the pre-drilled hole aligns with the pre-drilled hole of center vertical spine of Trellis (A). Using one screw (D), screw through the cross beam and into the center spine as shown in image #2 below.

Now you can attach the other 4 vertical spines in the same way. Starting with the outside spine, gently bend the spine outwards until it is aligned with the outside edge of the cross beam and secure with a screw through the back of the cross beam and into the spine as shown in image #3 below. Gently bend the middle spine outwards until the pre-drilled holes are aligned and attach using one screw as shown in image #4 below. Repeat on other side.

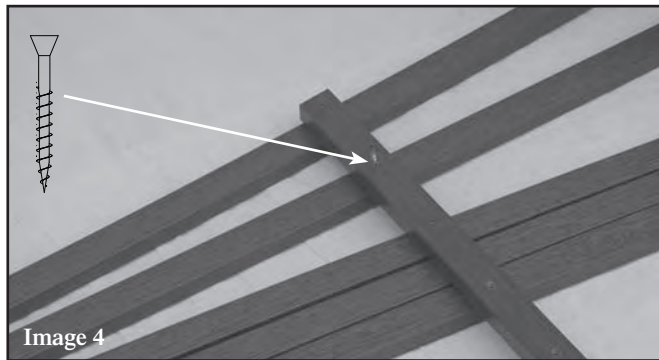
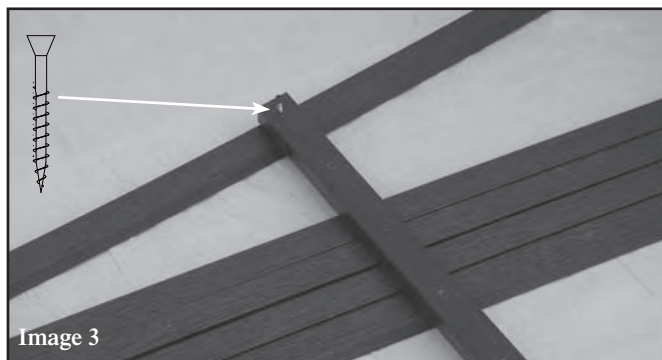
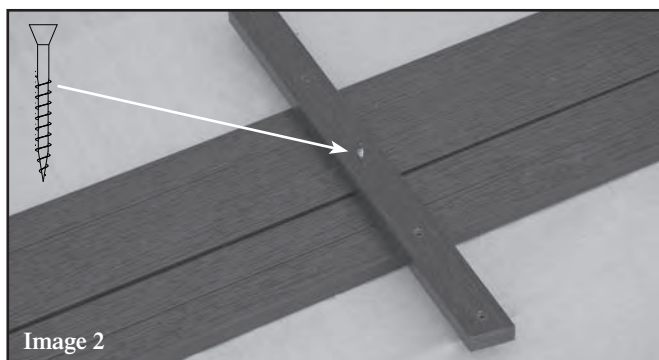
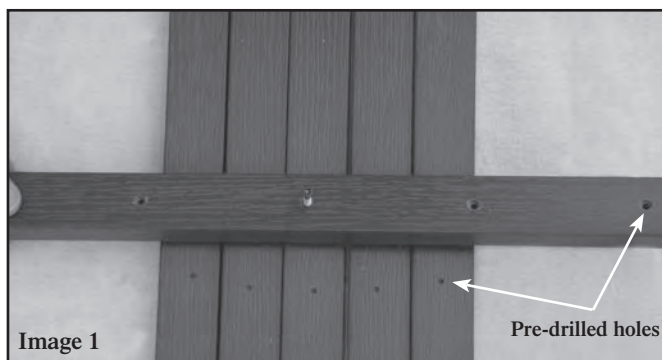

## STEP 2

### Attach Top Cross-brace

The final task is to attach the Top Cross-brace (B) in the same way that you screwed through the middle cross-brace and into the spines. Starting with the center spine secure with a screw into the pre-drilled holes. Next, gently bend the outside spine and secure, and then attached the middle spine.

Repeat on other side.

The trellis can be either inserted directly into soil at the base and/or attached to a vertical surface using any common wood-screws/wire etc.



## Enjoy your Trellis!

For information on Care and Cleaning your *highwood*<sup>®</sup> product visit [www.highwood-usa.com/care.html](http://www.highwood-usa.com/care.html)

Visit our Website and Facebook page to see more *highwood*<sup>®</sup> products!

[www.highwood-usa.com](http://www.highwood-usa.com) • [www.facebook.com/highwoodUSA](http://www.facebook.com/highwoodUSA)