

Instructions for Adding Serrated Tip Option To Models:

SEF-1850
SEF-1850-8
SEF-1801
SEF-1801-8

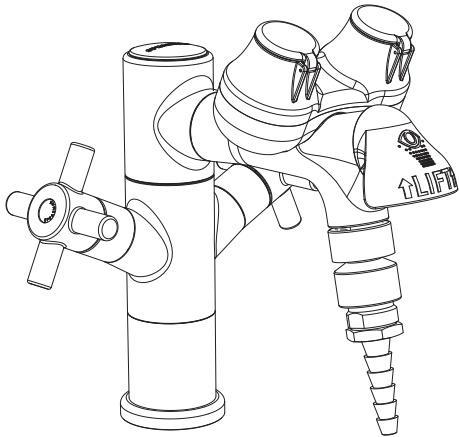

Need Help?

For additional assistance or service call:

SPEAKMAN Company
400 Anchor Mill Road
New Castle, DE 19720

PHONE: 800-537-2107
EMAIL: customerservice@speakmancompany.com
WEB: www.speakmancompany.com

92-SEF-1850-ST-R1

What You Need To Know:

Tools:

Required:

* Aerator Wrench (included)

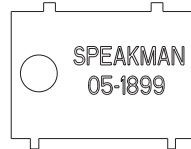

* Adjustable Wrench

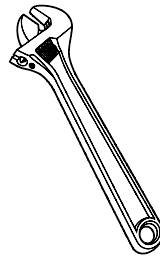

Important Notes:

Be sure to read instructions thoroughly before beginning installation. Do not overtighten any connections or damage may occur.

Safety Tips:

Cover your drain to prevent loss of parts.

Maintenance:

Keep the serrated tip looking new by cleaning it periodically with a soft cloth. Avoid abrasive cleaners, steel wool, and harsh chemicals as these will dull the finish and void your warranty.

Warranty:

Warranty information can be found at:
www.speakmancompany.com

- ① If the serrated tip is being installed on a new faucet, skip to step 2. If an aerator is currently installed, start out by removing it with the aerator wrench supplied with the faucet.

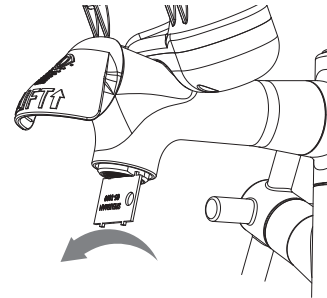

- ② The threaded bushing can now be threaded into the faucet. Be sure to insert the washer on top of the bushing. Wrench tighten.

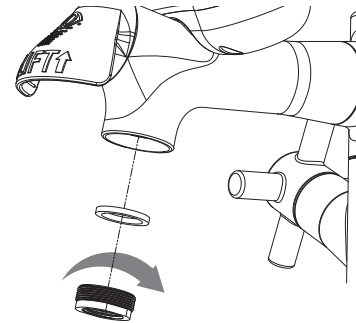

- ③ Retrieve the vacuum breaker and included blue washer. Place the washer in the groove at the base of the external threads, then thread the vacuum breaker into the installed bushing. Wrench tighten.

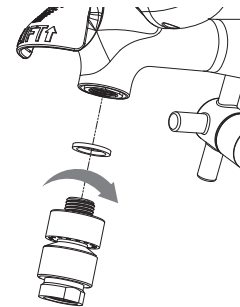

- ④ Locate the serrated tip and supplied washer. Install the washer in the groove at the base of the external threads. Thread the serrated tip into the vacuum breaker. Wrench tighten.

